

STORE #3889

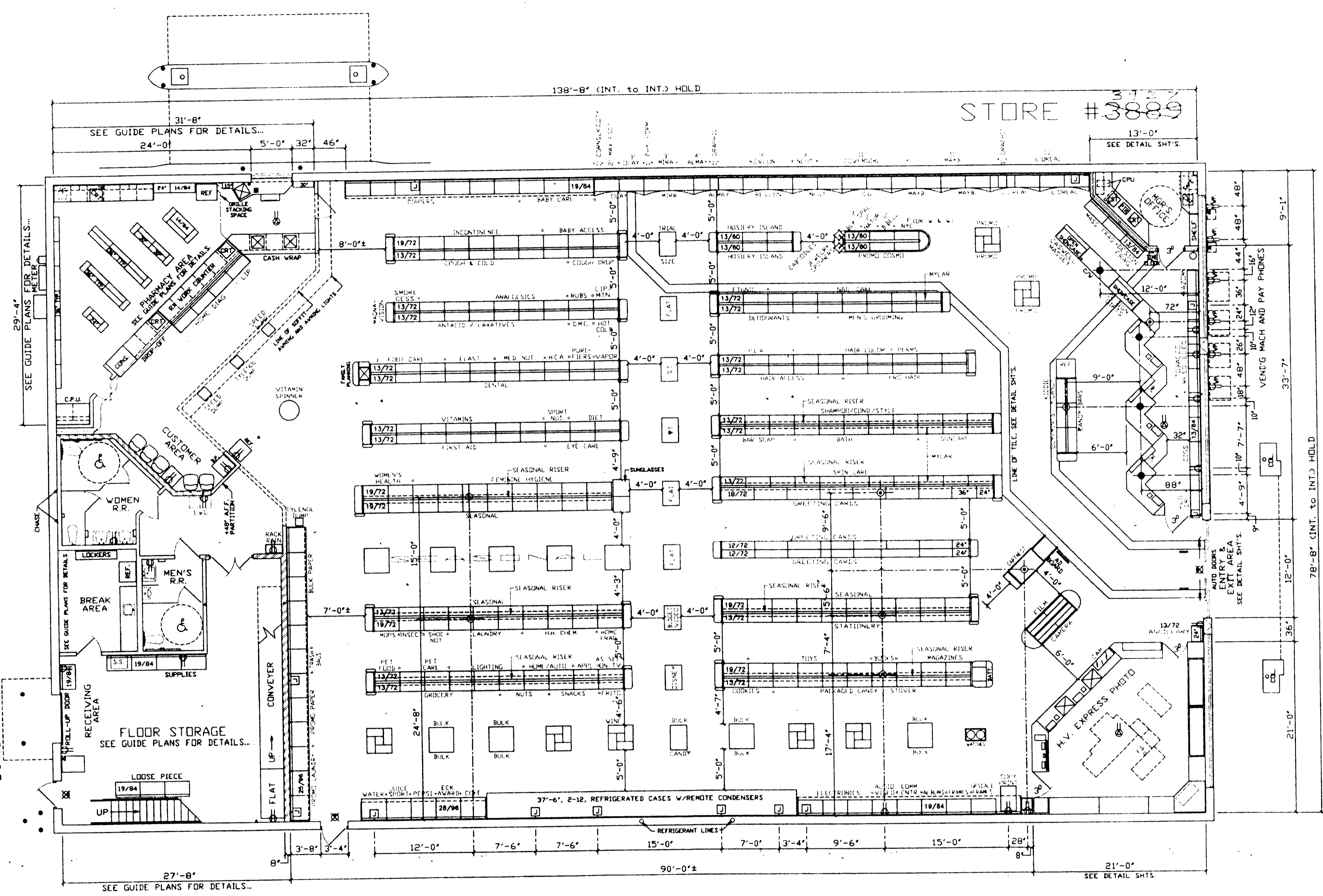

- LEGEND**
- SEE ECKERD GUIDE PLANS FOR DETAILS...
- ⊙ - FLOOR RECEPTACLE, 120V 20AMP BRASS W/ FLUSH RECEPT. (ALL CONDUIT TO BE PVC PIPE)
 - - DATA TERMINAL POWER SOURCE FOR #319 ELECTRICAL CASH REGISTER. (ALL CONDUIT TO BE DEDICATED CIRCUIT IN PVC PIPE)
 - 1. PROVIDE CONTINUOUS 2-#2 THW W/ GND CONNECTING CASH REGISTERS AS SHOWN CIRCUIT TO PANEL "B".
 - 2. EACH CASH REGISTER DRAWS 15 AMP.
 - 3. C/R CASH REGISTER RECEPT. TO BE AN ISOLATED GND. BRASS RECEPT. TYPE HUBBELL 1G-5362-125V OR EQUIV.
 - ⊗ - EXIT LIGHT & SIGN. 'LITHONIA' M-S-W-IRW OR EQUAL.
 - ⊕ - DUPLEX RECEPTACLE, IN WALL 18" AFF. OR AS SPECIFIED. NOTE: SEE GUIDE PLANS FOR OFFICE ELECTRICAL DETAILS.
 - ⊕ - SPECIAL PURPOSE DUPLEX RECEPTACLE OUTLET ABOVE CEILING. ALL SPECIAL PURPOSE OUTLETS ARE TO BE ON ONE (1) CIRCUIT.
 - ⊗ - TELEPHONE.
 - ⊕ - JUNCTION BOX, SEE GUIDE PLANS FOR MOUNTING HEIGHT.

NOTE 1

SEE ECKERD GUIDE PLANS FOR DETAILS...

NEW RESTROOMS: ARCHITECT SHALL DESIGN RESTROOMS TO COMPLY WITH ALL HANDICAPPED CODES HAVING JURISDICTION OVER THIS PROJECT. HE SHALL PROVIDE ELEVATIONS OF THE RESTROOMS WITH DIMENSIONS OF ALL ELEMENTS REQUIRED.

NOTE 2

SEE ECKERD GUIDE PLANS FOR DETAILS...

CONTRACTOR TO VERIFY ALL DIMENSION AND CONDITIONS BEFORE STARTING CONSTRUCTION. CONTRACTOR TO NOTIFY ECKERD CONSTRUCTION OF ANY CONFLICTS.

MEZZANINE

PROTO 2000
FLOOR PLAN
SCALE - 1/8" = 1'-0"

ECKERD
CORPORATION
P.O. BOX 4689, CLEARWATER, FL. 33777, (727)395-6948

REV. - REDRAWN TO NEW PROTO 2000 - 02/20/01 - DP.			
STORE #3889 ³²⁷ NEW STORE			
SCALE: SHOWN	APPROVED BY:	DRAWN BY: PELZEL	
DATE: 03/14/2000		STREATER FIXTURES	
COCONUT CREEK, FLORIDA		DISTRICT: S.F.L.	FILENAME: 3889
		TOTAL SQFT. = 10,908	
		SITE #20004	
FIXTURE PLAN		DRAWING NUMBER: 3889 F-1	