

PROPOSED ELECTRICAL POWER PLAN

SCALE: 1/4" = 1'-0"

H.V.A.C. INSTALLATION NOTES:

1. PROVIDE VOLUME DAMPERS FOR ALL SUPPLY BRANCH DUCTS, IF REQUIRED.
2. PROVIDE SPLITTER DAMPERS IF REQUIRED.
3. EXHAUST FANS TO BE INSTALLED AS INDICATED WITH DIRECT VENTING TO EXTERIOR THROUGH THE ROOF OR THROUGH THE WALL AS INDICATED.
4. CEILING MOUNTED SUPPLY DUCT DIFFUSERS ARE TO BE BY AMERIFLOW MODEL #500 W/ 4" DIA. 6" ROUND OR EQUAL. FLOOR OR WALL MOUNTED REGISTERS ARE TO BE BY AMERIFLOW 4" X 10" MODEL #43B4-10 OR EQUAL.
5. ONE NEW PROGRAMMABLE THERMOSTAT TO BE WALL MOUNTED, MULTI-STAGED TYPE BY WHITE RODGERS, MODEL #4E661 OR EQUAL.
6. RETURN AIR GRILLES TO BE TITUS MODEL #F, 8"X12" WITH BOX AND COLLAR.
7. PROVIDE FURNACE MOUNTING BRACKETS WITH VIBRATION DAMPERS ON THE NEW 2ND FLOOR MOUNTED FURNACE UNIT AS REQUIRED.
8. PROVIDE SMOKE DETECTORS AS REQUIRED.
9. INSULATE ALL DUCT EXPOSED TO NON-CONDITIONED TEMPERATURES.
10. PROVIDE ACCESS TO EQUIPMENT ACCORDING TO APPLICABLE CODE.
11. PROVIDE THROUGH WALL FLUES AND THROUGH ROOF FLUES COMPLETE INCLUDING ALL ASSOCIATED FLASHINGS AND HARDWARE.
12. FURNISH AND INSTALL ONE GAS FURNACE TO SERVE THE SECOND FLOOR UP FLOW UNIT. "COMFORTMAKER", 80% EFFICIENCY, 125,000 BTU/H. (UNIT #)
13. PROVIDE COMBUSTIBLE AIR SUPPLY TO FURNACES AS REQUIRED.
14. PROVIDE ELECTROSTATIC AIR CLEANER AND HUMIDIFIER SYSTEM ON ALL OF THE FURNACE UNITS.
15. FURNISH AND INSTALL ONE 2 TON A/C CONDENSING UNIT.
16. PROVIDE HARD PIPED CONDENSATE DRAIN DIRECTLY TO SANITARY SEWER FROM NEW FURNACE UNIT.

ELECTRICAL GENERAL NOTES:

1. ALL WORK SHALL BE DONE IN ACCORDANCE WITH THE NATIONAL ELECTRICAL CODE (NEC), AND ALL LOCAL AND STATE CODES.
2. ALL EQUIPMENT SHALL BE NEW AND SHALL HAVE UL LABEL FOR THE INTENDED USE.
3. ELECTRICAL SYSTEM SHALL BE COMPLETE IN EVERY DETAIL, INCLUDING ALL INCIDENTAL ITEMS FOR PROPER AND FUNCTIONING INSTALLATION.
4. ALL REQUIRED PERMITS AND INSPECTIONS SHALL BE OBTAINED AND PAID FOR BY THE CONTRACTOR.
5. GROUND CONTINUITY SHALL BE MAINTAINED THROUGHOUT THE ELECTRICAL SYSTEM PER NEC REQUIREMENTS.
6. SWITCHES SHALL BE SINGLE POLE, 15 AMP OR 20 AMP, 120/277 VOLT, QUIET TYPE 61MLR TO HUBBELL 9 121, OR BUILDERS GRADE.
7. PROVIDE NEW 200 AMP SERVICE AS REQUIRED TO PROPERLY POWER THE NEW STRUCTURE. BURY NEW INCOMING POWER LINE.
8. ALL MATERIALS AND WORKMANSHIP SHALL BE GUARANTEED FOR A PERIOD OF ONE YEAR FROM THE DATE OF THE OWNER'S ACCEPTANCE OF THE WORK. THE CONTRACTOR SHALL MAKE GOOD ANY DEFECTS WITHIN THAT PERIOD AT NO ADDITIONAL COST TO THE OWNER.
9. COORDINATE AND COMPLY WITH ALL OF THE REQUIREMENTS OF UTILITY COMPANY REGARDING THE ELECTRICAL SERVICE TO THE ADDITION.
10. PROVIDE THROUGH WALL VENTING FOR ALL EXHAUST FANS.
11. THE ELECTRICIAN SHALL CONFIRM AND VERIFY THE ENTIRE SERVICE AND SHALL MAKE ALL NECESSARY MODIFICATIONS TO THE SERVICE AS REQUIRED BY CODE.
12. THE EXHAUST FAN SYSTEMS AND VENTILATION SYSTEM SHALL MEET ALL OF THE REQUIREMENTS OF THE CURRENT FLORIDA MECHANICAL CODE.
13. A MINIMUM OF TEN FEET ISOLATION DISTANCE MUST BE MAINTAINED BETWEEN EXHAUST FAN OUTLETS & FRESH AIR INTAKES.

REFLECTED CEILING LEGEND

- | | |
|---|--|
| SURFACE MOUNTED, T8 2x4 FLUORESCENT TROFFER LIGHT FIXTURE BY LITHONIA. 4 BULB FLUORESCENT 60 WATT LAMPS | EXHAUST FAN W/ LIGHT, BROAN 120 CFM, PART # M45120L W/ MOTION SENSOR |
| WALL MTD. INCANDESCENT FIXTURE | 50 WATT, 120 VOLT, DUAL LAMP EMERGENCY LIGHT BY LITHONIA, PART # EL14 OR EQ. |
| RECESSED INCANDESCENT DOWN LIGHT | EMERGENCY EXIT SIGN W/ BATTERY BACKUP BY LITHONIA, PART # LQ15W3 OR EQ. |
| RECESSED COMPACT FLUORESCENT WALL WASHER | DUAL CARBON MONOXIDE / SMOKE DETECTOR - WIRED TO OTHER UNITS FOR UNISON ALARM PROVIDE BATTERY BACKUP BRK #C9120B (2FTP4) |
| LANTERN PENDANT FIXTURE | SUPPLY AIR DIFFUSER |
| SURFACE MOUNTED INCANDESCENT FIXTURE | RETURN AIR GRILLE |

ELECTRICAL LEGEND

- | | | |
|---|--|--|
| SURFACE MOUNTED, T8 2x4 FLUORESCENT TROFFER LIGHT FIXTURE BY LITHONIA. 4 BULB FLUORESCENT 60 WATT LAMPS | TELEPHONE | 3/4 HORSEPOWER GARAGE DOOR OPENER WITH REMOTES BY STANLEY (OR EQUAL) |
| WALL MTD. INCANDESCENT FIXTURE | COMPUTER | FLOOR OUTLET |
| DUPLEX RECEPTACLE | EXHAUST FAN W/ LIGHT, BROAN 120 CFM, PART # M45120L W/ MOTION SENSOR | |
| DUPLEX RECEPTACLE W/ GROUND FAULT INTERRUPT | 3/4 H.P. INSINKERATOR DISPOSABLE UNIT | |
| DUPLEX RECEPTACLE 220 VOLTAGE | 110 VOLT JUNCTION BOX. | |
| SINGLE POLE SWITCH | 50 WATT, 120 VOLT, DUAL LAMP EMERGENCY LIGHT BY LITHONIA, PART # EL14 OR EQ. | |
| 3 WAY SWITCH | EMERGENCY EXIT SIGN W/ BATTERY BACKUP BY LITHONIA, PART # LQ15W3 OR EQ. | |
| 4 WAY SWITCH | | |
| DIMMER SWITCH | | |
| DIGITAL PROGRAMMABLE THERMOSTAT BY WHITE RODGERS | | |

NOTE: ALL ELECTRICAL WORK SHALL CONFORM TO THE STANDARDS OF THE LATEST ADOPTED NATIONAL ELECTRIC CODE

HVAC LEGEND:

- | | |
|--|---|
| SUPPLY AIR DIFFUSER | ATTIC MOUNTED, ELECTRIC FURNACE/AIR CONDITIONING SPLIT SYSTEM UNIT |
| RETURN AIR GRILLE | FIRE DAMPER |
| DIGITAL PROGRAMMABLE THERMOSTAT BY WHITE RODGERS | AMERIFLOW 10" X 12" WALL REGISTER |
| DUAL CARBON MONOXIDE / SMOKE DETECTOR - WIRED TO OTHER UNITS FOR UNISON ALARM PROVIDE BATTERY BACKUP BRK #C9120B (2FTP4) | SHEET METAL "BUTTERFLY" DUCT DAMPER |
| EXHAUST FAN W/ LIGHT 4 HEATER, VENTED THROUGH ROOF, 200 CFM | FLEXIBLE INSULATED DUCT WITH TIGHTENED COLLARS @ EACH END |
| | SLAB MOUNTED EXTERIOR, SPLIT SYSTEM, AIR CONDITIONING CONDENSING UNIT, 5 TON, HIGH EFFICIENCY BY "COMFORTMAKER" |

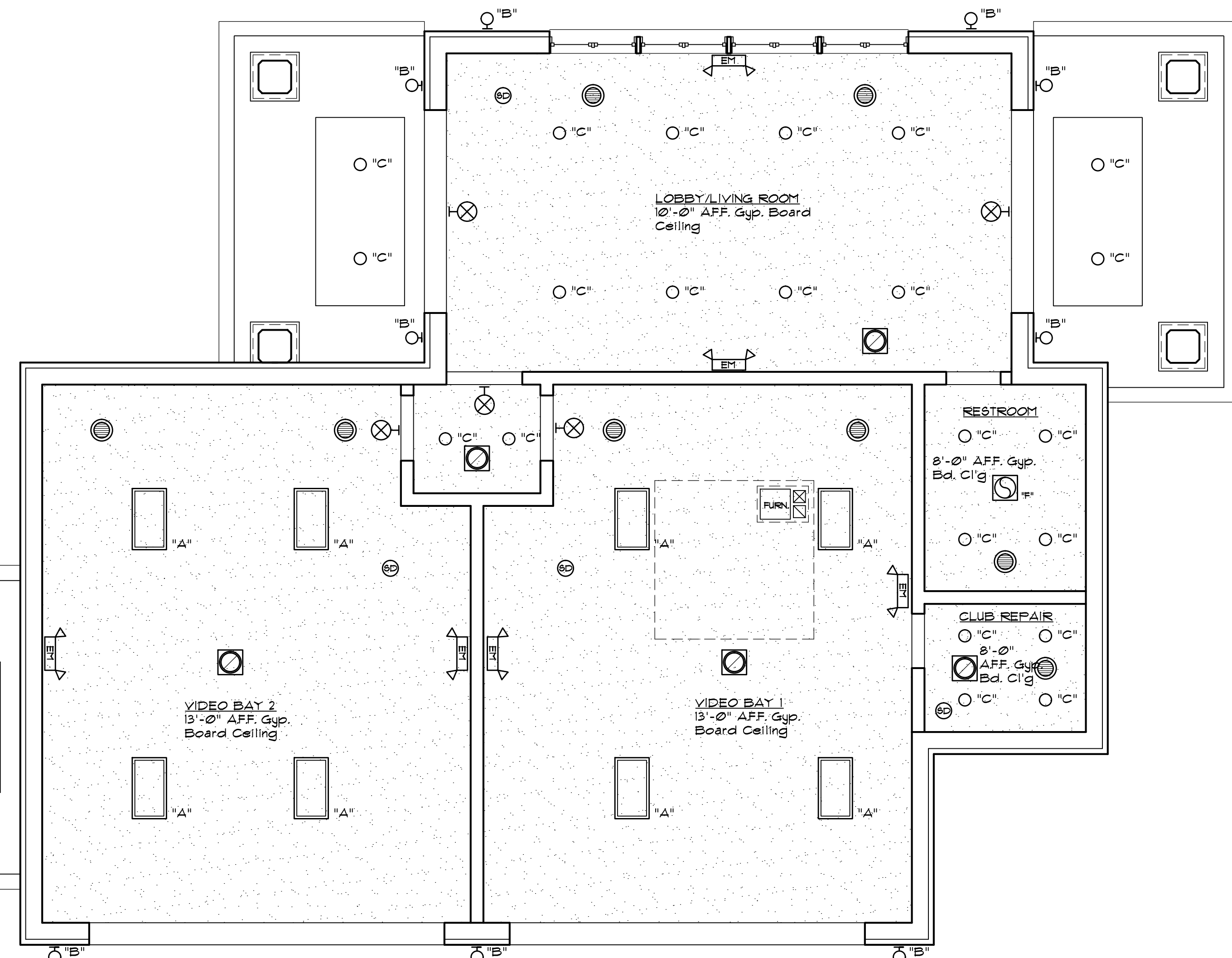

PROPOSED REFLECTED CEILING PLAN

SCALE: 1/4" = 1'-0"



THE RON JONA COLLABORATIVE

ARCHITECTS DESIGNERS CONSULTANTS

29110 INKSTER, SUITE 150 SOUTHFIELD, MI 48034

P. 248.357.3600
F. 248.357.3646

WWW.RONJONA.COM

KEVIN D. HART, AIA

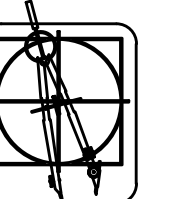

ARCHITECTURE PLANNING DESIGN ENGINEERING

F. 248.642.9427
700 EAST MAPLE, SUITE 101 BIRMINGHAM, MI 48009

©2014 THE RON JONA COLLABORATIVE

THIS DOCUMENT AND THE INFORMATION CONTAINED THEREIN IS THE SOLE PROPERTY OF THE RON JONA COLLABORATIVE AND SHALL NOT BE ALTERED OR REPRODUCED WITHOUT THE EXPRESS WRITTEN PERMISSION OF THE RON JONA COLLABORATIVE. ANY MODIFICATION OR ALTERATION THEREOF SHALL BE INDICATED AND PROPERLY MARKED FOR THE RON JONA COLLABORATIVE BY ALL SERVICES, CLAIMS AND/OR LIABILITY ARISING FROM SUCH MODIFICATIONS OR ALTERATIONS.

DO NOT SCALE DRAWINGS

ISSUED	PERMITS
11-10-14	PERMITS

FILE	ERW
DRAWN	ERW
CHECKED	KDH/RJ
SEAL	

CLIENT
ADIOS GOLF CLUB
7740 NW 39th AVENUE
COCONUT CREEK, FL 33073

PROJECT
PROPOSED TEACHING FACILITY
ADIOS GOLF CLUB
COCONUT CREEK, FL

JOB NO.
1411

SHEET
MECHANICAL/ELECTRICAL PLAN
AND REFLECTED CEILING PLAN

SHEET NO.

ME-1