

ADDIOS GOLF CLUB

GOLF COURSE IMPROVEMENTS PLAN COCONUT CREEK, FLORIDA

APRIL, 2002

GOLF COURSE IMPROVEMENTS
- INDEX TO DRAWINGS -

DESCRIPTION	SHEET
PROPOSED IMPROVEMENTS	1 OF 7
PROPOSED LATE CROSS SECTIONS	2 OF 7
EXISTING LATE CROSS SECTIONS	3 OF 7
PROPOSED EARLY CROSS SECTIONS	4 OF 7
EXISTING EARLY CROSS SECTIONS	5 OF 7
PROPOSED LATE CROSS SECTIONS	6 OF 7
EXISTING LATE CROSS SECTIONS	7 OF 7

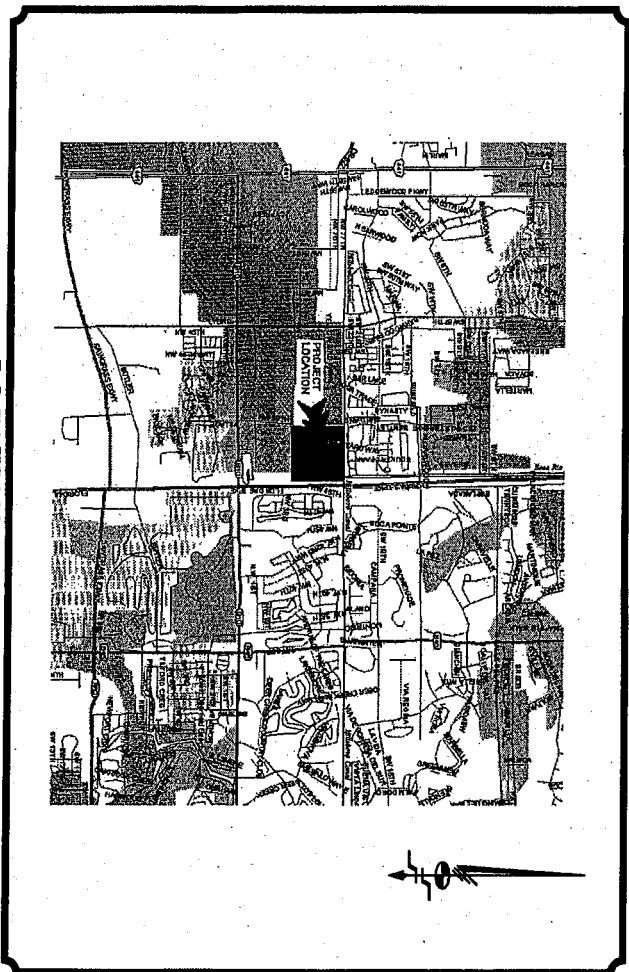

LOCATION MAP
N.T.S.

Prepared by
SCHWEBKE-SHISKIN & ASSOCIATES, INC.
3240 CORPORATE WAY, MIRAMAR, FL. 33026
LAND PLANNERS - ENGINEERS - ARCHITECTS - LAND SURVEYORS

APR 23 2002
FILE NO. B-1628

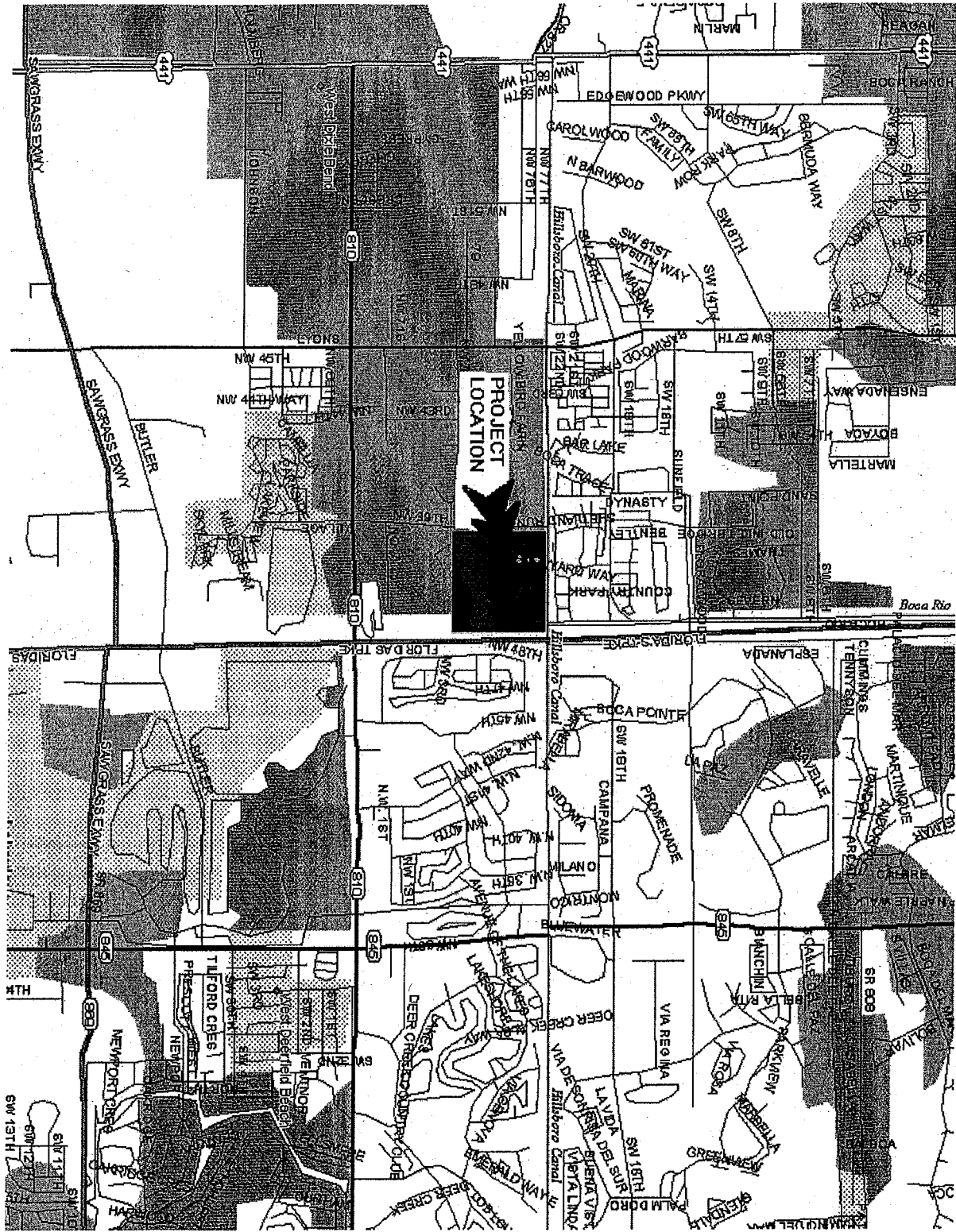

APR 23 2002

NOT: Aerials copies of this drawing will bear the stamp
 seal of the actually Professional Engineer or
 Professional Land Surveyor.

REVISIONS		
Date	Description	By

Adios Golf Club
 VICINITY MAP

COCONUT CREEK, FLORIDA, SEC 32 T14N 47RNG 42

Schwelbe, Shickel & Associates, Inc.
 ENGINEERS
 LAND PLANNERS
 3840 CORPORATE WAY
 MIRAMAR, FLORIDA 33029

ALFONSO C. TELLO
 SEC/TREASURER
 Registered Land Surveyor No. 2878, State of Florida

Drawn By: J.L. Date: 04/18/02 Checked By: A.G.Y. Date: 04/18/02
 Sheet No. 100100 of 100 Scale: N.T.S.
 Plot No. D 1000

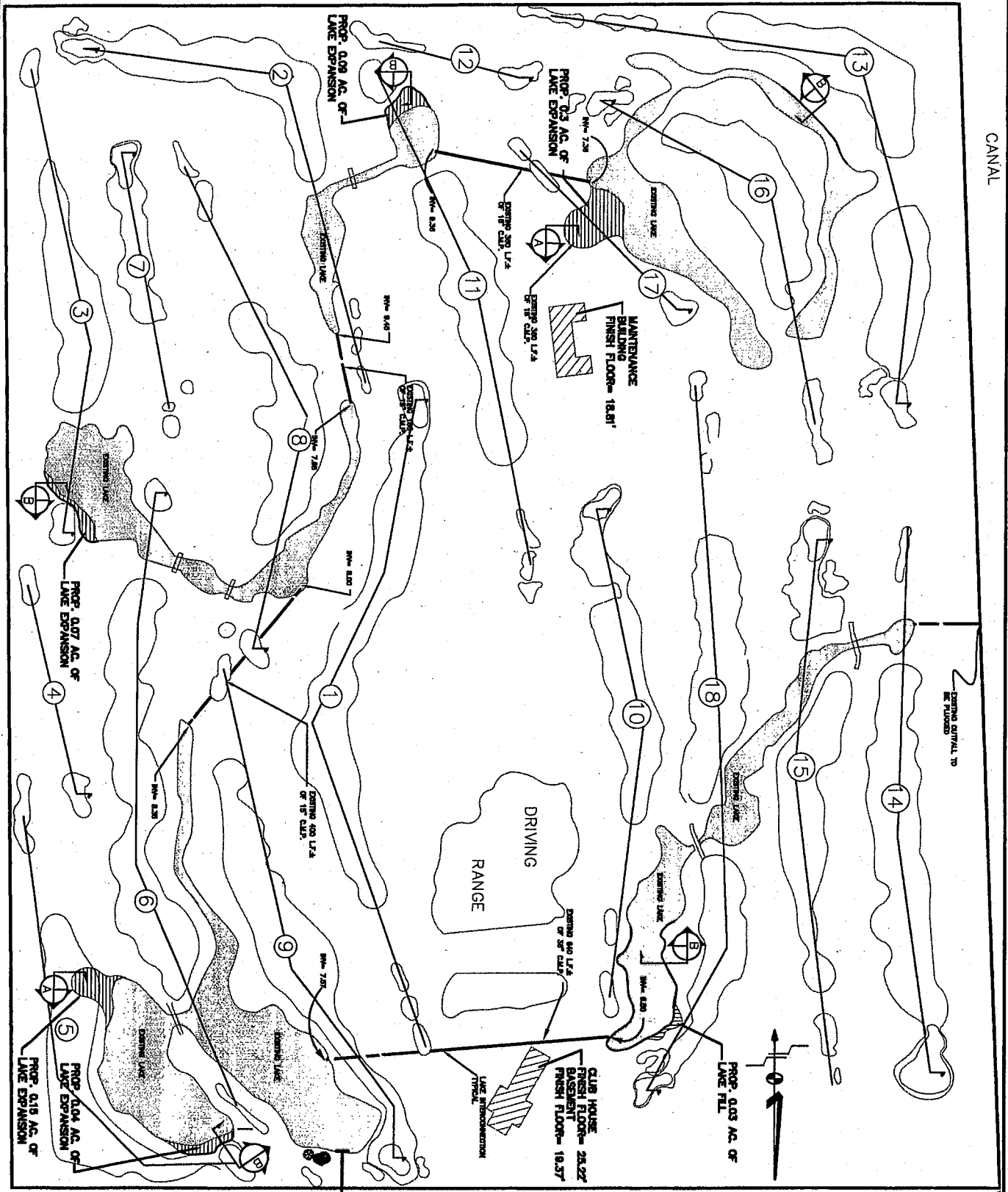

HILLSBORO CANAL

APR 23 2002

NOTE: Subordinate copies of this drawing will bear the initials and of the signing Professional Engineer or Professional Land Surveyor.

Schwabbe, Shickler & Associates, Inc.
 ENGINEERS LAND PLANNERS
 3240 CORPORATE WAY
 MIRAMON, FLORIDA 32025

ALFONSO C. TELLO
 REGISTERED LAND SURVEYOR No. 2518 State of Florida

Drawn By: J.L. Date: 04/18/02 Checked By: A.C.T. Date: 04/18/02
 Order No. 192188 \$11,000.00 Scale: 1" = 100'

REVISIONS	
Date	Remarks

Adios Golf Club
 PROPOSED GOLF COURSE IMPROVEMENTS
 COCONUT CREEK, FLORIDA, SEC 32 TWN 47 RNG 42

K:\3247421\ADSHOW2.DWG

SECTION B-B
TYPICAL BOULDER SECTION
 N.T.S.

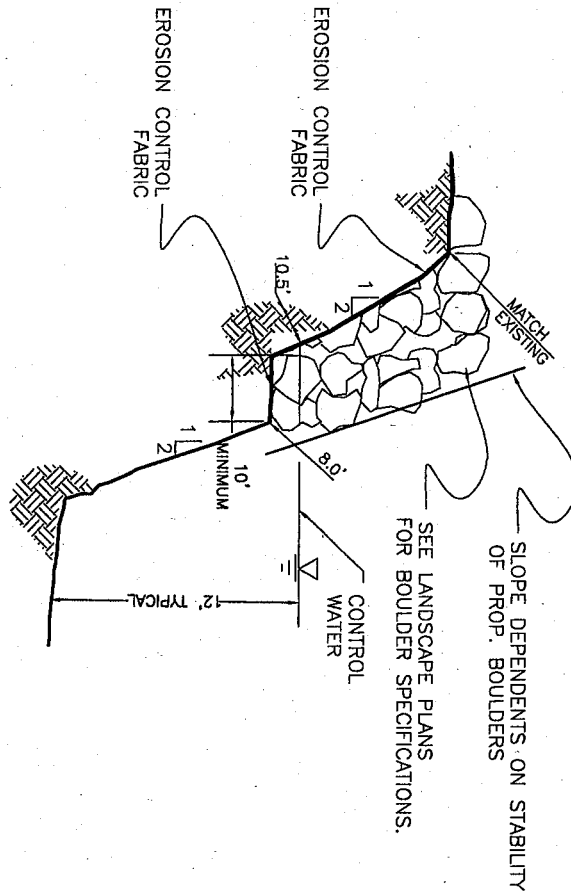

SECTION A-A
TYPICAL LAKE SECTION
 N.T.S.

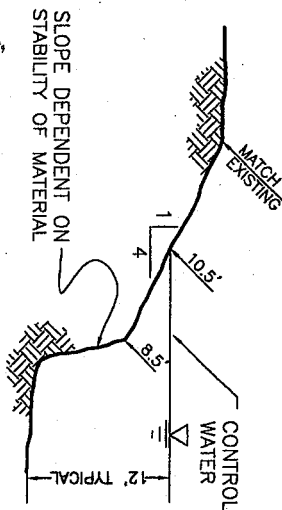

APR 23 2002

NOTE: Accurately copies of this drawing will bear the red seal and of the signing Professional Engineer or Professional Land Surveyor.

REVISIONS		
Date	Remarks	By

Adios Golf Club
 PROPOSED LAKE CROSS SECTIONS
 COCONUT CREEK, FLORIDA, SEC 32 TWN 47 RNG 42

Schwabke Shiskin & Associates, Inc.
 ENGINEERS LAND PLANNERS
 250 CORPORATE WAY MIRAMAR, FLORIDA 33025

Drawn By: T.L. Tello Date: 04/18/02
 Order No. 106180 PR State: N.T.S.

Checked By: A.C.Y. Date: 04/18/02

Registered Land Surveyor No. 2218 State of Florida

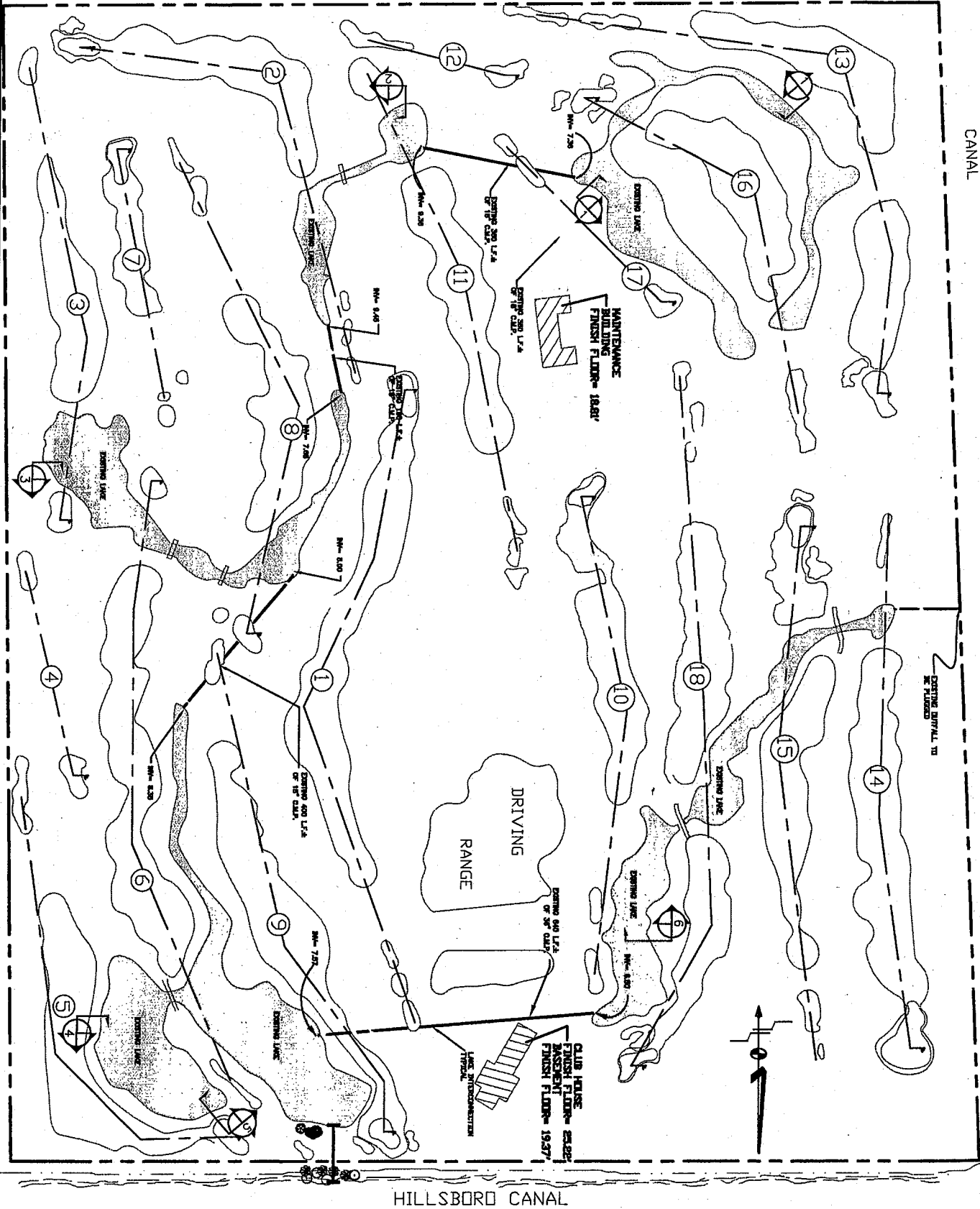

HILLSBORD CANAL

CANAL

APR 23 2002

NOTE: Accurately copies of this drawing will have the red seal of the attending Professional Engineer or Professional Land Surveyor.

Schweitzer Shishin & Associates, Inc.
 LAND PLANNERS ARCHITECTS
 3240 CORPORATE WAY
 MIAMI, FLORIDA 33133

ALFONSO C. YELLO
 REGISTERED LAND SURVEYOR No. 3878 State of Florida

Drawn By: J.L. Date: 04/18/02 Checked By: A.C.T. Date: 04/18/02
 Sheet No. 194120 of 194120 Scale: 1" = 100'

REVISIONS

Date	Remarks	By

Adios Golf Club
 EXISTING SITE PLAN

COCONUT CREEK, FLORIDA, SEC 32 T2N 47 R2G 42

CROSS SECTION #6
N.T.S.

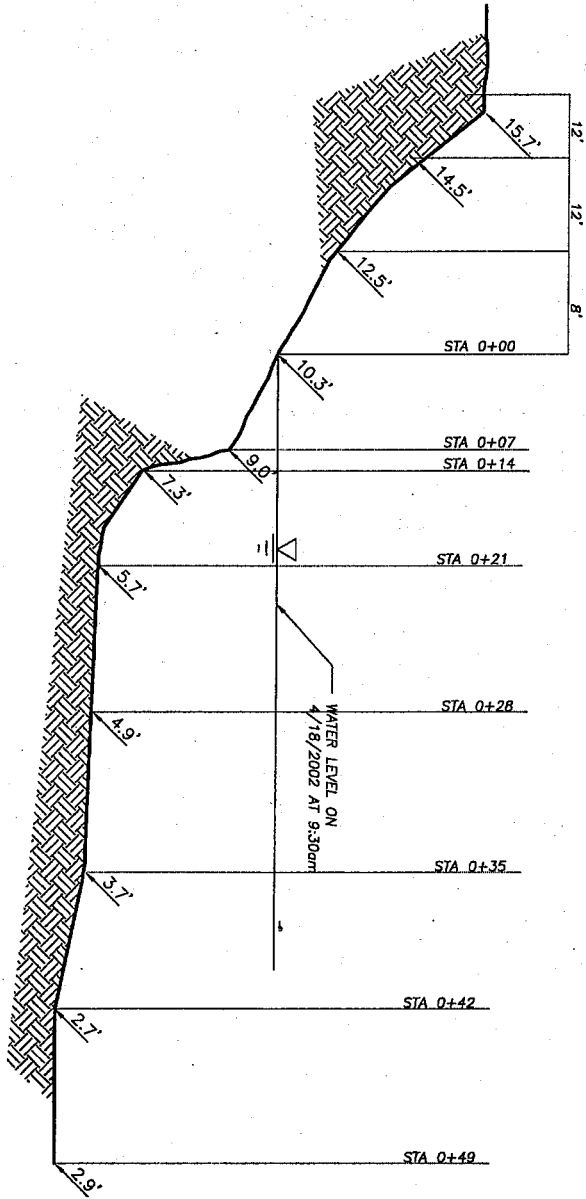

CROSS SECTION #5
N.T.S.

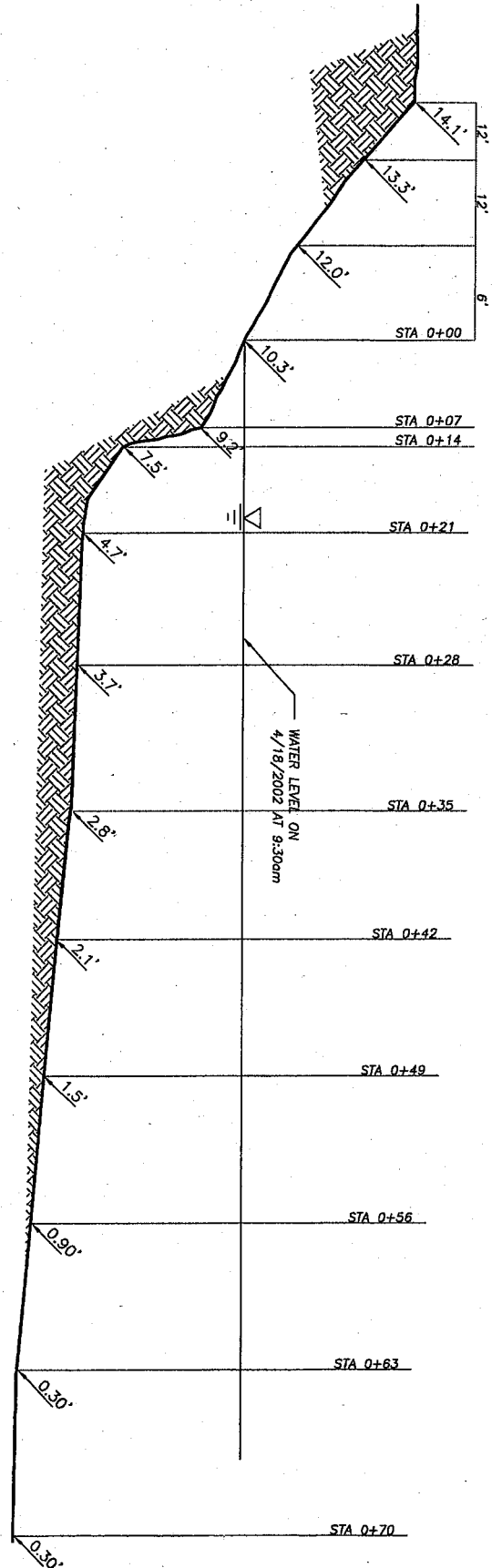

APR 23 2002

NOTE: Accurate copies of this drawing will bear the raised seal of the signing Professional Engineer or Professional Land Surveyor.

REVISIONS		
Date	Remarks	By

Adios Golf Club
EXISTING LAKE CROSS SECTIONS
COCONUT CREEK, FLORIDA, SEC 32 TWN 47 RNG 42

Schwabbe Shikha & Associates, Inc.
LAND PLANNERS ENGINEERS LAND PLANNERS
3240 CORPORATE WAY MIKAMAR, FLORIDA 33026

Drawn By: J.L. Date: 04/18/02 Checked By: A.C.T. Date: 04/18/02
 ALFONSO C. TRINIDAD SEC./TREASURER
 Drawing No. 100130 Date: 04/18/02 Scale: N.T.S.