

SITE STATS (per Proposed Conditions)

SITE AREA: 137,201 SF = 3.14 Acres

GREEN AREA: 34,554 S.F. = 25.2% of Site Area
IMPERVIOUS AREA: 86,380 S.F. = 62.95% of Site Area
 Asphalt Areas, Conc Walks, Stairs, Stoops, Pads & Screen Walls
BLDG LOT COVERAGE: 18,267 S.F. = 11.85% of Site Area

PARKING STATS (per Proposed Conditions)

TOTAL BUILDING AREA: 31,926 SQ FT
 (Increase of 233 sf for Covered Entries along North and East Elevations)
TOTAL PKING REQD (1/300): 107 Spaces (including 5 HC stalls)
TOTAL PARKING PROVIDED : 178 Spaces (including 6 HC stalls)

**TECHNOLOGICAL
 UNIVERSITY OF MIAMI**
 3700 COCONUT CREEK PARKWAY
 COCONUT CREEK, FLORIDA

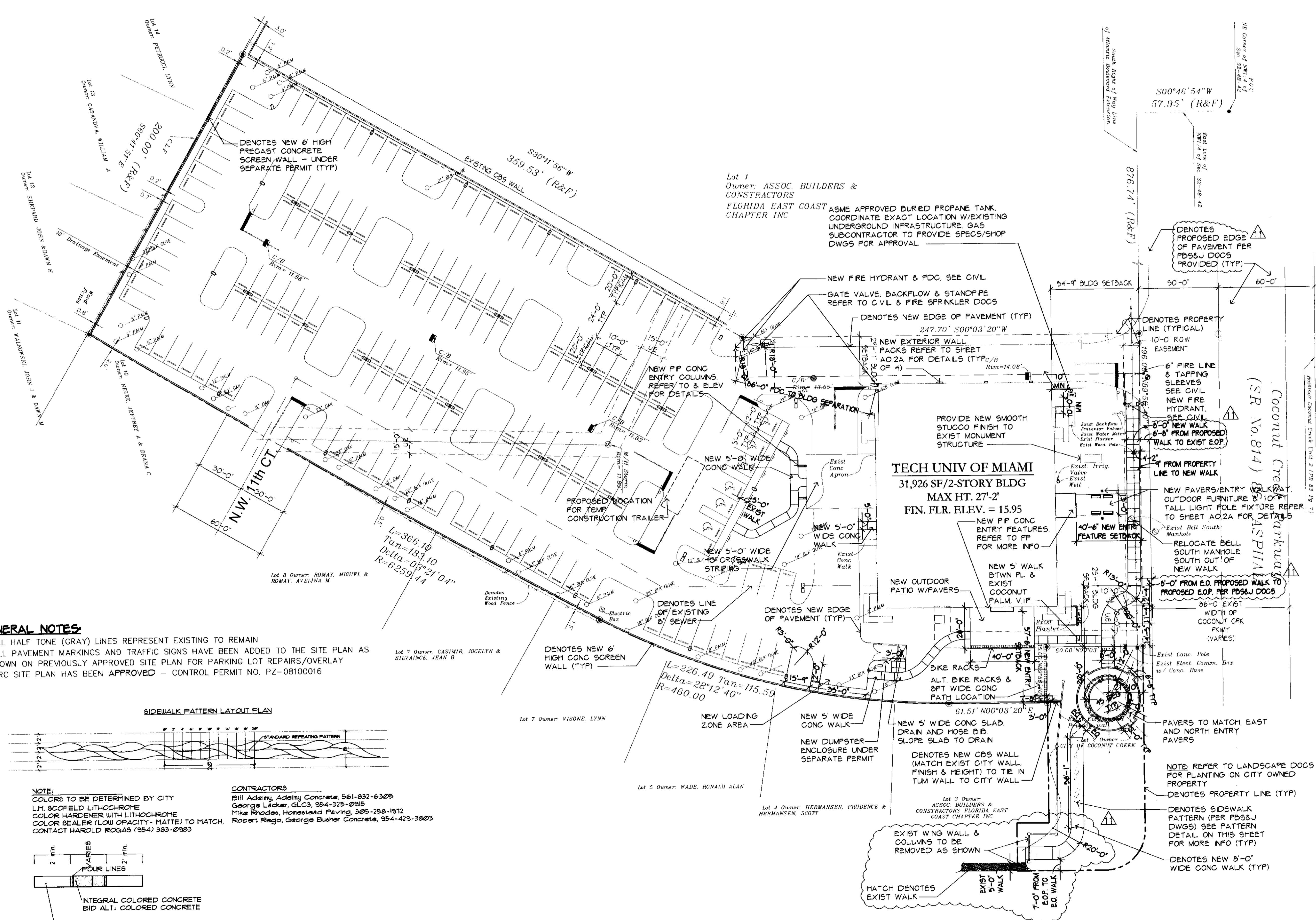

GENERAL NOTES:

- 1) ALL HALF TONE (GRAY) LINES REPRESENT EXISTING TO REMAIN
- 2) ALL PAVEMENT MARKINGS AND TRAFFIC SIGNS HAVE BEEN ADDED TO THE SITE PLAN AS SHOWN ON PREVIOUSLY APPROVED SITE PLAN FOR PARKING LOT REPAIRS/OVERLAY
- 3) DRC SITE PLAN HAS BEEN APPROVED - CONTROL PERMIT NO. PZ-08100016

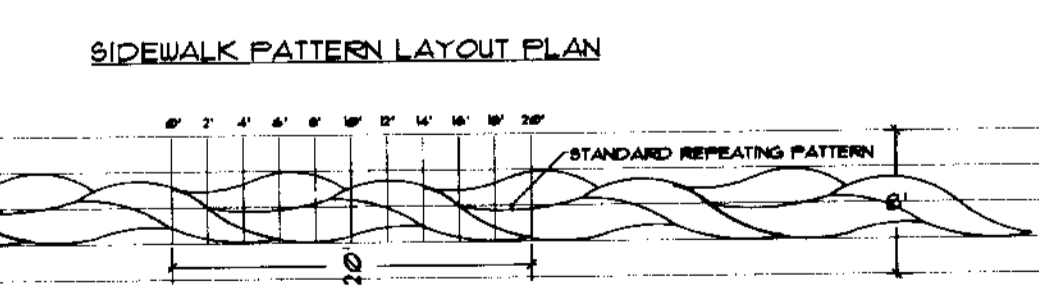

NOTE:
 COLORS TO BE DETERMINED BY CITY
 L.M. SCOFIELD LITHOCHROME
 COLOR HARDENER WITH LITHOCHROME
 COLOR SEALER (LOW OPAQTY - MATTE) TO MATCH.
 CONTACT HAROLD ROGAS (954) 383-0983

CONTRACTORS
 Bill Adams, Adams Concrete, 561-832-6305
 George Lacker, GLC3, 954-325-0915
 Mike Rhodes, Homestead Paving, 305-298-1912
 Robert Rego, George Euker Concrete, 954-423-3803

FOUR LINES
 INTEGRAL COLORED CONCRETE
 BID ALT. COLORED CONCRETE
 POURED CONCRETE SIDEWALK

2010-07-07-GENERAL REVS
2010-06-04-CLIENT REVS
2010-01-12-GENERAL REVISION
2009-07-20-ENG COMMENT
2009-05-18-BLDG DEPT COMMENT
2009-03-18-BLDG DEPT COMMENT
2009-01-22-GENERAL REVISION

ALL DRAWINGS, SPECIFICATIONS AND RELATED DOCUMENTS ARE THE COPYRIGHT PROPERTY OF THE ARCHITECT AND MUST BE RETURNED UPON REQUEST. REPRODUCTION OF DRAWINGS, SPECIFICATIONS AND RELATED DOCUMENTS IN PART OR WHOLE IS FORBIDDEN WITHOUT THE ARCHITECT'S WRITTEN PERMISSION.

CONTRACTOR MUST CHECK AND VERIFY ALL DIMENSIONS

HNM ARCHITECTURE
 3705 NORTH FEDERAL HIGHWAY
 DELRAY BEACH, FLORIDA 33483
 T: 561-753-2215 F: 561-753-2583
 INFO@HNM-ARCHITECTURE.COM

ISSUED DATE: 2009-01-12
 DATE PRINTED: 2010-07-07
 SCALE: 1" = 30'-0"

DRAWN BY: MWH
 CHECKED BY: MWH
 HNM PROJECT NO.: 08-012

SITE PLAN

A-0.2