

COCONUT CREEK PARKWAY

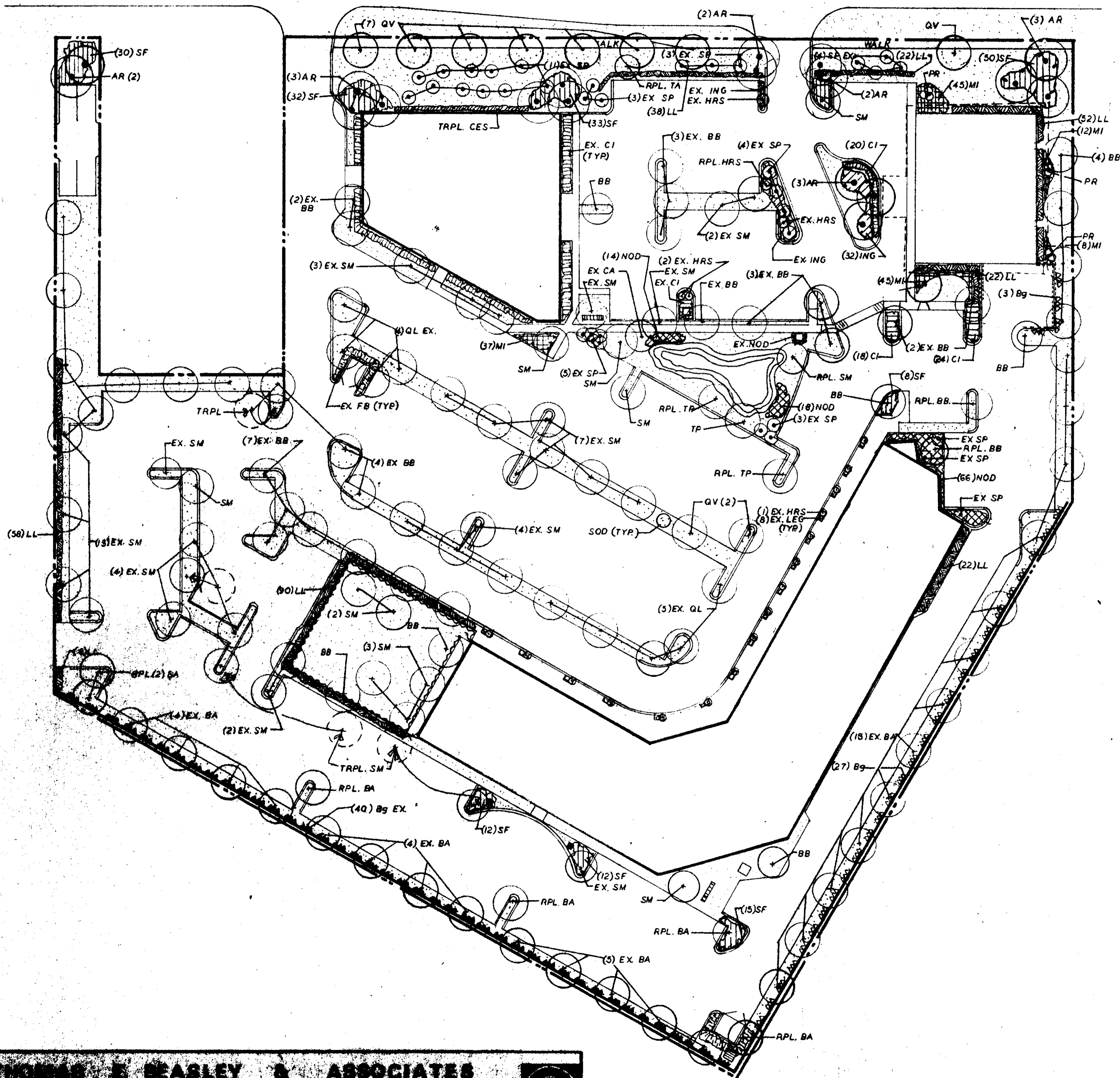

NO.	SYM.	PLANTING SPECIES	PLANTING NAME	PLANTING QUANTITY
1	AR	Ardisia cuneata	Orange Red	18" - 24" o.a.
2	BB	Banksia laevis	Orange	18" - 24" o.a.
3	CI	Chrysanthemum	Orange	18" - 24" o.a.
4	EX. SP	Exochorda	Orange	18" - 24" o.a.
5	EX. SM	Exochorda	Orange	18" - 24" o.a.
6	EX. HRS	Exochorda	Orange	18" - 24" o.a.
7	EX. CA	Exochorda	Orange	18" - 24" o.a.
8	EX. NOD	Exochorda	Orange	18" - 24" o.a.
9	EX. LEG	Exochorda	Orange	18" - 24" o.a.
10	EX. QL	Exochorda	Orange	18" - 24" o.a.
11	EX. SM	Exochorda	Orange	18" - 24" o.a.
12	EX. SM	Exochorda	Orange	18" - 24" o.a.
13	EX. SM	Exochorda	Orange	18" - 24" o.a.
14	EX. SM	Exochorda	Orange	18" - 24" o.a.
15	EX. SM	Exochorda	Orange	18" - 24" o.a.
16	EX. SM	Exochorda	Orange	18" - 24" o.a.
17	EX. SM	Exochorda	Orange	18" - 24" o.a.
18	EX. SM	Exochorda	Orange	18" - 24" o.a.
19	EX. SM	Exochorda	Orange	18" - 24" o.a.
20	EX. SM	Exochorda	Orange	18" - 24" o.a.
21	EX. SM	Exochorda	Orange	18" - 24" o.a.
22	EX. SM	Exochorda	Orange	18" - 24" o.a.
23	EX. SM	Exochorda	Orange	18" - 24" o.a.
24	EX. SM	Exochorda	Orange	18" - 24" o.a.
25	EX. SM	Exochorda	Orange	18" - 24" o.a.
26	EX. SM	Exochorda	Orange	18" - 24" o.a.
27	EX. SM	Exochorda	Orange	18" - 24" o.a.
28	EX. SM	Exochorda	Orange	18" - 24" o.a.
29	EX. SM	Exochorda	Orange	18" - 24" o.a.
30	EX. SM	Exochorda	Orange	18" - 24" o.a.

NO.	SYM.	PLANTING SPECIES	PLANTING NAME	PLANTING QUANTITY
1	TA	Tabebuia argentea	Yellow Trumpet Tree	REPLACE (18")
2	TP	Tabebuia pallida	Pink Trumpet Tree	REPLACE (18")
3	BA	Banksia laevis	Orange	REPLACE (18" - 24")
4	CI	Chrysanthemum	Orange	REPLACE (18" - 24")
5	EX. SP	Exochorda	Orange	REPLACE (18" - 24")
6	EX. SM	Exochorda	Orange	REPLACE (18" - 24")
7	EX. HRS	Exochorda	Orange	REPLACE (18" - 24")
8	EX. CA	Exochorda	Orange	REPLACE (18" - 24")
9	EX. NOD	Exochorda	Orange	REPLACE (18" - 24")
10	EX. LEG	Exochorda	Orange	REPLACE (18" - 24")
11	EX. QL	Exochorda	Orange	REPLACE (18" - 24")
12	EX. SM	Exochorda	Orange	REPLACE (18" - 24")
13	EX. SM	Exochorda	Orange	REPLACE (18" - 24")
14	EX. SM	Exochorda	Orange	REPLACE (18" - 24")
15	EX. SM	Exochorda	Orange	REPLACE (18" - 24")
16	EX. SM	Exochorda	Orange	REPLACE (18" - 24")
17	EX. SM	Exochorda	Orange	REPLACE (18" - 24")
18	EX. SM	Exochorda	Orange	REPLACE (18" - 24")
19	EX. SM	Exochorda	Orange	REPLACE (18" - 24")
20	EX. SM	Exochorda	Orange	REPLACE (18" - 24")
21	EX. SM	Exochorda	Orange	REPLACE (18" - 24")
22	EX. SM	Exochorda	Orange	REPLACE (18" - 24")
23	EX. SM	Exochorda	Orange	REPLACE (18" - 24")
24	EX. SM	Exochorda	Orange	REPLACE (18" - 24")
25	EX. SM	Exochorda	Orange	REPLACE (18" - 24")
26	EX. SM	Exochorda	Orange	REPLACE (18" - 24")
27	EX. SM	Exochorda	Orange	REPLACE (18" - 24")
28	EX. SM	Exochorda	Orange	REPLACE (18" - 24")
29	EX. SM	Exochorda	Orange	REPLACE (18" - 24")
30	EX. SM	Exochorda	Orange	REPLACE (18" - 24")

NO.	SYM.	PLANTING SPECIES	PLANTING NAME	PLANTING QUANTITY
10	OV	Quercus virginiana	Live Oak	18" - 24" 4' - 5'
11	AR	Ardisia cuneata	Orange Red	18" - 24" o.a.
12	BB	Banksia laevis	Orange	18" - 24" o.a.
13	CI	Chrysanthemum	Orange	18" - 24" o.a.
14	EX. SP	Exochorda	Orange	18" - 24" o.a.
15	EX. SM	Exochorda	Orange	18" - 24" o.a.
16	EX. HRS	Exochorda	Orange	18" - 24" o.a.
17	EX. CA	Exochorda	Orange	18" - 24" o.a.
18	EX. NOD	Exochorda	Orange	18" - 24" o.a.
19	EX. LEG	Exochorda	Orange	18" - 24" o.a.
20	EX. QL	Exochorda	Orange	18" - 24" o.a.
21	EX. SM	Exochorda	Orange	18" - 24" o.a.
22	EX. SM	Exochorda	Orange	18" - 24" o.a.
23	EX. SM	Exochorda	Orange	18" - 24" o.a.
24	EX. SM	Exochorda	Orange	18" - 24" o.a.
25	EX. SM	Exochorda	Orange	18" - 24" o.a.
26	EX. SM	Exochorda	Orange	18" - 24" o.a.
27	EX. SM	Exochorda	Orange	18" - 24" o.a.
28	EX. SM	Exochorda	Orange	18" - 24" o.a.
29	EX. SM	Exochorda	Orange	18" - 24" o.a.
30	EX. SM	Exochorda	Orange	18" - 24" o.a.

1. ALL PLANT MATERIALS SHALL BE FLORIDA GROWN OR GROWN IN FLORIDA BY CONTRACTORS AS SPECIFIED IN GENERAL AND SPECIFICATIONS, FLORIDA DEPT. OF AGRICULTURE, CDB, 1988.
2. ALL PLANT MATERIALS SHALL BE DELIVERED TO THE PROJECT SITE BY THE CONTRACTOR AND SHALL BE STORED IN A PROTECTED AREA TO PREVENT DAMAGE.
3. ALL PLANT MATERIALS SHALL BE DELIVERED TO THE PROJECT SITE BY THE CONTRACTOR AND SHALL BE STORED IN A PROTECTED AREA TO PREVENT DAMAGE.
4. ALL PLANT MATERIALS SHALL BE DELIVERED TO THE PROJECT SITE BY THE CONTRACTOR AND SHALL BE STORED IN A PROTECTED AREA TO PREVENT DAMAGE.
5. ALL PLANT MATERIALS SHALL BE DELIVERED TO THE PROJECT SITE BY THE CONTRACTOR AND SHALL BE STORED IN A PROTECTED AREA TO PREVENT DAMAGE.
6. ALL PLANT MATERIALS SHALL BE DELIVERED TO THE PROJECT SITE BY THE CONTRACTOR AND SHALL BE STORED IN A PROTECTED AREA TO PREVENT DAMAGE.
7. ALL PLANT MATERIALS SHALL BE DELIVERED TO THE PROJECT SITE BY THE CONTRACTOR AND SHALL BE STORED IN A PROTECTED AREA TO PREVENT DAMAGE.
8. ALL PLANT MATERIALS SHALL BE DELIVERED TO THE PROJECT SITE BY THE CONTRACTOR AND SHALL BE STORED IN A PROTECTED AREA TO PREVENT DAMAGE.
9. ALL PLANT MATERIALS SHALL BE DELIVERED TO THE PROJECT SITE BY THE CONTRACTOR AND SHALL BE STORED IN A PROTECTED AREA TO PREVENT DAMAGE.
10. ALL PLANT MATERIALS SHALL BE DELIVERED TO THE PROJECT SITE BY THE CONTRACTOR AND SHALL BE STORED IN A PROTECTED AREA TO PREVENT DAMAGE.

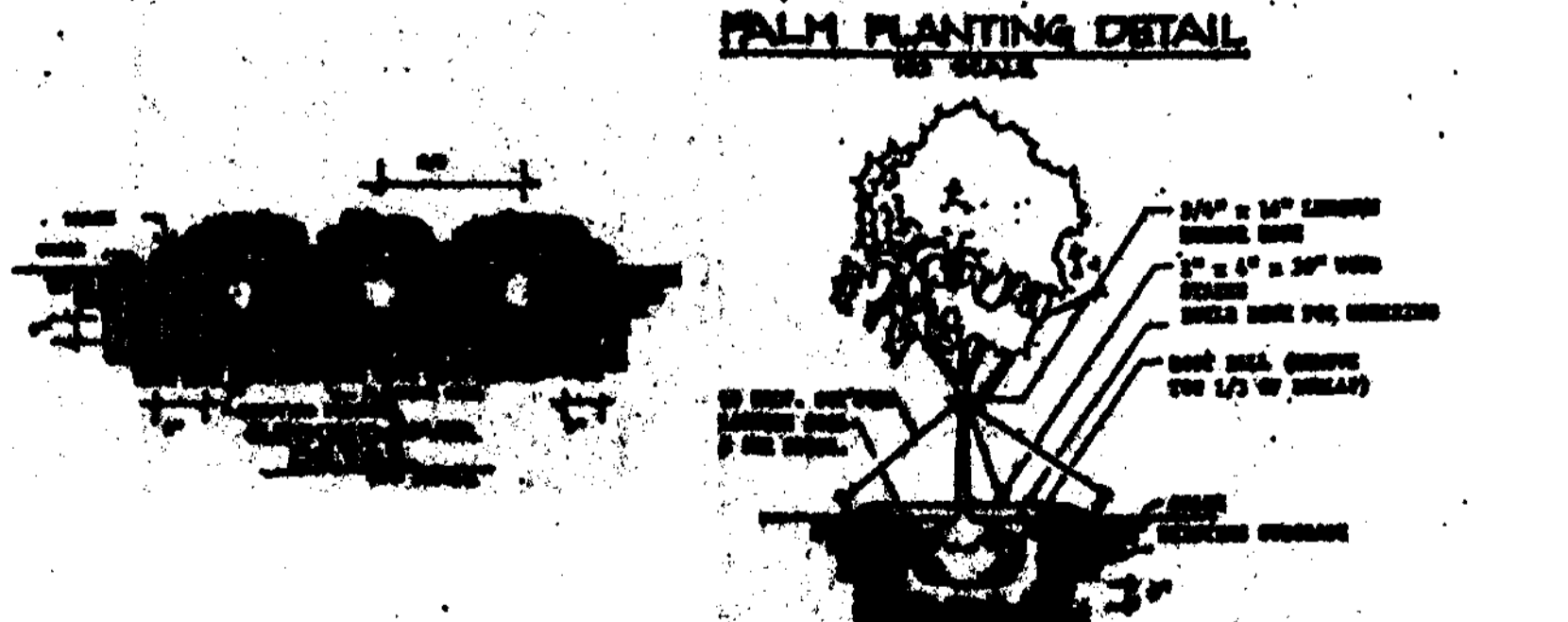

THOMAS & BEASLEY & ASSOCIATES
 LANDSCAPE ARCHITECTS & PLANNERS
 100 N. MIAMI BLVD., SUITE 1000, MIAMI, FLORIDA 33130
 1000 N. WINDYWAY AVE., GAITHERSBURG, MARYLAND 20878

LANDSCAPE PLAN

Handwritten signature: *Thomas & Beasley*

N (North arrow symbol)

REVISIONS	BY
1-23-88	COMBATS D.R.C.

WIN CREEK CENTER
COCONUT CREEK PARKWAY
COCONUT CREEK, BROWARD COUNTY, FLORIDA

DRAWN: T & B
 CHECKED: T & B
 DATE: 1-30-88
 SCALE: 1"=30'-0"
 JOB NO: C-71955
 SHEET: LR-1
 OF THREE SHEETS