

COCONUT CREEK PARKWAY

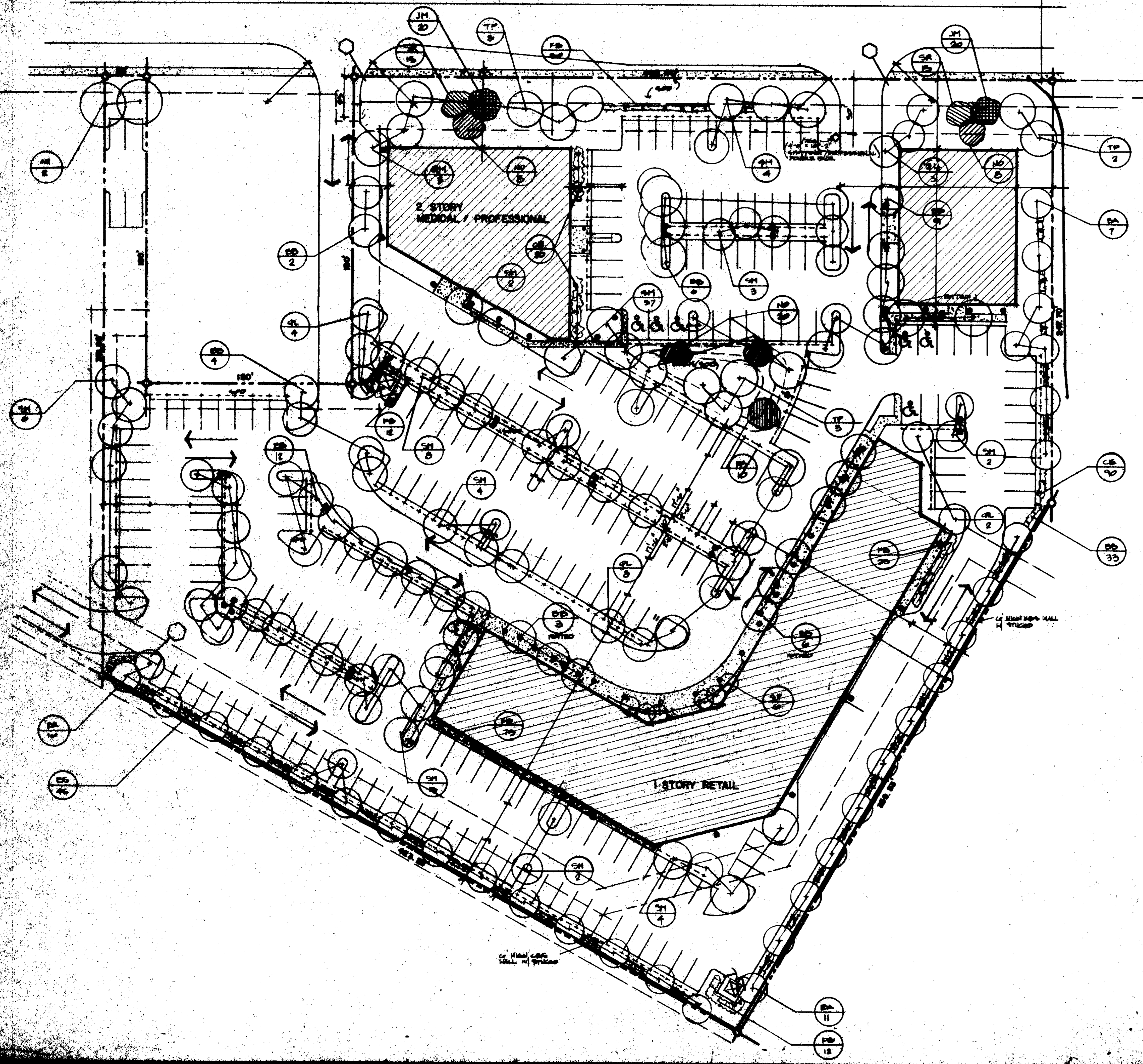

PLANT MATERIAL

CODE	COMMON NAME	BOTANICAL NAME	#	SIZE AT PLANTING
SM	Mahogany	Swietenia Mahogany	60	12'H 6'apr. 6'ct.
NB	Black Olive	Bucida Buceras	42	12'H 6'apr. 6'ct.
QL	Laurel Oak	Quercus Laurifolia	17	12'H 6'apr. 6'ct.
SF	Cabbage Palm	Sabal Palmetto	9	
TP	Pink Tabebuia	Tabebuia Pallida	5	12'H 6'apr. 6'ct.
AR	Queen Palm	Aracostrium Komarovianum	11	
BA	Umbrella Tree	Braeselia Actinophylla	34	
CE	Silver Buttonbush	Conocarpis Erectus	110	3'H
ES	Hibiscus	Hoes Sinensis	10	6'H
JM	Downy Jasmine	Jasminum Multiflorum	46	N/A
NO	Dwarf Oleander	Nerium Oleander	36	3'H
FB	Benjamin Fig	Ficus Benusa	174	3'H
SR	Bird of Paradise	Strelitzia Reginae	30	N/A
SOD	St. Augustine	Stenotaphrum Floratum		
BS	Bougainvillea	Bougainvillea Spectabilis	78	10' st.

ALL NEW LANDSCAPING AREA TO HAVE AUTOMATIC IRRIGATION SYSTEM.

1. All landscaping and plant material shall comply with Land Development Code #307.0509 A, B & C; Installation, maintenance and materials.
2. All landscaping at project entrance shall comply with Land Development Code #307.0503; sight distance for landscaping adjacent to public right-of-way and points of access.
3. The plant list is subject to change based on availability but all plant material to be used shall comply with Land Development Code #307.0504; minimum landscape requirements for zoning districts.
4. Site irrigation shall be supplied and maintained according to Land Development Code #307.0509 B; Maintenance.
5. All site lighting for parking areas, driveways, building areas and walkways shall be provided according to Land Development Code #307.0502; Lighting; general requirements.

Contractor to verify all existing site conditions and thoroughly check elevations and dimensions before commencing work. Report to the architect engineer any discrepancies, errors or conditions that will alter construction as intended by these drawings. Architect is not responsible for any work or materials furnished on the job.

WYN CENTER

LANDSCAPE PLAN

Contractor to verify all existing site conditions and thoroughly check elevations and dimensions before commencing work. Report to the architect engineer any discrepancies, errors or conditions that will alter construction as intended by these drawings. Architect is not responsible for any work or materials furnished on the job.

DATE	BY	REVISION

1" = 30'-0"