

Cotleur & Hearing

Landscape Architects
Land Planners
Environmental Consultants
1934 Commerce Lane
Suite 1
Jupiter, Florida 33458
561.747.6336 · Fax 747.1377
www.cotleurhearing.com
Lic# LC-C000239

CLARITY POINTE

Coconut Creek, Florida

NAME: UHAUL
FLU: IND
ZONING: PCD
FOLIO NUMBER: 484206440010

NAME: CARL'S FURNITURE PLAZA
FLU: COM
ZONING: PCD
FOLIO NUMBER: 4842060130010

NAME: EL RAÑCHO
MOBILE HOME PARK
FLU: LM-10
ZONING: MH-1
FOLIO NUMBER: 484206010410

NAME: ESPINOSA
SINGLE FAMILY RESIDENTIAL
FLU: LM-10
ZONING: MH-1
FOLIO NUMBER: 484206010413

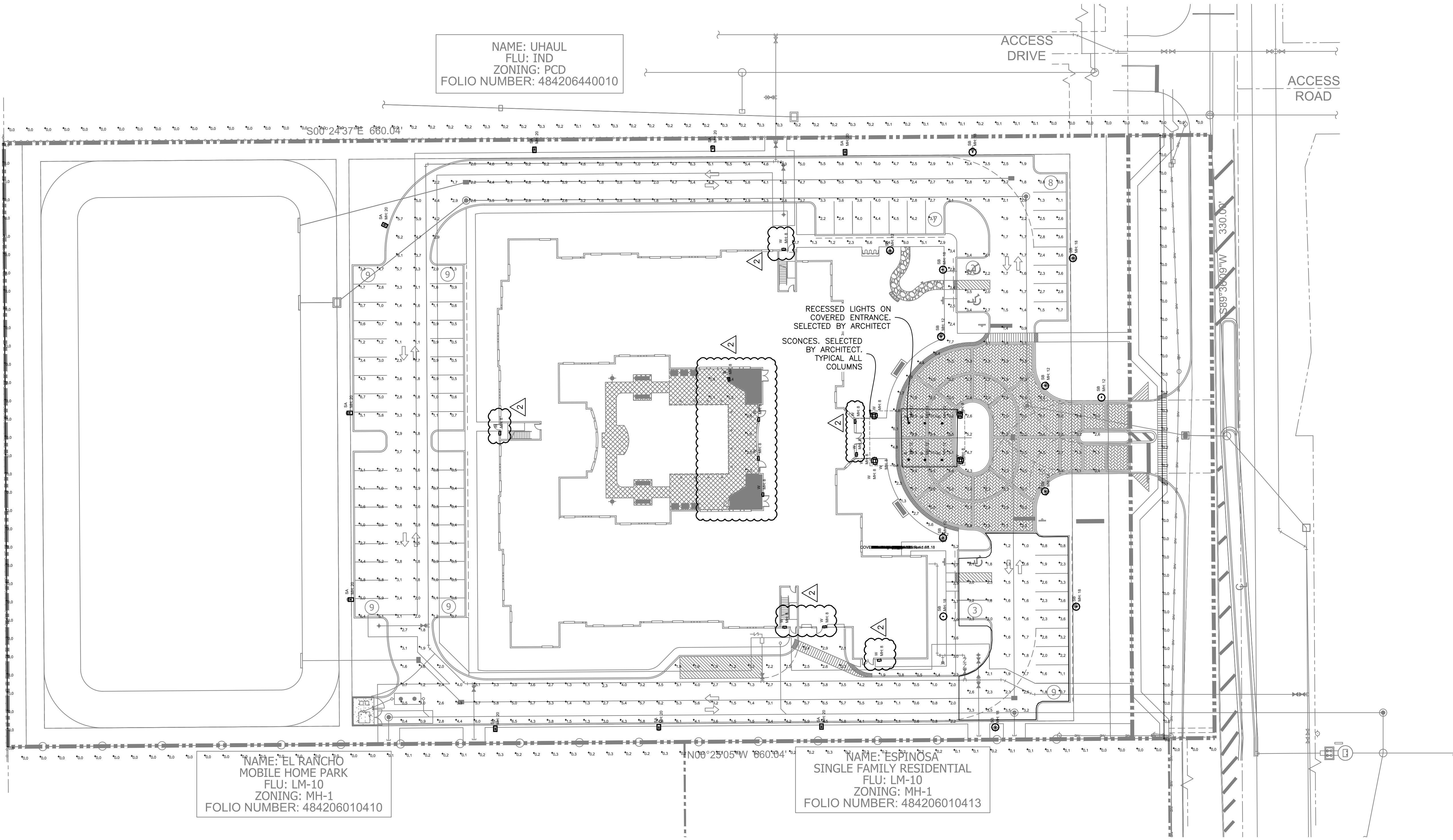

SITE LIGHTING PHOTOMETRIC VALUES

SCALE 1" = 30'-0"

THIS SITE LIGHTING PLAN IS DESIGNED TO MEET THE REQUIREMENTS OF ORDINANCE SECT 13-374 (d) 1 AND 2

DURING DESIGN OF CONSTRUCTION DOCUMENTS, ALL PARKING LIGHT SHALL BE CIRCUITED IN A WAY TO REDUCE LIGHTING LEVEL TO A MAXIMUM OF 1FC AFTER HOURS.

Symbol	Qty	Label	Arrangement	Total Lamp Lumens	LLF	Description	Lum. Watts	Lum. Lumens
○	12	SB	SINGLE	N.A.	0.950	CREE CAT # ARE-EDR-4MB...06 E-UL-525-40K (525mA)	100	6685
○	6	B	SINGLE	N.A.	1.000	RECESSED LIGHT SELECTED BY ARCHITECT	18.9	1274
○	9	SA	SINGLE	N.A.	0.950	CREE CAT # ARE-EDG-4MB...14 E-UL-525-40K (525mA)	229	15463
○	26	W	SINGLE	N.A.	1.000	SCONCE SELECTED BY ARCHITECT	54	2518

Label	CalcType	Units	Avg	Max	Min	Avg/Min	Max/Min
INTERIOR COURTYARD	Illuminance	Fc	1.74	2.6	0.4	4.35	6.50
PARKING - NORTH	Illuminance	Fc	2.45	3.7	0.4	5.43	10.25
PARKING - SOUTHEAST	Illuminance	Fc	2.90	6.3	0.5	5.80	12.60
PARKING - SOUTHWEST	Illuminance	Fc	2.13	3.6	0.7	3.04	5.14
PEDESTRIAN	Illuminance	Fc	3.69	9.0	0.5	7.38	18.00
PROPERTY LINE - EAST	Illuminance	Fc	0.11	0.3	0.0	N.A.	N.A.
PROPERTY LINE - NORTH	Illuminance	Fc	0.60	0.0	0.0	N.A.	N.A.
PROPERTY LINE - SOUTH	Illuminance	Fc	0.04	0.3	0.0	N.A.	N.A.
PROPERTY LINE - WEST	Illuminance	Fc	0.12	0.3	0.0	N.A.	N.A.
SIDE STREET - EAST	Illuminance	Fc	3.76	6.5	0.8	4.70	8.13
SIDE STREET - WEST	Illuminance	Fc	3.05	6.5	0.4	7.63	10.25
COVERED ENTRANCE	Illuminance	Fc	9.18	10.0	3.5	1.08	1.18

LIGHTING COMPLIANCE CHART

TOTAL AREA HARDSCAPE.....58,901
AS PER SEC 13.364 (2) (d) (1) COMMERCIAL PARKING ARE ALLOWED 7.5 LUMENS/SQFT TOTAL ALLOWED : 415,787 LUMENS
TOTAL LUMENS INSTALLED..... 292,499 LUMENS

DESIGNED _____ ES
DRAWN _____ JH
APPROVED _____ ES
JOB NUMBER 15-10206.04
DATE 01-14-16
REVISIONS
2 5.2.16 BLDG. DEPT. COMMENTS

E & C Engineers, Inc.
Cert. of Auth # 26558
2755 Vista Parkway Suite 1-3
West Palm Beach, FL 33411
Tel (561) 712 1149
email: ed@ecengineers.com

Eduardo (Ed) Samour, P.E.
Registered Electrical Engineer
P.E. # 41186
Date 5.2.2016

January 14, 2016 10:11:38 a.m.
Drawing: CLARITY POINTE BASE.DWG

PHM-1
SHEET 1 OF 2
© COTLEUR & HEARING, INC.
These drawings are the property of the architect and are not to be used for extensions or on other projects except by agreement in writing with the architect. Immediately report any discrepancies to the architect.

ARE-EDR-4MB/4MP-R3

Cree Edge™ Round Area Luminaire – Type IV Medium w/ Backlight Control – Spider Mount, Center Tension

Product Description
Slim, low profile design minimizes wind load requirements. Luminaire sides are rugged cast aluminum with integral, weathertight LED driver compartments, spun vented cover and high performance aluminum heat sinks. Post top mounting consists of four precision machined, extruded aluminum arms mounted to weathertight cast lower hub with center tension adaptor and is designed to slip-fit over a 2.375" (60mm) ID to 3" (76mm) O.D. steel or aluminum tenon or pole and secures to tenon with four set screws.

Performance Summary

- Utilizes BetaLED™ Technology
- Patented NanoOptic™ Product Technology
- Made in the U.S.A. and imported parts
- CRI: Minimum 70 CRI
- CCT: 5700K (+/- 500K) Standard, 4000K (+/- 300K)
- Limited Warranty*: 10 years on luminaire / 10 years on Colorfast DeltaGuard™ finish
- EPA and Weight: Reference EPA and Weight spec sheet

Accessories

- Field Installed Accessories
- XA-SRDSPK Bird Spikes

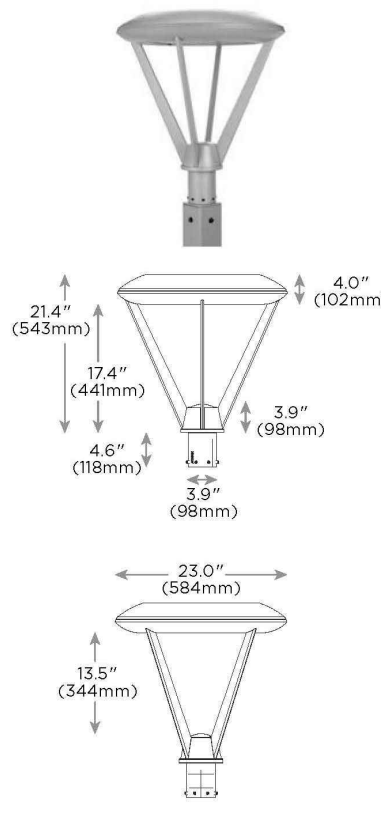

Ordering Information

Example: ARE-EDR-4MB-R3-04-E-UL-SV-350-OPTIONS

ARE-EDR	Optic	Mounting	LED Count (x10)	Series	Voltage	Color Options	Driver Current	Options
ARE-EDR	4MB Type IV Medium w/ ELS 4MP Type IV Medium w/ PFB (EL)	BS Spider Mount, Center Tension	04 06 08 10 12	E Universal	120-277V 120-277V 120-277V 120-277V 120-277V	SF Silver (Standard) BK Black BR Bronze WH White	350mA 350mA 350mA 350mA 350mA	AWK 4000K Color Temperature Color temperature per luminaire SMB D-400 Draining Color temperature per luminaire F RIB Not available with HFC options. Refer to HFC spec sheet for availability with HFC options HFC 4000K Not available with HFC options. Refer to HFC spec sheet for availability with HFC options P Photoacoustic Not available with HFC options. Refer to HFC spec sheet for availability with HFC options TL Two-Level (DS / S2 w/ Integrated Sensor Control) Refer to HFC spec sheet for details TL2 Two-Level (DS / S2 w/ Integrated Sensor Control) Refer to HFC spec sheet for details TL3 Two-Level (DS / S2 w/ Integrated Sensor Control) Refer to HFC spec sheet for details

*See manufacturer's literature for details.
*Consists of multiple 25 LED light bars. 40, 60, 80, and 100 LED with use blanks as needed in place of populated light bars.
*Available on luminaires with 40-100 LEDs.
***Must specify voltage other than 120, 240, or 277.



Rev. Date: 05/24/13



www.cree.com/lighting T (800) 236-6800 F (262) 504-5415

ARE-EDR-4MB/4MP-R3

Product Specifications

CONSTRUCTION & MATERIALS

- Slim, low profile, minimizing wind load requirements
- Luminaire sides are rugged die cast aluminum with integral, weathertight LED driver compartments, spun vented cover and high performance aluminum heat sinks
- Post top mounting consists of four precision machined, extruded aluminum arms mounted to weathertight cast lower hub with center tension adaptor and is designed to slip-fit over a 2.375" (60mm) ID to 3" (76mm) O.D. steel or aluminum tenon or pole and secures to tenon with four set screws
- Exclude Colorfast DeltaGuard™ finish features an E-Coat epoxy primer with an ultra-durable powder topcoat, providing excellent resistance to corrosion, ultraviolet degradation and abrasion. Standard is silver, bronze, black, white, and platinum bronze are also available

ELECTRICAL SYSTEM

- Input Voltage: 120-277V or 347-480V, 50 / 60Hz, Class 1 drivers
- Power Factor: > 0.9 at full load
- Total Harmonic Distortion: < 20% at full load
- Integral weathertight electrical box with terminal strips (20ga-20ga) for easy cover hookup
- Integral 1KV surge suppression protection standard
- To address inrush current, slow blow fuse or type C / D breaker should be used

REGULATORY & VOLUNTARY QUALIFICATIONS

- UL Listed
- Substantially meet locations
- Enclosure rated IP66 per IEC 60529 when ordered without or option
- Consult factory for CE Certified products
- 1KV surge suppression protection tested in accordance with IEEE / ANSI C82.42
- Luminaire and finish endurance tested to withstand 5000 hours of simulated ambient salt fog conditions as defined in ASTM Standard D 137
- Product qualified on the DesignLights Consortium™ (DLC) Qualified Products List ("QPL") when ordered without full backlight control shield
- Meets Buy American requirements within ABMA

Photometry
All published Luminaire photometric testing performed to IESNA LM-79-09 standards by a NVLAP certified laboratory.

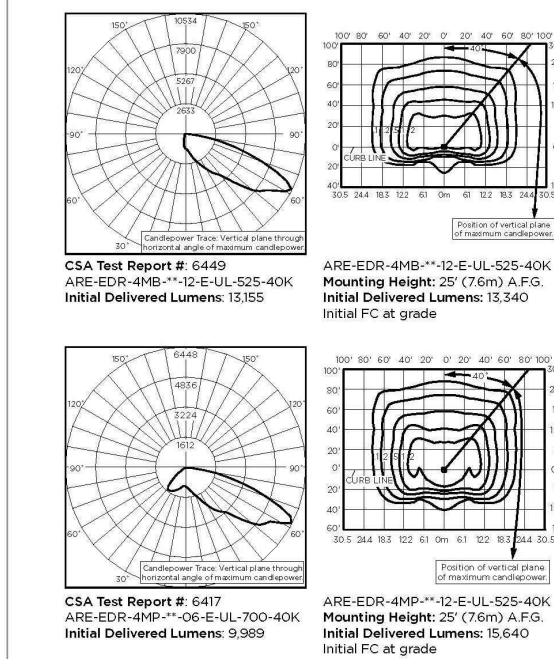

IES File: <http://www.cree.com/lighting/tech-and-support/Reference-configuration-foot>

Lumen Output, Electrical, and Lumen Maintenance Data

LED Qty	100W CABINET													SMA Non-Photoacoustic (Referenced to S-CIR 777)	
	100W	100W	100W	100W	100W	100W	100W	100W	100W	100W	100W	100W	100W		
40	1500	1500	1500	1500	1500	1500	1500	1500	1500	1500	1500	1500	1500	1500	90%
60	2250	2250	2250	2250	2250	2250	2250	2250	2250	2250	2250	2250	2250	2250	92%
80	3000	3000	3000	3000	3000	3000	3000	3000	3000	3000	3000	3000	3000	3000	90%

© 2013 Cree, Inc. All rights reserved. For informational purposes only. Content is subject to change. See www.cree.com/products for details that cover latest products. Cree, the Cree logo, BetaLED, NanoOptic, the BetaLED Technology logo, and Colorfast DeltaGuard are registered trademarks, and Cree Edge™ is a trademark of Cree, Inc. The UL logo is a registered trademark of UL LLC, DesignLights Consortium™ and the DLC QPL logo are trademarks of Northeast Energy Efficiency Partnerships, Inc. www.cree.com/lighting T (800) 236-6800 F (262) 504-5415

Cree Edge™ Series

LED Area/Flood Luminaire

Product Description
The Cree Edge Series has a slim, low profile design. Its rugged cast aluminum housing minimizes wind load requirements and features an integral, weathertight LED driver compartment and high performance aluminum heat sinks. Various mounting choices: Adjustable Arm, Direct Arm, Direct Arm Long, Splice or Side Arm (details on page 2). Includes a half-flood/guard.
Applications: Parking lots, walkways, campuses, car dealerships, office complexes, and internal roadways

Performance Summary

- Utilizes BetaLED™ Technology
- Patented NanoOptic™ Product Technology
- Made in the U.S.A. and imported parts
- CRI: Minimum 70 CRI
- CCT: 4000K (+/- 300K), 5700K (+/- 500K) standard
- Limited Warranty*: 10 years on luminaire/10 years on Colorfast DeltaGuard™ finish

Accessories

- Field Installed
- Backlight Control Shields
- Wired stainless steel
- Wired stainless steel

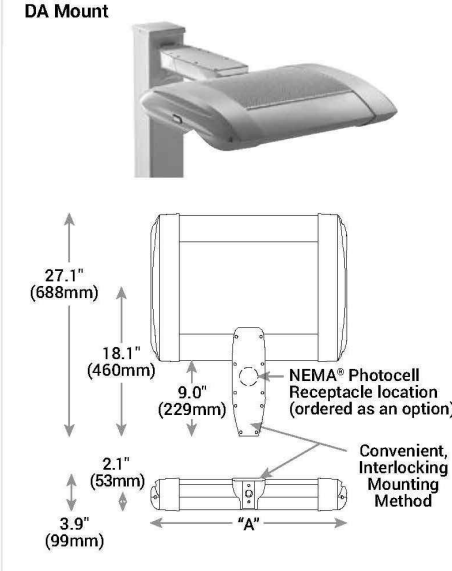

LED Count (x10)	Dim. "X"	Weight
02	12.1" (307mm)	21 lb. (10kg)
04	12.1" (307mm)	24 lb. (11kg)
06	14.1" (357mm)	27 lb. (12kg)
08	16.1" (407mm)	28 lb. (13kg)
10	18.1" (457mm)	32 lb. (15kg)
12	20.1" (510mm)	34 lb. (15kg)
14	22.1" (560mm)	37 lb. (17kg)
16	24.1" (610mm)	41 lb. (19kg)
20	28.1" (710mm)	43 lb. (20kg)
24	32.1" (810mm)	48 lb. (22kg)

Ordering Information

Example: ARE-EDG-2M-AA-12-E-UL-SV-350

Product	Optic	Mounting	LED Count (x10)	Series	Voltage	Color Options	Driver Current	Options
ARE-EDG	15 Type I Short	AM Adjustable Arm	02	E	120-277V	BK	350mA	AWK 4000K Color Temperature Color temperature per luminaire SMB D-400 Draining Color temperature per luminaire F RIB Not available with HFC options. Refer to HFC spec sheet for availability with HFC options HFC 4000K Not available with HFC options. Refer to HFC spec sheet for availability with HFC options P Photoacoustic Not available with HFC options. Refer to HFC spec sheet for availability with HFC options TL Two-Level (DS / S2 w/ Integrated Sensor Control) Refer to HFC spec sheet for details TL2 Two-Level (DS / S2 w/ Integrated Sensor Control) Refer to HFC spec sheet for details TL3 Two-Level (DS / S2 w/ Integrated Sensor Control) Refer to HFC spec sheet for details

© 2013 Cree, Inc. All rights reserved. For informational purposes only. Content is subject to change. See www.cree.com/products for details that cover latest products. Cree, the Cree logo, BetaLED, NanoOptic, the BetaLED Technology logo, and Colorfast DeltaGuard are registered trademarks, and Cree Edge™ is a trademark of Cree, Inc. The UL logo is a registered trademark of UL LLC, DesignLights Consortium™ and the DLC QPL logo are trademarks of Northeast Energy Efficiency Partnerships, Inc. www.cree.com/lighting T (800) 236-6800 F (262) 504-5415

FIXTURE TYPE "SB" POST TOP MOUNTED AT 12' AND 18' A.F.F.

FIXTURE TYPE "SA" MOUNTED AT 20' A.F.F.

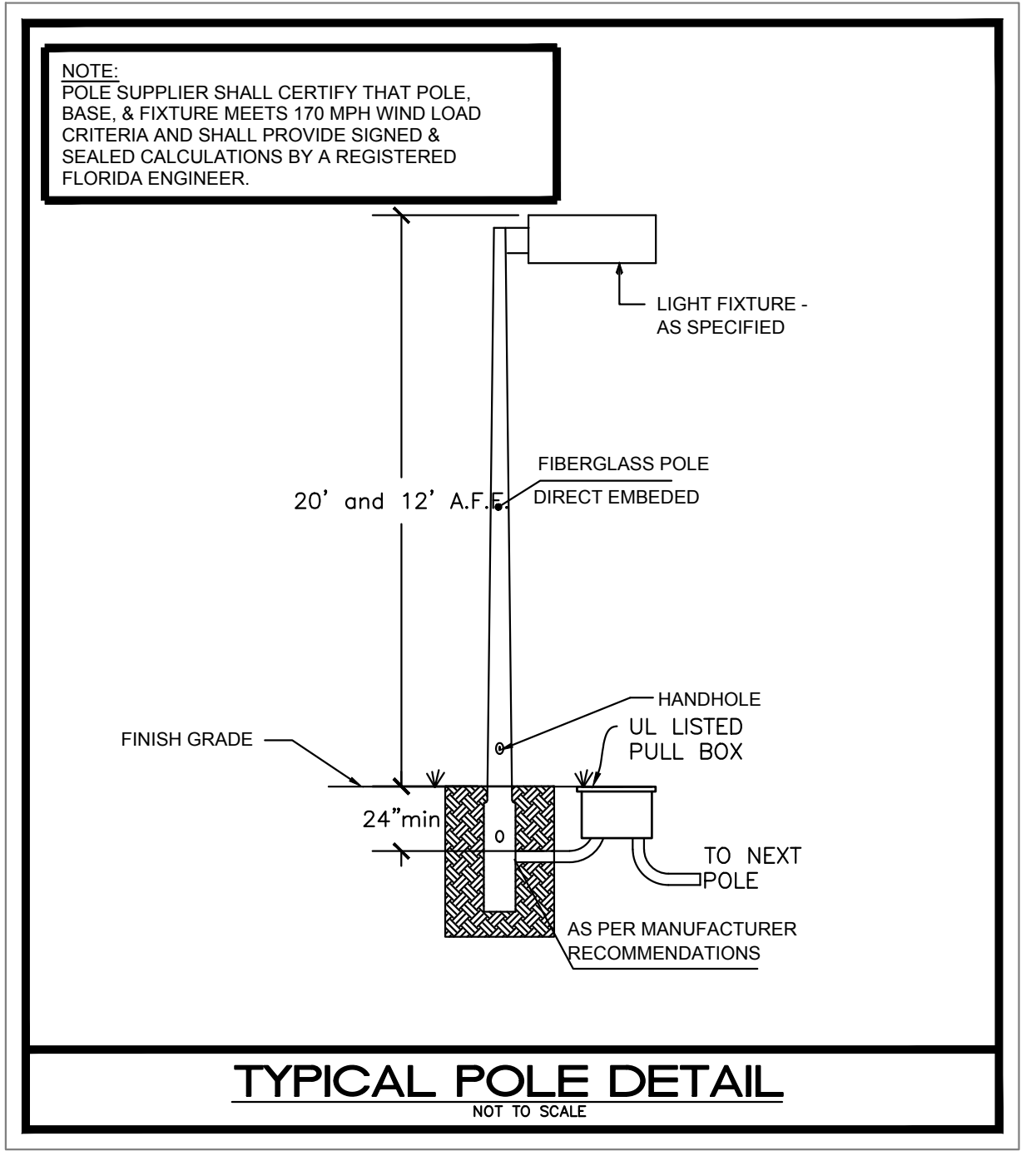

E & C Engineers, Inc.
Cert. of Auth # 26558
2755 Vista Parkway Suite 1-3
West Palm Beach, FL 33411
Tel (561) 712 1149
email: ec@ecengineers.com

No. 41186

STATE OF FLORIDA
PROFESSIONAL ENGINEER

Eduardo (Ed) Samour, P.E.
Registered Electrical Engineer
P.E. # 41186
Date: 5.2.2016

Cotleur & Hearing
Landscape Architects
Land Planners
Environmental Consultants
1934 Commerce Lane
Suite 1
Jupiter, Florida 33458
561.747.6336 · Fax 747.1377
www.cotleurhearing.com
Lic# LC-C000239

CLARITY POINTE
Coconut Creek, Florida

DESIGNED	ES
DRAWN	JH
APPROVED	ES
JOB NUMBER	15-10206.04
DATE	01-14-16
REVISIONS	

January 14, 2016 10:11:38 a.m.
Drawing: CLARITY POINTE BASE.DWG

PHM-2
2 OF 2

© COTLEUR & HEARING, INC.
These drawings are the property of the architect and are not to be used for extensions or other projects except by agreement in writing with the architect. Immediately report any discrepancies to the architect.