

PLANT LIST FOR ENTRY ROAD - VILLAGE APARTMENTS 10/2/97

NOTE: The quantities on this plant list are to be used as a guide only and not for bidding purposes.
* Denotes native plants.

SYM	QTY	BOTANICAL NAME	COMMON NAME	HEIGHT	SPREAD	CLIMATE	CAL	COMMENTS
B56	19	Bursera simaruba	Gumbo Limbo	12'	6'	4'	2'	
BVD	30	Bougainvillea Yolan Johnson	Dwarf Bougainvillea	10'-24"	10'			
CAS6	6	Caselia australis	'Caselia	12'	5'	3'	4'	
CE5	8	Conocarpus erectus	'Green Buttonwood	10'	5'	3'	15'	
CE6	23	Conocarpus erectus	'Green Buttonwood	12'	6'	4'	2'	Full
ING	602	Impatiens 'N. Grand'	'Impatiens					
JCP	132	Jasminum chinensis var. paniculatum	'Jasmine	12'	6'			Full
JV	220	Jasminum volubile	'Wine Jasmine	14'	10'-24"			Full
MCS	24	Myrica carifera	'Wax Myrtle	6'	3'-4'	1'	75'	
PENL	288	Ficus palmata	'Ficus Palm	6'-8'				Full
PENP	434	Ficus palmata	'Ficus Palm	6'-8'				Full
PKS	12	Phoenix rostrata	'Palm Tree	6'				Triple Ht.
PVD	90	Pittosporum variegatum	'Pittosporum	20'	12'	5'-6'	6'	Full
QV10	9	Quercus virginiana	'Florida Live Oak					Full
RDB	39	Rapanea hirsuta	'Florida Royal Palm					Matched
SC	300	Scaevola taccada	'Flowers as Available		4'-6'			Full
WDS	34	Wodyetia bifurcata	'Foxtail Palm	10'		6'		

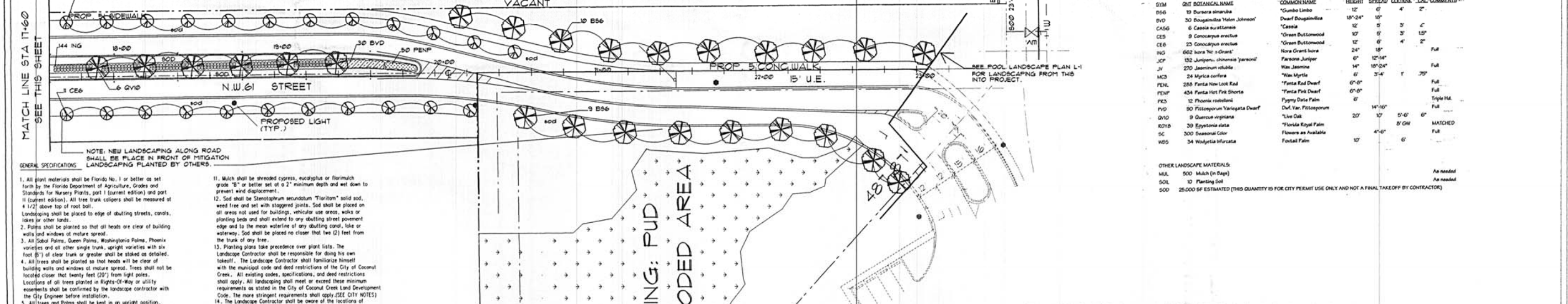

CITY NOTES FOR ALL LANDSCAPE PLANS AND SPECIFICATIONS

- ALL LANDSCAPE AND SPECIFICATIONS SHALL MEET OR EXCEED THE MINIMUM REQUIREMENTS AS PROVIDED IN THE CITY OF COCONUT CREEK LAND DEVELOPMENT CODE.
- ALL PLANTING MATERIAL SHALL MEET OR EXCEED FLORIDA GRADE #1 AS SPECIFIED IN GRASSES AND STANDARDS FOR NURSERY PLANTS AND PART 1. PALMS AND TREES CURRENT EDITION.
- LANDSCAPE MATERIAL SHALL BE PLACED TO EDGE OF ADJUTING STREETS, CANALS, LAKES OR OTHER LANDS.
- ALL MECHANICAL EQUIPMENT, AIR CONDITIONING, IRRIGATION PUMPS AND EQUIPMENT, PFL TRANSFORMERS, POOL PUMPS ETC. MUST BE SCREENED ON THREE (3) SIDES BY LANDSCAPE SHRUBS.
NOTE: THE QUANTITY OF SCREENING SHRUBS IS IN ADDITION TO THE REQUIRED NUMBER OF SHRUBS AS PROVIDED IN THE CITY CODE CALCULATION TABLE. ALL SCREENING SHRUBS SHALL BE PLANTED FOR PROPER OPERATION OF EQUIPMENT BEING SCREENED AND/OR PER THE REQUIREMENTS OF THE UTILITY AS NECESSARY. ALL HEDGE MATERIAL REQUIRED FOR SCREENING PURPOSES SHALL BE PLANTED WITH BRANCHED TOUCHING, ADJUST ON CENTER SPACING AS NECESSARY AND/OR PROVIDE ADDITIONAL PLANTS TO PROVIDE AN ADEQUATE SCREEN.
- SITE DISTANCE CONCERNS MUST BE MAINTAINED FOR CLEAR SITE VISIBILITY FROM TRUNK (30) INCHES TO SEVENTY-TWO (72) INCHES TREES EXCLUDED. MEASUREMENT SHALL BE MADE FROM TOP OF ROOT BALL PLANTED AT PROPER ELEVATION.
- OUTSTANDING BRANCHES SHALL NOT PENETRATE ROOFS, SCREENS, WIRES, ETC. TO PENETRATE OUTER SURFACES OF TREES, PALMS OR OTHER PLANT MATERIAL. TREES, PALMS AND PLANT MATERIAL SELECTED DUE TO THIS PRACTICE SHALL BE REPLACED WITH THE INSPECTOR ON SITE.
- BURLAP MATERIAL, WIRE CAGES, PLASTIC/CANVAS STRIPS, ETC. MUST BE CUT AND REMOVED FOR THE TOP ONE-HALF (1/2) DEPTH OF THE ROOT BALL. TREES AND SHRUBS GROWN IN GROW BAGS OR GROW BAG TYPE MATERIAL MUST HAVE SUCH MATERIAL REMOVED ENTIRELY PRIOR TO PLANTING THE TREE OR SHRUB.
- ALL PLANT MATERIAL SHALL BE FREE OF PESTS, INSECTS, DISEASE WEEDS, ETC.
- ALL PLANT MATERIAL SHALL BE PLANTED AT THE PROPER DEPTH AS ORIGINALLY GROWN AND/OR SO THE TOP OF THE ROOT BALL IS FLUSH OR SLIGHTLY ABOVE FINISHED GRADE IMMEDIATELY AFTER PLANTING. ALL TREES SHOULD PROVIDE TRUNK TAPER WHEN PROPERLY PLANTED AT THE CORRECT PLANTING DEPTH.
- ALL PLANT MATERIAL SHALL BE WATERED IN AT THE TIME OF PLANTING TO ELIMINATE AIR ROCKETS IN THE ROOT ZONE AREA.
- UPON COMPLETION OF WORK, THE SITE SHALL BE CLEARED OF ALL DEBRIS, SUPERFLUOUS MATERIALS AND EQUIPMENT CAUSED BY THIS PERMIT TO THE SATISFACTION OF THE INSPECTOR.
- REFER TO COCONUT CREEK FIRE HYDRANT CLEAR ZONE DIAGRAM TO MAINTAIN A SAFE ZONE FRONTING FIRE HYDRANTS.
- DO NOT PLANT TREES, SHRUBS OR GROUND COVER PLANTS WITHIN ELECTRIC METER CLEAR ZONE PROVIDE A SAFE ZONE AS DESCRIBED BY THE ELECTRICAL INSPECTOR.
- ALL LANDSCAPED AREAS SHALL BE PROVIDED WITH AN UNDERGROUND ROLLY AUTOMATIC IRRIGATION SYSTEM USING POP-UP SPRINKLERS. SYSTEM SHALL PROVIDE 100% COVERAGE WITH A NO-OVERLAP (MULCH) LEANS MUST FREE WATER, EXCEPT PRESERVED AREAS REMAINING IN NATURAL STATE. A RAIN SENSOR DEVICE OR SWITCH SHALL BE INSTALLED THAT WILL OVERLAP THE IRRIGATION SYSTEM WHEN ADEQUATE RAINFALL HAS OCCURRED. WATER SHALL NOT BE DIRECTED AND/OR PROVIDED INTO IMPERVIOUS SURFACES AND/OR BE DESIGNED OR INSTALLED TO THROW WATER OVER AN IMPERVIOUS SURFACE SUCH AS A SIDEWALK. EACH HOUR OF OPERATION FOR ALL IRRIGATION SYSTEMS SHALL BE LIMITED TO 5:00 PM TO 8:00 AM ONLY OR AS MAY BE FURTHER RESTRICTED BY SOUTH FLORIDA WATER MANAGEMENT DISTRICT OR OTHER JURISDICTIONAL AGENCY.
- IRRIGATION PERMITS AND PLANS SHALL BE SUBMITTED FOR APPROVAL AT THE TIME OF BUILDING PERMITS.
- ALL NON-SINGLE FAMILY OR DUPLEX IRRIGATION SYSTEMS OTHER THAN CITY WATER SYSTEMS SHALL REQUIRE A SOUTH FLORIDA WATER MANAGEMENT DISTRICT WATER USE PERMIT PRIOR TO ISSUANCE OF AN IRRIGATION PERMIT AND INSTALLATION OF THE IRRIGATION SYSTEM AS REQUIRED.
- ALL SITE APPLICANTS TO INCLUDE SITE STREET LIGHTS, LANDSCAPE COMMON OPEN SPACE, IRRIGATION COMMON OPEN SPACE, BARRIERS, BENCHES, LANDSCAPE ENTRY FEATURES, ETC. LEADING UP TO AND INCLUDING THE MODEL CENTER AND/OR FIRST CERTIFICATE OF OCCUPANCY MUST BE COMPLETED AND FUNCTIONAL PRIOR TO ISSUANCE OF THE FIRST REQUESTED CERTIFICATE OF OCCUPANCY.
- THE HEIGHT OF ALL REQUIRED DESIGNED AND INSTALLED BERRYS SHALL BE FROM THE HIGHEST ADJACENT POINT (WHETHER IT IS THE SIDEWALK, PARKING AREA, VEHICULAR USE AREA, SURROUNDING GROUND, ETC.) WHERE THE BERRY ADJUTS A SIDEWALK THERE SHALL BE ONE (1) FOOT OF LEVEL 500 AREA ADJACENT TO THE SIDEWALK PRIOR TO THE START OF INCLINE FOR THE BERRY.

ENTRY ROAD LANDSCAPE PLAN FOR VILLAGE APARTMENTS
COCONUT CREEK, FLORIDA

DATE: AUGUST 1, 1997
SCALE: 1"=50'
DRAWN BY: M.J.P.
CHECKED BY: ONE
DATE: 10-9-98

Michael J. Petrov
Associates, Inc.

Professional Seal: M.J.P. 10000
Professional Seal: M.J.P. 10000
Professional Seal: M.J.P. 10000
Professional Seal: M.J.P. 10000