

GENERAL SPECIFICATIONS

- All plant materials shall be Florida No. 1 or better as set forth by the Florida Department of Agriculture, Grades and Standards for Nursery Plants, part 1 (current edition) and part 11 (current edition). All tree trunk calipers shall be measured at 1 1/2" above top of root ball.
- Landscaping shall be placed to edge of abutting streets, canals, lakes or other lands.
- Palms shall be planted so that all heads are clear of building walls and windows of mature spread.
- All Sabal Palms, Queen Palms, Washingtonia Palms, Phoenix varieties and all other single trunk, upright varieties with six foot (6') of clear trunk or greater shall be staked as detailed.
- All trees shall be planted so that heads will be clear of building walls and windows of mature spread. Trees shall not be located closer than twenty feet (20') from light poles.
- Locations of all trees planted in Rights-Of-Way or utility easements shall be confirmed by the landscape contractor with the City Engineer before installation.
- All trees and Palms shall be kept in an upright position. Under no circumstances shall any support method used employ the driving of nails or other mechanical devices of any kind into the bark of any tree or palm. Trees rejected due to this type of damage shall be replaced with the inspector on site. Burlap material, wire cages, plastic straps, etc. must be cut and removed from the top one-half (1/2) of the root ball. Trees grown in "grow bag" type of materials must have the "grow bags" removed entirely prior to planting the tree.
- All major trees within or overhanging pedestrian areas shall have a clear trunk high enough to allow unobstructed pedestrian movement under trees.
- All hedges shall be planted with twelve inches (12") clear space between outer branches and building walls, fences or pavement edges at the time of planting. Required hedge plants shall be planted with branches touching, as required by municipal code. All mechanical equipment, air conditioning, irrigation pumps, FFL transformers, pool pumps, etc., must be screened on three (3) sides by shrubs.
- Irrigation source shall be from well by underground, automatic, rust free system with 100% coverage and a minimum of 50% overlap of spray. Irrigation rain sensor shall be installed. Irrigation water shall not be directed onto or over impervious surfaces.
- Irrigation systems shall operate and be designed to operate between the hours of 5:00 PM and 8:00 AM. Irrigation systems other than City water shall require a South Florida Water Management District water use permit prior to the issuance of the required irrigation permit from the City and/or the operation of the irrigation system. Approved irrigation permits shall be required from the City prior to installation.
- Planting soil shall be at least 50% muck and 50% sand pulverized and weed free, to be mixed with existing soil free from rocks and debris and backfilled into plant pits by washing in. Planting soil for Sabal Palms shall be clean sand. Existing soil may be used for planting soil if approved by the Landscape Architect.
- Fertilizer for trees and shrubs shall be a general purpose 50% organic fertilizer (6-6-6) with minor elements, iron and manganese and shall be mixed with the planting soil at the time of backfilling.
- Fertilizer for palms shall be a palm special type to include manganese and magnesium sulfate.
- Application rates for all fertilizers at the time of planting shall be 1/2 the manufacturers recommendations for established plants.
- Mulch shall be shredded cypress, eucalyptus or florimulch grade "B" or better set at a 2" minimum depth and wet down to prevent wind displacement.
- Sod shall be Stenotaphrum secundatum "Floritan" solid sod, weed free and set with staggered joints. Sod shall be placed on all areas not used for buildings, vehicular use areas, walks or planting beds and shall extend to any abutting street pavement edge and to the mean waterline of any abutting canal, lake or waterway. Sod shall be placed no closer than two (2) feet from the trunk of any tree.
- Planting plans take precedence over plant lists. The Landscape Contractor shall be responsible for doing his own takeoff. The Landscape Contractor shall familiarize himself with the municipal code and deed restrictions of the City of Coconut Creek. All existing codes, specifications, and deed restrictions shall apply. All landscaping shall meet or exceed these minimum requirements as stated in the City of Coconut Creek Land Development Code. The more stringent requirements shall apply.
- The Landscape Contractor shall be aware of the locations of all easements and utilities above and below ground and coordinate plant locations before digging operations begin. All plant pits located in easements shall be hand dug.
- The Landscape Contractor shall provide a written guarantee to the Owner for all plant materials and workmanship for a period no less than ninety (90) days from the time of final inspection and acceptance by the Owner.
- At the end of the guarantee period, all plant materials shall be inspected by the Landscape Contractor and the Owner. All plants that are in a healthy, growing condition at the time of the inspection shall be free from further guarantee and shall be the Owners responsibility. All plants that are in questionable condition due to transplant shock shall continue under the guarantee until recovery or, if deemed severely retarded in growth or dead, shall be replaced. Replaced plant material shall be guaranteed for the same time period and under the same conditions as the original plant material. This guarantee does not apply if the plant materials have not been maintained by the Owner as instructed by the Landscape Contractor, are damaged by storms, vandalism, insect or freeze damage or acts of God beyond the Landscape Contractors control. All plants shall be free from harmful plant pests at the time of planting.
- Sight distance concerns must be maintained for clear sight visibility from thirty (30) inches to seventy-two (72) inches, tree trunks excluded.
- All site amenities to include street and internal lighting, landscaped common areas, entrances, open space, irrigation, buffers, etc. leading to and including the first certificate of occupancy, must be completed and functional prior to the issuance of the requested certificate of occupancy.
- All common area landscape shall require permits from the City prior to installation.

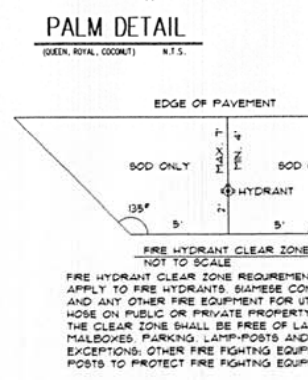
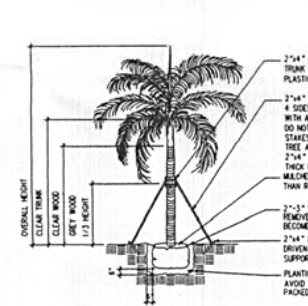
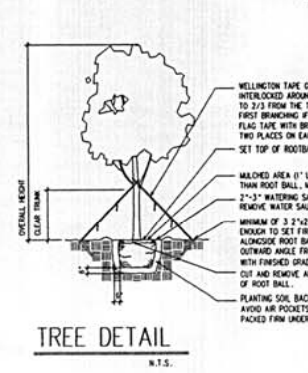
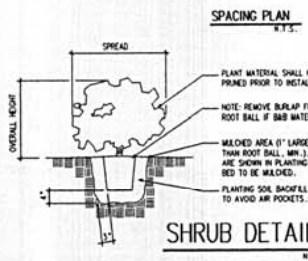
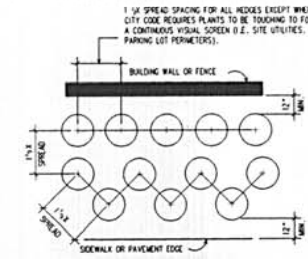

CITY NOTES FOR ALL LANDSCAPE PLANS AND SPECIFICATIONS

- ALL LANDSCAPE AND SPECIFICATIONS SHALL MEET OR EXCEED THE MINIMUM REQUIREMENTS AS PROVIDED IN THE CITY OF COCONUT CREEK LAND DEVELOPMENT CODE.
 - ALL PLANTING MATERIAL SHALL MEET OR EXCEED FLORIDA GRADE #1 AS SPECIFIED IN GRADES AND STANDARDS FOR NURSERY PLANTS AND PART I PALMS AND TREES, CURRENT EDITION.
 - LANDSCAPE SHALL BE PLACED TO EDGE OF ABUTTING STREETS, CANALS, LAKES OR OTHER LANDS.
 - ALL MECHANICAL EQUIPMENT AIR CONDITIONING, IRRIGATION PUMP STATIONS AND EQUIPMENT, FFL TRANSFORMERS, POOL PUMPS ETC. MUST BE SCREENED ON THREE (3) SIDES BY LANDSCAPE SHRUBS.
- NOTE: THE QUANTITY OF SCREENING SHRUBS IS IN ADDITION TO THE REQUIRED NUMBER OF SHRUBS AS PROVIDED IN THE CODE CALCULATION TABLE. ALL SCREENING SHRUBS SHALL BE PLANTED FOR PROPER OPERATION OF EQUIPMENT BEING SCREENED AND/OR PER THE REQUIREMENTS OF THE UTILITY AS NECESSARY. ALL HEDGE MATERIAL REQUIRED FOR SCREENING PURPOSES SHALL BE PLANTED WITH BRANCHES TOUCHING. ADJUST ON CENTER SPACINGS AS NECESSARY AND/OR PROVIDE ADDITIONAL PLANTS TO PROVIDE AN ADEQUATE SCREEN.
- SITE DISTANCE CONCERNS MUST BE MAINTAINED FOR CLEAR SITE VISIBILITY FROM THIRTY (30) INCHES TO SEVENTY-TWO (72) INCHES. TREE TRUNKS EXCLUDED. MEASUREMENT SHALL BE MADE FROM TOP OF ROOT BALL PLANTED AT PROPER ELEVATION.
 - CUTTING/STAKING PRACTICES SHALL NOT PERMIT NAILS, SCREWS, WIRES, ETC. TO PENETRATE OUTER SURFACES OF TREES, PALMS OR OTHER PLANT MATERIAL. TREES, PALMS AND PLANT MATERIAL REJECTED DUE TO THIS PRACTICE SHALL BE REPLACED WITH THE INSPECTOR ON SITE.
 - BURLAP MATERIAL, WIRE CAGES, PLASTIC/CANVAS STRAPS, ETC. MUST BE CUT AND REMOVED FOR THE TOP ONE-HALF (1/2) DEPTH OF THE ROOT BALL. TREES AND SHRUBS GROWN IN GROW BAGS OR GROW BAG TYPE MATERIAL MUST HAVE SUCH MATERIAL REMOVED ENTIRELY PRIOR TO PLANTING THE TREE OR SHRUB.
 - ALL PLANT MATERIAL SHALL BE FREE OF PESTS, INSECTS, DISEASE, WEEDS, ETC.
 - ALL PLANT MATERIAL SHALL BE PLANTED AT THE PROPER DEPTH. AS ORIGINALLY GROWN AND/OR SO THE TOP OF THE ROOT BALL IS FLUSH OR SLIGHTLY ABOVE FINISHED GRADE IMMEDIATELY AFTER PLANTING. ALL TREES SHOULD PROVIDE TRUNK TAPER WHEN PROPERLY PLANTED AT THE CORRECT PLANTING DEPTH.
 - ALL PLANT MATERIAL SHALL BE WATERED IN AT THE TIME OF PLANTING TO ELIMINATE AIR POCKETS IN THE ROOT ZONE AREA.
 - UPON COMPLETION OF WORK, THE SITE SHALL BE CLEARED OF ALL DEBRIS, SUPERFLUOUS MATERIALS, AND EQUIPMENT CAUSED BY THIS PERMIT TO THE SATISFACTION OF THE INSPECTOR.
 - REFER TO COCONUT CREEK FIRE HYDRANT CLEAR ZONE DIAGRAM TO MAINTAIN A SAFE ZONE FRONTING FIRE HYDRANTS.
 - DO NOT PLANT TREES, SHRUBS OR GROUND COVER PLANTS WITHIN ELECTRIC METER CLEAR ZONE. PROVIDE A SAFE ZONE AS DESCRIBED BY THE ELECTRICAL INSPECTOR.
 - ALL LANDSCAPED AREAS SHALL BE PROVIDED WITH AN UNDERGROUND FULLY AUTOMATIC IRRIGATION SYSTEM USING POP-UP SPRINKLERS. SYSTEM SHALL PROVIDE 100% COVERAGE WITH A 50% OVERLAP (MINIMUM) USING RUST FREE WATER EXCEPT PRESERVED AREAS REMAINING IN NATURAL STATE. A RAIN SENSOR DEVICE OR SWITCH SHALL BE INSTALLED THAT WILL OVERRIDE THE IRRIGATION SYSTEM WHEN ADEQUATE RAINFALL HAS OCCURRED. WATER SHALL NOT BE DIRECTED AND/OR PROVIDED INTO IMPERVIOUS SURFACES AND/OR BE DESIGNED OR INSTALLED TO THROW WATER OVER AN IMPERVIOUS SURFACE SUCH AS A SIDEWALK, ETC. HOURS OF OPERATION FOR ALL IRRIGATION SYSTEMS SHALL BE LIMITED TO 9:00 PM TO 8:00 AM ONLY OR AS MAY BE FURTHER RESTRICTED BY SOUTH FLORIDA WATER MANAGEMENT DISTRICT OR OTHER JURISDICTIONAL AGENCY.
 - IRRIGATION PERMITS AND PLANS SHALL BE SUBMITTED FOR APPROVAL AT THE TIME OF BUILDING PERMITS.
 - ALL NON SINGLE FAMILY OR DUPLEX IRRIGATION SYSTEMS OTHER THAN CITY WATER SYSTEMS SHALL REQUIRE A SOUTH FLORIDA WATER MANAGEMENT DISTRICT WATER USE PERMIT PRIOR TO ISSUANCE OF AN IRRIGATION PERMIT AND INSTALLATION OF THE IRRIGATION SYSTEM AS REQUIRED.
 - ALL SITE AMENITIES TO INCLUDE SITE STREET LIGHTS, LANDSCAPE COMMON OPEN SPACE, IRRIGATION COMMON OPEN SPACE, BUFFERS, BERMS, LANDSCAPE ENTRY FEATURES, ETC. LEADING UP TO AND INCLUDING THE MODEL CENTER AND/OR FIRST CERTIFICATE OF OCCUPANCY, MUST BE COMPLETED AND FUNCTIONAL PRIOR TO ISSUANCE OF THE FIRST REQUESTED CERTIFICATE OF OCCUPANCY.
 - THE HEIGHT OF ALL REQUIRED, DESIGNED AND INSTALLED BERMS SHALL BE FROM THE HIGHEST ADJACENT POINT WHETHER IT IS THE SIDEWALK, PARKING AREA, VEHICULAR USE AREA, SURROUNDING GROUND, ETC. WHERE A BERM ABUTS A SIDEWALK, THERE SHALL BE ONE (1) FOOT OF LEVEL SOD AREA ADJACENT TO THE SIDEWALK PRIOR TO THE START OF INCLINE FOR THE BERM.

PLANT LIST FOR VILLAGE APARTMENTS POOL 10/2/97

NOTE: The quantities on this plant list are to be used as a guide only and not for bidding purposes.

SYM	QTY	BOTANICAL NAME	COMMON NAME	HEIGHT	SPREAD	CLEARANCE	CAL	COMMENTS
ASB	1	Aspidochelone argentea	"Fountain"	10'-12'	6'-8'	2'-6"		Slugg Tree
ALCH	20	Alamanda cathartica hunderwoodii	Hard Dwarf Alamanda	18"	18"			
AO	12	Alcaecia odora 'California'	Alcaecia, "Odora" type	24"	18"-24"			Full Gal
ALZ	15	Alpinia zerumbet 'variegata'	Variegated Shell Ginger	24"-30"				5 Stem Min.
ADM	100	Asparagus densiflorus 'Myers'	Fox Tail Fern		8"-10"			Full Gal
AV	4	Douglasville Spp.	Douglasville	26"	50"-60"			Triple
CBG	9	Callitamon vinicola	Weeping Bottlebrush	12'	6'	4'		
CEB	3	Calophyllum antillarum	"Beauty Palm"	12'	6'	4 1/2'		
CEC	6	Conocarpus erectus	"Green Buttonwood"	6'	3'-4'	1'-2'	30"	
CE5	6	Conocarpus erectus	"Green Buttonwood"	12'	5'	3'	15"	
CH5	6	Chamaedorea seifridii	Red Palm	4'	18"			5 Stem Min.
CL5	4	Chrysalidocarpus lutescens	Avocado Palm	10'	6'-8'			
CI	175	Chrysalidocarpus lutescens	"Coconut"	10'-24"	18"			Full
COM	41	Coccothrinax 'Maypan'	Maypan Coconut	12'-14"				
COV	19	Colobium variegatum 'Yatra'	Petra Croton	18"	18"			3 Per Pot
CR	12	Crinum asiaticum	Crinum Lily	30"	30"			Full
DEL7	1	Dalmanella regia	Royal Foinciana	14'	6'	5'		Full
FAK	14	Tripsacum dactyloides	"Falahatchee Grass"	30"	30"			Full
HF	55	Hamelia patens	"Firebush"	24"-30"	24"			Full
HEL	7	Hibiscus Spp.	Hibiscus	2'-4'				Full
HES	1	Hibiscus rosa-sinensis	Chinese Hibiscus	6'	3'-4'	3'		Tree Std.
HIS	10	Hieronyma condensa 'Shilling's'	"Dwarf Yaupon Holly"	12"-14"	14"-18"			Full
HIS	254	Hieronyma condensa 'Nora Grant'	Nora Grant holly	24"	18"			Full
JM	175	Jasminum multiflorum	Downy Jasmine	14"-18"	18"-24"			Full
JV	125	Jasminum volubile	Wax Jasmine	14"	18"-24"			Full
LA	10	Lagerstroemia indica	Crape Myrtle	8'	4'	2'-3'		
LA5	7	Lagerstroemia indica	Crape Myrtle	10'	4'	3'-4'		
LA4	1	Ligustrum lucidum	Glossy Privet	8'	4'			Full
LEG	231	Liriodendron 'Evergreen Giant'	Evergreen Lilyturf	12'				Full Gal
LV	85	Liriodendron 'Variegata Giant'	Asiac Grass	2'	2'			
MT	35	Musa sapientum	Musa sapientum (pink)	2'	2'			
MCA	14	Mycia confusa	"Wax Myrtle"	8'	4'	1'-2'	1'	
PENC	50	Penta crenberry punch	Penta Cranberry Punch	6"	6"			
PENP	305	Penta Hot Pink Shorte	"Penta Pink Dwarf"	6"-8"				Full
PENL	275	Penta New Look Red	"Penta Red Dwarf"	6"-8"				Full
PS	72	Philodendron edoum	Syltized Philodendron	2'-3'				
PX	48	Philodendron 'Lanadu'	Xanadu Philodendron	18"-24"	18"-24"			Full
SD	1	Phoenix rostrata	Senegal Date Palm	14'-16"				4-5 Trunks
PV	35	Pittosporum 'Variegata'	Variegated Pittosporum	24"	18"			Full
POZ	6	Poncirus mali	Yew Poincarnus	4'	18"			
PC4	1	Pavonia littoralis	Callistylis Palm	8'	4'	2'-3'		Triple
PE6	4	Psychopoma elegans	Saltwater Palm	12'	6'	4'	2'	
QV8	7	Quercus virginiana	"Live Oak"	12'	6'	4'	2'	
EX	1	Rhapiz mocha	Lady Palm	3'-4'	18"-24"			5 Stem Min.
ROYB	4	Roystonia elata	"Florida Royal Palm"			8' GW		Full
SC	605	Seasonal Color	Flowers as Available	4'-6"				Full
SR	17	Strelitzia reginae	Bird of Paradise	3'	3'			Heavy
SMB	2	Sweetenia mahogany	"West Indies Mahogany"	12'	6'	4'	2'	
SYS	5	Syagrus romanzoffiana	Queen Palm			10'		
SYT	5	Syagrus romanzoffiana	Queen Palm			18'		
SY9	5	Syagrus romanzoffiana	Queen Palm			10'		
TPE	4	Taxodium imrayense	Purple Tropic Tree	12'	6'	4'		
FAK	41	Tripsacum dactyloides	"Falahatchee Grass"	30"	30"			Full
VS	166	Viburnum suspensum	Sandbarbe Viburnum	24"	18"			Full
ZF	4	Zamia furfuracea	Carobwood Plant	18"-24"	24"			Full

500 Muck (in Bags) As needed
 300 Planting Soil As needed
 10500 SF ESTIMATED (THIS QUANTITY IS FOR CITY PERMIT USE ONLY AND NOT A FINAL TAKEOFF BY CONTRACTOR)

POOL LANDSCAPE DETAILS AND NOTES FOR VILLAGE APARTMENTS COCONUT CREEK, FLORIDA

DATE: AUGUST 6, 1997
 SCALE: 1/8"=1'-0"
 DRAWN BY: H.J.P.
 CHECKED BY: M.T.
 JOB # 9704

REVISIONS: OCT 2, 1997

THESE DRAWINGS ARE NOT VALID FOR SUBMITTAL OR CONTRACT CONSTRUCTION USE UNLESS SIGNED, SEALED AND DATED WITH AN ORIGINAL SIGNATURE & LICENSED SEAL. CLIENT IN-CHARGE PURPOSES & RECORD ONLY.

Michael J. Petrow
 Associate, Inc.
 OCT 16 1997

A.S.L.A. Architect
 P.O. Box 8621, Coral Springs, FL 33075
 7438 Wiles Road, Coral Springs, Florida 33067
 Phone: (305) 752-1782, F1, Reg. # 92