

SEE 'COMMERCE CENTER OF COCONUT CREEK TRACTS G & H PARKING LOT IMPROVEMENTS' PLANS FOR IMPROVEMENTS NORTH OF THE EXIST. RIGHT OF WAY UNDER SEPARATE REVIEW

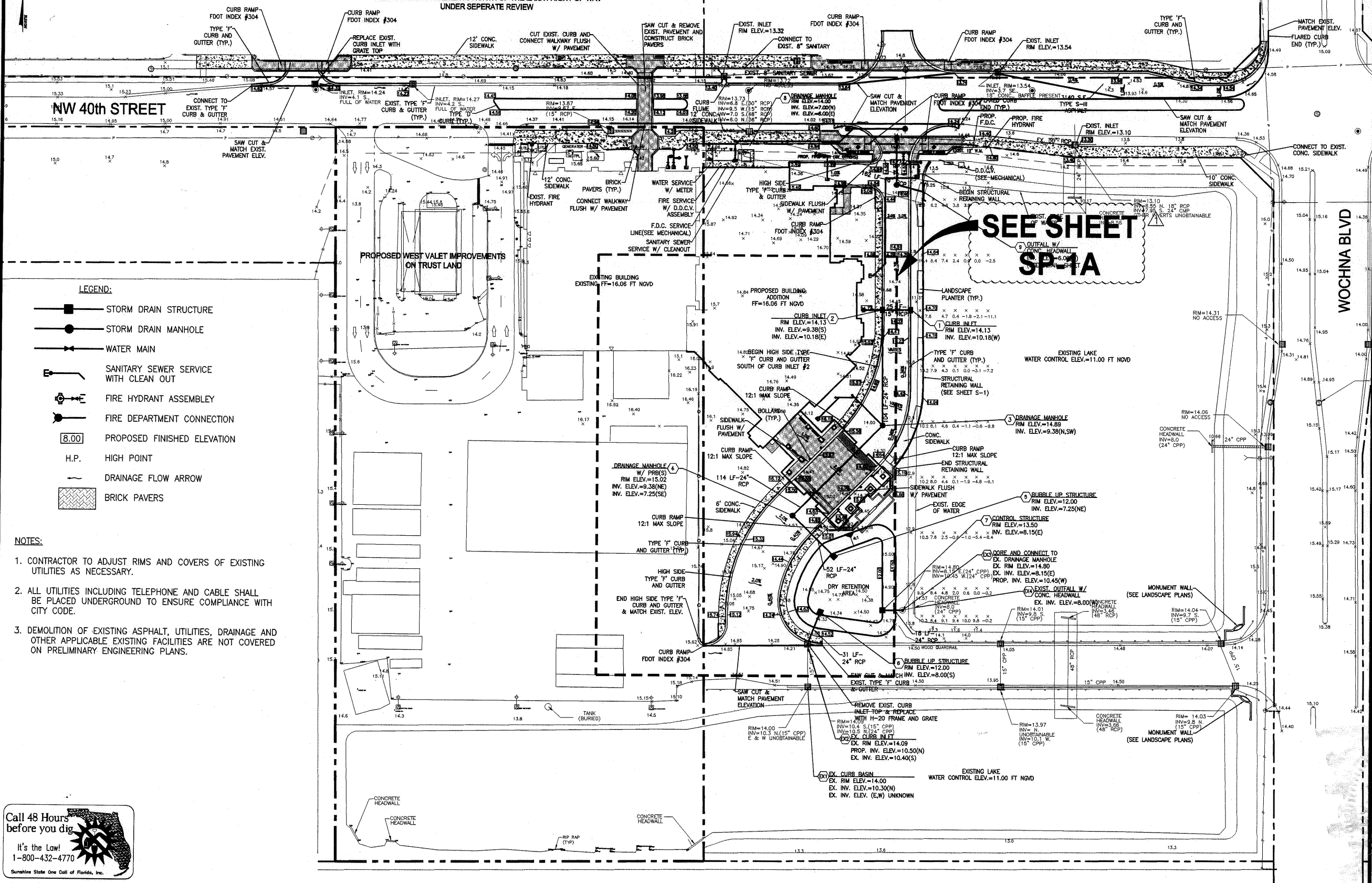

LEGEND:

- STORM DRAIN STRUCTURE
- STORM DRAIN MANHOLE
- WATER MAIN
- SANITARY SEWER SERVICE WITH CLEAN OUT
- FIRE HYDRANT ASSEMBLY
- FIRE DEPARTMENT CONNECTION
- PROPOSED FINISHED ELEVATION
- H.P. HIGH POINT
- DRAINAGE FLOW ARROW
- BRICK PAVERS

NOTES:

1. CONTRACTOR TO ADJUST RIMS AND COVERS OF EXISTING UTILITIES AS NECESSARY.
2. ALL UTILITIES INCLUDING TELEPHONE AND CABLE SHALL BE PLACED UNDERGROUND TO ENSURE COMPLIANCE WITH CITY CODE.
3. DEMOLITION OF EXISTING ASPHALT, UTILITIES, DRAINAGE AND OTHER APPLICABLE EXISTING FACILITIES ARE NOT COVERED ON PRELIMINARY ENGINEERING PLANS.

SEE SHEET SP-1A

Call 48 Hours before you dig
It's the Law!
1-800-432-4770
Sunshine State One Call of Florida, Inc.

KEITH and SCHNARS, P.A.
ENGINEERS, PLANNERS, SURVEYORS



6500 NORTH ANDREWS AVENUE, FORT LAUDERDALE, FL 33309-2132 (954)776-1616

DATE	REVISIONS
1/20/05	DRC REVISIONS
2/3/05	ADDED PARKING
7/5/05	DRC REVISIONS
9/29/11	SALLY PORT

DATE	JULY 2005
SCALE	1" = 40'
DESIGNED BY	C.C.
DRAWN BY	C.C.
CHECKED BY	T.J.H.

COCONUT CREEK CASINO MARKETPLACE
CITY OF COCONUT CREEK
BROWARD COUNTY, FLORIDA
PRELIMINARY ENGINEERING PLAN

SHEET NO.	PE-1
PROJECT NO.	17094.22
J. HALL, P.E. FLORIDA REG. NO. 50588 (FOR THE FIRM)	

10/3/2011 3:21 PM, Scale: 1:1, Layout Tab: PE-1; Pen Table: CIVL.CTB; Plot Created by: FRANCINE LINZERS