

NOTES

- ALL CONSTRUCTION SHALL BE IN ACCORDANCE WITH CITY OF COCONUT CREEK STANDARDS.
- ALL UTILITIES WITH THE EXCEPTION OF MAJOR FPL LINES WILL BE PLACED UNDERGROUND IN ACCORDANCE WITH PHASING SCHEDULE AGREEMENT.
- ALL CONSTRUCTION, MATERIALS, TESTING AND MAINTENANCE SHALL CONFORM TO THE STANDARDS AND SPECIFICATIONS OF LOCAL, COUNTY, STATE AND NATIONAL CODES WHERE APPLICABLE.
- WHEN ANY OF THE GOVERNING REGULATORY AGENCIES' STANDARDS AND SPECIFICATIONS ARE IN CONFLICT, THE MORE STRINGENT SHALL APPLY.
- ALL SIDEWALKS SHALL COMPLY WITH ADA.
- ALL WATER LINES, SEWER LINES AND THEIR APPURTENANCES SHALL BE SEPARATED BY A MINIMUM OF 4 FEET FROM ALL OTHER UTILITIES.
- WATER MAINS SHALL BE LAID TO PROVIDE A VERTICAL SEPARATION OF AT LEAST 18" BETWEEN THE BOTTOM OF THE WATER MAIN AND THE TOP OF THE SANITARY SEWER AND STORM DRAINAGE. WATER MAINS SHALL BE INSTALLED ABOVE SEWERS. STORM DRAINAGE SHALL BE LAID TO PROVIDE A VERTICAL SEPARATION OF AT LEAST 6".
- REFER TO SPRUNG BUILDING OFF-SITE IMPROVEMENT PLANS (NOT PART OF SITE PLAN SUBMITTAL)

LEGEND

- INDICATES TRACT 65 LIMITS (NOT PART OF SITE PLAN SUBMITTAL)
- REFER TO SPRUNG BUILDING OFF-SITE IMPROVEMENT PLANS (NOT PART OF SITE PLAN SUBMITTAL)

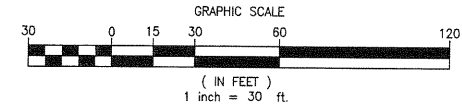

MATCH LINE - SHEET C-18

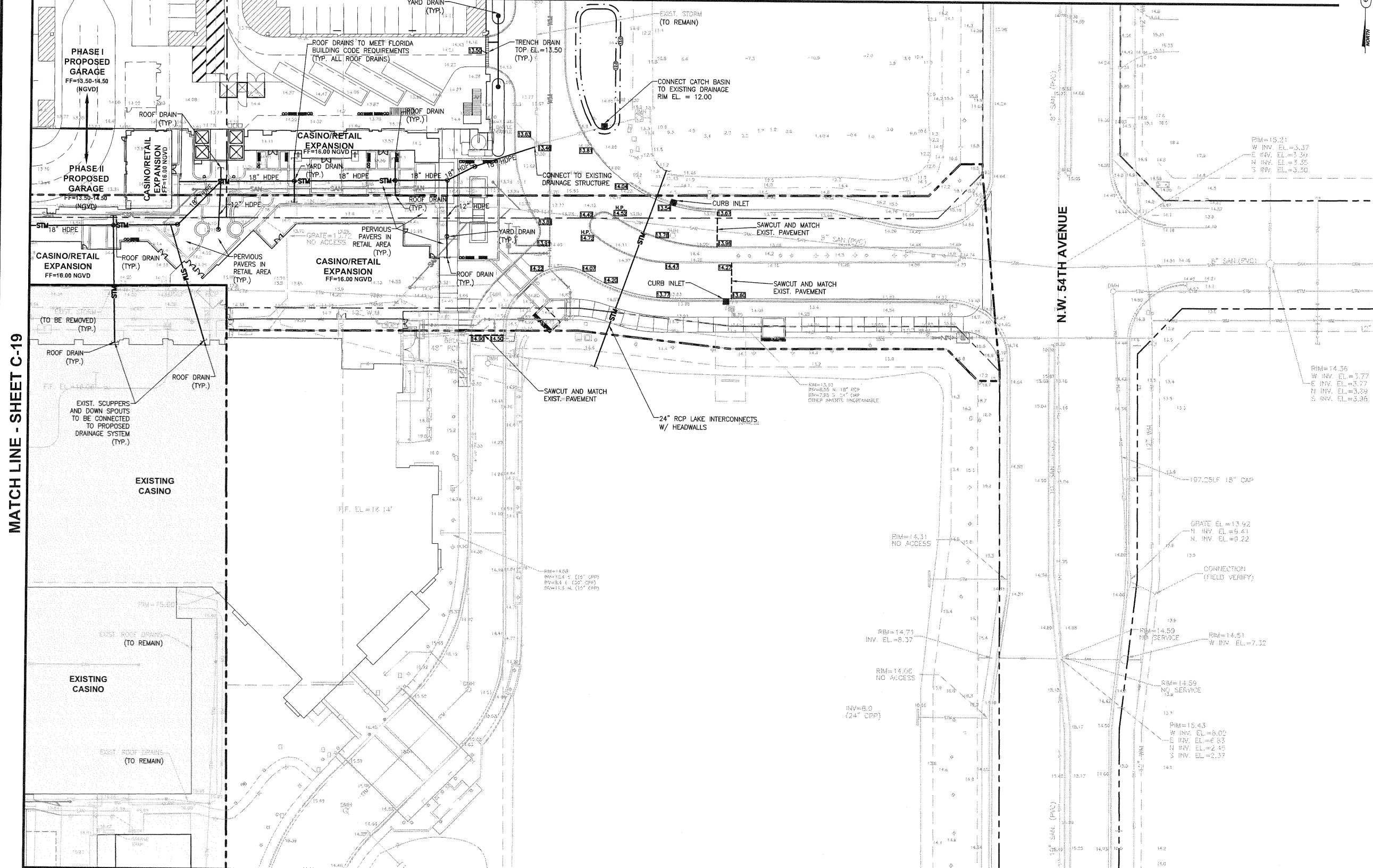

MATCH LINE - SHEET C-22

Date	Description

Michael Singer Inc.
Surveyors, Planners, Surveyors
801 NW 10th Ave, Suite 100
Fort Lauderdale, FL 33304
954-537-0844
msinger@msinger.com

EDSA

KEITH and SCHNARS, P.A.
SURVEYORS, PLANNERS, SURVEYORS
601 N. W. 10th Ave, Suite 100
Fort Lauderdale, FL 33304
954-537-0844
kschnars@kschnars.com

State of Florida
Professional Engineer
License No. 50588

TIM J. HALL, P.E.

PHASE I TRANSPORTATION CENTER
SEMINOLE COCONUT CREEK CASINO
SEMINOLE TRIBE OF FLORIDA
5600 NW 40TH STREET
COCONUT CREEK, FLORIDA 33073

Drawn By
KEITH AND SCHNARS, PA, FL

Checked By
T.J.H.

Issue Date
OCTOBER 18, 2010

Job Number
17796.42

Sheet Name
PRELIMINARY DRAINAGE PLANS

C-20