

1. ALL CONSTRUCTION SHALL BE IN ACCORDANCE WITH CITY OF COCONUT CREEK STANDARDS.
2. ALL UTILITIES WITH THE EXCEPTION OF MAJOR FPL LINES WILL BE PLACED UNDERGROUND IN ACCORDANCE WITH PHASING SCHEDULE AGREEMENT.
3. ALL CONSTRUCTION, MATERIALS, TESTING AND MAINTENANCE SHALL CONFORM TO THE STANDARDS AND SPECIFICATIONS OF LOCAL, COUNTY, STATE AND NATIONAL CODES WHERE APPLICABLE.
4. WHEN ANY OF THE GOVERNING REGULATORY AGENCIES' STANDARDS AND SPECIFICATIONS ARE IN CONFLICT, THE MORE STRINGENT SHALL APPLY.
5. ALL SIDEWALKS SHALL COMPLY WITH ADA.
6. ALL WATER LINES, SEWER LINES AND THEIR APPURTENANCES SHALL BE SEPARATED BY A MINIMUM OF 4 FEET FROM ALL OTHER UTILITIES.
7. WATER MAINS SHALL BE LAID TO PROVIDE A VERTICAL SEPARATION OF AT LEAST 18" BETWEEN THE BOTTOM OF THE WATER MAIN AND THE TOP OF THE SANITARY SEWER AND STORM DRAINAGE. WATER MAINS SHALL BE INSTALLED ABOVE SEWERS.
8. STORM DRAINAGE SHALL BE LAID TO PROVIDE A VERTICAL SEPARATION OF AT LEAST 6".

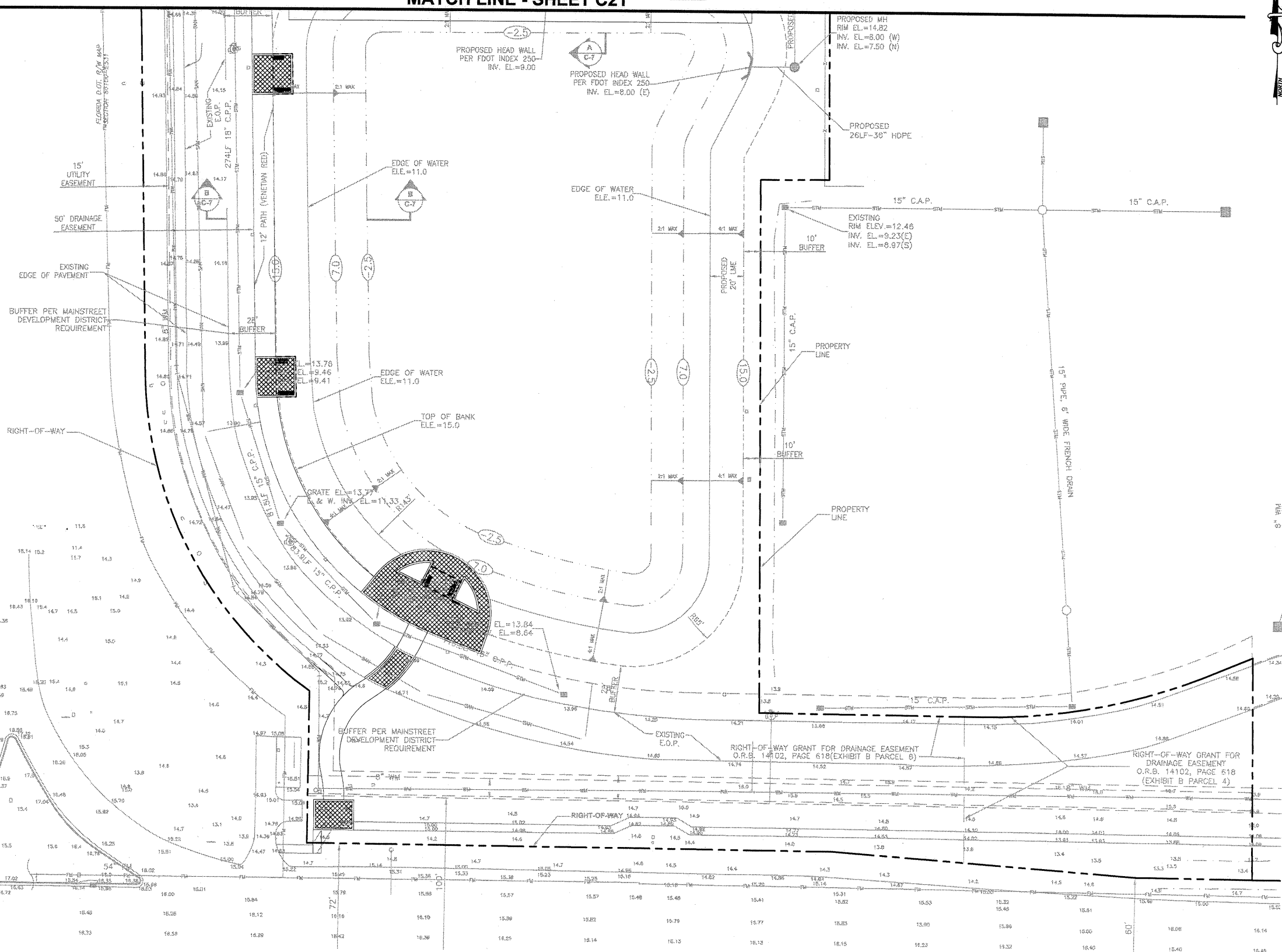

PHASE I TRANSPORTATION CENTER

SEMINOLE COCONUT CREEK CASINO  
SEMINOLE TRIBE OF FLORIDA  
5600 NW 40TH STREET  
COCONUT CREEK, FLORIDA 33073

DRAWN BY  
KEITH AND SCHNARS, PA: FL  
CHECKED BY  
T.J.H.  
ISSUE DATE  
OCTOBER 18, 2010  
JOB NUMBER  
17796.42  
SHEET NAME  
PRELIMINARY  
DRAINAGE PLANS

C-23