

TRACT "K"
(P.B. 160, PGS. 18)

DESCRIPTION:
TRACT E OF WILES/BUTLER PLAT ONE, ACCORDING TO THE PLAT THEREOF, AS RECORDED IN PLAT BOOK 160, AT PAGE 18, OF THE PUBLIC RECORDS OF BROWARD COUNTY, FLORIDA.

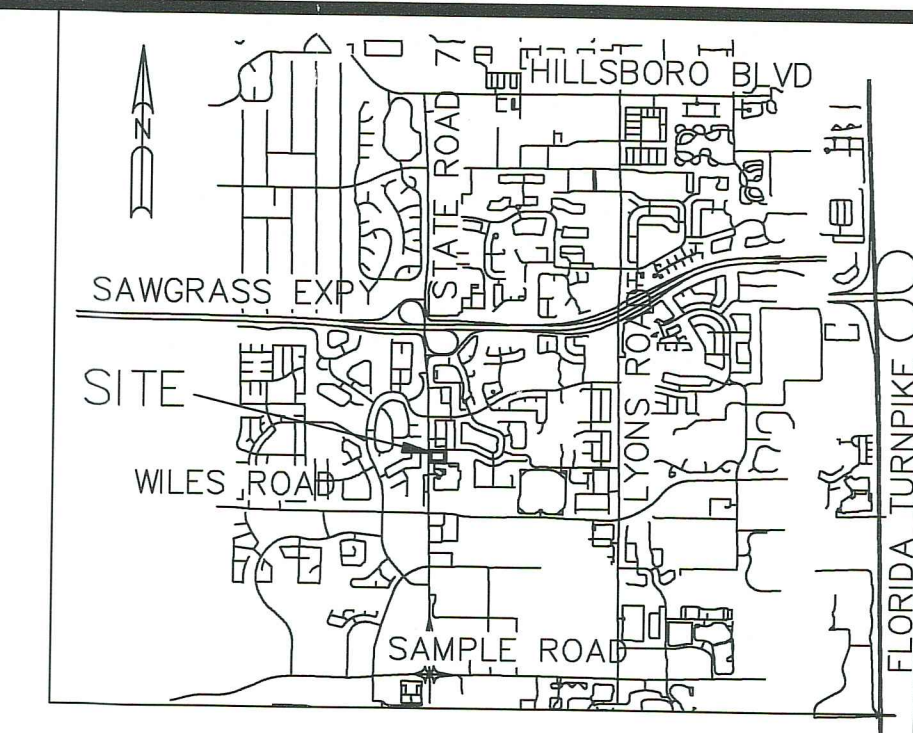

CONSULTANT

Gregory B. Molins
FL. REG. # AR 83354
DATE: 03-26-13

GBM
ARCHITECTURE P.A.
ARCHITECTURE
MASTER PLANNING
4426002322

5801 SW 8th Avenue, Unit F 8
Fort Lauderdale, Florida 33315
T: 954.713.6101
C: 954.812.6680
E: gbm@gbmarchitecture.com
WWW: WWW.GBMARCHITECTURE.COM

DRG SUBMITTAL FOR
COCONUT CREEK MOB
4890 ACCESS ROAD, LLC
4890 ACCESS RD COCONUT CREEK, FLORIDA 33073

DRAWING ISSUE DATES:

PAVEMENT, MARKING + SIGNING PLAN

SHEET
C-2
PROJECT DATE PERMIT NO. 130218 03-26-13

TRACT "I-1"
(P.B. 160, PGS. 18)
80' R/W
ALEXANDRA BOULEVARD

TRACT "F"
(P.B. 160, PGS. 18)

N44°00'21"E
42.43'

S45°59'39"E
42.43'

N89°00'21"E
220.88'

N00°59'39"W
266.92'

S00°59'39"W
266.92'

S89°00'21"W
280.88'

PROPOSED TWO - STORY
21,700 SF
FIN. FLR. 16.5' N.G.V.D.
88 PARKING SPACES

LEGEND

- EXISTING PAVEMENT
- PROPOSED PAVEMENT
- ▭ PROPOSED BUILDING
- PROPOSED EDGE LINE
- ➔ ONLY PROPOSED PAVEMENT ARROW AND MESSAGE
- ➔ DIRECTION OF TRAFFIC
- ➔ TRAFFIC SIGN
- ➔ STOP SIGN (RI-1) 30"x30"(H)
- ➔ R3-5R 24"x30"

NOTES:

1. ALL PAVEMENT MARKINGS ADJACENT TO AND IN THE PUBLIC RIGHT OF WAY SHALL BE REFLECTIVE THERMOPLASTIC (T).
2. ALL STOP AND DO NOT ENTER SIGNS SHALL BE 30"x30" HIGH INTENSITY REFLECTIVE MATERIAL.
3. PAVEMENT MARKINGS ON PAVERS SHALL BE B130/B131 TAPE 3M OR EQUAL APPLIED WITH CONTACT CEMENT OR THERMOPLASTIC APPLIED TO A CONCRETE RIBBON SEALED WITH FDOT APPROVED SEALER.
4. RAISED PAVEMENT MARKERS SHALL BE CLASS B-911 OR EQUAL.
5. RAISED PAVEMENT MARKERS SHALL BE APPLIED WITH EPOXY OR BITUMINUS.
6. FOR THE LOCATION OF BROWARD COUNTY TRAFFIC ENGINEERING DIVISION FACILITIES CONTACT JEROME FONDER 954-484-8600, EXT. 364, 1 TO 10 DAYS PRIOR TO CONSTRUCTION.
7. STRIPING FOR PEDESTRIAN CORSSWALKS SHALL BE IN ACCORDANCE WITH MUTCD.

CAMERO + ASSOCIATES, INC.
CIVIL ENGINEERS CAMERO + ASSOCIATES, INC. EB NO. 06004178
JORGE L. CAMERO, P.E. FLA. REG. NO. 32545
7400 SW 50th TERR. SUITE 204 MIAMI, FL 33155
(305) 665-7602 FAX (305) 665-8488
jorge@cameroengineers.com OUR JOB# 13-110

PAVEMENT, MARKING + SIGNING PLAN



PAVED PARKING (NOT LOCATED)

STATE ROAD NO. 7

