

Drawing name: H:\042 jobs\042701\051-Sawgrass Pky & Lyons Rd- (Coco Crk)\CADD\CIVIL\CIVIL2\CONSTR\PH1-PHOTOMETRIC.dwg PH1 Sep 20, 2006 1:24pm by: mariorivera
 This document, together with the concepts and designs presented herein, as an instrument of service, is intended only for the specific purpose and client for which it was prepared. Reuse of and improper reliance on this document without written authorization and adaptation by Kimley-Horn and Associates, Inc. shall be without liability to Kimley-Horn and Associates, Inc.

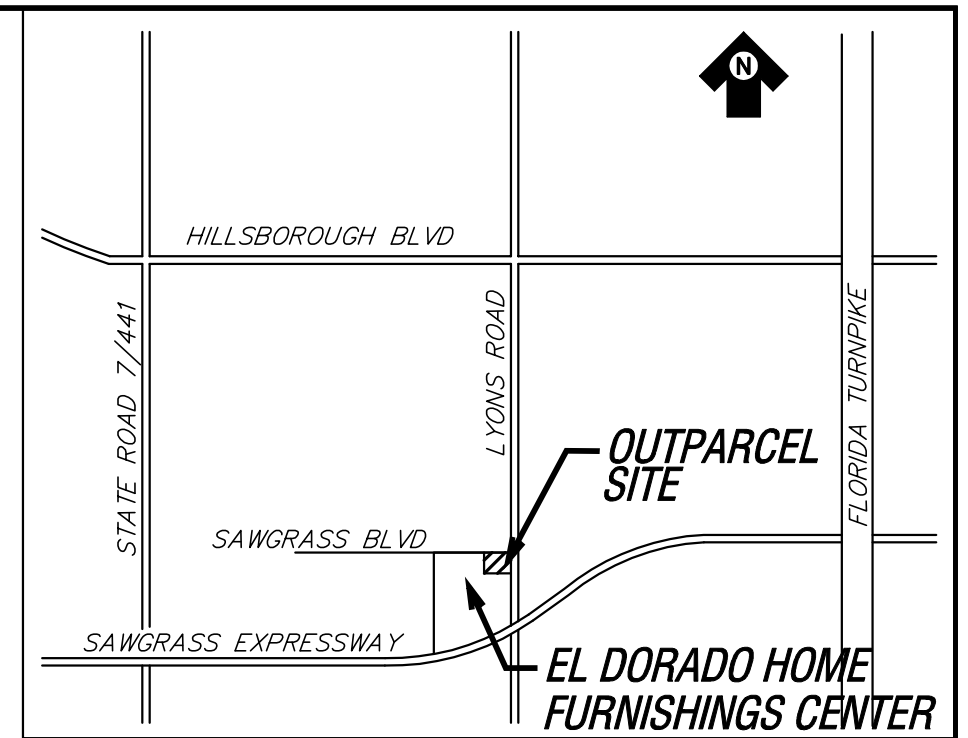
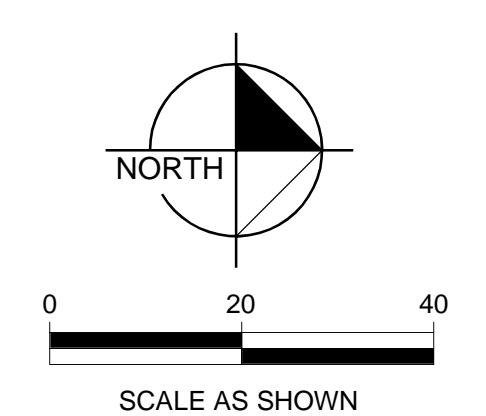
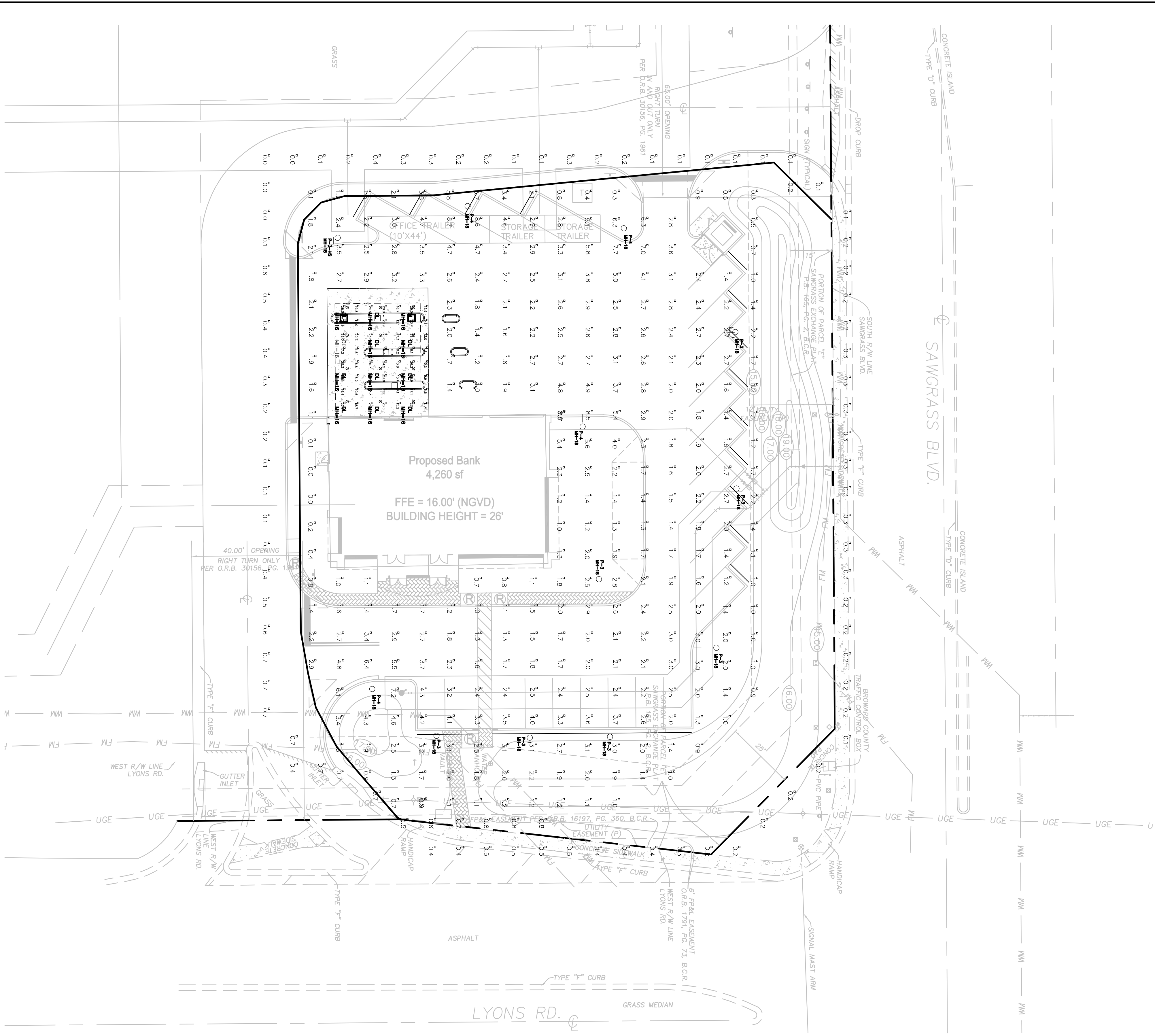

LOCATION MAP
N.T.S.

LEGEND

- PAVERS
- ADA COMPLIANT DETECTABLE WARNING PATTERN & RAMP
- STORM CATCH BASIN

DEVELOPER

Commerce Bank
 9000 Atrium Way
 Mount Laurel, NJ 08054
 Phone: (856) 470-3110
 Contact: Gerry Guidice

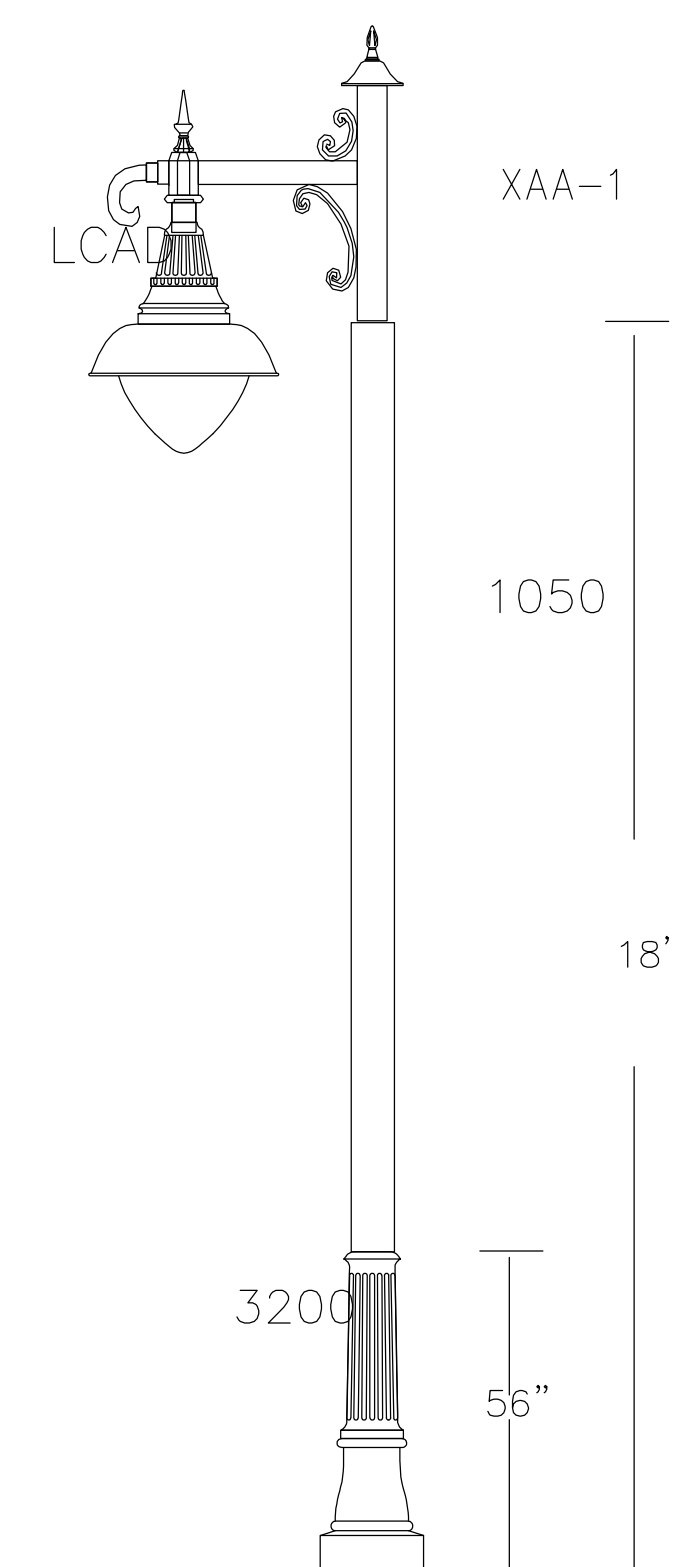

DECORATIVE POLE 'P1A' DETAIL
NOT TO SCALE

- NOTE:**
1. THE POLE SUPPLIER SHALL CERTIFY THAT POLE ASSEMBLY WITH FIXTURE AND ANCHOR BASE AS SPECIFIED WILL MEET 140 MPH WIND LOAD CRITERIA. PROVIDE SIGNED & SEALED CALCULATIONS BY A REGISTERED FLORIDA ENGINEER
 2. ALL LIGHT POLES SHALL BE SET-BACK 2.5' FROM CURB (TYP.)
 3. SEE MEP PLAN BY OTHERS FOR ELECTRICAL SERVICE POINT OF CONNECTION AND ELECTRICAL SERVICE DETAILS.

Luminaire Schedule						
Symbol	Qty	Label	Arrangement	Lumens	LLF	Description
○	12	DL	SINGLE	3400	0.720	LSI # 208J-MHPAR38-1-70-FL25 - Recessed DL 16" MH
○	7	P-3	SINGLE	20500	0.720	LCAD-III-250MH - 16" MH Decorative Steel Pole
○	1	P-3-HS	SINGLE	20500	0.720	LCAD-III-250MH - 16" MH Decorative Steel Pole with House Shield
○	4	P-4	SINGLE	22000	0.720	Sun Valley # LCAD-HR-IV-250MH CLEAR FLAT TEMP. GLASS LENS_ SEG REF. W-HSS

Numeric Summary						
Label	CalcType	Units	Avg	Max	Min	Avg/Min
Parking	Illuminance	Fc	2.73	8.7	0.7	3.90
Canopy	Illuminance	Fc	18.71	29.5	6.6	2.83
Property	Illuminance	Fc	0.31	0.8	0.0	0.00
Landscape Area	Illuminance	Fc	2.01	7.7	0.0	0.00

Call 48 Hours before you dig
 It's the Law!
 1-800-432-4770

Sunshine State One Call of Florida, Inc.

No.	REVISIONS	DATE	BY
4	ISSUED FOR PERMIT SUBMITTALS	8/1/2006	HLS
3	PER DRC COMMENTS	7/24/2006	GB
2	PER DRC COMMENTS	6/9/2006	HLS
1	PER DRC COMMENTS	5/24/2006	HLS

SCALE AS NOTED
 DESIGNED BY EJJ
 DRAWN BY GB
 CHECKED BY HLS

© 2006 KIMLEY-HORN AND ASSOCIATES, INC.
 5200 NW 33RD AVENUE, SUITE 109, FT. LAUDERDALE, FL 33309
 (954) 535-5100
 CA 00000696

DATE 12/09/05
 PROJECT NO. 042701051

COMMERCE BANK OUTPARCEL
EL DORADO HOME FURNISHINGS CENTER
COCONUT CREEK, FL

COCONUT CREEK, BROWARD COUNTY FLORIDA

DESIGN ENGINEER:
 HEATHER SPENCER, P.E.
 FLORIDA REGISTRATION NUMBER:
 59511

SEAL

PHOTOMETRIC PLAN

SHEET NUMBER
PH1