

PLANT LEGEND

QV LIVE OAK 15' HT. X 8' SPR. MIN. 3.5" DBH MIN	BS GUMBO LIMBO 15' HT. X 8' SPR. MIN. 3.5" DBH MIN	MC WAX MYRTLE 15' HT. X 8' SPR. MIN. MULTI 5 TRUNK MIN.	AM CHRISTMAS PALM 8' CT MIN.; TRIPLE	CRI Crinum Lily 7 GAL., 3 PPP, FULL	VIB Viburnum hedge 24" HT.; FULL, TIP TO TIP
CE GREEN BUTTWOOD 14' HT. X 7' SPR.; 3" DBH MIN	CD PIGEON PLUM 10' HT. X 5' SPR. MIN.	VM MONTGOMERY PALM 8' CT, MATCHED	PHO PYGMY DATE PALM 3'-4' OA; TRIPLE	CRO Croton spp. 7 GAL., 30" HT, FULL	DIA Flax lily 20" HT.; 2' OC; FULL
DR ROYAL POINCIANA 15' HT. X 8' SPR. MIN. 3.5" DBH MIN	AR RED MAPLE 12' HT. X 6" SPR. 3" DBH	SP SABAL PALM 12' CT - 18' CT, STG HTS	CHR RED TIP COCOPLUM 30" HT.; PLANT TIP TO TIP; FULL TO BASE	HAM FIREBUSH 18" HT.; 18" OC; FULL	SPA Cordgrass 20" HT.; 2' OC, FULL
LI CRAPE MYRTLE 12' HT. X 5' SPR. MIN. MULTI 5 TRUNK MIN.	IC DAHOON HOLLY 10' HT. X 5' SPR. MIN.	TR THRINAX PALM 8' CT MIN.	CLU CLUSIA HEDGE 24" HT.; PLANT TIP TO TIP; FULL TO BASE	PLU PLUMBAGO 18" HT.; 18" OC; FULL	ZAM FL Coontie 18" HT.; 18" OC
CS DESERT CASSIA 10' HT. X 4' SPR. MIN. FULL	CR CLUSIA STD. 12' HT. X 6" SPR. 3" DBH	SCH SCHEFFLERA ARBORICOLA HEDGE 24" HT.; PLANT TIP TO TIP; FULL TO BASE	TRI SCHEFFLERA TRINETTE 18" HT.; 2' O.C.; FULL TO BASE	FAK DWF FAKAHATCHEE GRASS 24" HT.; FULL, 30" OC	ILE DWF YAUPON HOLLY 12" HT.; 15" OC; FULLY ROOTED POTS
LL LIGUSTRUM 10' HT. X 10' SPR. MUTLI, TREE FORM	LIGUSTRUM 10' HT. X 10' SPR. MUTLI, TREE FORM		SCH SCHEFFLERA ARBORICOLA HEDGE 24" HT.; PLANT TIP TO TIP; FULL TO BASE	JUN JUNIPER 15" HT.; 18" O.C.; FULL	ASP FOXTAIL FERN 12" HT.; 18" OC; FULL

REVISION	DATE
1. DRC rev #1 comments	9/28/18
2. DRC rev #2 comments	11/5/18
3. DRC comments 3/ Lyons rd access rev	12/28/18
	02/19/19
4. DRC client rev. #4 east loop drive	04/08/19
5. DRC comments rev #5	05/06/19

clouding of planting adjustments not shown for clarity purposes. Refer to Comment Responses for detail of revisions

NOTE: Root barriers shall be installed (and included in bidding) by the Landscape Contractor, where required & in accordance to the municipality &/or other regulating agencies. Refer to sheet LP-6 for further details.

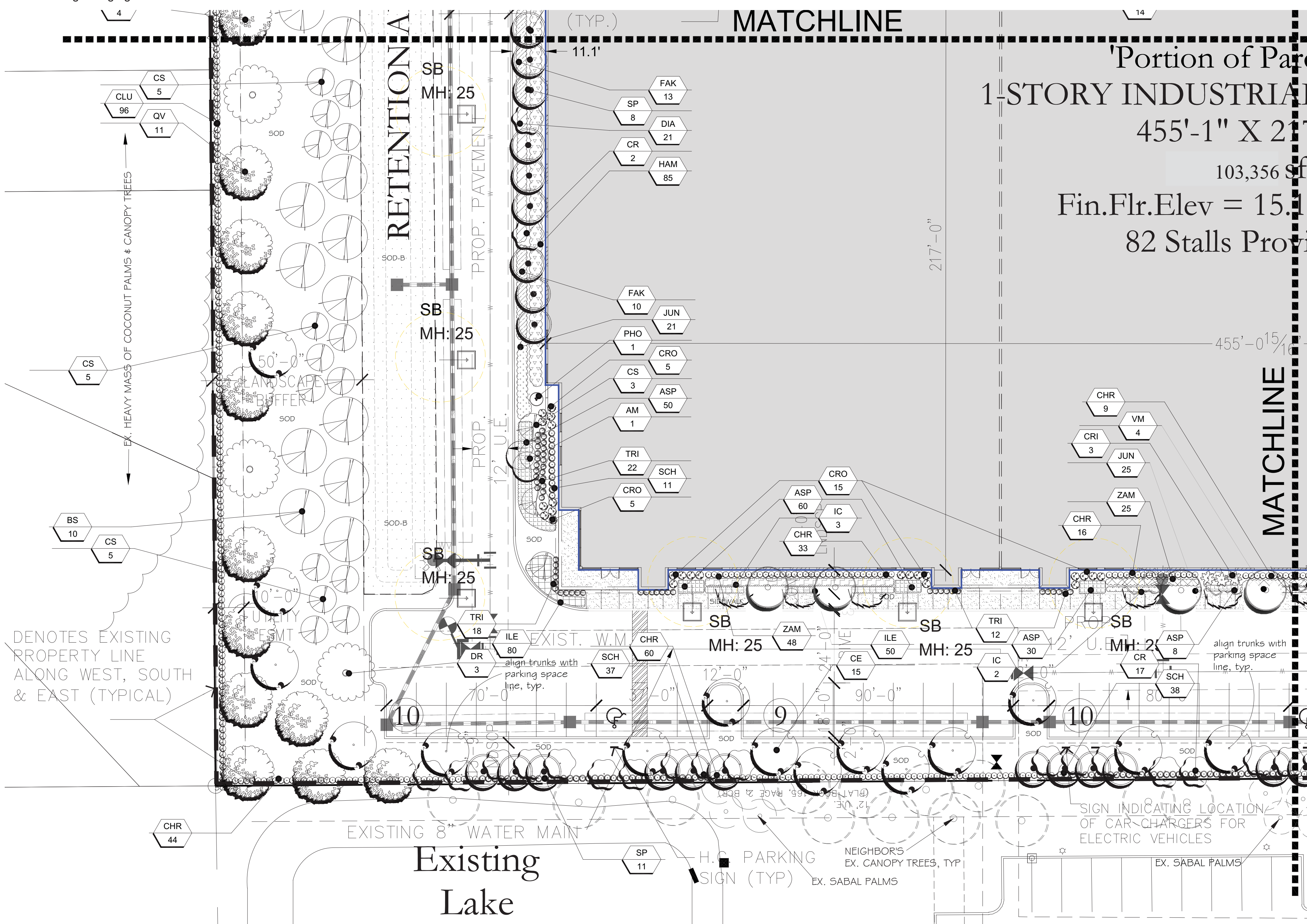

OVERALL SITE - PROPOSED PLANT LIST

TYPE / CATEGORY	KEY	QTY	COMMON NAME	SCIENTIFIC NAME	SIZE / SPECIFICATION	NATIVE	DIVERSITY %	AREA PER TREE (SF)	CANOPY COVERAGE (SF)
TREES									
CANOPY / CAT 1	QV	20	LIVE OAK	Quercus virginiana	15' HT. X 8' SPR. MIN. 3.5" DBH MIN	YES	5.2	300	6000
CANOPY / CAT 1	CR	42	PITCH APPLE	Clusia rosea	12' HT X 9' SPR MIN; 2" DBH, FULL CANOPY	YES	10.8	300	12600
CANOPY / CAT 1	AR	47	RED MAPLE	Acer rubrum	12' HT X 9' SPR MIN; 2" DBH, FULL CANOPY	YES	12.1	300	14100
CANOPY / CAT 1	BS	17	GUMBO LIMBO	Bursera simaruba	15' HT. X 8' SPR MIN. 3.5" DBH MIN	YES	4.4	300	5100
CANOPY / CAT 1	CE	58	GREEN BUTTWOOD	Conocarpus erectus	12' HT X 9' SPR MIN; 2" DBH, FULL CANOPY	YES	15.0	300	17400
CANOPY / CAT 1	DR	6	ROYAL POINCIANA	Delonix regia	15' HT. X 8' SPR MIN. 3.5" DBH MIN	NO	1.6	300	1800
INTERMEDIATE / CAT 2	CS	46	SCRAMBLED EGG TREE	Cassia surattensis	10' HT. X 4' SPR MIN.; 2" DBH, FULL	NO	11.9	150	6900
INTERMEDIATE / CAT 2	CD	6	PIGEON PLUM	Coccoloba diversifolia	10' HT. X 4' SPR MIN.; 2" DBH, FULL	YES	1.6	150	900
INTERMEDIATE / CAT 2	IC	31	DAHOON HOLLY	Ilex cassine	10' HT. X 4' SPR MIN.; 2" DBH, FULL	YES	8.0	150	4650
INTERMEDIATE / CAT 2	LL	8	LIGUSTRUM	Ligustrum spp.	10' HT. X 10' SPR. MUTLI. TREE FORM	NO	2.1	150	1200
SMALL / CAT 3	LI	16	CRAPE MYRTLE	Lagerstroemia spp	8' HT X 4' SPR. MULTI. 5 TRUNK MIN (1.5" DBH PER TRUNK)	NO	4.1	100	1600
SMALL / CAT 3	MC	18	WAX MYRTLE	Myrica carifera	8' HT X 4' SPR. MULTI. 5 TRUNK MIN (1.5" DBH PER TRUNK)	YES	4.7	100	1800
		315	total trees @ 3.1 - 24" tree credits						total = 74,050 SF
PALMS									
CAT 3	SP	55	CABBAGE PALM	Sabal palmetto	18 @ 12' CT, 19 @ 18' CT, 18 @ 24' CT. MIX STG HTS IN GROUPINGS	YES	14.2	100	5500
CAT 3	VM	6	MONTGOMERY PALM	Veitchia montgomeryana	8' CT, MATCHED	NO	1.6	100	600
CAT 4	AM	2	CHRISTMAS PALM	Adonidia merrillii	8' CT, TRIPLE	NO	5	50	100
CAT 4	TR	9	FL THATCH PALM	Thrinax radata	8' CT MIN.	YES	2.3	50	450
		72	total palms @ 3.1 - 24" tree credits				78% o.a.	OF 387 TOTAL PLANT SPECIES	total = 6,650 sf
SHRUBS & GROUNDCOVER									
ACCENT	CRI	16	CRINUM LILY	Crinum asiaticum	7 GAL. MIN, 3PPP, FULL	NO	.7		
ACCENT	PHO	10	PYGMY DATE PALM	Phoenix roebelenii	3'-4' OA, TRIPLE	NO	.4		
HEDGE	CHR	821	RED TIP COCOPLUM	Chrysobalanus icaco 'Red Tip'	30" HT MIN. @ INSTALL; 2' OC; FULL TO BASE	YES	n/a		
HEDGE	CLU	224	SMALL LEAF CLUSIA	Clusia guttifera	24" X 18" MIN. @ INSTALL; 2' OC; FULL TO BASE	NO	n/a		
SHRUB	CRO	108	CROTON SPP.	Codiaeum variegatum	7 GAL. MIN, 30" OA HT, FULL, TIP TO TIP	NO	4.8		
SHRUB	FAK	123	DWF FAKAHATCHEE	Tripsacum floridanum	24" HT MIN. @ INSTALL; 30" OC; FULL	YES	5.5		
SHRUB	HAM	229	FIREBUSH	Hamelia patens	18" HT MIN @ INSTALL; 18" OC; FULLY ROOTED	YES	10.3		
SHRUB	PLU	92	PLUMBAGO	Plumbago zeylanica	18" X 18" MIN.; 18" OC; FULL	NO	4.1		
SHRUB	TRI	153	TRINETTE SCHEFFLERA	Schefflera arboricola 'Trinette'	18" X 18" MIN. @ INSTALL; TIP TO TIP; FULL TO BASE	NO	6.9		
SHRUB	SCH	117	SCHEFFLERA ARBORICOLA	Schefflera arboricola	24" HT MIN @ INSTALL; TIP TO TIP; FULLY ROOTED	NO	5.2		
SHRUB	SPA	40	SAND CORDGRASS	Spartina bakeri	20" X 20"; FULL, 2' OC	YES	1.8		
SHRUB	ZAM	273	FL COONTIE	Zamia floridana	18" HT MIN @ INSTALL; 18" OC; FULLY ROOTED	YES	12.2		
HEDGE	VIB	137	SANDANKWA VIBURNUM	Viburnum suspensum	24" HT MIN. @ INSTALL; PLANT TIP TO TIP; FULL TO BASE	NO	n/a		
SHRUB	DIA	170	VAR. FLAX LILY	Dianella tasmanica variegata	20" X 20"; FULL, 2' OC	NO	7.6		
SHRUB	ILE	270	DWF YAUPON HOLLY	Ilex vomitoria 'Schilling's Dwarf'	12" HT MIN @ INSTALL; 15" OC; FULLY ROOTED	YES	12.1		
		2746	total shrubs						
GROUNDCOVER	ASP	291	FOXTAIL FERN	Asparagus densiflorus var. meyeri	12" OA MIN. @ INSTALL; FULL; 18" OC	NO	13.0		
GROUNDCOVER	JUN	337	PARSONS JUNIPER	Juniper 'parsonii'	15" HT MIN @ INSTALL; 18" OC; FULLY ROOTED	NO	15.1		
		628	total groundcover				54%	OF 2229 TOTAL SPECIES*	*excluding hedges & butterfly areas
SOD-B	TBD		BAHIA SOD	Paspalum notatum	SOD LAID FLAT; END TO END; NO GAPS; ROLLED (RETENTION AREAS ONLY)				
SOD	TBD		ST AUGUSTINE	Stenotaphrum secundatum	SOD LAID FLAT; END TO END; NO GAPS; ROLLED				
	TBD		MULCH		2 CU FT BAGS, NON-CYPRESS, FDA INSPECTED AND CERT. GRADE 'A' (approx btd of at 3" thick min.)				
SUGGESTED HABITAT & BUTTERFLY ENHANCED AREAS									
SHRUB (NECTAR)		12 per area	48	FIREBUSH	Hamelia patens	18" HT MIN @ INSTALL; 18" OC; FULLY ROOTED	YES		
SHRUB (NECTAR)		4 per area	16	FIDDLEWOOD	Citharexylum fruticosum	18" HT MIN @ INSTALL; 18" OC; FULLY ROOTED	YES		
GROUNDCOVER (NECTAR)		8 per area	32	LANTANA	Lantana involucrata	1 GAL. FULLY ROOTED; 15" OC	YES		
SHRUB (FOOD)		12 per area	48	WILD PLUMBAGO	Plumbago scandens	18" HT MIN @ INSTALL; 18" OC; FULLY ROOTED	YES		
SHRUB (FOOD)		8 per area	32	COONTIE	Zamia pumila	18" HT MIN @ INSTALL; 18" OC; FULLY ROOTED	YES		
SHRUB (FOOD)		6 per area	24	BUTTERFLY WEED	Azteclea curassavica	1 GAL. FULLY ROOTED; 15" OC	YES		

LBLA, Inc.
Landscape Architecture
5610 Adair Way
Lake Worth, FL 33467
Phone: 561-644-3237
LbenderLarch@gmail.com
FL-LA666715

ALL DRAWINGS, SPECIFICATIONS AND RELATED DOCUMENTS ARE THE COPYRIGHT PROPERTY OF THE LANDSCAPE ARCHITECT. REPRODUCTION OF DRAWINGS, SPECIFICATIONS AND RELATED DOCUMENTS IN PART OR WHOLE IS FORBIDDEN WITHOUT THE LANDSCAPE ARCHITECT'S WRITTEN PERMISSION.
CONTRACTOR MUST CHECK AND VERIFY ALL DIMENSIONS AND FIELD CONDITIONS AND NOTIFY L.A. ARCHITECT &/OR ENGINEER IMMEDIATELY OF ANY DISCREPANCIES.

Lyons Exchange Center
SPECULATIVE INDUSTRIAL BUILDING
6401 Lyons Road Coconut Creek, Florida
LANDSCAPE PLAN

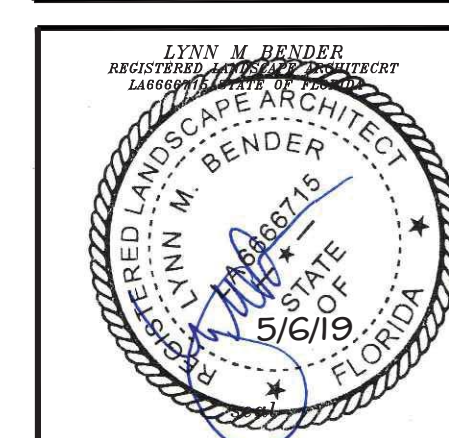

PROJECT NO: 18-030 (HNM)
CADD I.D.: LYONS EXCHANGE
DRAWN BY: LMB
CHECKED BY: LMB
SCALE: 1" = 20'-0"
DATE: AUGUST 28, 2018

Scale in Feet
1" = 20' - 0"
www.callsunshine.com