

"FISHERMANS LANDING AT COCONUT CREEK"

REVISIONS	BY	D

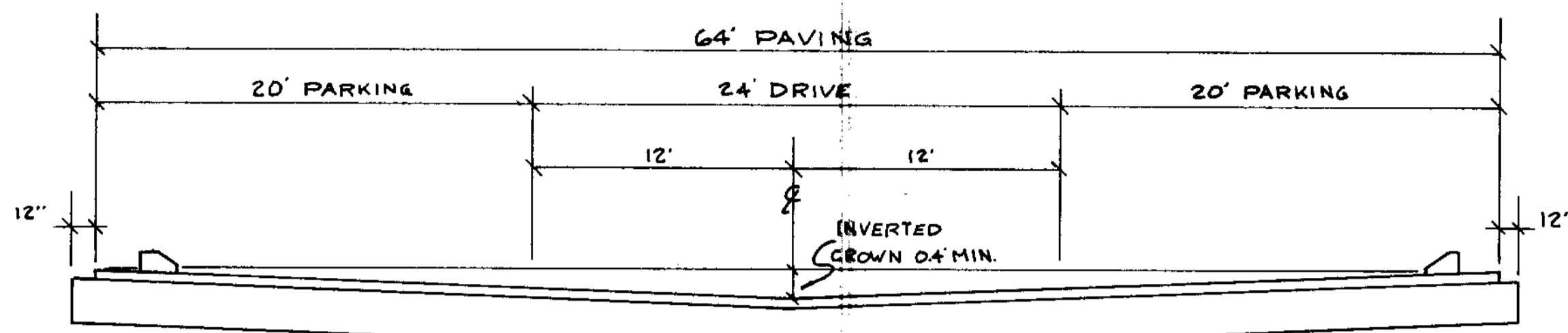

TYPICAL PARKING
N.T.S.

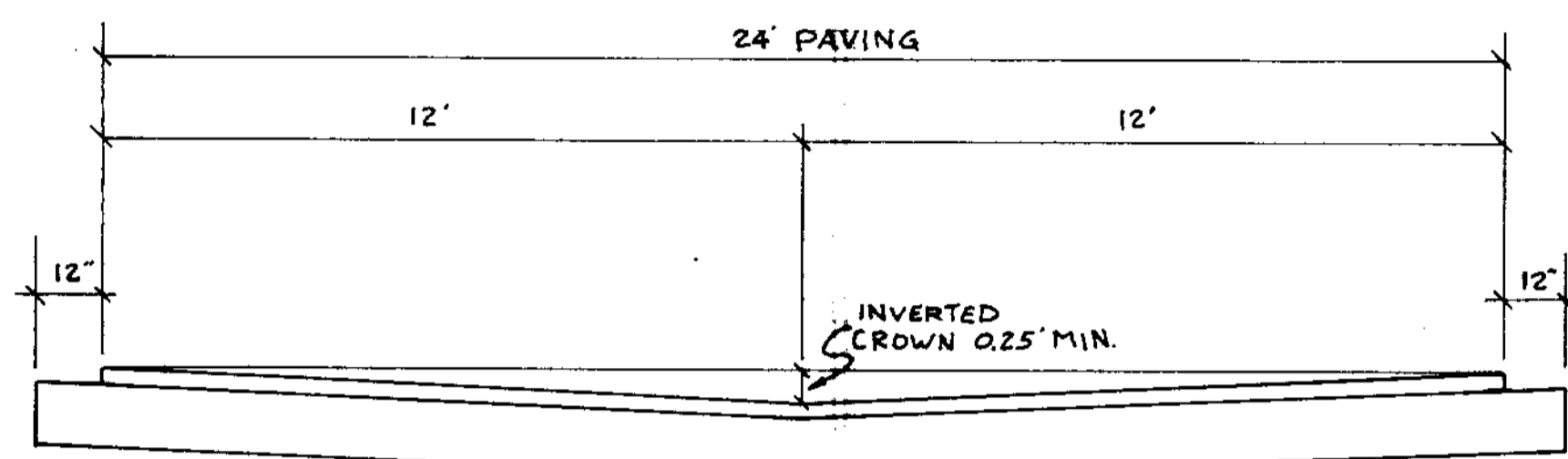

TYPICAL INTERIOR ROAD
N.T.S.

PARKING AND ROAD SPECIFICATIONS
 1" COMPACTED ASPHALTIC CONCRETE TYPE 51 SURFACE COURSE.
 8" COMPACTED LIMESTONE BASE COURSE
 REMOVE ALL MUCK, OVERBURDEN AND ROOT MATERIAL WITHIN THE LIMITS OF ALL PARKING, DRIVE AND ROAD CONSTRUCTION, BACK-FILL TO REQUIRED SUBGRADE WITH CLEAN, GRANULAR MATERIAL IN MAXIMUM 12 INCH LIFTS, COMPACTED TO AT LEAST 98% OF MAXIMUM DENSITY IN ACCORDANCE WITH AASHTO T-180 SPECIFICATIONS.

- LEGEND**
- 13.0 - EXISTING GRADE
 - (15.0) - PROPOSED FINISHED ELEVATION
 - - PROPOSED STORM DRAIN - C.M.P.
 - 15.2 - TENTATIVE FINISHED FLOOR ELEVATION

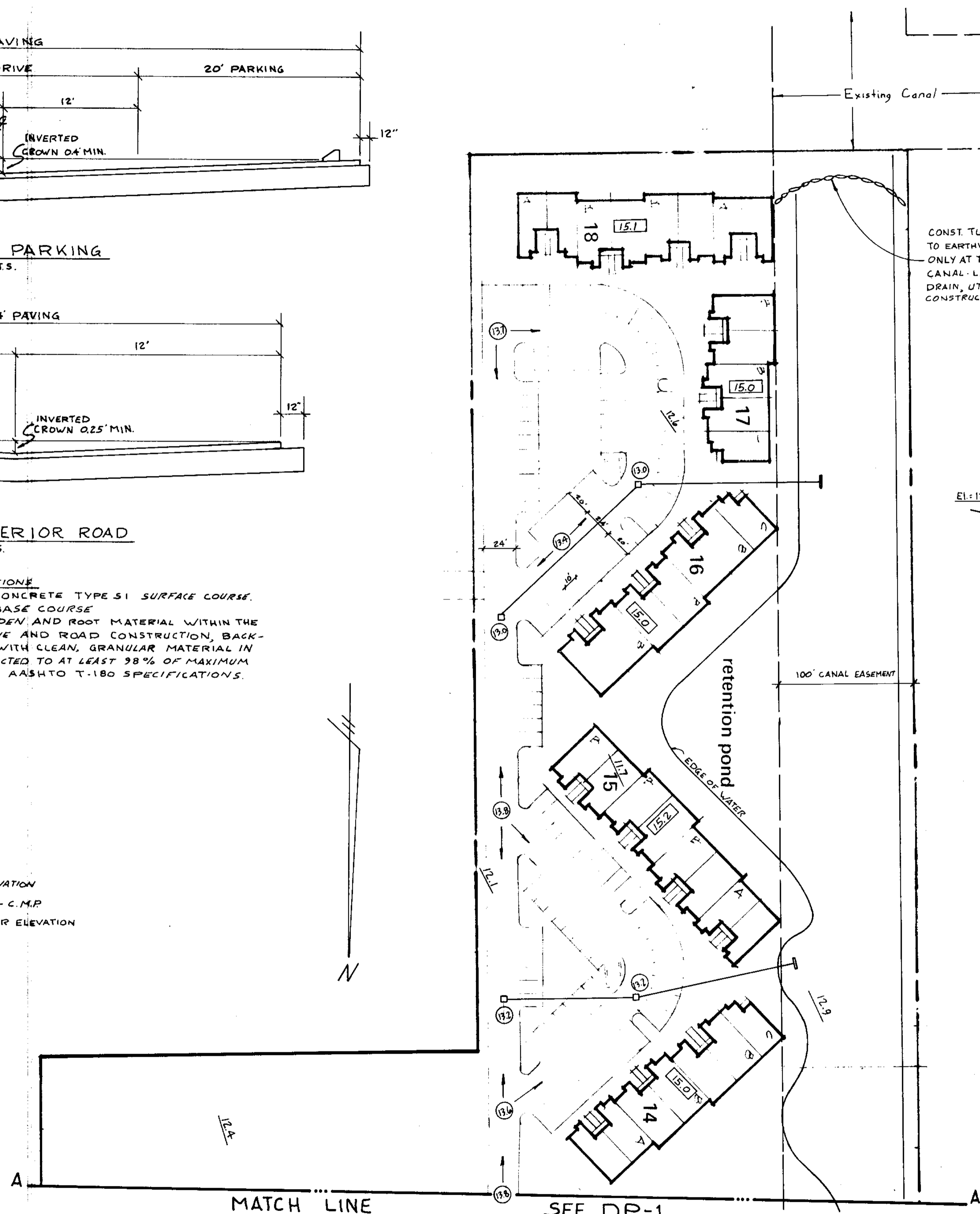

CONST. TURBIDITY BARRIER PRIOR TO EARTHWORK EXCAVATION. REMOVE ONLY AT THE COMPLETION OF ALL CANAL-LAKE EXCAVATION, STORM DRAIN, UTILITY AND PAVING CONSTRUCTION

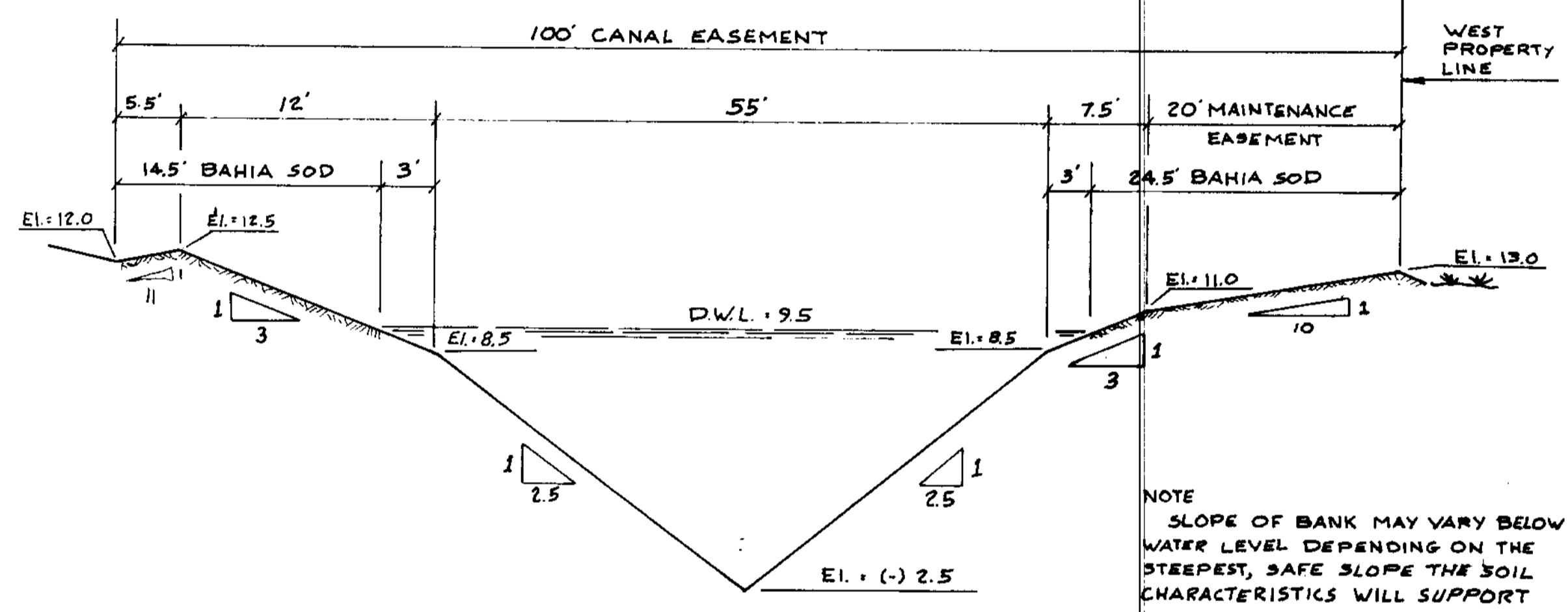

TYPICAL CANAL

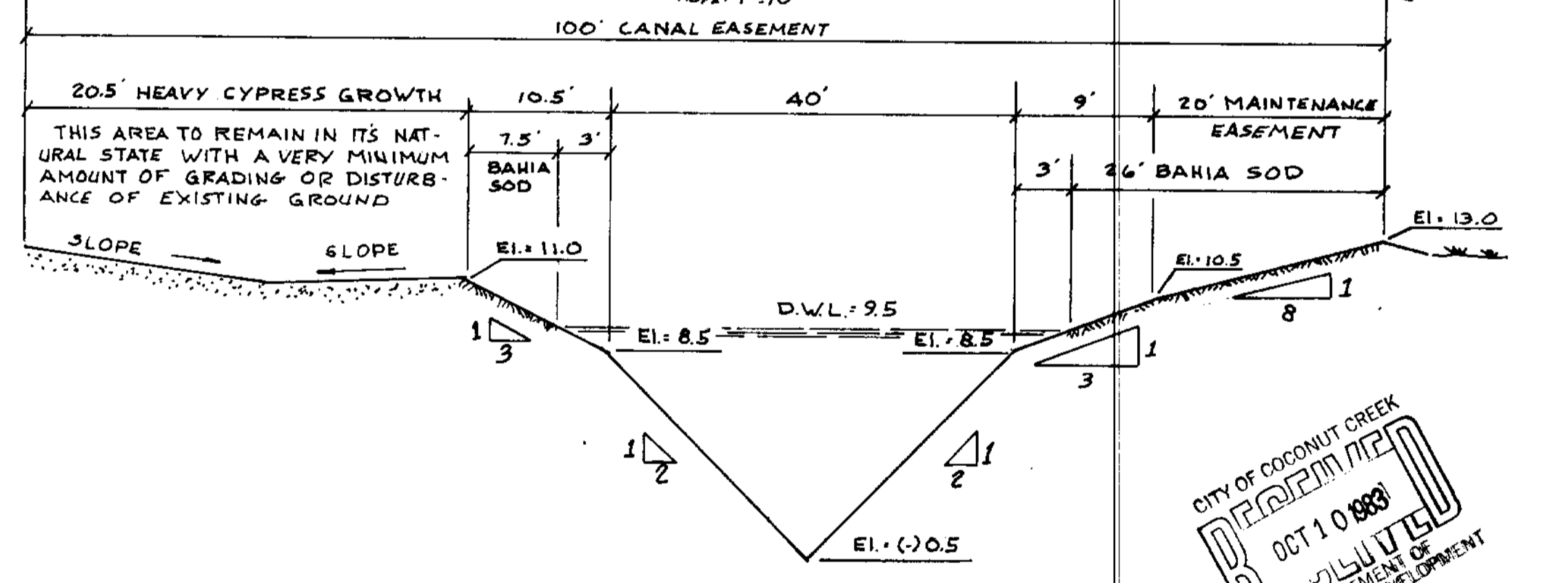

TYPICAL MODIFIED CANAL

NOTE
SLOPE OF BANK MAY VARY BELOW WATER LEVEL DEPENDING ON THE STEEPEST, SAFE SLOPE THE SOIL CHARACTERISTICS WILL SUPPORT



J.W. McLaughlin
 J.W. McLAUGHLIN
 REGISTERED ENGINEER NO. 17174
 STATE OF FLORIDA

PRELIMINARY

PAVING, GRADING AND DRAINAGE PLAN
 N.E. 1/4 SEC. 19-48-42
 CITY OF COCONUT CREEK, FLORIDA

"FISHERMANS LANDING AT COCONUT CREEK"

McLAUGHLIN ENGINEERING CO.
 FORT LAUDERDALE, FLORIDA
 AND
 JOHN B. SMITH ENGINEERS, INC.
 MARGATE, FLORIDA

SCALE: 1" = 50' DATE: OCT. 7, 1983