

JOHNSON TECHNOLOGY CTR. PLANTLIST

SYM.	NATIVE	NAME	BOTANICAL NAME	SPECIFICATION
TREES				
CD	YES	5 PIGEON PLUM	<i>Coccoloba diversifolia</i>	12' x 6' apr. 2 1/2' cal.
CET	YES	18 SILVER BUTTWOOD	<i>Conocarpus erect.</i> 'Sericeus'	10' x 6', STANDARD
C9	YES	4 ORANGE GEIGER	<i>Cordia sebestena</i>	FG, 8' x 5', 2' cal.
IC	YES	14 DAHOON HOLLY	<i>Ilex cassine</i>	10' x 5' apr., 2' cal.
LB	YES	16 WILD TAMARIND	<i>Lysiloma latifolia</i>	12' x 6' apr. 2 1/2' cal.
MF	YES	34 SIMPSON'S STOPPER	<i>Myrcianthes fragrans</i>	10' x 6', max. 5 tks. @ o.a. ht.
FEL	YES	29 SLASH PINE	<i>Pinus elliotii</i>	FG, RFG, 12' o.a., 3' cal.
QV6	YES	19 LIVE OAKS	<i>Quercus virginiana</i>	16' x 1' apr., 4' cal., 6' ct.
PALMS				
ARC	6	KING ALEXANDER PALMS	<i>Archontophoenix alexandrae</i>	16' o.a., TRIFLE, full head
RE	YES	6 ROYAL PALMS	<i>Roystonea elata</i>	6' GW, 25' o.a. full head
VM2	6	MONTGOMERY PALMS	<i>Veitchia montgomeryana</i>	DBL. TK, FG, 14' o.a., full head
SHRUBS				
CCT	YES	295 JAMAICA CAPER	<i>Capparis cynophallophora</i>	1 gal., 30' x 24', 24' o.c. full
CIT	YES	162 COCOPLUM	<i>Chrysobalanus icaco</i>	1 GAL., 30' x 24' full, 24' o.c.
CRT	YES	85 FITCH APPLE	<i>Clusia rosea</i>	1 GAL., 36' ht., 30' ØC, FTB.
CEH	YES	200 GREEN BUTTWOOD	<i>Conocarpus erectus</i>	3 gal., 24' x 24', 24' o.c. full
HPD	YES	145 DWARF FIREBUSH	<i>Hamelia nodosa</i>	3 gal., 18' x 18', 18' o.c.
HP	YES	360 FIREBUSH	<i>Hamelia patens</i>	3 gal., 24' x 24', 24' o.c. full
PY5	YES	32 WILD COFFEE	<i>Pyschotria nervosa</i>	3 gal., 18' x 18', 24' o.c. full
ACCENTS AND GROUND COVER PLANTS				
CAT	36	CAT PALMS	<i>Chamadorea cataractarum</i>	15 gal., 3' x 3', 30' o.c.
BLU	310	BLUEBERRY FLAX LILY	<i>Dianella taenianica</i>	3 gal., 12' x 18', 18' o.c. full
FGI	280	'GREEN ISLAND' FIGUS	<i>Ficus 'Green Island'</i>	3 gal., 18' x 18', 18' o.c. full
BUR	35	PHILODENDRON 'ROJO CONGO'	<i>Philodendron spp.</i>	3 gal., 18' x 18', 18' o.c. full
IND	180	INDIAN HAWTHORNE	<i>Rhapidolepis indica</i>	3 gal., 18' x 18', 24' o.c. full
SPY	40	YELLOW GROUND ORCHIDS	<i>Spathoglottis gracilis</i>	1 gal., 10' x 10', 12' o.c.
FGG	YES	390 FLORIDA GAMA GRASS	<i>Tripsacum floridana</i>	1 gal., 12' x 12', 18' o.c. full
SOD				
FLO	20,000 SF.	'FLORATAM' ST. AUGUSTINE	<i>Stenotaphrum secundatum</i>	SOLID SOD, price per s.f.
TOPSOIL:				
	40 C.Y.	TREES, PALMS, SHRUBS AND GROUNDCOVERS		
	100 C.Y.	AREA TO BE SODDED WITH A 2" DEPTH OF TOPSOIL SPREAD IN PLACE		
MULCHING:				
	50 C.Y./-	'DECO BARK' MULCH	3' DEPTH, SPREAD IN PLACE, ATLAS PEAT AND SOIL	PROVIDE SAMPLE FOR APPROVAL PRIOR TO INSTALLATION
	---	TOPSOIL, SOD AND MULCH QUANTITIES SHOWN ARE APPROXIMATE, CONTRACTOR TO PROVIDE A UNIT PRICE PER UNIT AND WILL BE PAID ON THAT UNIT PRICE BASIS UPON FINAL INSPECTION AND APPROVAL.		

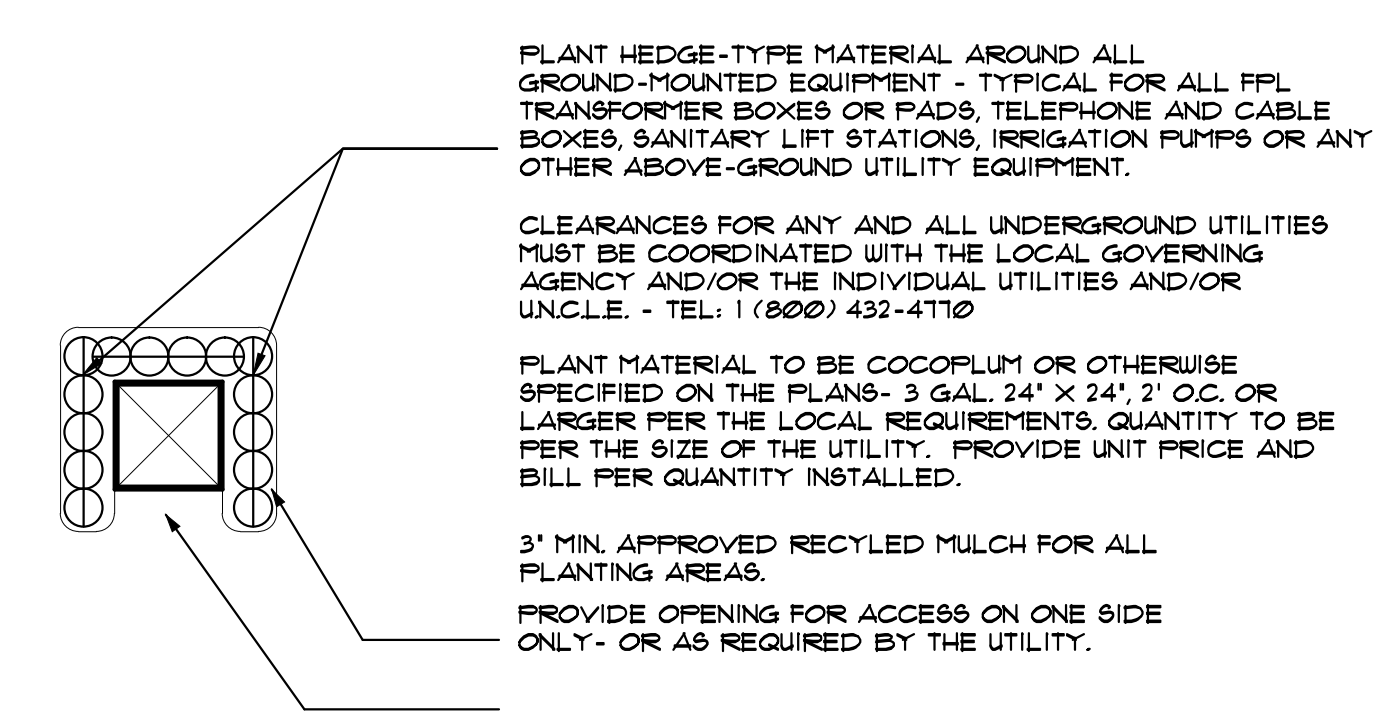

TYPICAL PLANTING SCREEN FOR GROUND-MOUNTED EQUIPMENT
 N.T.S.

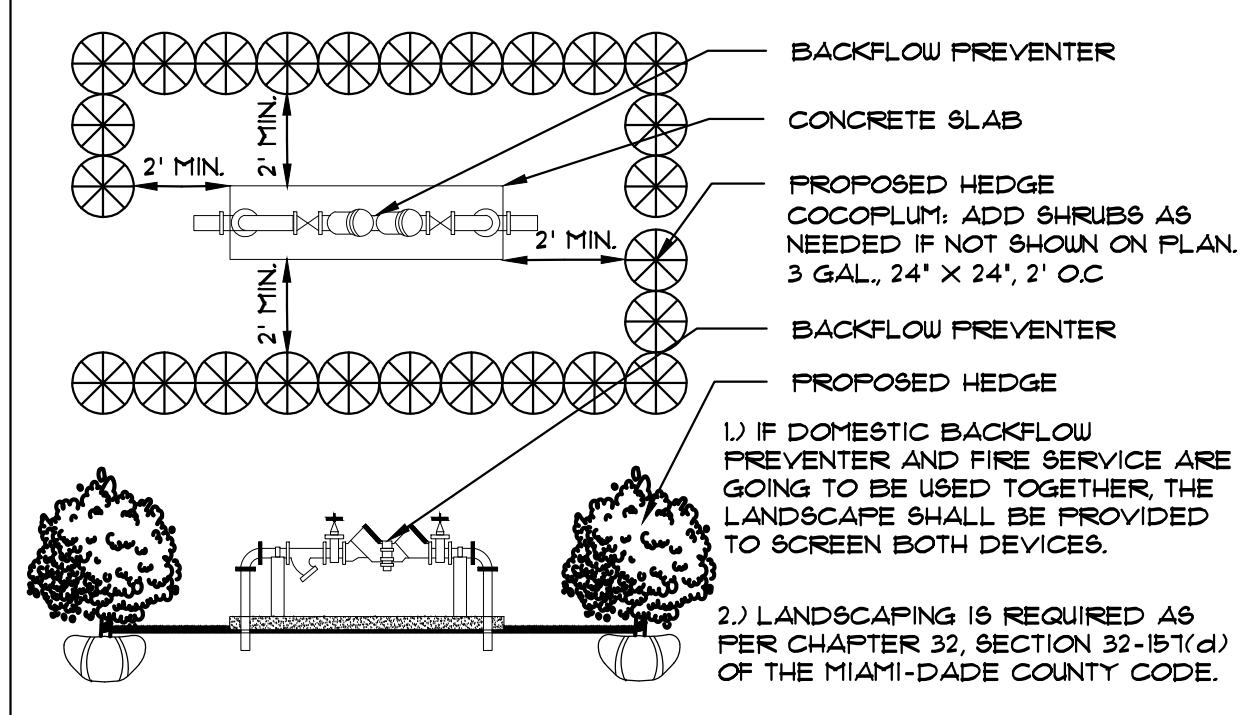

TYPICAL PLANTING SCREEN FOR ABOVE-GROUND UTILITIES
 N.T.S.

LANDSCAPE NOTES

- ALL PLANT MATERIAL SHALL BE FLORIDA NO. 1 GRADE OR BETTER.
- CONTRACTOR SHALL FAMILIARIZE HIMSELF WITH THE LOCATION OF AND AVOID AND PROTECT UTILITY LINES, BURIED CABLES, AND OTHER UTILITIES.
- TREE, PALM, ACCENT AND BED LINES ARE TO BE LOCATED IN THE FIELD AND APPROVED BY THE LANDSCAPE ARCHITECT PRIOR TO INSTALLATION.
- ALL PLANTING SOIL SHALL BE 50:50 TOPSOIL: SAND MIX FREE OF CLAY, STONES, ROCKS, OR OTHER FOREIGN MATTER. THIS SPECIFICATION INCLUDES ALL BACKFILL FOR BERMS AND OTHER LANDSCAPE AREAS.
- SODDED-LAWN AREAS
 2" DEPTH PLANTING SOIL SPREAD IN PLACE- THROUGHOUT.
 GROUNDCOVER PLANTING BEDS:
 6" DEPTH PLANTING SOIL SPREAD IN PLACE- THROUGHOUT.
 SHRUB AND HEDGE PLANTING AREAS:
 12" DEPTH PLANTING SOIL SPREAD IN PLACE- THROUGHOUT.
 TREES, PALMS, SPECIMEN PLANT MATERIAL:
 24" DEPTH PLANTING SOIL SPREAD IN PLACE OR, TO THE DEPTH OF THE ROOTBALL OR CONTAINER WHICHEVER IS GREATEST.
 LANDSCAPE ISLANDS AND BUILDING FOUNDATIONS:
 EXCAVATE AND REMOVE ALL LIMESTONE, ROCKS, DEBRIS, ETC. TO A DEPTH OF 12" AND BACKFILL W/ 50:50 TOPSOIL: SAND MIX.
 BUILDING FOUNDATIONS SHALL BE THE SAME DEPTH TO A WIDTH OF 36" FROM THE BUILDING BASE.
- THE SITE CONTRACTOR SHALL BE RESPONSIBLE TO BRING ALL GRADES TO WITHIN 2" OF FINAL GRADES. THIS SHALL INCLUDE A 2" APPLICATION OF 50:50 TOPSOIL: SAND MIX FOR ALL LANDSCAPE AND AREAS TO BE SODDED.
- THE LANDSCAPE CONTRACTOR SHALL CALCULATE AND SUBMIT AN ITEMIZED PRICE FOR THE 2" APPLICATION OF 50:50 MIX FOR ALL SOD AREAS AS A REFERENCE IN THE CASE THAT THERE WOULD BE A DISCREPANCY BETWEEN SITE AND LANDSCAPE CONTRACTORS AND NOTIFY THE SITE CONTRACTOR OR PROJECT SUPERINTENDENT AS TO THIS DISCREPANCY. IT WILL THEN BE DETERMINED WHICH PARTY WILL PROVIDE THIS 2" TOPSOIL: SAND APPLICATION AND SUBSEQUENT PAYMENT.
 OTHER PLANTING SOIL MIXES TO BE ADDED, I.E. FOR TREES, PALMS, SPECIMEN PLANTS, SHRUBS AND GROUNDCOVERS SHALL BE THE RESPONSIBILITY OF THE LANDSCAPE CONTRACTOR AND BE INCLUSIVE WITH THE LANDSCAPE BID.
- CONTRACTOR SHALL COORDINATE WITH THE IRRIGATION CONTRACTOR AND LEAVE PROVISIONS FOR ALL, INCLUDING UNDERGROUND UTILITY LINE LOCATIONS DIAL 811 "NO CUTS" AS REQUIRED BY LAW.
- ALL PLANTING BEDS SHALL BE MULCHED TO A DEPTH OF 3" WITH AN APPROVED RECYCLED MULCH BY THE PRESIDING GOVERNING AGENCY. NO HEAVY METALS, I.E. ARSENIC, LEAD, ETC. ARE TO BE CONTAINED IN THE MULCH AND THE CONTRACTOR SHALL PROVIDE CERTIFICATION OR PROOF THAT ALL MULCH IS FREE OF HEAVY METALS OR SIMILAR ENVIRONMENTAL CONTAMINANTS.
- SOD SHALL BE ARGENTINE 'BAHIA' OR ST. AUGUSTINE 'FLORATAM' AS SHOWN ON THE PLANS, STRONGLY ROOTED, FREE FROM WEED, FUNGUS, INSECTS AND DISEASE. CONTRACTOR SHALL SOD ALL AREAS AS INDICATED ON THE PLAN OR AS DIRECTED. PAYMENT SHALL BE DETERMINED BY THE TOTAL MEASURED SODDED AREAS X THE UNIT PRICE SUBMITTED AND FIELD VERIFIED.
- SOD SHALL BE INSTALLED IN ACCORDANCE WITH THE SPECIFICATIONS AS DEFINED BY FDOT. SOD SHALL CARRY A 5-MONTH WARRANTY.
- ALL TREES, PALMS, SHRUBS AND GROUNDCOVERS SHALL CARRY A ONE-YEAR WARRANTY FROM THE DATE OF FINAL ACCEPTANCE.
- ALL TREES AND PALMS SHALL BE STAKED PER ACCEPTED STANDARDS BY THE FLORIDA NURSERYMEN & GROUERS LANDSCAPE ASSOCIATION (FNGLA). THERE SHALL BE ONE FINAL INSPECTION FOR APPROVAL BY THE PRESIDING GOVERNING AGENCY. CONTRACTOR SHALL INSURE THAT THE PLANS, DETAILS, SPECIFICATIONS AND NOTES HAVE BEEN ADHERED TO AND THAT THE LANDSCAPE AND IRRIGATION INSTALLATION IS COMPLIANT TO ALL ITEMS AS DIRECTED ON THE PLANS PRIOR TO SCHEDULING OF THE FINAL INSPECTION.
- THE PLANT LIST IS INTENDED ONLY AS AN AID TO BIDDING. ANY DISCREPANCIES FOUND BETWEEN THE QUANTITIES ON THE PLAN AND PLANT LIST, THE QUANTITIES ON THE PLAN SHALL BE HELD VALID.
- IRRIGATION SHALL PROVIDE FOR A 100% COVERAGE WITH A 100% OVERLAP AUTOMATIC SYSTEM W/ RAIN MOISTURE SENSOR ATTACHED TO CONTROLLER. ALL FLORIDA BUILDING CODE APPENDIX 'F' IRRIGATION REQUIREMENTS SHALL BE STRICTLY ADHERED TO FOR INSTALLATION AND PREVAILING WATER MANAGEMENT DISTRICT RESTRICTIONS AND REGULATIONS SHALL BE IN COMPLIANCE FOR POST-INSTALLATION WATERING SCHEDULES.
- EXISTING IRRIGATION SYSTEM (IF APPLICABLE) SHALL BE RETROFITTED TO COMPLY WITH THOSE SPECIFICATIONS AS OUTLINED ABOVE.
- CONTRACTOR SHALL PROVIDE A WATER TRUCK DURING PLANTING TO INSURE PROPER WATERING- IN DURING INSTALLATION AND WILL BE RESPONSIBLE FOR CONTINUAL WATERING UNTIL FINAL ACCEPTANCE BY THE OWNER.
- ALL EXISTING TREES, PALMS AND PLANT MATERIAL TO REMAIN SHALL BE PROTECTED DURING CONSTRUCTION. CONTRACTOR SHALL INSTALL PROTECTIVE BARRIERS SUCH AS 'TENAX' PROTECTIVE FENCING OR AS SHOWN ON THE DETAILS TO BE INSTALLED AT THE BEGINNING OF THE PROJECT. BARRIERS SHALL BE LOCATED TO INCLUDE THE DRIPLINE OF THE TREES, PALMS AND PLANT MATERIAL WHERE POSSIBLE. THE CONTRACTOR SHALL TAKE EXTRA CAUTION TO PREVENT ANY DAMAGE TO THE TRUNK, BRANCHES, ROOTS, ROOT ZONE AREAS AND ADJACENT GRADES.
- EXISTING TREES AND PALMS TO REMAIN SHALL BE TRIMMED PER ANSI-300 STANDARDS. SUPERVISION OF THE TRIMMING SHALL BE PERFORMED BY AN ISA-CERTIFIED ARBORIST.
- ALL EXISTING TREES AND PALMS SHALL BE 'LIFTED AND THINNED' TO PROVIDE FOR AN 8' MINIMUM CLEARANCE FOR SIDEWALKS AND PEDESTRIAN WALKWAYS AND A 14' MINIMUM CLEARANCE FOR ROADWAYS, DRIVEWAYS, AND ALL VEHICULAR USE AREAS.
- REMOVAL OF ANY TREES OR PALMS WILL REQUIRE A WRITTEN 'TREE REMOVAL PERMIT' FROM THE LOCAL GOVERNING AGENCY PRIOR TO REMOVAL.

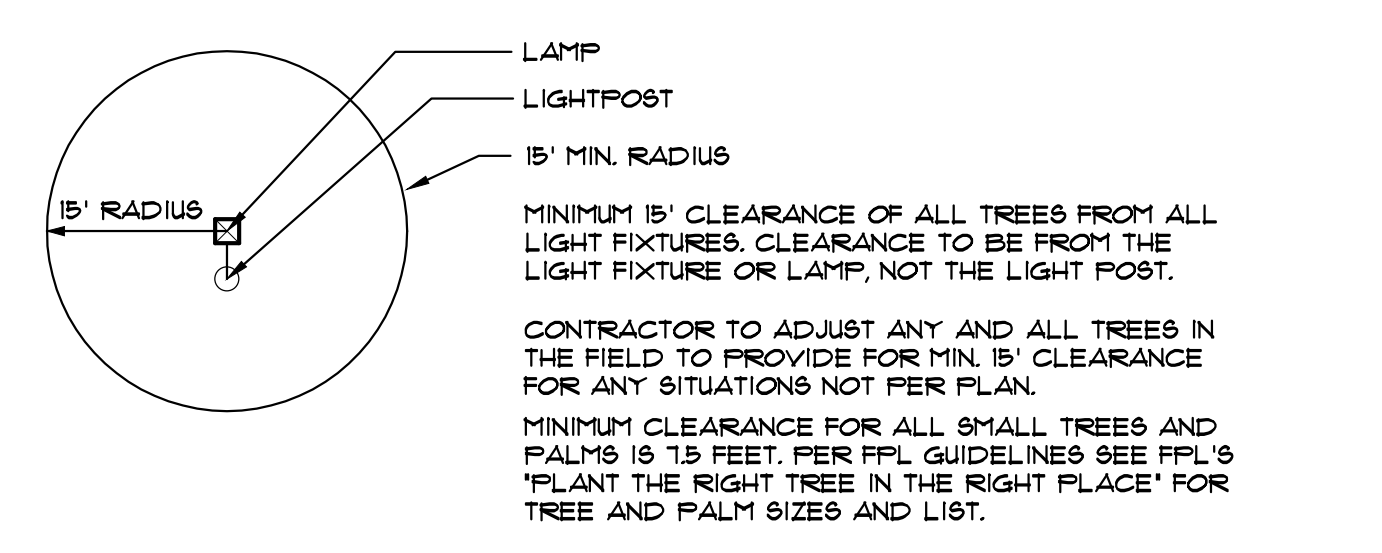

MINIMUM TREE CLEARANCE FROM LIGHT FIXTURES
 N.T.S.

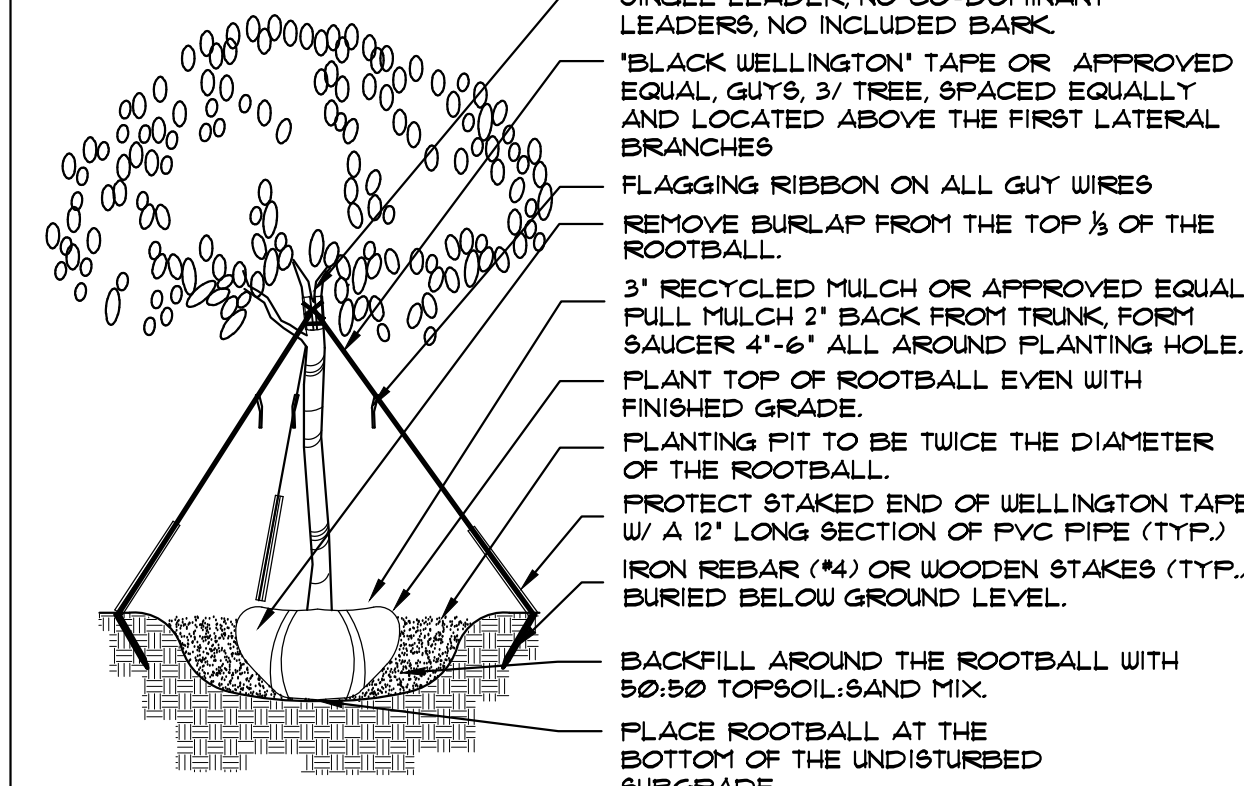

TREE PLANTING DETAIL
 N.T.S.

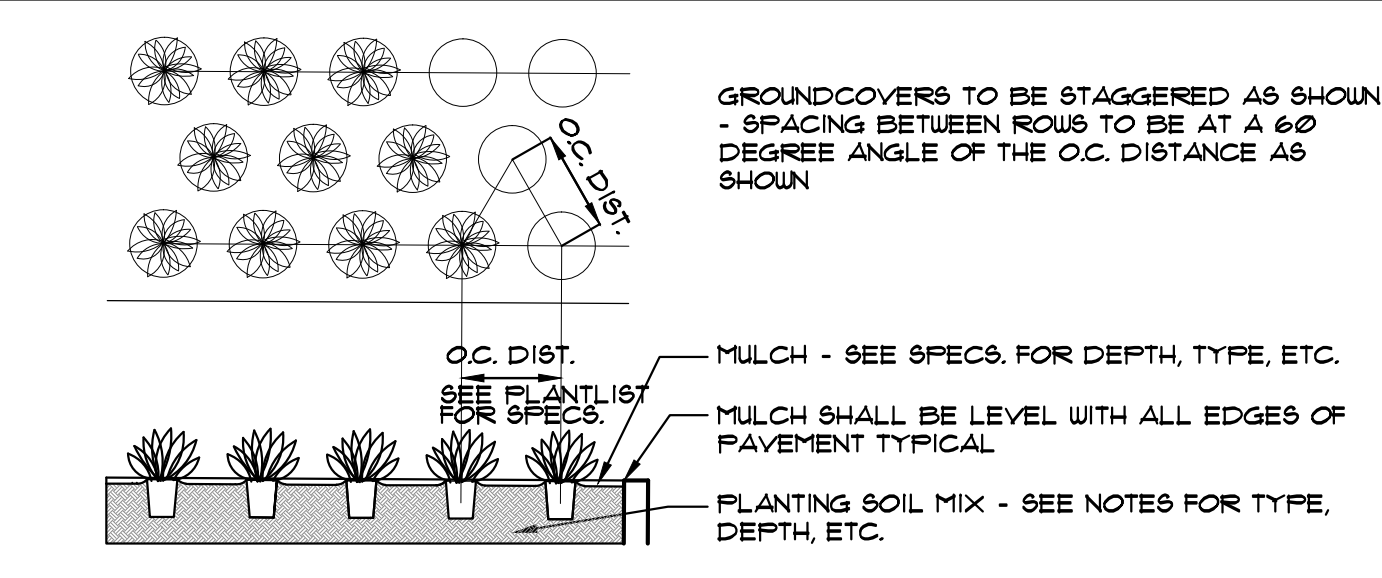

GROUNDCOVER PLANTING DETAIL
 N.T.S.

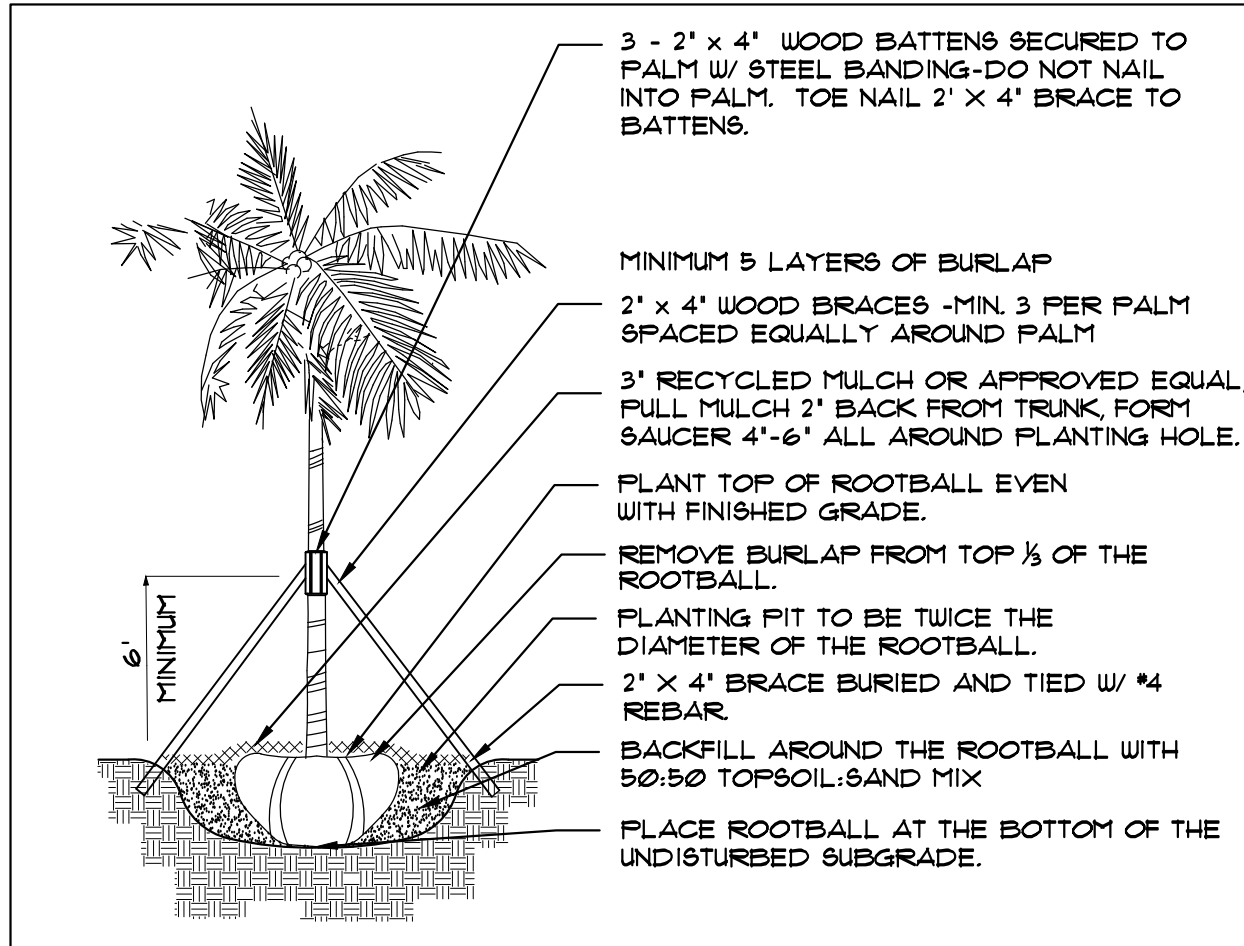

PALM PLANTING DETAIL
 N.T.S.

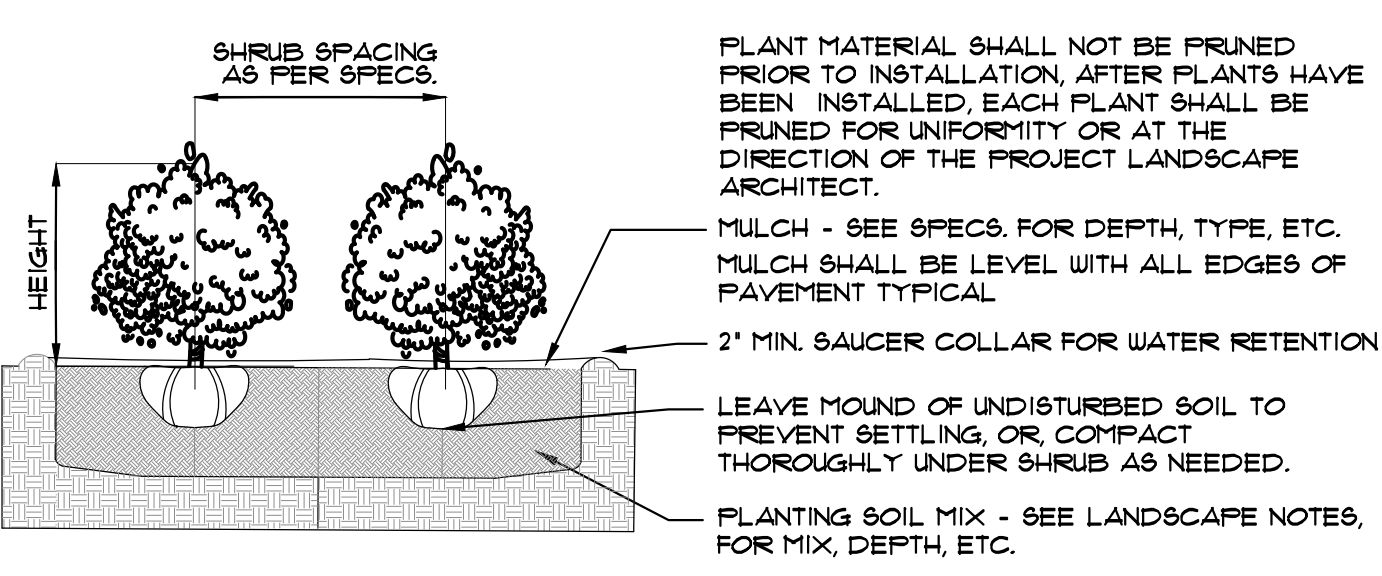

SHRUB PLANTING DETAIL
 N.T.S.

FERTILIZATION:
 ONE COMPLETE APPLICATION OF GRANULAR FERTILIZER SHALL BE APPLIED PRIOR TO FINAL ACCEPTANCE AND APPROVAL BY THE LANDSCAPE ARCHITECT. AN ADDITIONAL FERTILIZATION PROGRAM SHALL BE SUBMITTED TO THE PROJECT MANAGER FOR AN ANNUAL FERTILIZATION APPLICATION PROGRAM. FERTILIZERS SHALL BE PER ATLANTIC -AFEC FERTILIZER & CHEMICAL (AFEC) OR AN APPROVED EQUAL. CONTRACTOR SHALL SUBMIT FERTILIZATION AS A SEPARATE ITEM IN THE BID.
 FERTILIZATION SHALL BE AS FOLLOWS: TREES: 12-06-08 (AFEC # 5231) RATE: 15 LBS/ INCH OF DIA. @ DBH PALMS: 12-04-12 (AFEC # 7216) RATE: 15 LBS/ INCH OF DIA. @ DBH SHRUBS AND GROUNDCOVERS: (12-06-08 AFEC # 5231) RATE: 15 OZ. FT. OF HEIGHT

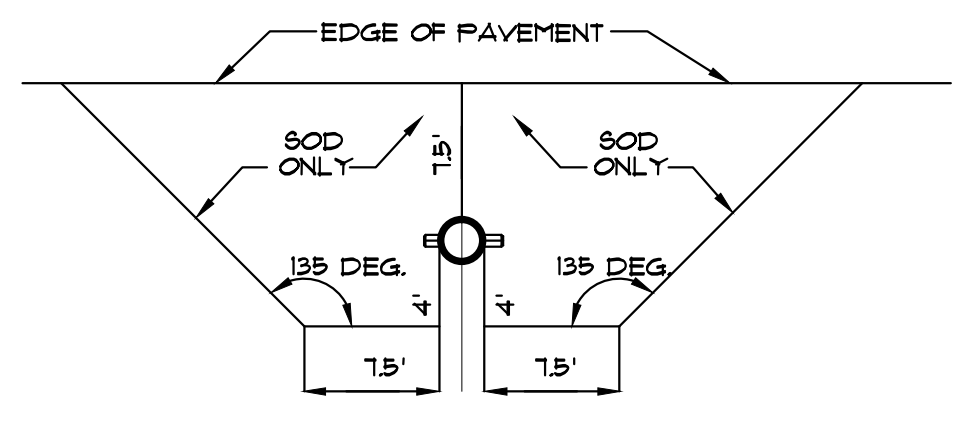

REQUIREMENTS APPLY TO FIRE HYDRANTS, SIAMSE CONNECTIONS AND ANY OTHER FIRE EQUIPMENT FOR UTILIZING FIRE HOSE, ON PUBLIC OR PRIVATE PROPERTY.
 BY THE AUTHORITY OF THE FLORIDA BUILDING CODE.
 THE CLEAR ZONE SHALL BE FREE OF LANDSCAPE (EXCEPT SOD), MAILBOXES, PARKING, LAMP-POSTS AND ALL OTHER OBJECTS.
 EXCEPTIONS: OTHER FIRE FIGHTING EQUIPMENT OR TRAFFIC POSTS TO PREVENT FIRE FIGHTING EQUIPMENT.

FIRE HYDRANT CLEAR ZONE DETAIL
 N.T.S.

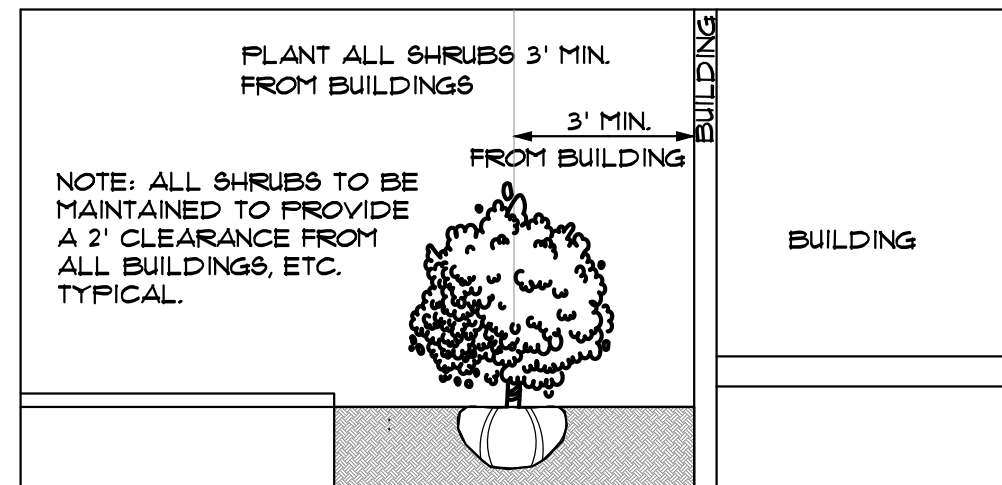

SHRUB PLANTING ADJACENT TO BUILDINGS DETAIL
 N.T.S.

A WRITTEN TREE REMOVAL PERMIT IS REQUIRED FROM THE CITY OF COCONUT CREEK PRIOR TO REMOVAL OF ANY TREES FROM THIS SITE.
 SEE L-4 FOR JOHNSON ROAD PCD INFORMATION.

LANDSCAPE DETAILS, SPECIFICATIONS, ETC.

NO.	DATE	DESCRIPTION

DATE:
 Mar. 2013

SCALE:
 AS SHOWN

DESIGNED BY:
 M.G.

DRAWN BY:
 A.E.V.

JOB NUMBER
 12-3516

SHEET No.
 L-3

SEAL
 JAMES F. SOOSH
 R.L.A. # 020112