

STATE ROAD #7  
(200' R/W Per FDOT MAP 86100-2532)

AMERICA'S TOP TEAM

anderson  
architecture, inc.

399 CAMINO GARDENS BLVD.  
SUITE 202  
BOCA RATON, FLORIDA 33432  
V: 561.382.0220  
www.andersonarchitecture.com

**SUN-TECH**  
Sun-Tech  
Engineering, Inc.  
Engineers - Planners - Surveyors  
1600 West Oakland Park Boulevard  
Ft. Lauderdale, FL 33311  
www.suntecheng.com  
Phone (954)777-3123  
Fax (954)777-3114  
Certificate of Auth. # 7097

May 02 2016  
CLIFFORD R. LOUTAN, P.E.  
FL. REG. NO. 56890

A Site Plan Approval for:  
**RESIDENCE INN  
BY MARRIOTT**  
State Road 7  
Coconut Creek, Florida

RECYCLING  
5/2/16

14-030  
ERIC ANDERSON  
CH

3744d  
02-23-15

SCHEMATIC  
PAVING &  
DRAINAGE  
PLAN

C1

2 C

AA 000197

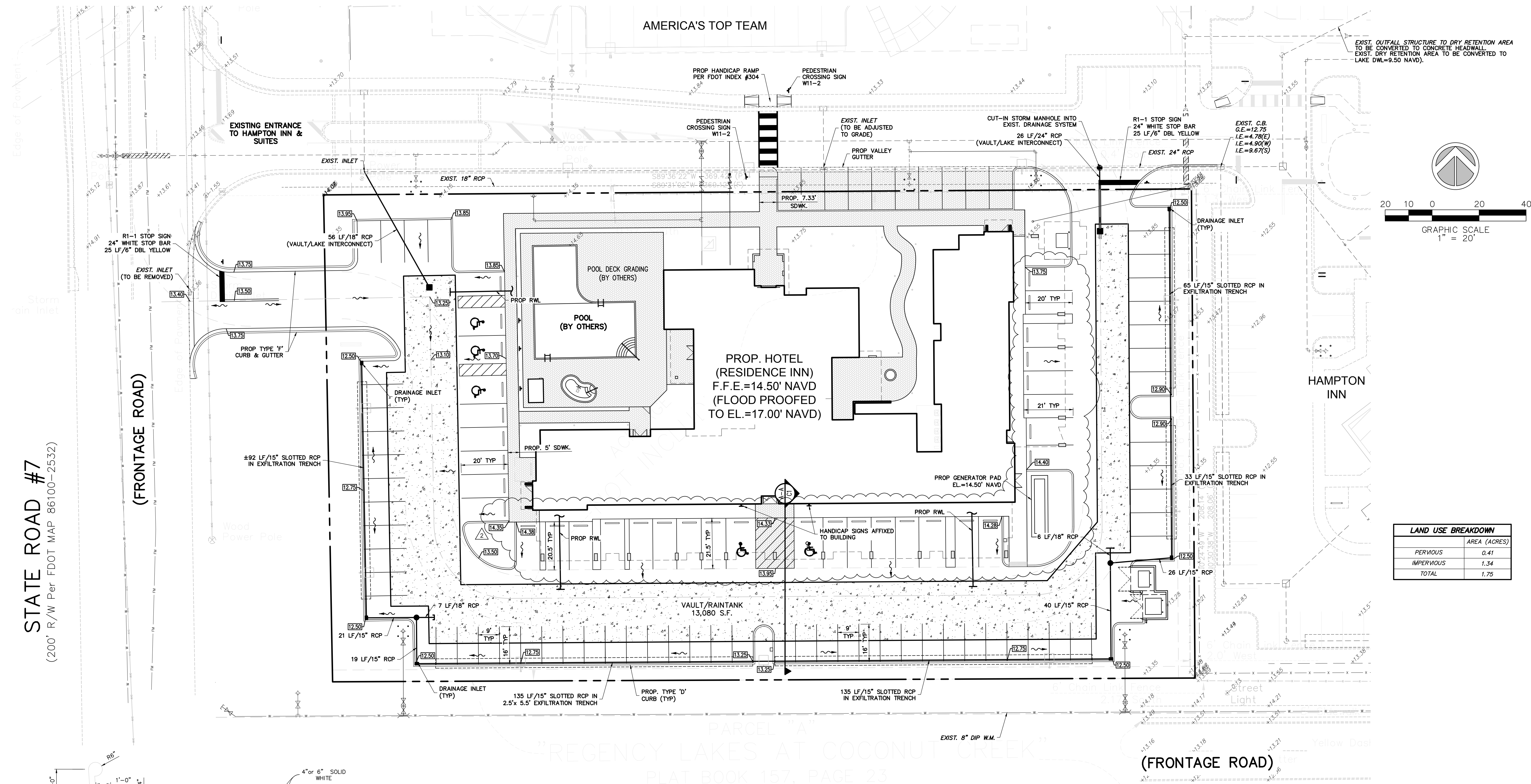

EXIST. OUTFALL STRUCTURE TO DRY RETENTION AREA TO BE CONVERTED TO CONCRETE HEADWALL. EXIST. DRY RETENTION AREA TO BE CONVERTED TO LAKE DWL=9.50 NAVD).

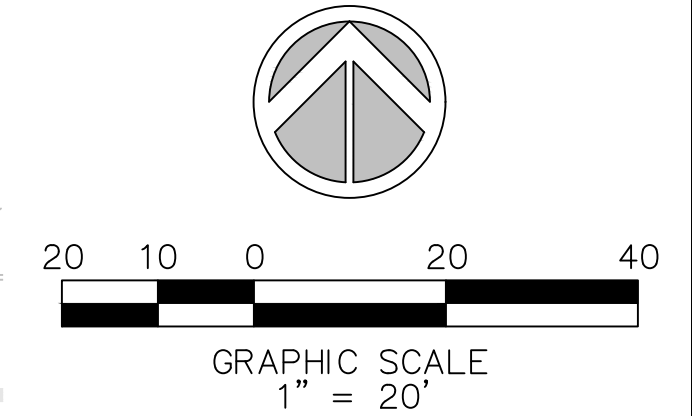

LAND USE BREAKDOWN	
	AREA (ACRES)
PERVIOUS	0.41
IMPERVIOUS	1.34
TOTAL	1.75

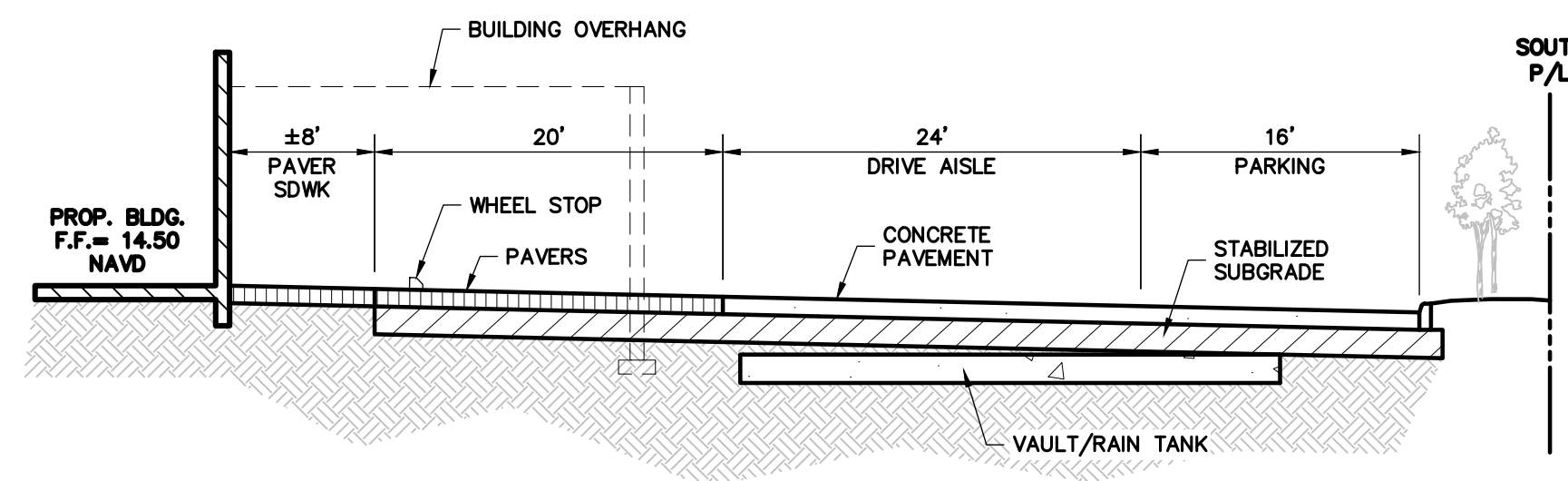
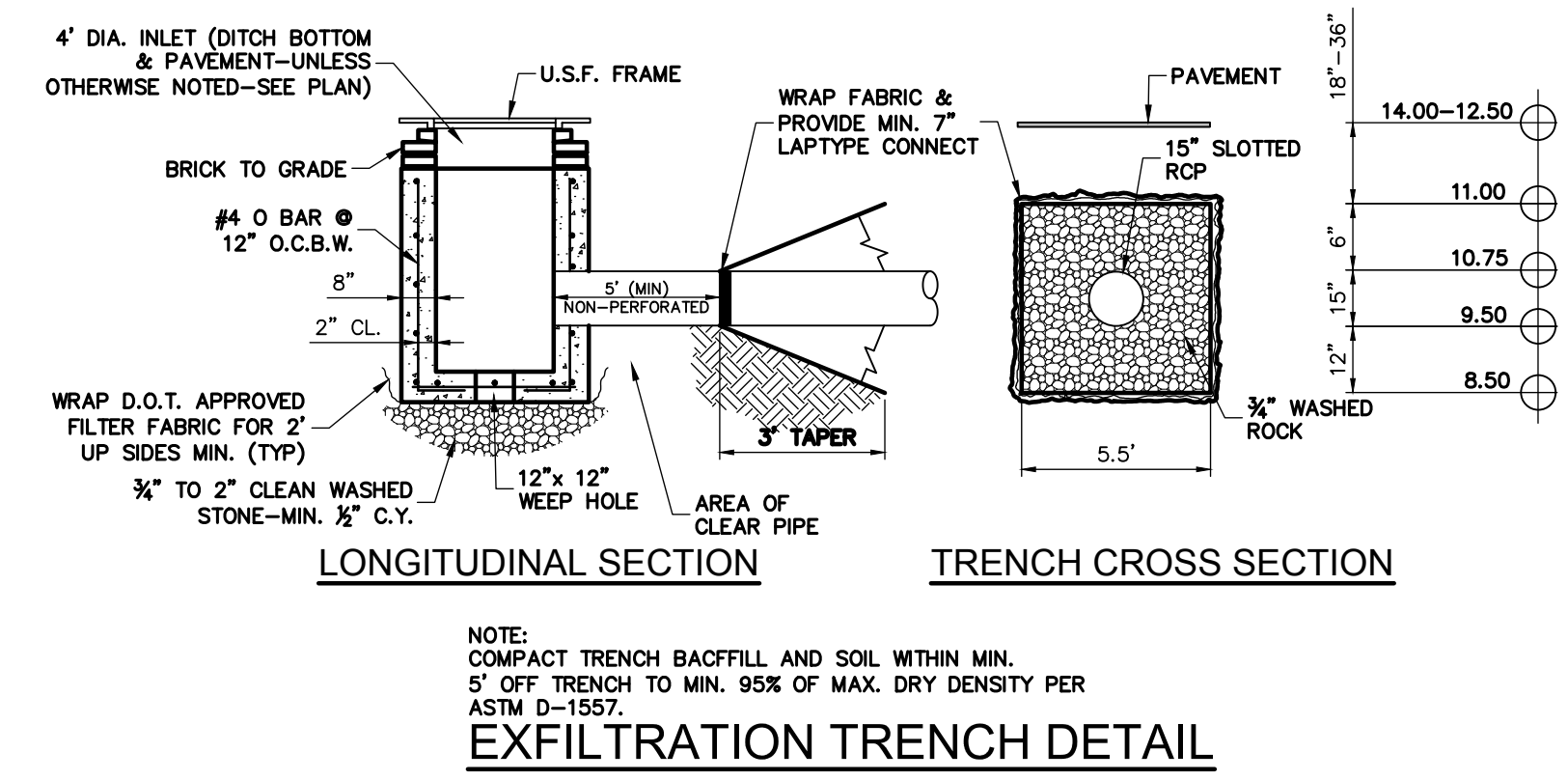
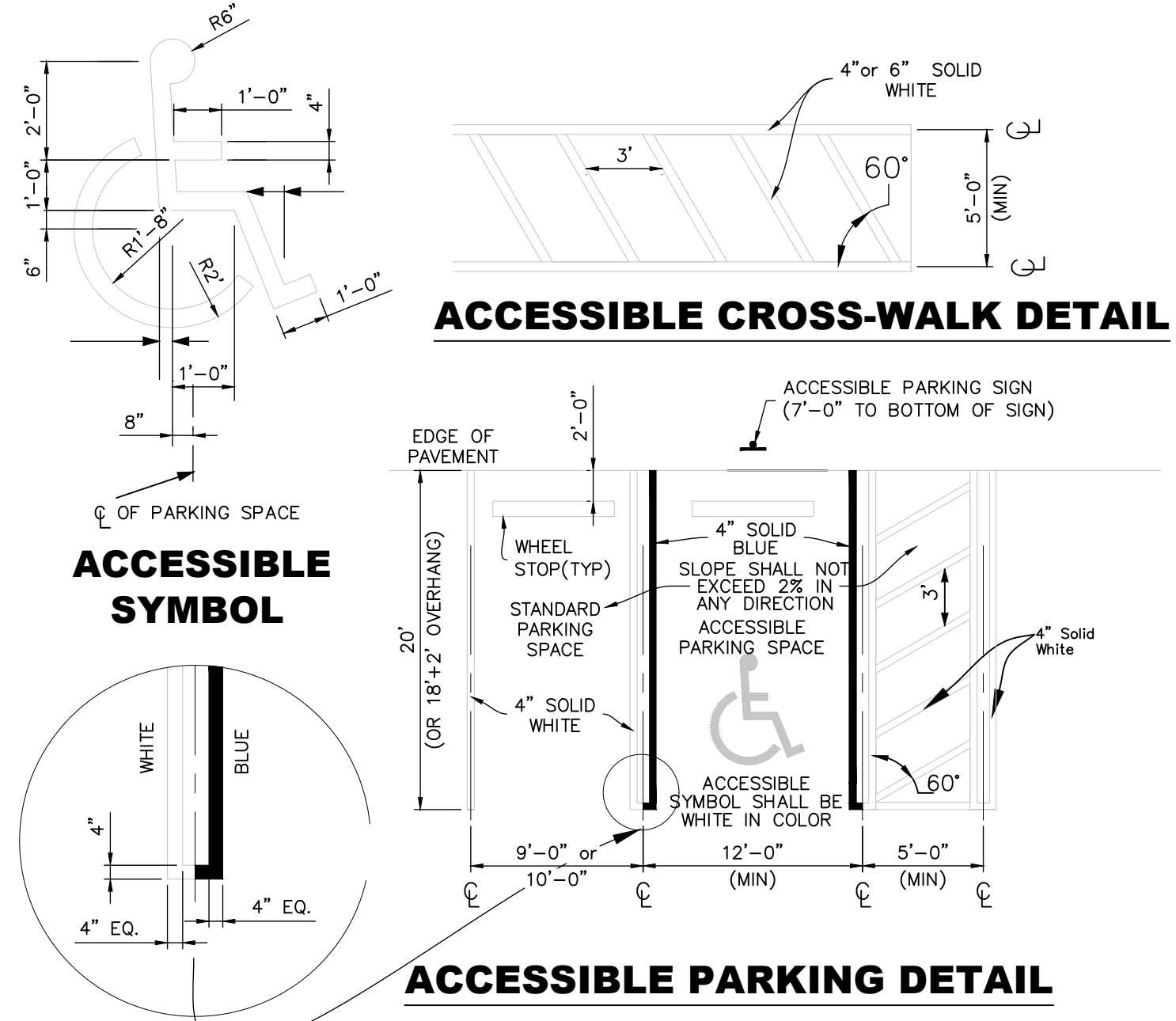

SECTION A-A

- NOTE:**
- ALL PROPOSED ELEVATIONS ARE IN N.A.V.D.(88)
  - BUILDING TO BE FLOOD PROOFED TO ELEVATION=17.00' NAVD (BFE+1')
  - FEMA=AE=16.00' NAVD

NOTE:  
COMPACT TRENCH BACKFILL AND SOIL WITHIN MIN. 5' OFF TRENCH TO MIN. 95% OF MAX. DRY DENSITY PER ASTM D-1557.

EXFILTRATION TRENCH DETAIL