

REVISIONS	BY	DATE
△ PROGRESS PLANS	GAH	04-22-16

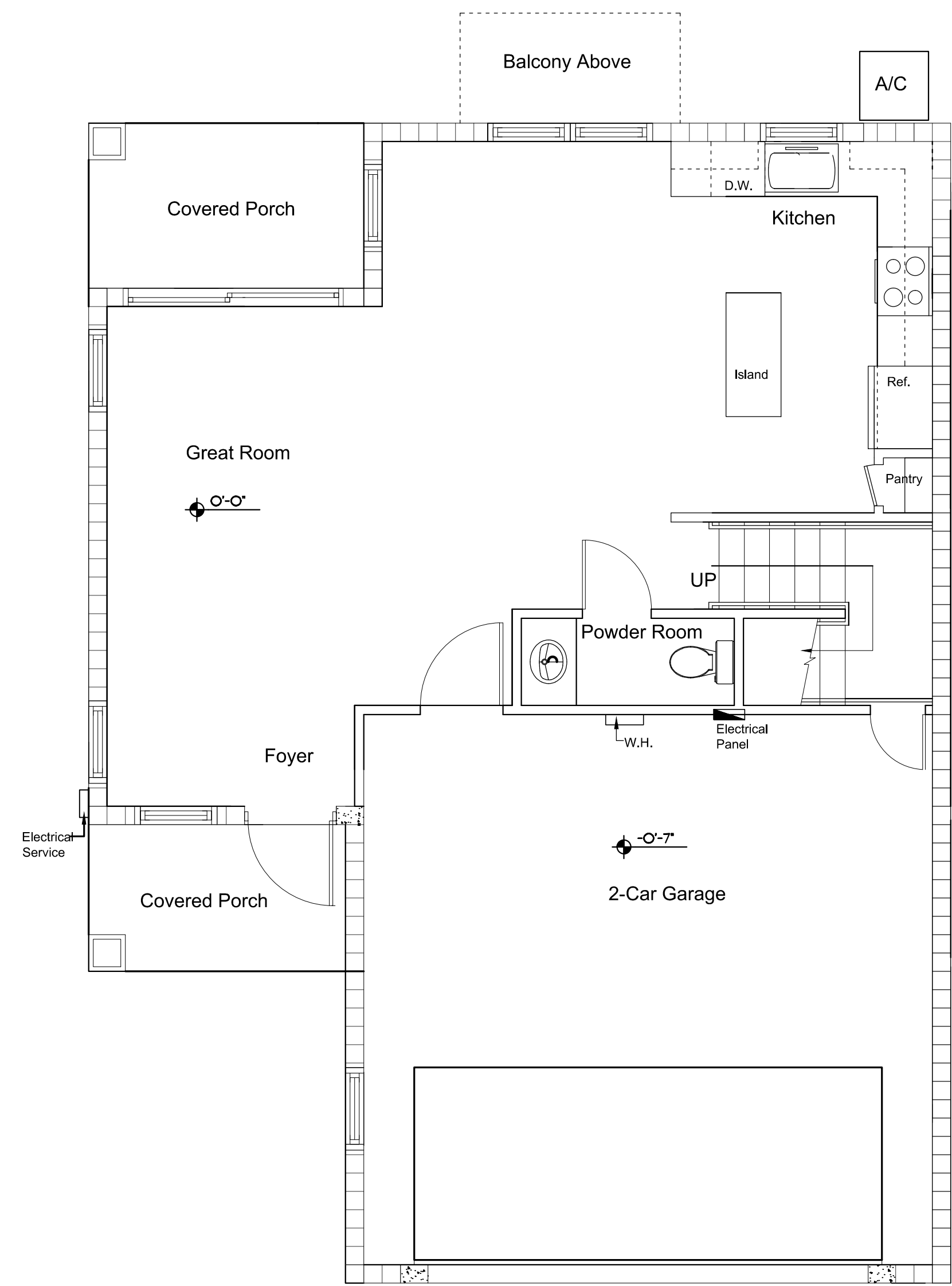

MODEL A- FIRST FLOOR

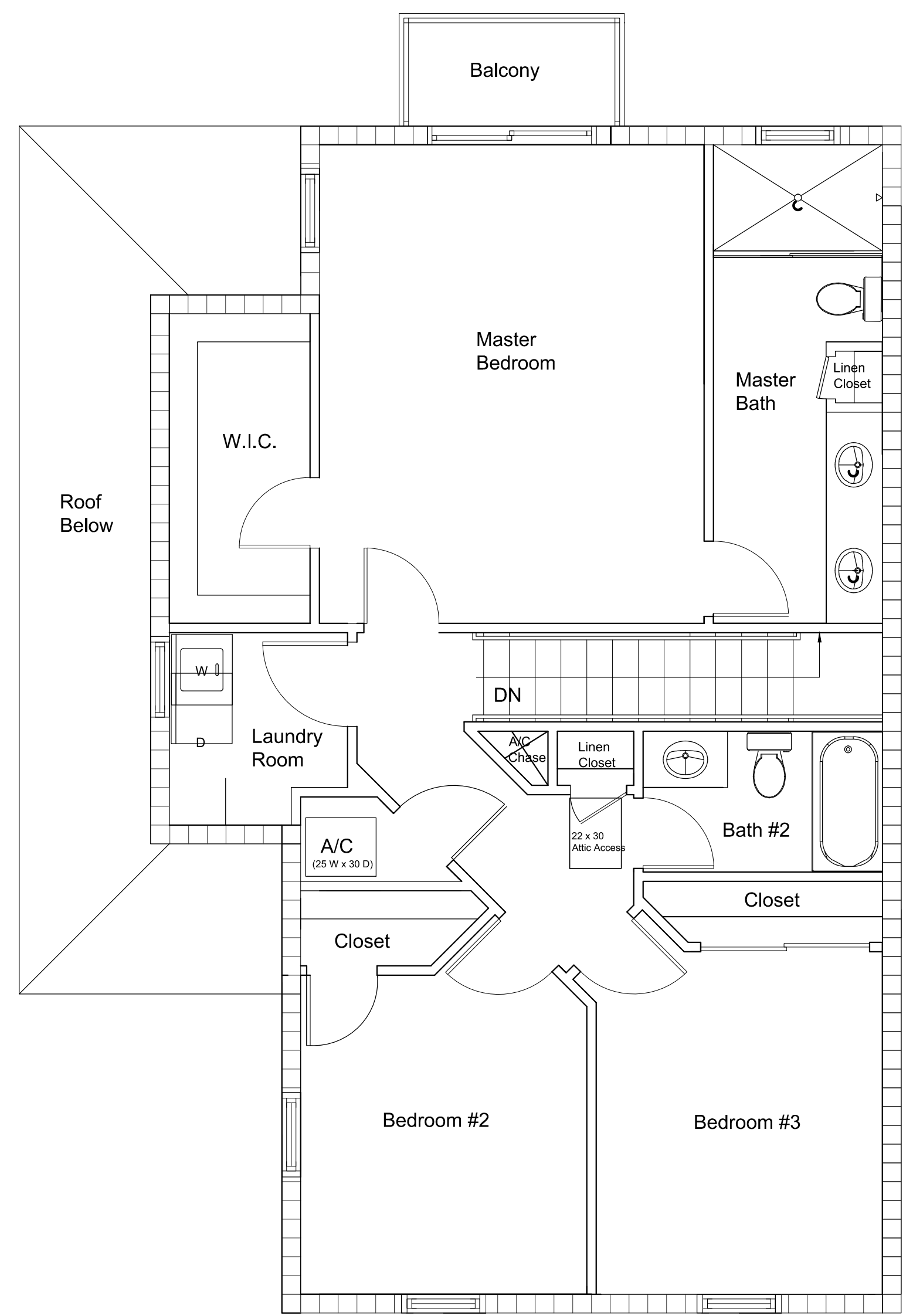

MODEL A- SECOND FLOOR

**MODEL A FLOOR PLAN
IN THE PINES
COCONUT CREEK, FL**

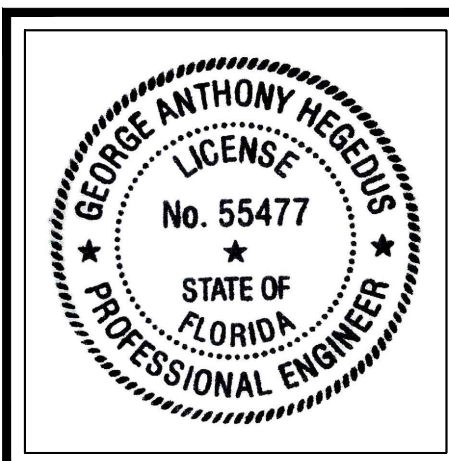

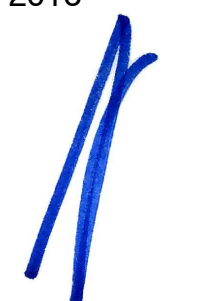
JOB#: 2016

 AUGUST 18, 2016
 George A. Hegedus P. E., S.I.



structural systems, inc.
 440 East Samuels Road, Ste. 207, Pompano Beach, FL 33064
 T: 954-781-4399 F: 954-781-2806 PE 55477 CA 6417
 SI 7002833, www.structuralsi.com

A-21

E:\Memor\In the Pines\08-16-16 zoning submittal\updated floor plans sheets (1) (2).dwg, 8/19/2016 12:54:53 PM, DWG To PDF.pc3