

REQUIREMENTS APPLY TO FIRE HYDRANTS, SIAMSE CONNECTIONS AND ANY OTHER FIRE EQUIPMENT FOR UTILIZING FIRE HOSE, ON PUBLIC OR PRIVATE PROPERTY.
BY THE AUTHORITY OF THE SOUTH FLORIDA FIRE PREVENTION CODE SECTION 9211.2
THIS DIAGRAM SHALL APPEAR ON ALL LANDSCAPE PLANS PRIOR TO APPROVAL.
THE CLEAR ZONE SHALL BE FREE OF LANDSCAPE (EXCEPT SOD), MAILBOXES, PARKING, LAMP-POSTS AND ALL OTHER OBJECTS.
EXCEPTIONS: OTHER FIRE FIGHTING EQUIPMENT OR TRAFFIC POSTS TO PREVENT FIRE FIGHTING EQUIPMENT.

FIRE HYDRANT CLEAR ZONE

N.T.S.

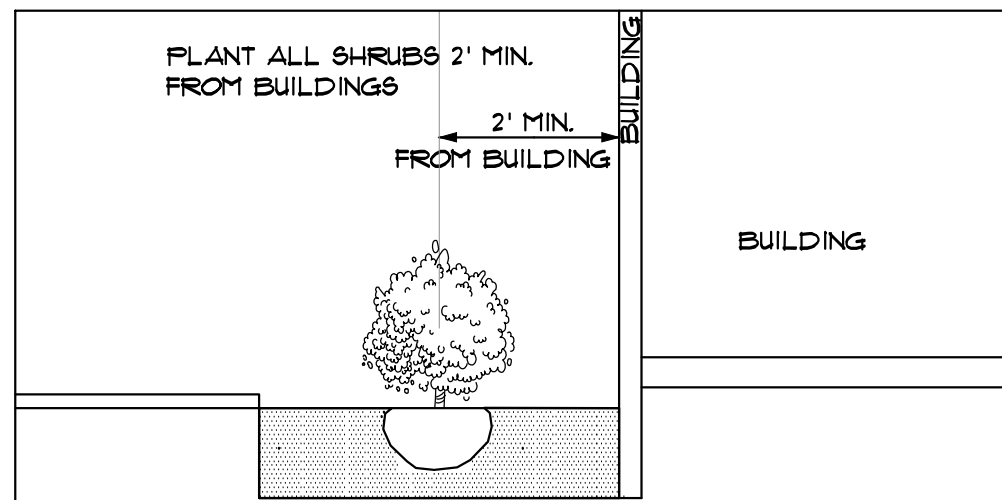

SHRUB PLANTINGS BUILDING DETAIL

N.T.S.

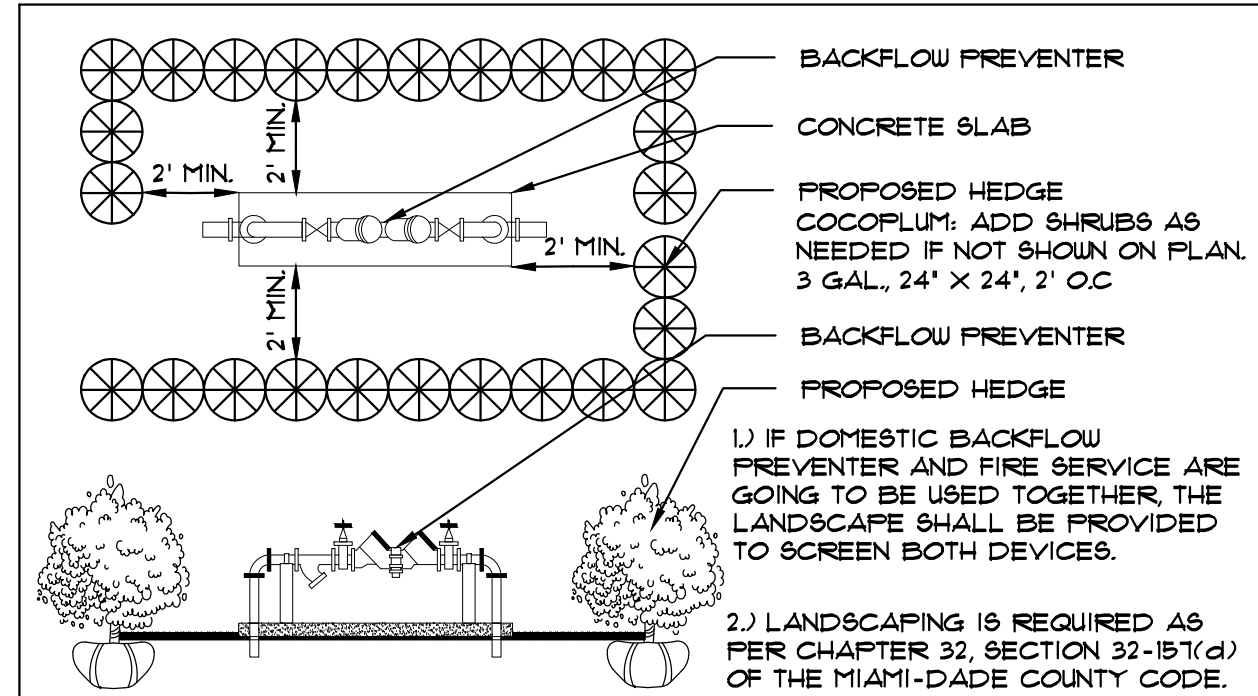

TYPICAL PLANTING SCREEN FOR ABOVE-GROUND UTILITIES

N.T.S.

PLANTING SOIL:

NOTE: ALL LANDSCAPED AREAS INCLUDING LANDSCAPE ISLANDS, SHALL BE EXCAVATED TO A DEPTH OF 2.0 FEET FOR REMOVAL OF ALL COMPACTED MATERIAL, LIMEROCK, ETC. AND BACKFILLED WITH A CLEAN, APPROVED BACKFILL. 50:50 TOPSOIL SHALL BE APPLIED TO A DEPTH OF 6" FOR ALL PLANTING BEDS AND A 2" DEPTH FOR ALL SOD AREAS. THE CONTRACTOR SHALL CALCULATE AND PROVIDE A UNIT AND AN EXTENDED PRICE FOR THIS ITEM.

FERTILIZATION:

ONE COMPLETE APPLICATION OF GRANULAR FERTILIZER SHALL BE APPLIED PRIOR TO FINAL ACCEPTANCE AND APPROVAL BY THE LANDSCAPE ARCHITECT. AN ADDITIONAL FERTILIZATION PROGRAM SHALL BE SUBMITTED TO THE PROJECT MANAGER FOR AN ANNUAL FERTILIZATION APPLICATION PROGRAM. FERTILIZERS SHALL BE PER ATLANTIC-APEC FERTILIZER CHEMICAL (APEC) OR AN APPROVED EQUAL. CONTRACTOR SHALL SUBMIT FERTILIZATION AS A SEPARATE ITEM IN THE BID.

FERTILIZATION SHALL BE AS FOLLOWS: TREES: 12-06-08 (APEC # 9231) RATE: 15 LBS./ INCH OF DIA. @ DBH PALMS: 12-04-12 (APEC # 1216) RATE: 15 LBS./ INCH OF DIA. @ DBH SHRUBS AND GROUNDCOVERS: (12-06-08 APEC # 9231) RATE: 15 OZ./ FT. OF HEIGHT

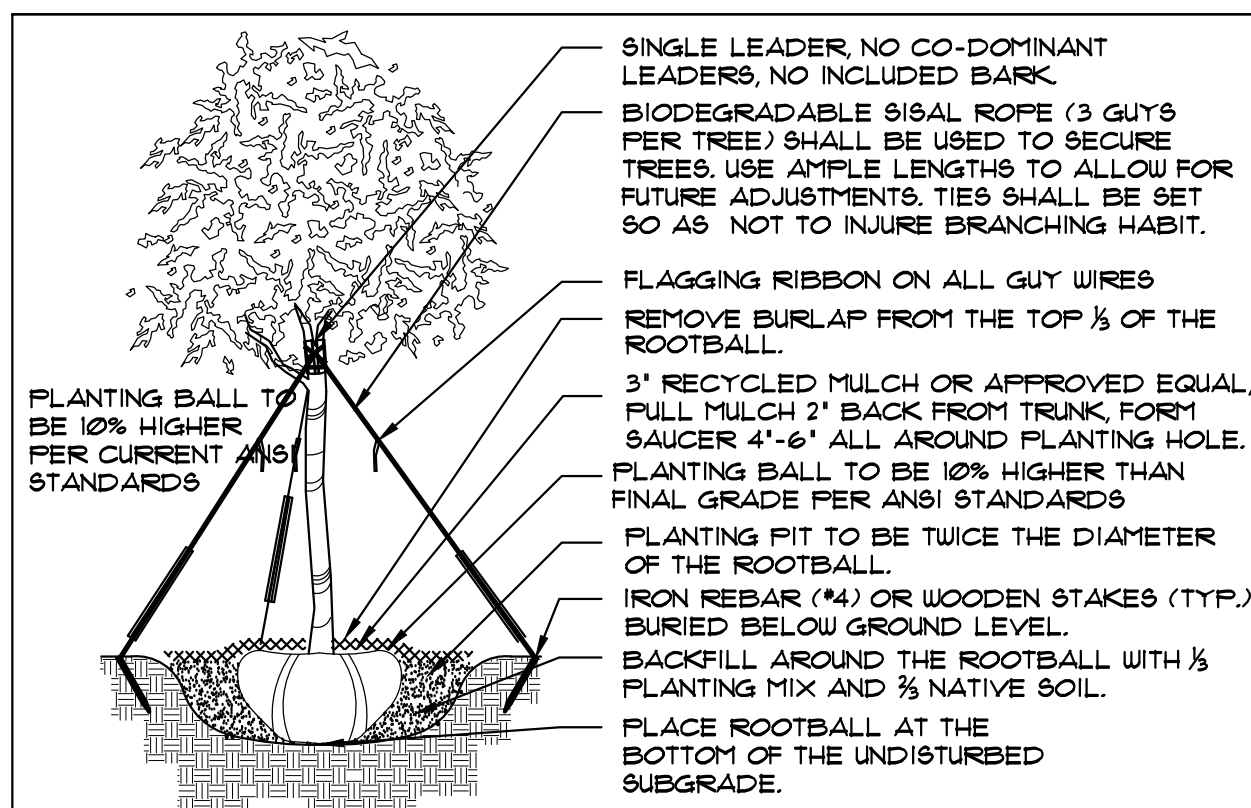

TREE PLANTING DETAIL

N.T.S.

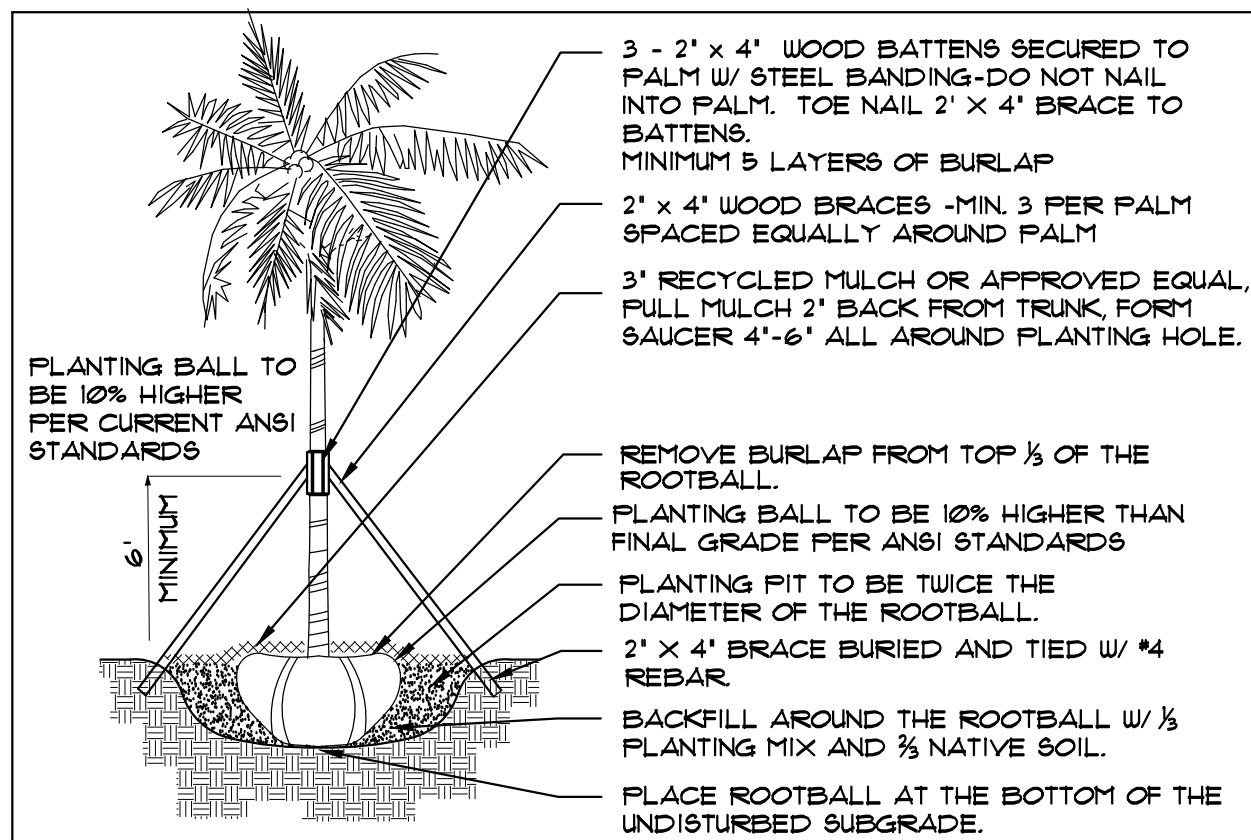

PALM PLANTING DETAIL

N.T.S.

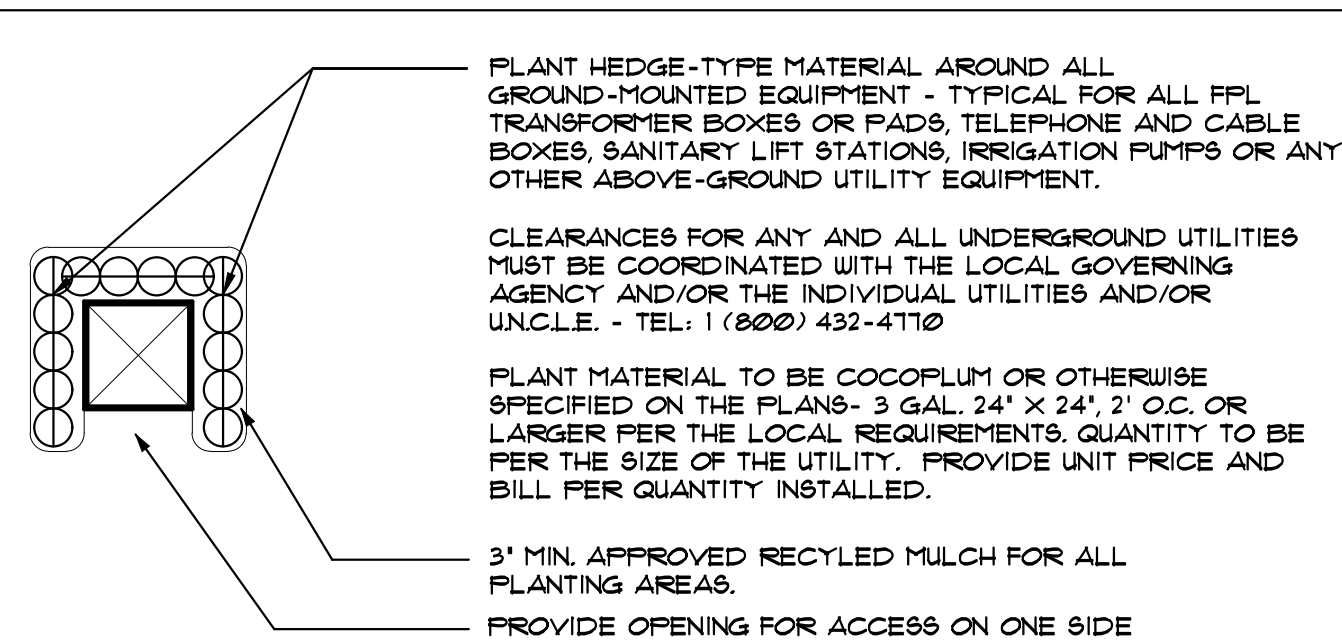

TYPICAL PLANTINGS FOR GROUND-MOUNTED EQUIPMENT

N.T.S.

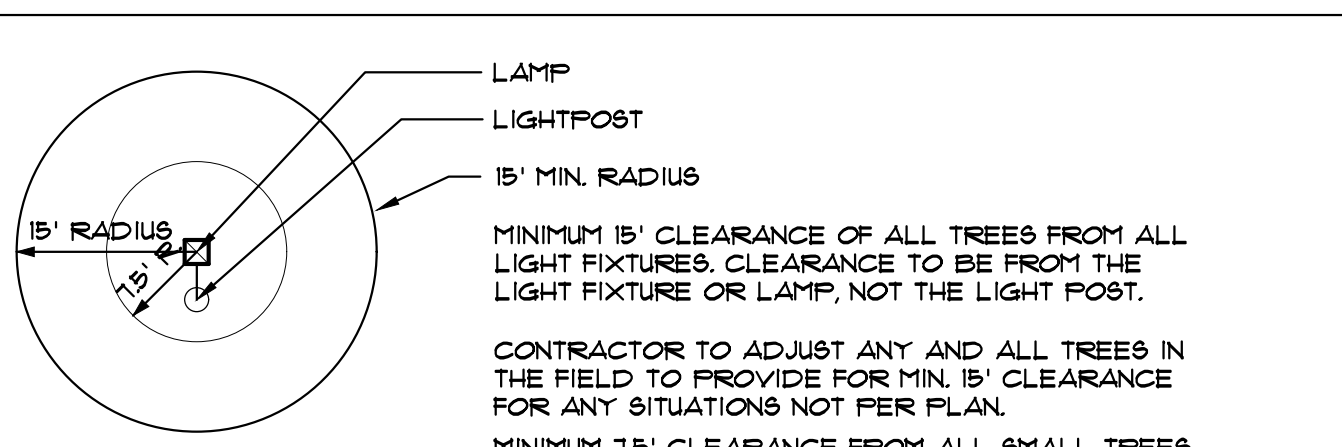

MINIMUM TREE CLEARANCE FROM LIGHT FIXTURES

N.T.S.

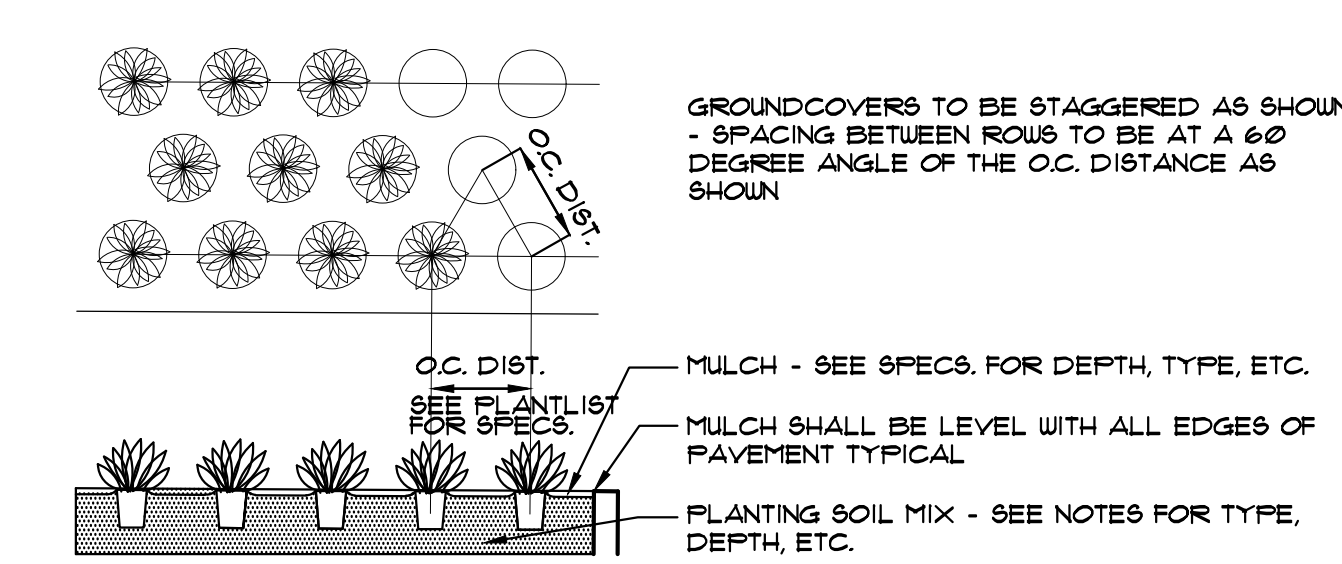

GROUNDCOVER DETAIL

N.T.S.

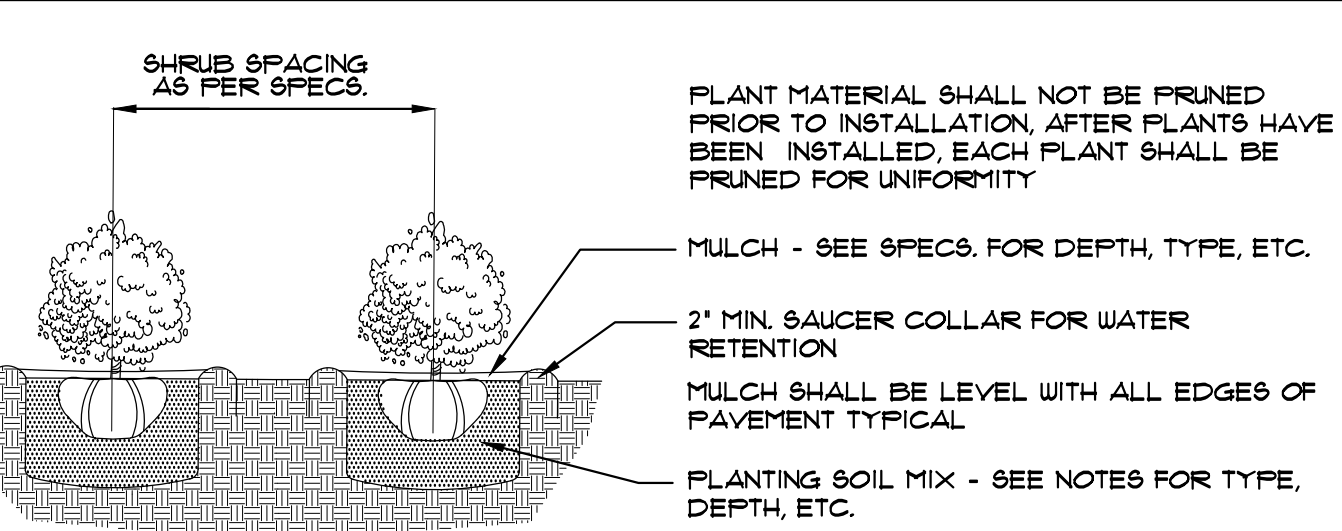

SHRUB PLANTING DETAIL

N.T.S.

LANDSCAPE NOTES

- ALL PLANT MATERIAL SHALL BE FLORIDA NO. 1 GRADE OR BETTER.
- CONTRACTOR SHALL FAMILIARIZE HIMSELF WITH THE LOCATION OF AND AVOID AND PROTECT UTILITY LINES, BURIED CABLES, AND OTHER UTILITIES.
- TREE, PALM, ACCENT AND BED LINES ARE TO BE LOCATED IN THE FIELD AND APPROVED BY THE LANDSCAPE ARCHITECT PRIOR TO INSTALLATION.
- ALL PLANTING SOIL SHALL BE 50:50 TOPSOIL:SAND MIX, FREE OF CLAY, STONES, ROCKS, OR OTHER FOREIGN MATTER. THIS SPECIFICATION INCLUDES ALL BACKFILL FOR BERTHS AND OTHER LANDSCAPE AREAS.
 - SODDED-LAWN AREAS
 - 2" DEPTH PLANTING SOIL SPREAD IN PLACE- THROUGHOUT.
 - GROUND COVER PLANTING BEDS:
 - 6" DEPTH PLANTING SOIL SPREAD IN PLACE- THROUGHOUT.
 - SHRUB AND HEDGE PLANTING AREAS:
 - 12" DEPTH PLANTING SOIL SPREAD IN PLACE- THROUGHOUT.
 - TREES, PALMS, SPECIMEN PLANT MATERIAL:
 - 24" DEPTH PLANTING SOIL SPREAD IN PLACE OR, TO THE DEPTH OF THE ROOTBALL, OR CONTAINER WHICHEVER IS GREATEST.
 - LANDSCAPE ISLANDS AND BUILDING FOUNDATIONS:
 - EXCAVATE AND REMOVE ALL LIMEROCK, ROCKS, DEBRIS, ETC. TO A DEPTH OF 12" AND BACKFILL W/ 50:50 TOPSOIL:SAND MIX.
 - BUILDING FOUNDATIONS SHALL BE THE SAME DEPTH TO A WIDTH OF 36" FROM THE BUILDING BASE.
- THE SITE CONTRACTOR SHALL BE RESPONSIBLE TO BRING ALL GRADES TO WITHIN 2" OF FINAL GRADES. THIS SHALL INCLUDE A 2" APPLICATION OF 50:50 TOPSOIL:SAND MIX FOR ALL LANDSCAPE AREAS TO BE SODDED.
- THE LANDSCAPE CONTRACTOR SHALL CALCULATE AND SUBMIT AN ITEMIZED PRICE FOR THE 2" APPLICATION OF 50:50 MIX FOR ALL SOD AREAS AS A REFERENCE IN THE CASE THAT THERE WOULD BE A DISCREPANCY BETWEEN SITE AND LANDSCAPE CONTRACTORS AND NOTIFY THE SITE CONTRACTOR OR PROJECT SUPERINTENDENT AS TO THIS DISCREPANCY. IT WILL THEN BE DETERMINED WHICH PARTY WILL PROVIDE THIS 2" TOPSOIL:SAND APPLICATION AND SUBSEQUENT PAYMENT. OTHER PLANTING SOIL MIXES TO BE ADDED, IE. FOR TREES, PALMS, SPECIMEN PLANTS, SHRUBS AND GROUNDCOVERS SHALL BE THE RESPONSIBILITY OF THE LANDSCAPE CONTRACTOR AND BE INCLUSIVE WITH THE LANDSCAPE BID.
- CONTRACTOR SHALL COORDINATE WITH THE IRRIGATION CONTRACTOR AND LEAVE PROVISIONS FOR ALL INCLUDING UNDERGROUND UTILITY LINE LOCATIONS DIAL 811 "NO CUTS" AS REQUIRED BY LAW.
- ALL PLANTING BEDS SHALL BE MULCHED TO A DEPTH OF 3" WITH AN APPROVED RECYCLED MULCH BY THE PRESIDING GOVERNING AGENCY. NO HEAVY METALS, I.E. ARSENIC, LEAD, ETC. ARE TO BE CONTAINED IN THE MULCH AND THE CONTRACTOR SHALL PROVIDE CERTIFICATION OR PROOF THAT ALL MULCH IS FREE OF HEAVY METALS OR SIMILAR ENVIRONMENTAL CONTAMINANTS.
- SOD SHALL BE ARGENTINE 'BAHIA' OR ST. AUGUSTINE 'FLORATAM' AS SHOWN ON THE PLANS, STRONGLY ROOTED, FREE FROM WEED, FUNGUS, INSECTS AND DISEASE. CONTRACTOR SHALL SOD ALL AREAS AS INDICATED ON THE PLAN OR AS DIRECTED. PAYMENT SHALL BE DETERMINED BY THE TOTAL MEASURED SODDED AREAS X THE UNIT PRICE SUBMITTED AND FIELD VERIFIED.
- SOD SHALL BE INSTALLED IN ACCORDANCE WITH THE SPECIFICATIONS AS DEFINED BY FDOT. SOD SHALL CARRY A 5-MONTH WARRANTY.
- ALL TREES, PALMS SHRUBS AND GROUNDCOVERS SHALL CARRY A ONE-YEAR WARRANTY FROM THE DATE OF FINAL ACCEPTANCE.
- ALL TREES AND PALMS SHALL BE STAKED PER ACCEPTED STANDARDS BY THE FLORIDA NURSERYMEN & GROWERS LANDSCAPE ASSOCIATION (FNLGA). THERE SHALL BE ONE FINAL INSPECTION FOR APPROVAL BY THE PRESIDING GOVERNING AGENCY. CONTRACTOR SHALL INSURE THAT THE PLANS, DETAILS, SPECIFICATIONS AND NOTES HAVE BEEN ADHERED TO AND THAT THE LANDSCAPE AND IRRIGATION INSTALLATION IS COMPLIANT TO ALL ITEMS AS DIRECTED ON THE PLANS PRIOR TO SCHEDULING OF THE FINAL INSPECTION.
- THE PLANT LIST IS INTENDED ONLY AS AN AID TO BIDDING. ANY DISCREPANCIES FOUND BETWEEN THE QUANTITIES ON THE PLAN AND PLANT LIST, THE QUANTITIES ON THE PLAN SHALL BE HELD VALID.
- IRRIGATION SHALL PROVIDE FOR A 100% COVERAGE WITH A 100% OVERLAP, AUTOMATIC SYSTEM W/ RAIN MOISTURE SENSOR ATTACHED TO CONTROLLER. ALL FLORIDA BUILDING CODE APPENDIX 'F' IRRIGATION REQUIREMENTS SHALL BE STRICTLY ADHERED TO FOR INSTALLATION AND PREVAILING WATER MANAGEMENT DISTRICT RESTRICTIONS AND REGULATIONS SHALL BE IN COMPLIANCE FOR POST-INSTALLATION WATERING SCHEDULES.
- EXISTING IRRIGATION SYSTEM (IF APPLICABLE) SHALL BE RETROFITTED TO COMPLY WITH THOSE SPECIFICATIONS AS OUTLINED ABOVE.
- CONTRACTOR SHALL PROVIDE A WATER TRUCK DURING PLANTING TO INSURE PROPER WATERING-IN DURING INSTALLATION AND WILL BE RESPONSIBLE FOR CONTINUAL WATERING UNTIL FINAL ACCEPTANCE BY THE OWNER.
- ALL EXISTING TREES, PALMS AND PLANT MATERIAL TO REMAIN SHALL BE PROTECTED DURING CONSTRUCTION. CONTRACTOR SHALL INSTALL PROTECTIVE BARRIERS SUCH AS 'TENAX' PROTECTIVE FENCING OR AS SHOWN ON THE DETAILS TO BE INSTALLED AT THE BEGINNING OF THE PROJECT. BARRIERS SHALL BE LOCATED TO INCLUDE THE DRIFLINE OF THE TREES, PALMS AND PLANT MATERIAL WHERE POSSIBLE. THE CONTRACTOR SHALL TAKE EXTRA CAUTION TO PREVENT ANY DAMAGE TO THE TRUNK, BRANCHES, ROOTS, ROOT ZONE AREAS AND ADJACENT GRADES.
- EXISTING TREES AND PALMS TO REMAIN SHALL BE TRIMMED PER ANSI-300 STANDARDS. SUPERVISION OF THE TRIMMING SHALL BE PERFORMED BY AN ISA-CERTIFIED ARBORIST.
- ALL EXISTING TREES AND PALMS SHALL BE 'LIFTED AND THINNED' TO PROVIDE FOR AN 8' MINIMUM CLEARANCE FOR SIDEWALKS AND PEDESTRIAN WALKWAYS AND A 14' MINIMUM CLEARANCE FOR ROADWAYS, DRIVEWAYS, AND ALL VEHICULAR USE AREAS.
- REMOVAL OF ANY TREES OR PALMS WILL REQUIRE A WRITTEN 'TREE REMOVAL PERMIT' FROM THE LOCAL GOVERNING AGENCY PRIOR TO REMOVAL.
- ALL PLANTINGS IN NON-IRRIGATED AREAS (IE. RIGHTS OF WAYS, SWALES, ETC. SHALL BE WATERED-IN THOROUGHLY AND CONTINUED TO BE WATERED THROUGHOUT UNTIL C.O. ACCEPTANCE. COORDINATE WITH OWNER AND PROJECT MANAGER TO PROVIDE POST C.O. WATERING TO INSURE PLANT ESTABLISHMENT FOR A MINIMUM OF ONE YEAR AFTER CERTIFICATE OF OCCUPANCY ACCEPTANCE.

SEE CONTIGUOUS LANDSCAPE PLANS, SHEETS L-2 THROUGH L-7 FOR SECTOR LANDSCAPE PLANS (L-2 TO L-5), PROJECT AREA CALCULATIONS (L-6), LANDSCAPE DETAILS (L-7).

SEE IRRIGATION PLANS FOR IRRIGATION LAYOUT, DETAILS, SPECIFICATIONS, ETC.

NO.	DATE	DESCRIPTION
1	07/09/15	PRELIMINARY
2	08/11/16	FOR REVIEW
3	08/11/16	FOR REVIEW
4	08/11/16	FOR REVIEW
5	08/11/16	FOR REVIEW
6	08/11/16	FOR REVIEW
7	08/11/16	FOR REVIEW
8	08/11/16	FOR REVIEW
9	08/11/16	FOR REVIEW
10	08/11/16	FOR REVIEW
11	08/11/16	FOR REVIEW
12	08/11/16	FOR REVIEW
13	08/11/16	FOR REVIEW
14	08/11/16	FOR REVIEW
15	08/11/16	FOR REVIEW
16	08/11/16	FOR REVIEW
17	08/11/16	FOR REVIEW
18	08/11/16	FOR REVIEW
19	08/11/16	FOR REVIEW
20	08/11/16	FOR REVIEW
21	08/11/16	FOR REVIEW
22	08/11/16	FOR REVIEW
23	08/11/16	FOR REVIEW
24	08/11/16	FOR REVIEW
25	08/11/16	FOR REVIEW
26	08/11/16	FOR REVIEW
27	08/11/16	FOR REVIEW
28	08/11/16	FOR REVIEW
29	08/11/16	FOR REVIEW
30	08/11/16	FOR REVIEW

DATE: Apr. 2016

SCALE: 1"=50'

DESIGNED BY: M.G.

DRAWN BY: M.A.S.

JOB NUMBER 13-3581

SHEET No. L-7

SEAL

JAMES F. SOCBASH
R.L.A. # 0001932

NOTES, DETAILS, SPECIFICATIONS, ETC.