

# PROVIDENCE CHILDREN'S ACADEMY

6111 LYONS ROAD STE.  
105, 106 & 107  
COCONUT CREEK,  
FLORIDA

TOM & DONNA MORGAN



**NORTHEAST PERSPECTIVE**

**PARKING DATA:**  
ORIGINAL PARKING REQUIRED 1SP/200SF RETAIL = 9,777.38/200 = 49SP AND 2HC  
ORIGINAL PARKING PROVIDED 61SP AND 3HC  
ADJUSTED PARKING FOR PROVIDENCE CHILDREN'S ACADEMY PLAYGROUND. REDUCTION OF (7)SP WOULD YIELD (54)SPACE WHICH IS > 49 REQ.D AND (3)HC REMAIN.

THERE WILL BE NO ALTERATIONS OF UTILITY FACILITIES AND THAT ANY ADDITIONAL UTILITIES WILL NOT BE REQUIRED (WATER, SEWER, DRAINAGE)  
THE PLAYGROUND ELEVATIONS WILL NOT CHANGE THE PARKING DRAINAGE.

**PROJECT DATA:**

<b>BUILDING DATA:</b>	
BUILDING SQUARE FOOTAGE A/C:	9,777 SQ. FT.
NON-A/C:	1,108 SQ. FT.
UTILITY:	68 SQ. FT.
PROPOSED DAY CARE FACILITY:	10,951 SQ. FT. 4,000 SQ. FT.
CODE USED- EXISTING BUILDING:	FBC 2004
PROPOSED DAYCARE:	FBC 2007
LATEST ADOPTED VERSIONS:	LIFE SAFETY NFPA 101 NEC
EXISTING TYPE OF CONSTRUCTION:	TYPE IIIB UNSPRINKLERED
OCCUPANCY EXISTING BUILDING:	TYPE 'M' MERCANTILE
PROPOSED OCCUPANCY:	TYPE 'D' DAYCARE
FLOOR AREA NET:	3085 SQ. FT.
OCCUPANCY LOAD AT 1PERSON/35SQ.FT. =	88 PEOPLE

**SHEET INDEX**

ID	Name	Published
A-0	COVER SHEET	<input checked="" type="checkbox"/>
A-1	1st FLOOR	<input checked="" type="checkbox"/>
A-2	DIMENSION FLOOR PLAN	<input checked="" type="checkbox"/>
A-3	LIFE SAFETY-FIRE ALARM-S...	<input checked="" type="checkbox"/>
A-4	EXTERIOR ELEVATIONS	<input type="checkbox"/>
A-5	INTERIOR ELEVATIONS	<input type="checkbox"/>
A-6	WALL SECTIONS	<input type="checkbox"/>
A-7	SCHEDULES AND DETAILS	<input type="checkbox"/>
A-8	SPECIFICATIONS	<input type="checkbox"/>
A-9	PLAYGROUND	<input type="checkbox"/>
E-1	1st FLOOR ELECT.	<input type="checkbox"/>
E-2	1st FLOOR RCP	<input type="checkbox"/>
E-3	ELECTRICAL DATA	<input type="checkbox"/>
P-1	PLUMBING ISOMETRICS	<input type="checkbox"/>

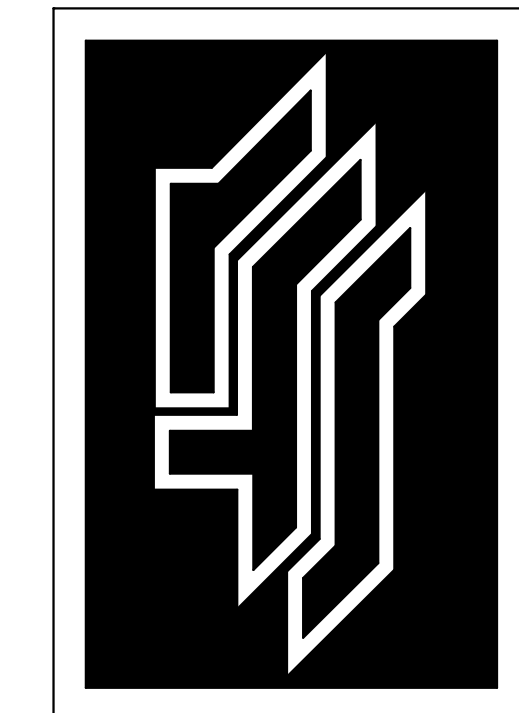
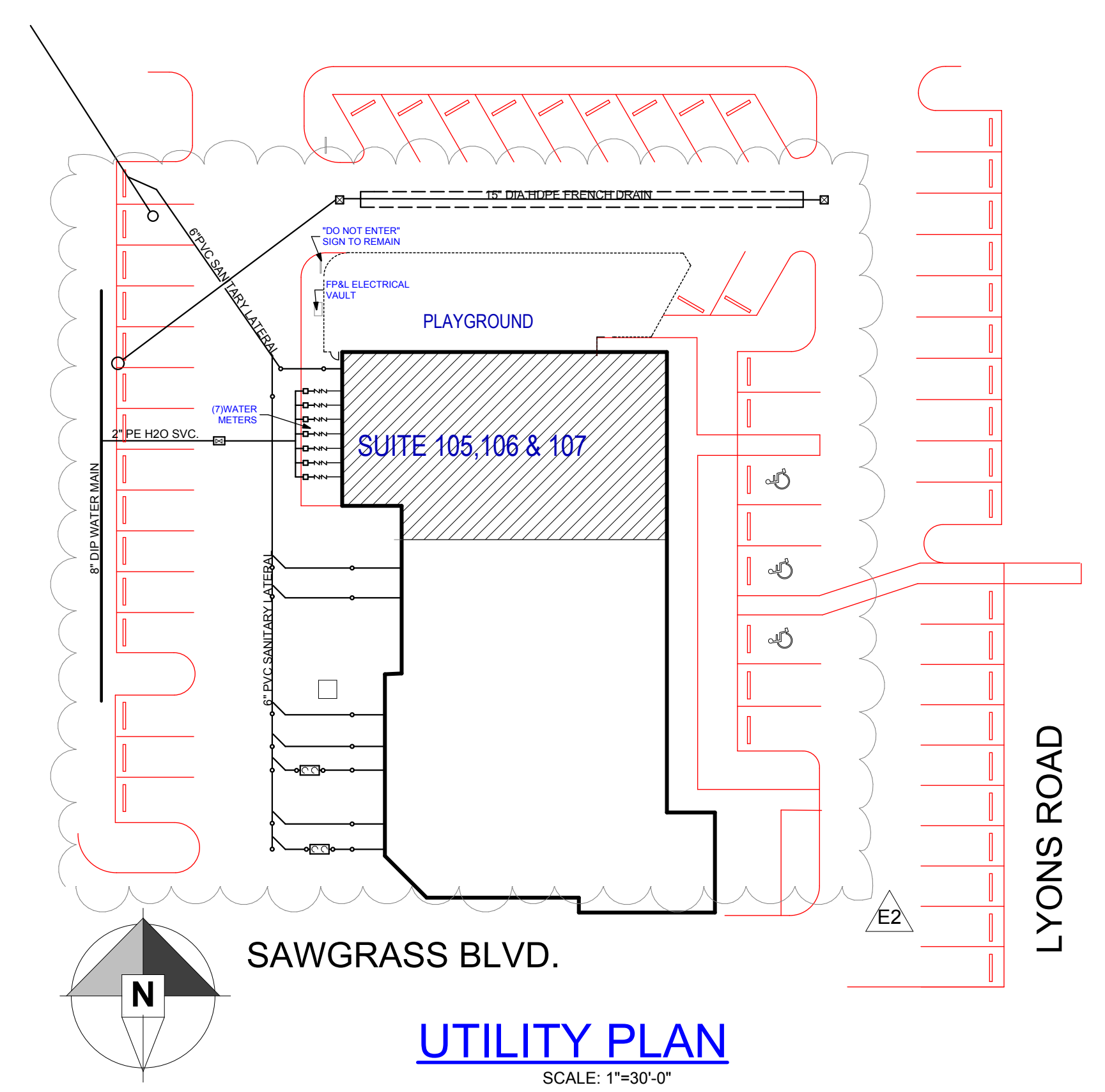
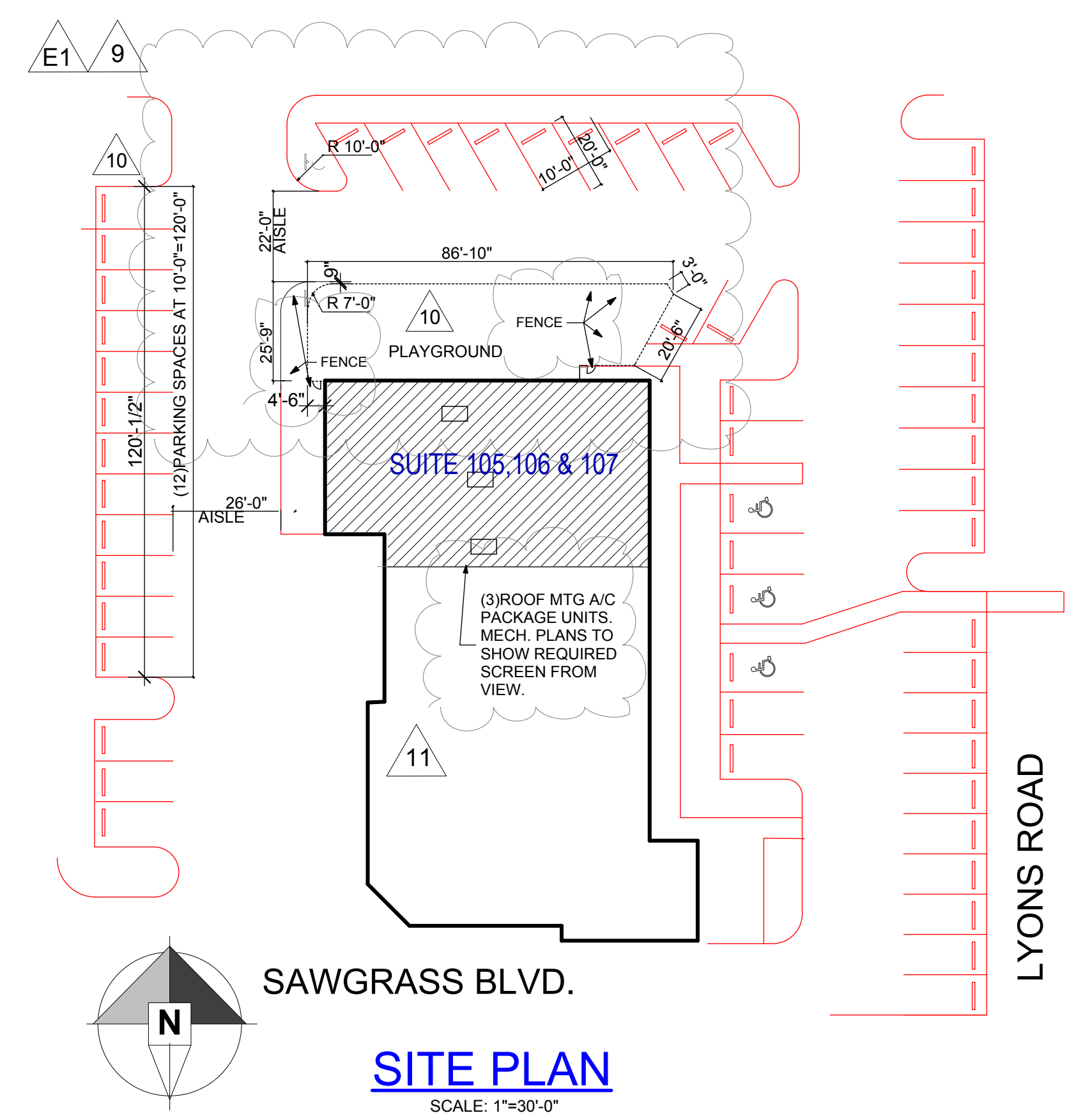

**ROBERT F. SONBERG**  
ARCHITECT/PLANNER

113 BENT TREE DRIVE. PALM BEACH GARDENS, FL. 33418  
PHONE: (561) 460-5635 FAX: (561) 775-0617

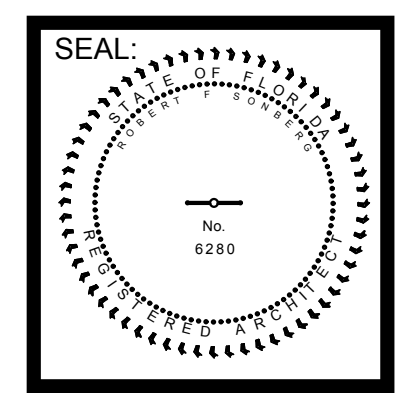

**A-0**  
SHEET 1 OF 14