

KEY	PLANT NAME	QTY.	UT.	SIZE
CHIC	Chrysobalanus icaco ...Cocoplum	290	ea.	3 gallon cans, 24" x 18"
COES	Conocarpus erectus sericeus ...Silver Buttonwood	2	ea.	8' tall x 4' spread, 2" cal. 3 1/2 c.t. standard
COSE	Cordia sebestena ...Orange Ginger	4	ea.	10'-12" tall x 5' spread, 2 1/2" cal.
HAPA	Hamelia patens ...Firebush	44	ea.	3 gallon cans
ILCA	Ilex cassine ...Dahoon Holly	8	ea.	10' tall x 4' spread, 4 1/2" c.t., 2" cal.
IXNG	Ixora Nora Grant	66	ea.	3 gallon cans, 24" x 18"
PITV	Pittosporum tobira variegata ...Variegated Pittosporum	73	ea.	3 gallon cans, 12" x 14"
PSLI	Psychotria ligustrifolia ...Bahama Coffee	164	ea.	3 gallon cans, 18" x 18"
QUVI	Quercus virginiana ...Live Oak	3	ea.	14'-15' tall x 5'-6' spread, 2 1/2" cal., 4 1/2" c.t.
RAIN	Raphiolepis indica ...Indian Hawthorne	270	ea.	3 gallon cans, 16" spread
SYRA	Syagrus romanzoffianum ...Queen Palm	1	ea.	20' tall overall
TAHE	Tabebuia heterophylla ...Pink Tabebuia	7	ea.	12' tall x 6' spread, 4 1/2" c.t., 2 1/2" cal., FG
VEMO	Veitchia mongomeriana ...Montgomery Palm	6	ea.	22'-25' tall overall
sod	St. Augustine "Floritam" Planting Soil Everglades Muck Shredded Melaleuca Mulch (Grade B)	as req.	s.f. c.y. c.y.	Solid Sod

**LANDSCAPE REQUIREMENT LEGEND**

ITEM	REQUIRED	PROVIDED
Minimum Landscape Requirement B-3 Zone [Sec. 13-443 (4)] Plot area no used for structures and parking = 49,642 s.f. / 1000 s.f. = 49.6	50 trees	50 (including trees on existing buffer)
Special Provisions [Sec. 13-443 (7e)] 420 lin. ft. landscape space between building and parking / 40 lin. ft. per tree = 10.5 trees for shrubs 30 x 10.5 for groundcover 30 x 10.5	248	248
Landscape Adjacent to Streets [Sec. 13-443 (8a)]	11 trees	12
Interior Landscape Requirements [Sec. 13-443 (12d)] 60 parking spaces = 1 tree per 10 spaces = 6 trees [Sec. 13-443 (12d)] 316 lin. ft. divider median / 40 lin.ft. = 7.9 trees	210 315	246 415
Street Trees [Sec. 13-443 (13)]	provided on existing buffer	
<b>Total Required Trees</b>	<b>75</b>	<b>75+</b>

New Tree	Percentage of Trees per Tree Category (not including buffer)		
	Shade / Canopy (17) 12 new + 5 existing	40%	48%
	Intermediate Trees (11)	30%	30%
	Small Tree (11)	10%	30%
	<b>Total Trees = 35</b>		

% OF NATIVE MATERIAL (NEW PLANTS)		
TREES & PALMS	40%	57%
SHRUBS		56%

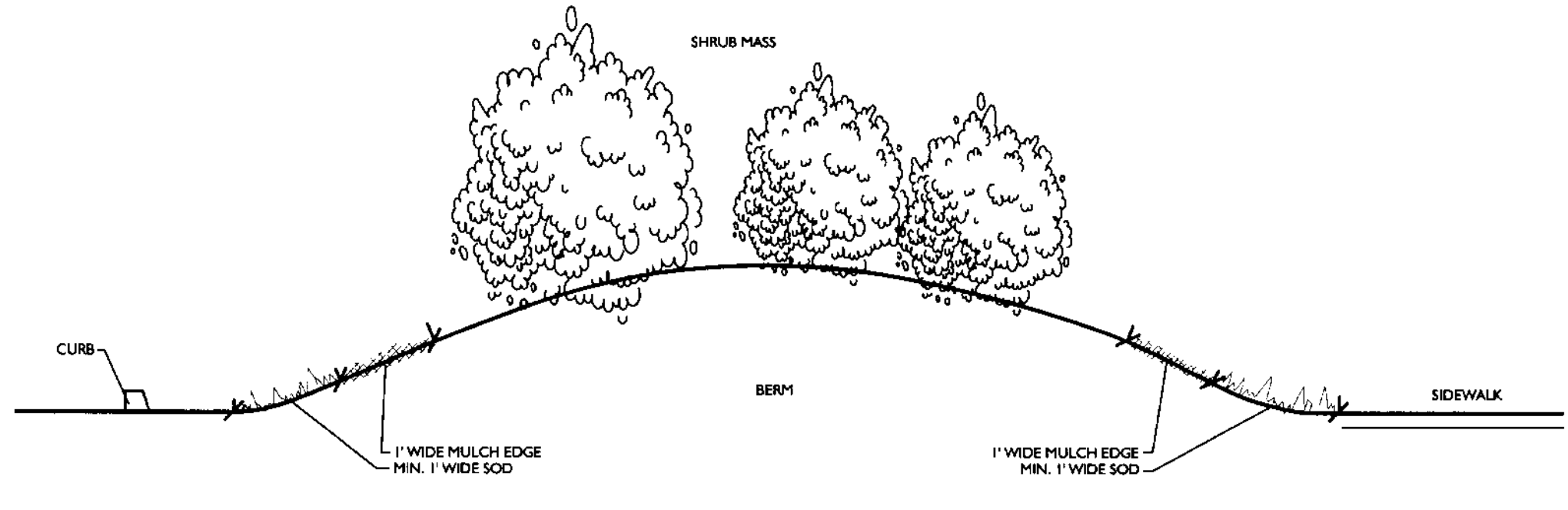
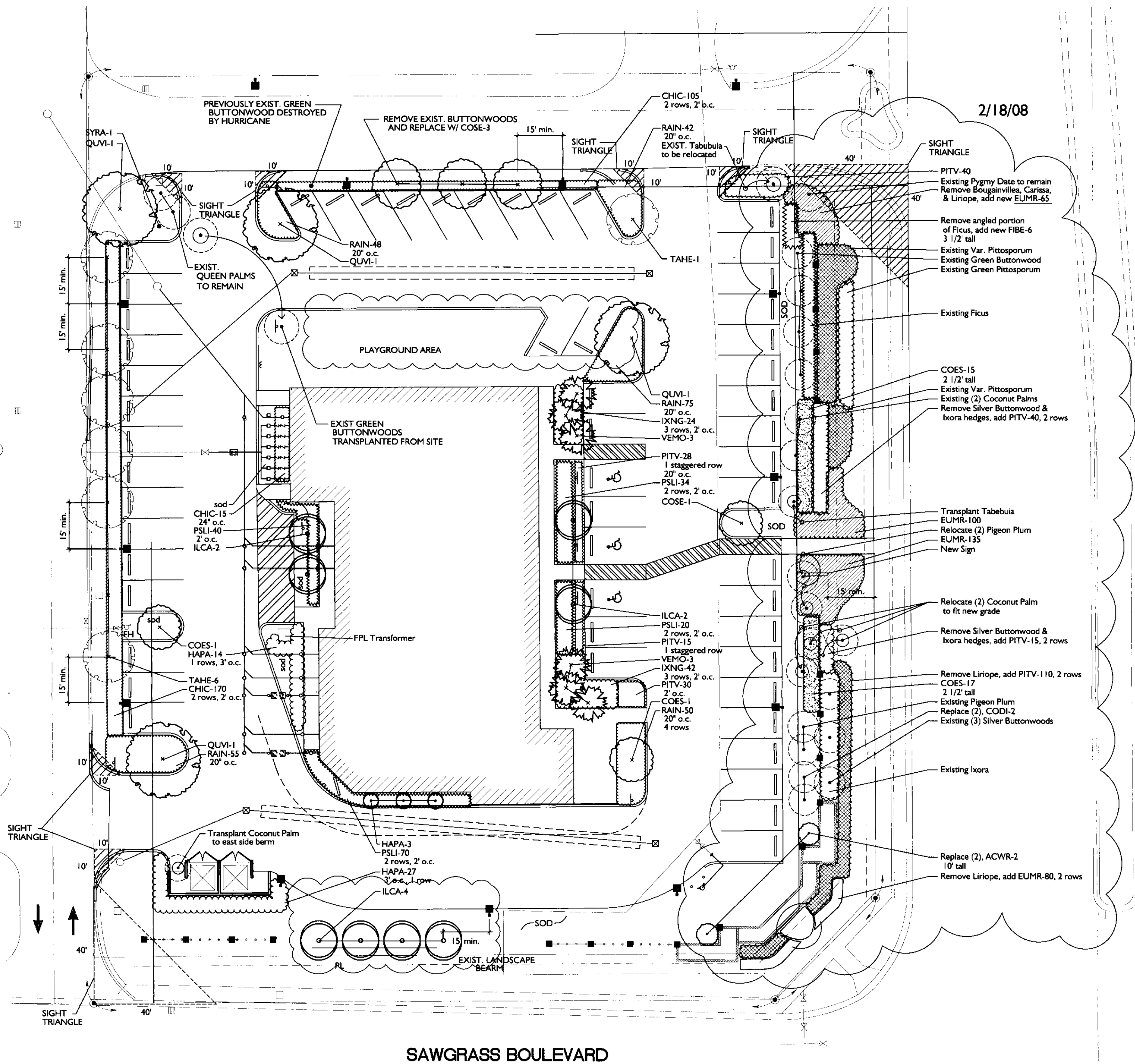

**TYPICAL BUFFER EDGE SECTION**  
NTS

2/18/08

KEY	PLANT NAME	QTY.	UT.	SIZE
ACWR	Accelorrhaphis wrightii ...Pauros Palm	2	ea.	10' tall
COES	Conocarpus erectus 'Sericeus' ...Silver Buttonwood	32	ea.	2 1/2' tall
CODI	Coccoloba diversifolia ...Pigeon Plum	2	ea.	10' tall x 4' spread, 4" cal.
EUMR	Euphorbia milii 'Rosy' ...Rosy Crown of Thorns	380	ea.	3 gallon cans
FIBE	Ficus benjamina ...Weeping Fig	6	ea.	3 1/2' tall
PITV	Pittosporum tobira 'Variegated' ...Var. Pittosporum	205	ea.	3 gallon cans

LYONS ROAD

5190 NW 167th St. Suite 111  
MIAMI, FLORIDA 3314  
PHONE: 305-620-7781  
FAX: 305-620-7787  
EMAIL: rgdesign@bellsouth.net  
CORPORATE # LC0000266

LANDSCAPE ARCHITECTURE  
LAND PLANNING  
MEMBER  
AMERICAN SOCIETY OF  
LANDSCAPE ARCHITECTS



LYONS - SAWGRASS  
SHOPPING CENTER  
COCONUT CREEK, FLORIDA

PLANTING PLAN  
AND LEGEND

Bill Rosenberg Ken Gardner	FL LA #143 FL LA #1569
DATE	2/25/05
REVISIONS	
3/24/05	2/18/08
1/18/06	1/27/10
1/30/06	
6/7/06	
11/21/06	
9/11/07	
SCALE	1" = 20'-0"
SHEET	LA-1

