



| PLANT LIST | | | |
|------------|---|------|--|
| KEY | PLANT NAME | QTY. | UT. SIZE |
| CHIC | Chrysobalanus icaco ...Cocoplum | 300 | ea. 3 gallon cans, 24" x 18" |
| COES | Conocarpus erectus sericeus ...Silver Buttonwood | 4 | ea. 8' tall x 4' spread, 2" cal. 3 1/2 c.t. standard |
| HAPA | Hamelia patens ...Firebush | 44 | ea. 3 gallon cans |
| ILCA | Ilex cassine ...Dahoon Holly | 8 | ea. 10' tall x 4' spread, 4 1/2 c.t., 2" cal. |
| IXNG | Ixora Nora Grant | 66 | ea. 3 gallon cans, 24" x 18" |
| PITY | Pittosporum tobira variegata ...Variegated Pittosporum | 73 | ea. 3 gallon cans, 12" x 14" |
| PSLI | Psychotria ligustrifolia ...Bahama Coffee | 164 | ea. 3 gallon cans, 18" x 18" |
| QUVI | Quercus virginiana ...Live Oak | 4 | ea. 14'-15' tall x 5'-6' spread 2 1/2" cal., 4 1/2' c.t. |
| RAIN | Raphiolepis indica ...Indian Hawthorne | 415 | ea. 3 gallon cans, 16" spread |
| TAHE | Tabebuia heterophylla ...Pink Tabebuia | 6 | ea. 12' tall x 6' spread, 4 1/2' c.t., 2 1/2" cal., FG |
| VEMO | Veitchia montgomeryana ...Montgomery Palm | 6 | ea. 22'-25' tall overall |
| sod | St. Augustine "Floratum" | | s.f. Solid Sod |
| | Planting Soil | | c.y. |
| | Everglades Muck | | |
| | Shredded Melaleuca Mulch (Grade B) | | c.y. |

| LANDSCAPE REQUIREMENT LEGEND | | |
|---|-----------------------------|--|
| ITEM | REQUIRED | PROVIDED |
| Minimum Landscape Requirement B-3 Zone [Sec. 13-443 (4)] Plot area not used for structures and parking = 49,642 s.f. / 1000 s.f. = 49.6 | 50 trees | 50 (including trees on existing buffer) |
| Special Provisions [Sec. 13-443 (7e)] 420 lin. ft. landscape space between building and parking / 40 lin. ft. per tree = 10.5 trees for shrubs 20 x 10.5 for groundcover 30 x 10.5 | 248 | 248 |
| Landscape Adjacent to Streets [Sec. 13-443 (8a)] | 11 trees | 12 |
| Interior Landscape Requirements [Sec. 13-443 (12d)] 60 parking spaces = 1 tree per 10 spaces = 6 trees [Sec. 13-443 (12d)] 316 lin. ft. divider median / 40 lin.ft. = 7.9 trees | 210 | 246 |
| Street Trees [Se. 13-443 (13)] | 315 | 315 |
| | provided on existing buffer | |
| | 6 | 7 |
| | 8 | 11 |
| | provided on existing buffer | |
| | Total Required Trees | 75 |
| | | 75+ |

| New Tree | Percentage of Trees per Tree Category (not including buffer) | | |
|----------|--|------|-----|
| | Shade / Canopy (17) 12 new + 5 existing | 40% | 48% |
| | Intermediate Trees (11) | 30% | 30% |
| | Small Tree (11) | 10% | 30% |
| | Total Trees | = 35 | |

| | | |
|---|-----|-----|
| % OF NATIVE MATERIAL (NEW PLANTS) TREES & PALMS | 40% | 57% |
| SHRUBS | | 56% |

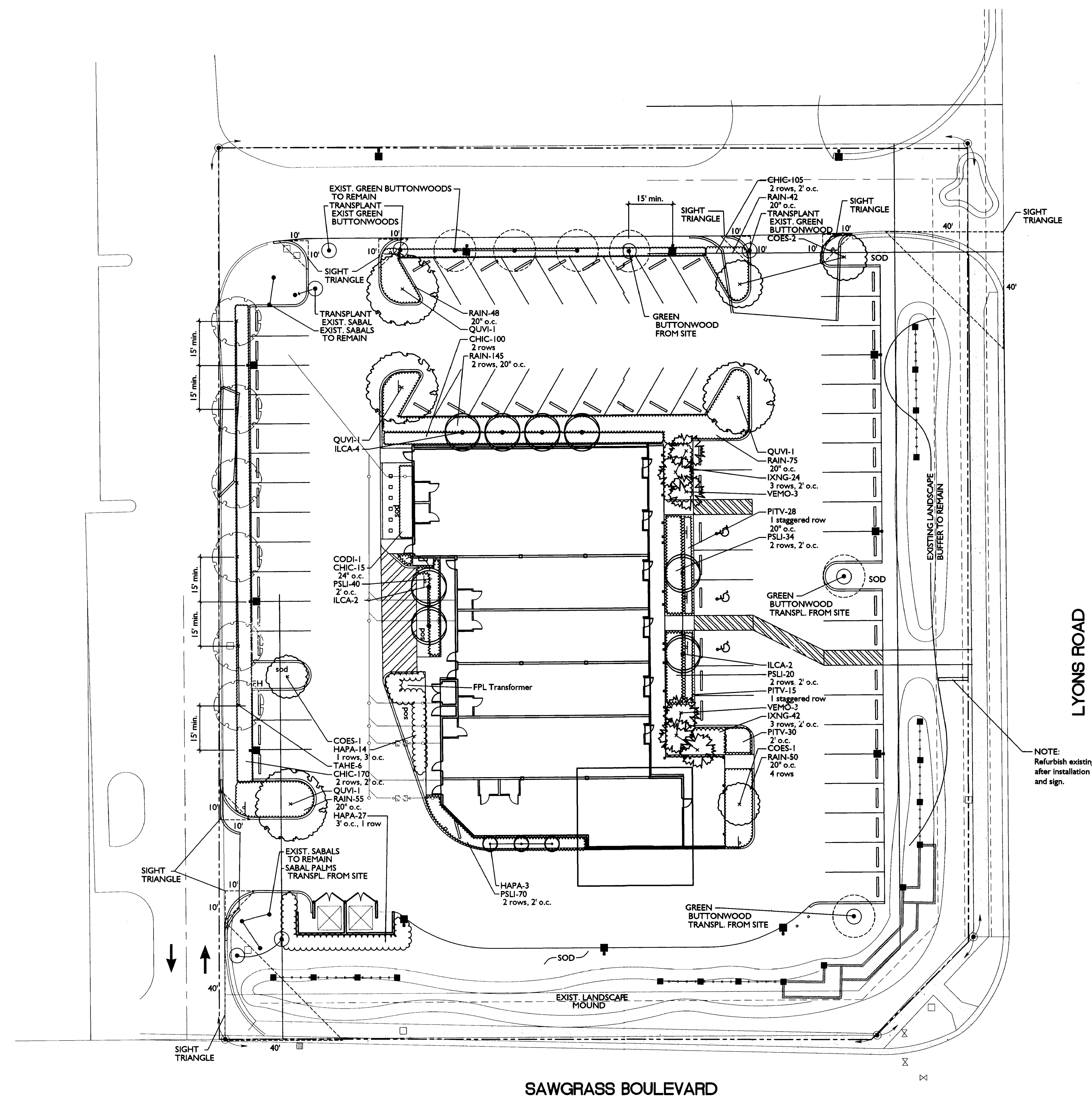

NOTE: Refurbish existing landscape after installation of sidewalk and sign.