

STATE ROAD 7 (US441)

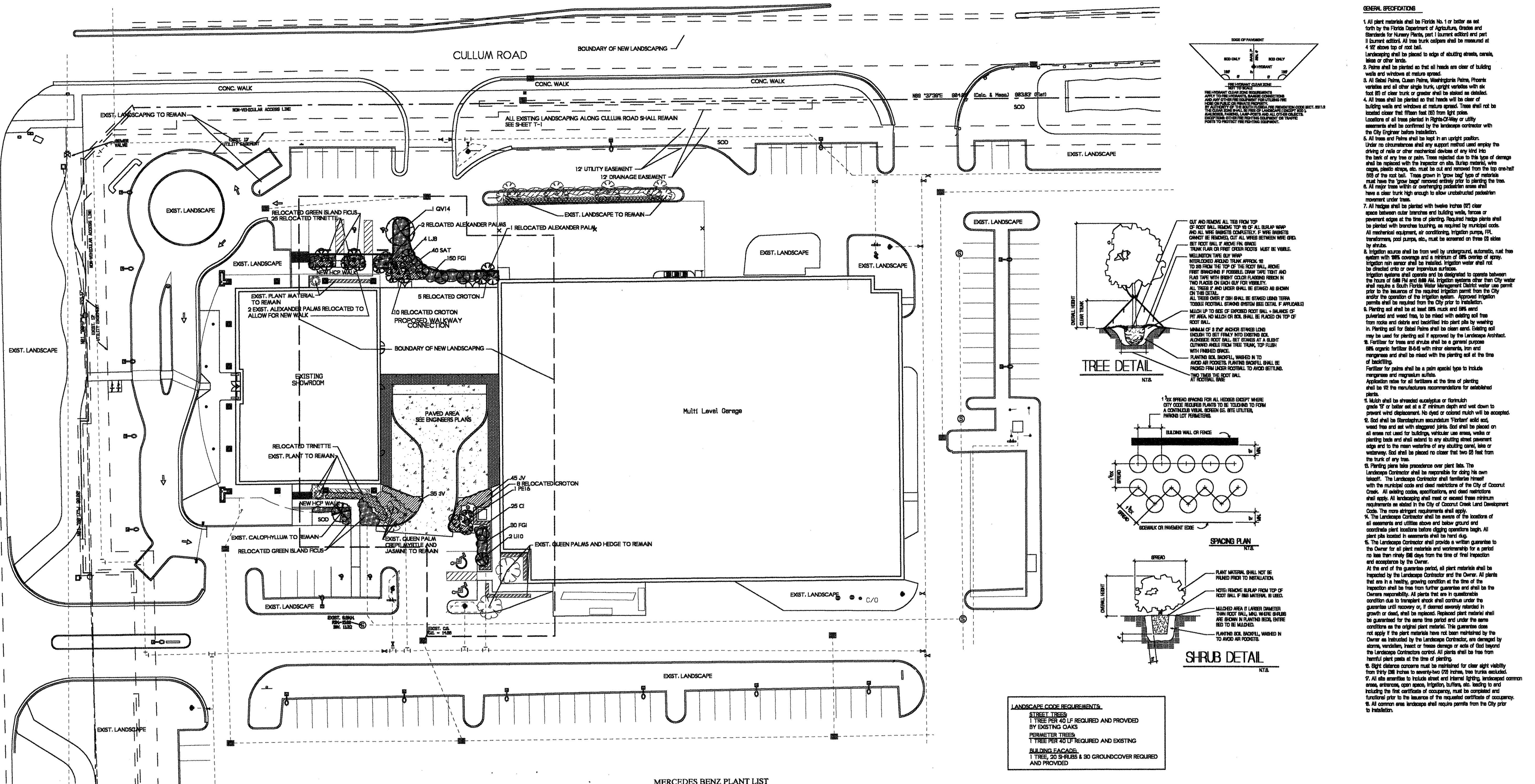

LANDSCAPE CODE REQUIREMENTS

STREET TREES
1 TREE PER 40 LF REQUIRED AND PROVIDED BY EXISTING OAKS

PERIMETER TREES
1 TREE PER 40 LF REQUIRED AND EXISTING

BUILDING FACADE
1 TREE, 20 SHRUBS & 90 GROUND COVER REQUIRED AND PROVIDED

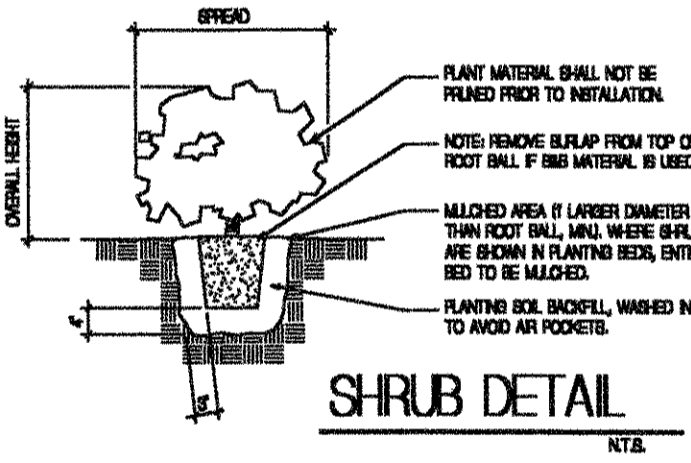
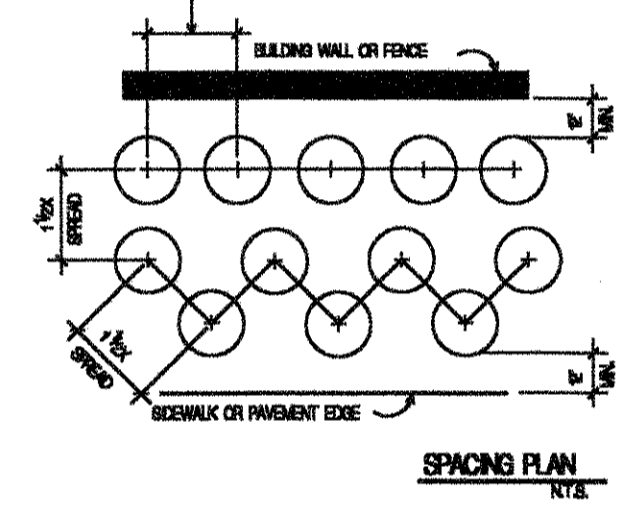
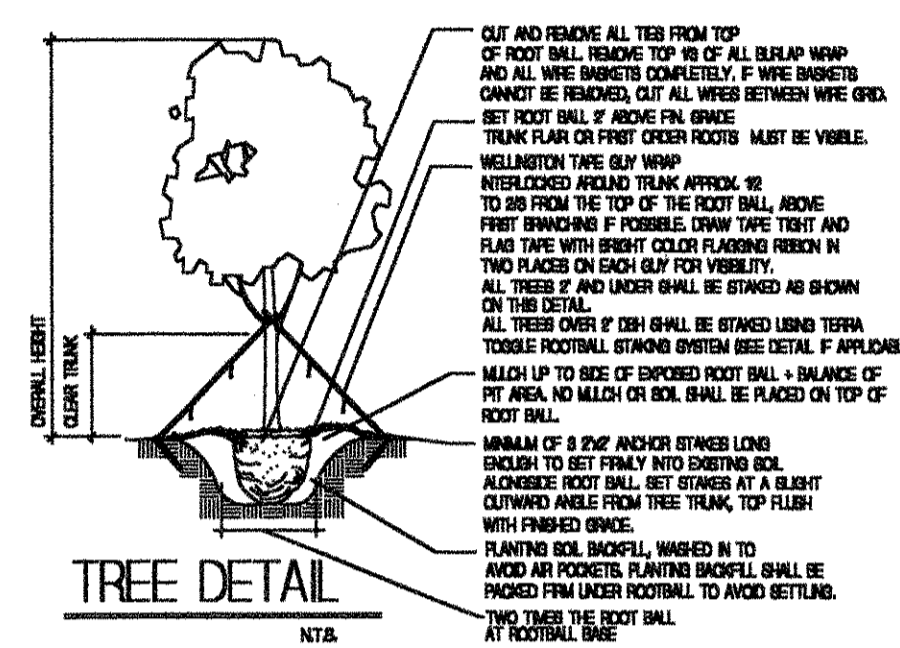

GENERAL SPECIFICATIONS

- All plant materials shall be Florida No. 1 or better as set forth by the Florida Department of Agriculture, Citrus and Subtropicals for Nursery Plants, part 1 (current edition) and part 2 (current edition). All tree trunk calipers shall be measured at 4" above top of root ball.
- Landscape shall be placed to edge of existing streets, curbs, sidewalks or other limits.
- Plants shall be planted so that all trunks are clear of building walls and windows at mature spread.
- All Sabal Palms, Queen Palms, Washingtonia Palms, Phoenix varieties and all other single trunk, upright varieties with dbh less than 6" shall be planted so that trunk will be clear of building walls and windows at mature spread. Trees shall not be located closer than 10 feet from fire exits.
- Locations of all trees planted in Right-Of-Way or utility easements shall be confirmed by the landscape contractor with the City Engineer before installation.
- All trees and Palms shall be kept in an upright position. Under no circumstances shall any support method used employ the string of nails or other mechanical devices of any kind into the trunk of any tree or palm. Trees rejected due to this type of damage shall be replaced with the Inspector on site. Burlap material, wire cages, plastic strips, etc. must be cut and removed from the top one-half (1/2) of the root ball. Trees grown in "grow bags" types of materials shall have the "grow bags" removed entirely prior to planting the tree.
- All major trunks within or overhanging pedestrian areas shall have a clear trunk high enough to allow unobstructed pedestrian movement under trees.
- All hedges shall be planted with twelve (12) inch clear space between outer branches and building walls, fence or pavement edges at the time of planting. Hedges shall be planted with branches facing as required by municipal code. All mechanical equipment, air conditioning, irrigation pumps, PFL transformers, pool pumps, etc. must be screened on three (3) sides by trees.
- Irrigation system shall be from well by underground, automatic, cast iron system with 100% coverage and a minimum of 200' coverage of spray. Irrigation system shall be installed. Irrigation water shall not be checked onto or over impervious surfaces. Irrigation systems shall operate and be designated to operate between the hours of 6:00 PM and 8:00 AM. Irrigation systems other than City water shall include a Backflow Preventer. Irrigation system water use permit shall be obtained from the City prior to installation.
- Planting soil shall be at least 60% mulch and 40% sand and pulverized and weed free, to be mixed with existing soil free from rocks and debris and installed in 6" deep pits by watering in. Planting soil for Sabal Palms shall be clean sand. Existing soil may be used for planting soil if approved by the Landscape Architect.
- Fertilizer for trees and shrubs shall be a general purpose 60% organic fertilizer (8-8-8) with minor elements, iron and manganese and shall be mixed with the planting soil at the time of planting.
- Fertilizer for palms shall be a palm specific type to include manganese and magnesium sulfate.
- Application rates for all fertilizers at the time of planting shall be as per the manufacturer's recommendations for established plants.
- Mulch shall be shredded cypress or mulch grade 1" or better set at 2" minimum depth and wet down to prevent wind displacement. No dyed or colored mulch will be accepted.
- Soil shall be *Stereophyllum maculatum* "Fertile" acid soil, weed free and set with diagonal joints. Soil shall be placed on all areas not used for buildings, vehicle use areas, walks or planting beds and shall extend to any skirting street pavement edge and to the mean wall of any existing canal, lake or waterway. Soil shall be placed no closer than two (2) feet from the trunk of any tree.
- Planting plans shall precede over plant bids. The Landscape Contractor shall be responsible for doing his own layout. The Landscape Contractor shall familiarize himself with the municipal codes and deed restrictions of the City of Coconut Creek. All zoning codes, specifications, and deed restrictions shall apply. All landscaping shall meet or exceed these minimum requirements as stated in the City of Coconut Creek Land Development Code. The more stringent requirements shall apply.
- The Landscape Contractor shall be aware of the locations of all easements and utilities down and before ground and coordinate plant location before digging operations begin. All plant pits located in easements shall be hand dug.
- The Landscape Contractor shall provide a written guarantee to the Owner for all plant materials and workmanship for a period no less than ninety (90) days from the time of final inspection and acceptance by the Owner.
- At the end of the guarantee period, all plant materials shall be inspected by the Landscape Contractor and the Owner. All plants that are in a healthy, growing condition at the time of the inspection shall be free from further guarantee and shall be the Owner's responsibility. All plants that are in questionable condition due to transplant shock shall continue under the guarantee until recovery or, if deemed severely retarded in growth or dead, shall be replaced. Replaced plant materials shall be guaranteed for the same time period and under the same conditions as the original plant material. This guarantee does not apply if the plant materials have not been maintained by the Owner as instructed by the Landscape Contractor, are damaged by storms, vandalism, insect or disease damage or acts of God beyond the Landscape Contractor's control. All plants shall be free from harmful plant pests at the time of planting.
- Eight (8) diameter concerns must be maintained for clear sight visibility from 100 feet to several hundred (200) feet, two trees included.
- All site attention to include street and internal lighting, landscaped common areas, entrance, open space, irrigation, buffers, etc. leading to and including the certificate of occupancy, must be completed and functional prior to the issuance of the requested certificate of occupancy.
- All common area landscaping shall require permits from the City prior to installation.

NOTE: The quantities on this plant list are to be used as a guide only. Bidder shall do independent takeoff for bidding purposes.

CT = CLEAR TRUNK GW = GREY WOOD DBH = DIAMETER BREAST HEIGHT (4 1/2") OA = OVERALL HEIGHT
 FTB = FULL TO BASE HVY = HEAVY TRUNK CAL = CALIPER @ 6" / 12" PER GRADES & STDS. SING. = SINGLE TRUNK
 DBL = DOUBLE TRUNK TRP = TRIPLE TRUNK STD = TREE STANDARD MULT = MULTI-TRUNK
 STAG = STAGGERED HEIGHTS B&B = BALLED AND BURLAPPED FG = FIELD GROWN
 ALL PLANT MATERIALS MUST ADHERE TO CURRENT GRADES AND STANDARDS FOR FLORIDA NUMBER ONE QUALITY OR BETTER

SYM	QTY	BOTANICAL NAME	COMMON NAME	OA HEIGHT	TRUNK SPREAD	TRUNK SPECS.	TRUNK DIA.	COMMENTS
CI	25	Chrysobalanus icaco	Cocoplum	18"	18"			
FGI	180	Ficus microcarpa	Green Island Ficus	18"	18"			
JV	80	Jasminum volubile	Wax Jasmine	24"	18"			Full
LI10	2	Lagerstroemia indica	Crape Myrtle	10'	4'	3-4.5CT		
LJ8	4	Ligustrum japonicum	Wax Privet	8'	4'	3CT		MULT
PE16	1	Ptychosperma elegans	Solitaire Palm	16'				Triple
QV14	1	Quercus virginiana	*Live Oak	14'	7'	4.5CT	3"dbh	
SAT	40	Schefflera arboricola "Trinette"	Dwarf Var. Schefflera	24"	18"			

OTHER LANDSCAPE MATERIALS:
 MUL Mulch (in Bags) As needed
 SOIL Planting Soil (Cubic Yards) As needed
 SOD TO BE MEASURED IN FIELD LOCATION AS SHOWN ON PLAN & GENERAL SPECIFICATIONS

RIGHT OF OWNERSHIP: The drawings, designs, arrangements and been represented by these plans are an instrument of service for the project only and are owned by the client. The drawings, designs, arrangements and been represented by these plans are an instrument of service for the project only and are owned by the client. The drawings, designs, arrangements and been represented by these plans are an instrument of service for the project only and are owned by the client.

NO REVISIONS

DATE:	JULY 15, 2011
-------	---------------

SCALE: 1"=30'

DATE: MAY 29, 2011

DRAWN BY: M.J.P.

LANDSCAPE RENOVATION PLAN
MERCEDES BENZ OF COCONUT CREEK
 COCONUT CREEK, FLORIDA

Michael J. Petrow and Associates, Inc.
 Landscape Architecture
 P.O. Box 888, Coral Springs, FL 33075
 Phone: (954) 464-8558 F. Reg. #3282

SHEET NO: L-1
OF ONE

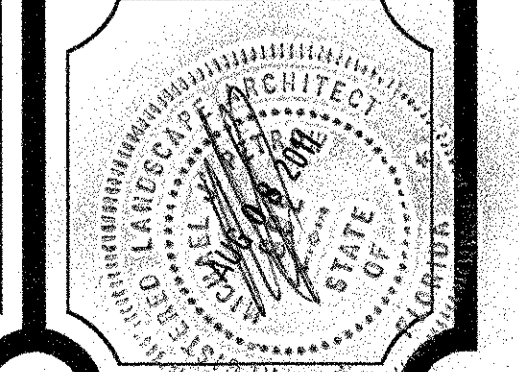

THESE DRAWINGS ARE NOT VALID FOR PERMIT OR CONTRACT CONSTRUCTION USE UNLESS SIGNED, SEALED & DATED WITH AN ORIGINAL SEPA/STATE & LICENSED SEAL BY THE LANDSCAPE ARCHITECT. UNSEALED & UNDATED DRAWINGS MAY BE USED FOR CLIENT HOUSE PURPOSES & BIDDING ONLY.