

TURTLE CREEK DRIVE (CULLUM ROAD)

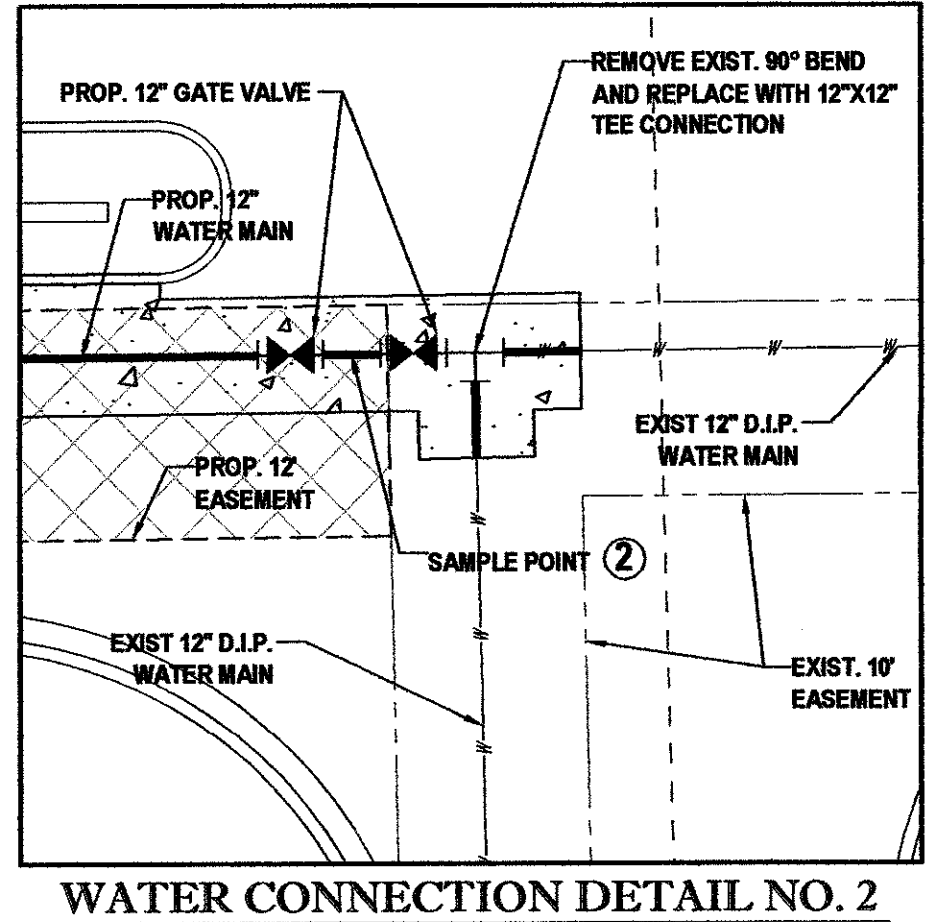
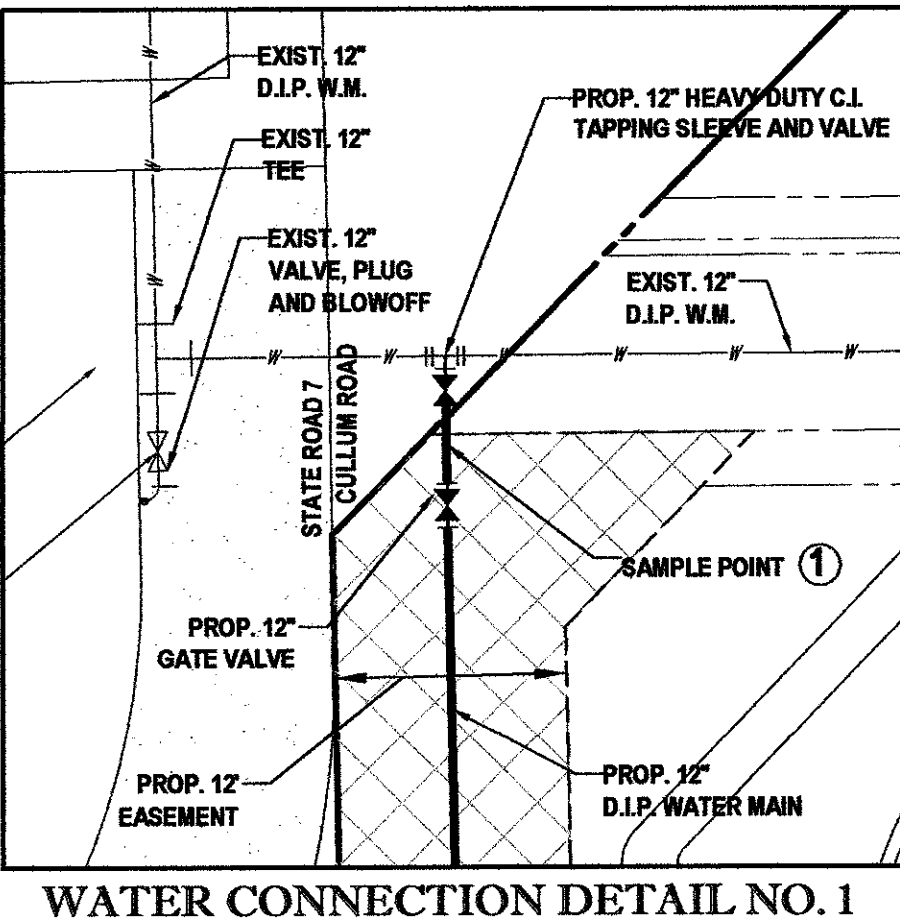
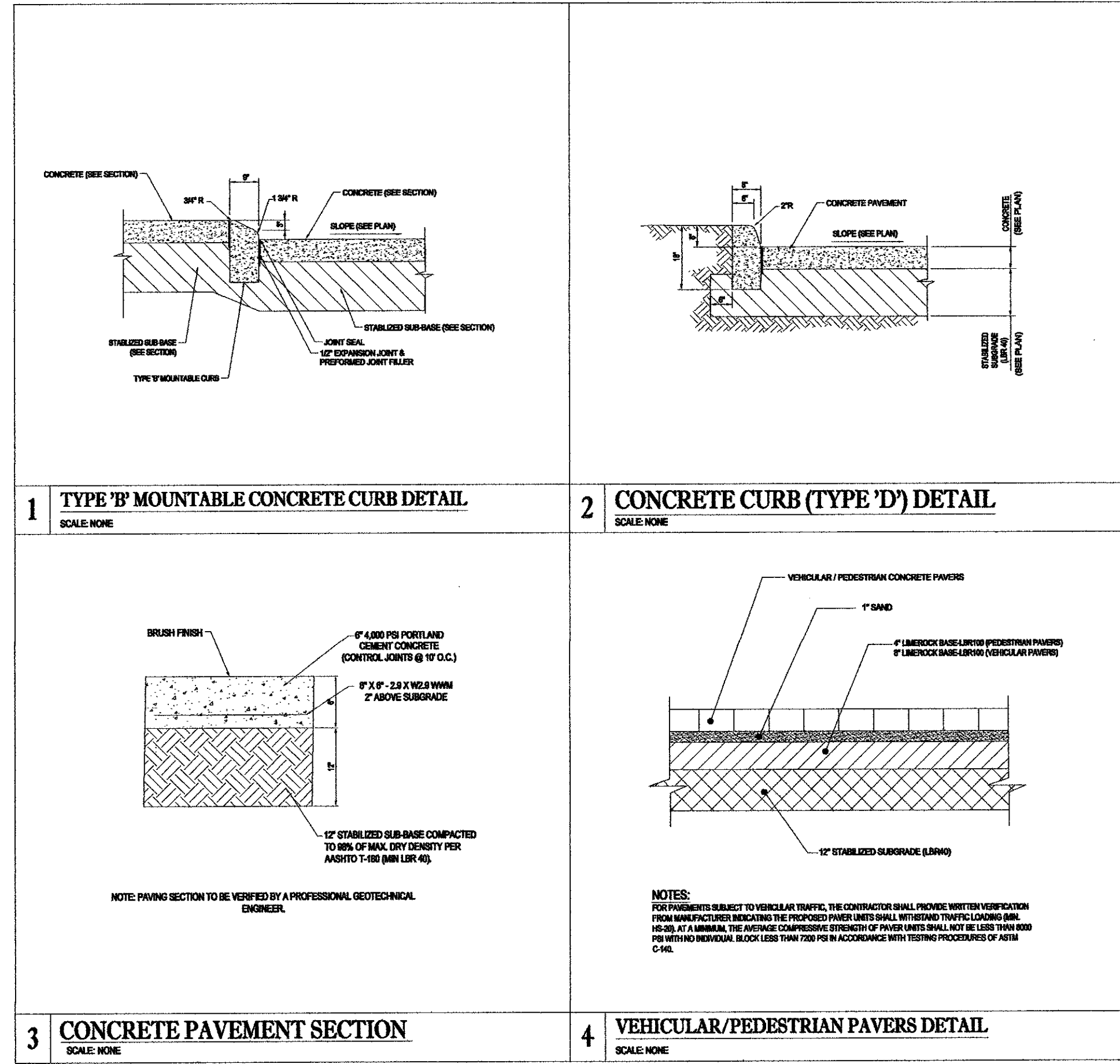
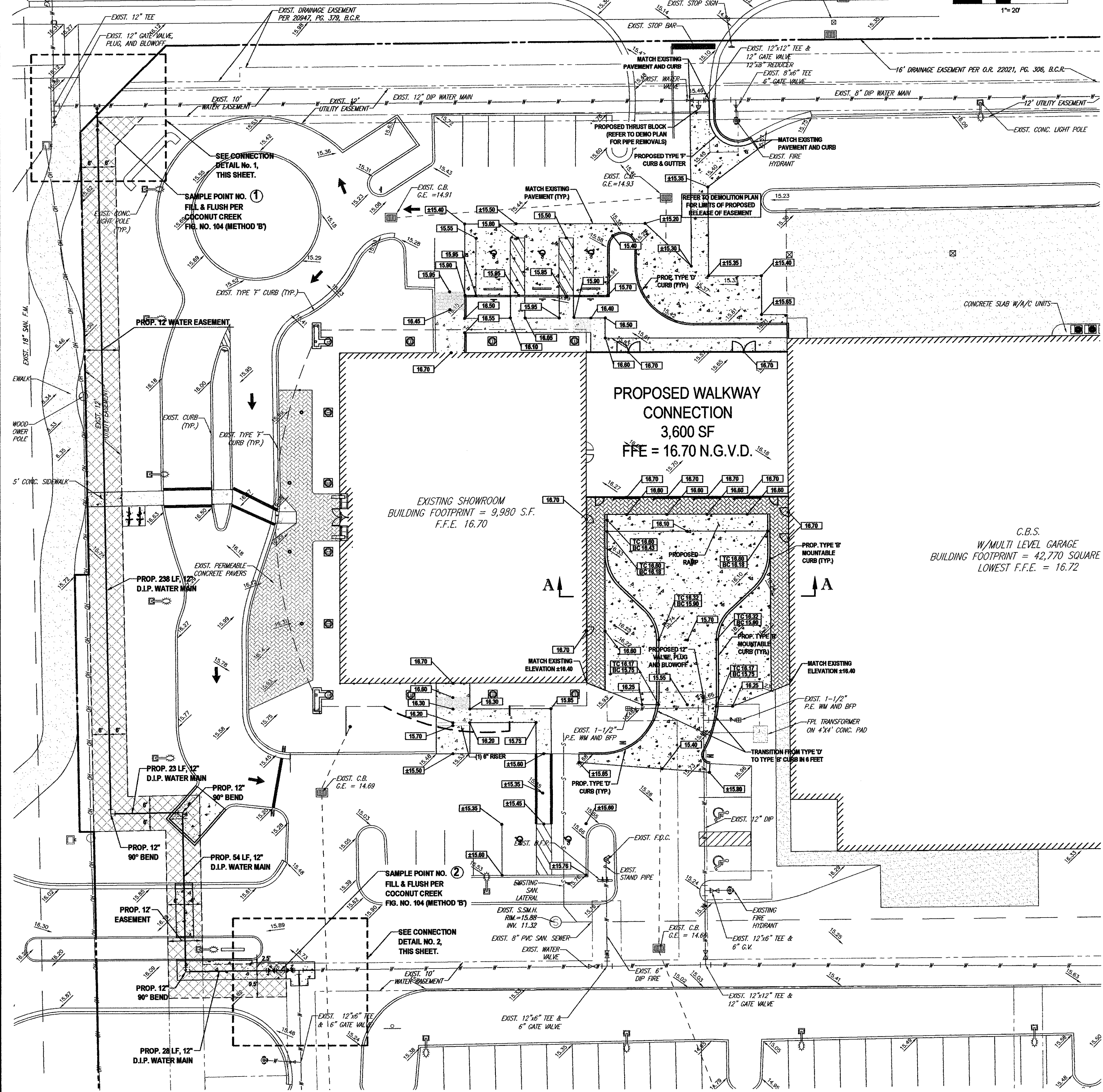
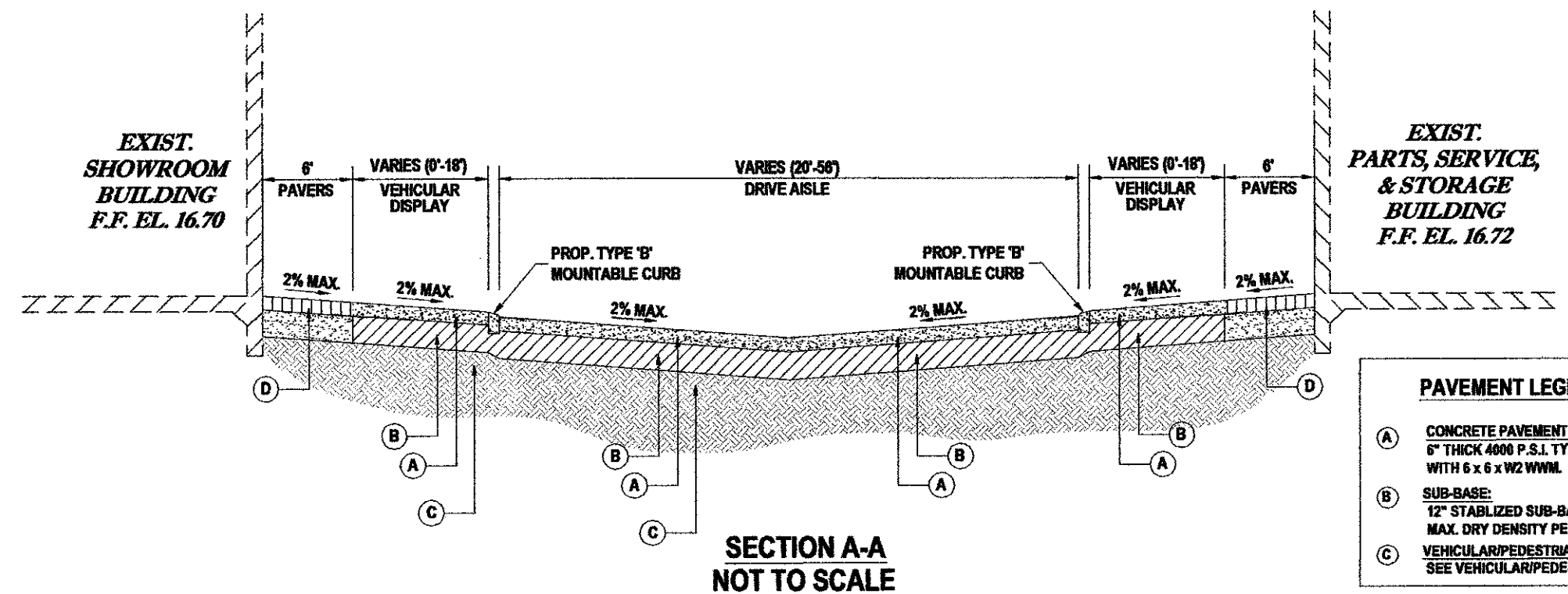
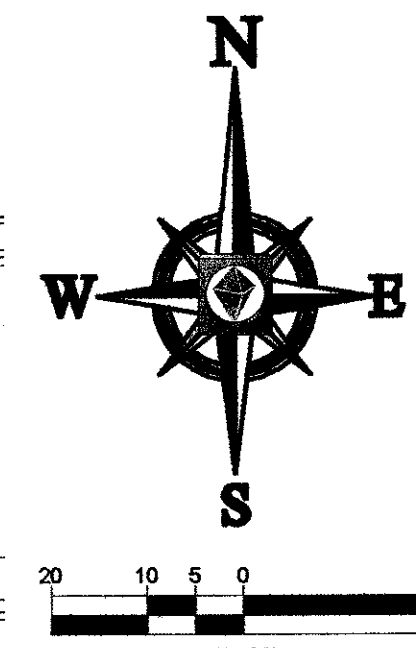

BOHLER ENGINEERING

CORPORATE OFFICE:
WARREN, NJ

OFFICES:
BOWNE, MD
BOSTON, MA
CHICAGO, IL
DENVER, CO
FORT LAUDERDALE, FL
FORT MYERS, FL
FORT WORTH, TX
HARTFORD, CT
HOUSTON, TX
INDIANAPOLIS, IN
JACKSONVILLE, FL
MEMPHIS, TN
MIAMI, FL
MINNEAPOLIS, MN
NEW YORK, NY
ORLANDO, FL
PHOENIX, AZ
RICHMOND, VA
SAN ANTONIO, TX
SAN JOSE, CA
TAMPA, FL

CIVIL & CONSULTING ENGINEERS
SURVEYORS
PROJECT MANAGERS
ENVIRONMENTAL CONSULTANTS
LANDSCAPE ARCHITECTS

REVISIONS:

REV.	DATE	COMMENT	BY
1	05-24-2011	FIRST SITE PLAN SUBMITTAL	NAB
2	06-25-2011	SECOND SITE PLAN SUBMITTAL	NAB
3	08-11-2011	THIRD SITE PLAN SUBMITTAL	NAB

PROJECT No.: F100016
DRAWN BY: LDT
CHECKED BY: NAB
DATE: 05-24-2011
SCALE: AS NOTED
CAD I.D.: 13-F100016-ENGINEERING

PROJECT:
**MERCEDES-BENZ
OF COCONUT CREEK
ADDITION**
FOR
**HODGEN
CONSTRUCTION**

4250 NORTH STATE ROAD 7
CITY OF COCONUT CREEK
BROWARD COUNTY, FLORIDA

BOHLER ENGINEERING

RADICE III
1000 CORPORATE DRIVE, SUITE 250
FORT LAUDERDALE, FL 33334
PH: (954) 202-7000
FX: (954) 202-7070
www.BohlerEngineering.com

NOEL A. BARNETT
PROFESSIONAL ENGINEER
No. 10,201
FLORIDA LICENSE NO. 27208
FLORIDA PROFESSIONAL ENGINEER WITH No. 27208

SHEET TITLE:
ENGINEERING PLAN
SHEET NUMBER:
C-5

Call two full business days (but not more than five) before digging to find out where buried facilities (electric, gas, telephone, cable, water) are located.

811
Know what's below.
Call before you dig.

Printed on Wednesday, August 10, 2011, 10:10 AM by Noel Barnett
C:\Users\carol\Desktop\BOHLER\PROJECTS\COCONUT CREEK ADDITION\1-FRONT-ENGINEERING\KAYOUT - SITE-ENGINEERING