

# STREETSCAPES 6

## 6.3 Street Type C MainStreet 170' ROW

Street Type C is the primary east-west MainStreet retail corridor and provides for an integrated relationship between retail development and open space components through the incorporation of a pedestrian park, promenade/greenway, and lakefront. The streetscape is designed to maximize lake view, encourage active and passive recreational activities, and facilitate safe pedestrian movement between commercial and recreational uses.

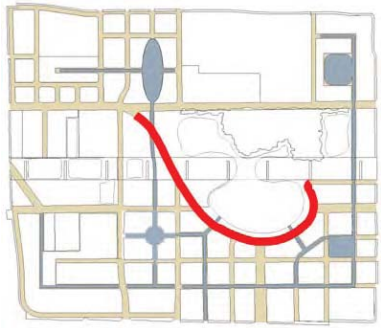
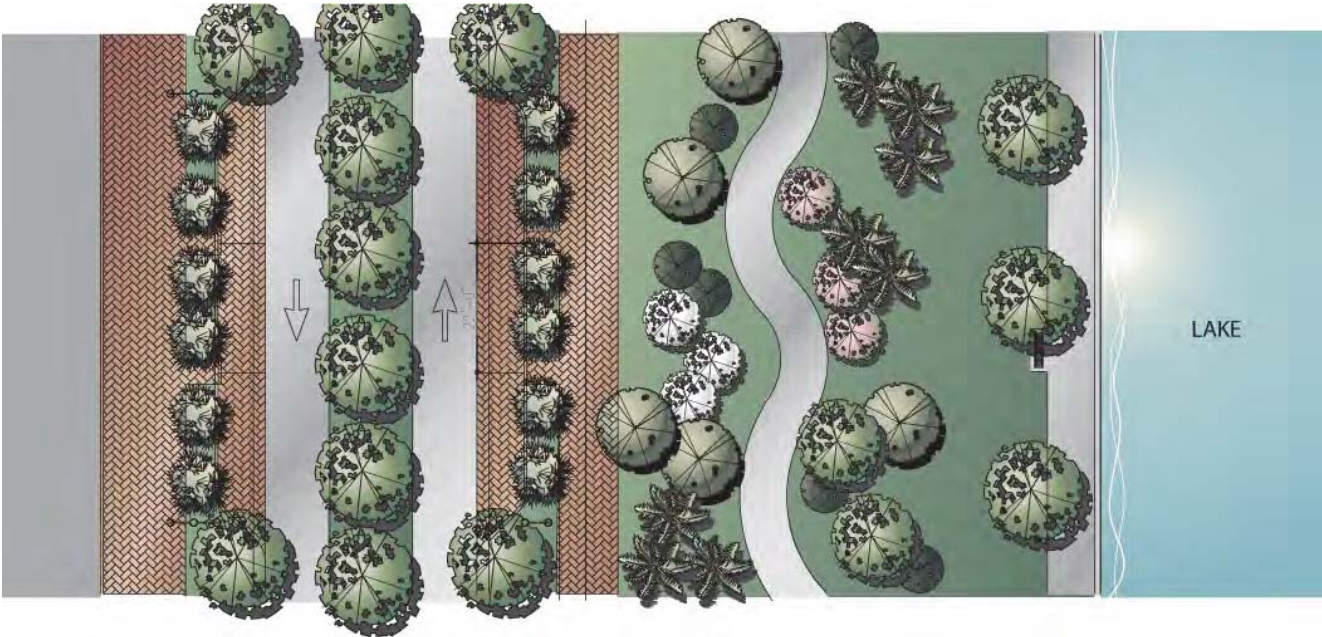

Type C Location Diagram

