

**GROUND LEVEL PHOTOMETRIC GARAGE PLAN**  
SCALE: 1/16"=1'-0"  
NORTH

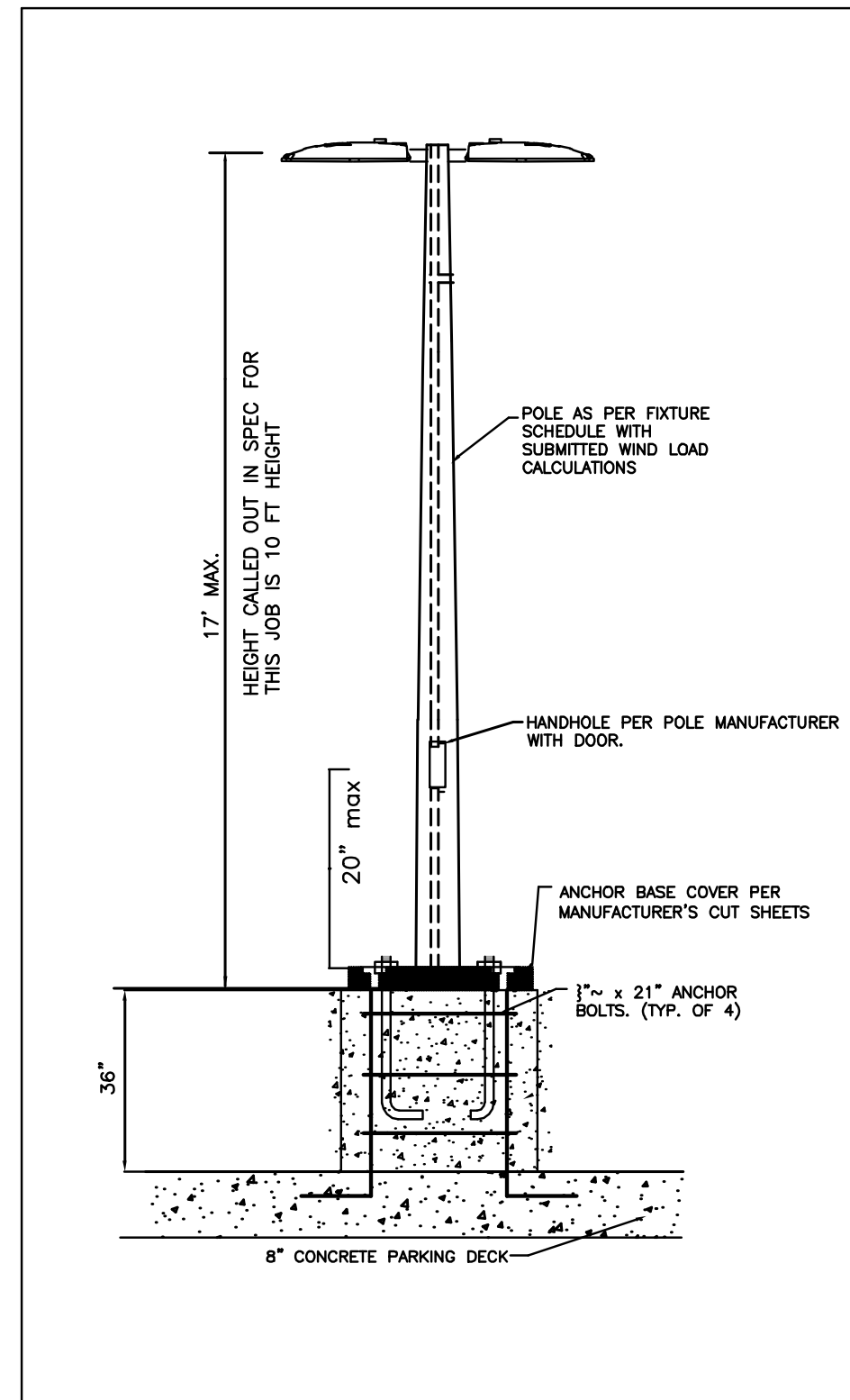

**PARKING DECK TOP LEVEL ANCHOR BASE POLE ON CONCRETE DECK**  
NOTE: MOUNTING CONCRETE PEDESTAL SIZE AND ANCHOR BOLT LOCATIONS SHALL BE COORDINATED WITH POLE TEMPLATE.  
N.T.S.

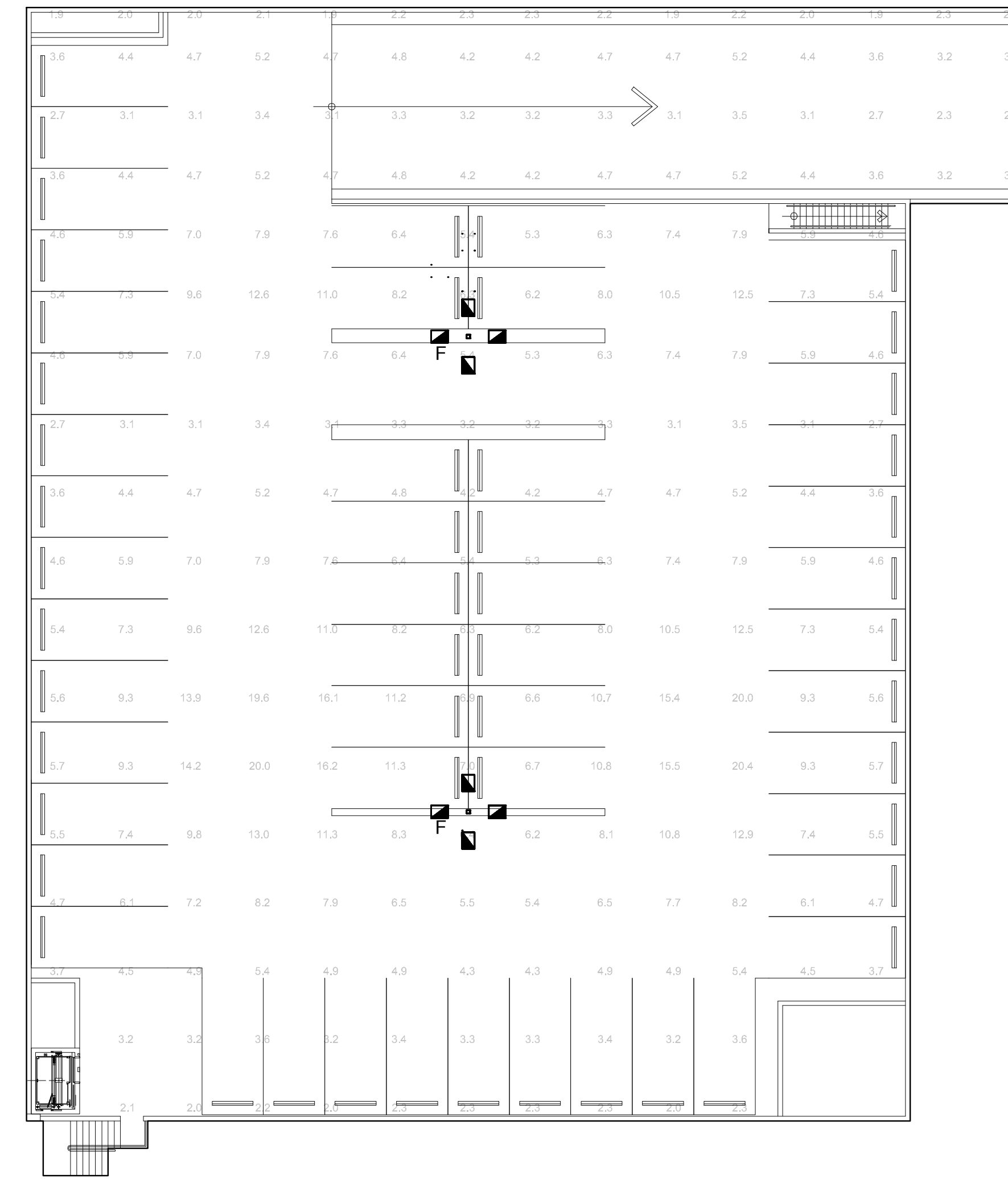

**ROOF LEVEL PHOTOMETRIC GARAGE PLAN**  
SCALE: 1/16"=1'-0"  
NORTH

Luminaire Schedule - Garage Ground Level									
Symbol	Label	Qty	Catalog Number	Description	Lamp	Number Lamps	Lumens per Lamp	LLF	Wattage
A	A	37	CITOL254M45MV	52x7x6" SUSPEND ENCLOSED/GASKETED LUMINAIRE SPECULAR GARAGE REFLECTOR w/CLEAR ACRYLIC DROP LENS UNIVERSAL BALLAST #B254PUNV-D WATTS=95	2/54W T5HO	2	0	0.72	95
AE	AE	16	CITOL254M45MV	52x7x6" SUSPEND ENCLOSED/GASKETED LUMINAIRE SPECULAR GARAGE REFLECTOR w/CLEAR ACRYLIC DROP LENS UNIVERSAL BALLAST #B254PUNV-D WATTS=95	2/54W T5HO	2	700	0.72	95

Statistics Normal - Garage Ground Level						
Description	Symbol	Avg	Max	Min	Max/Min	Avg/Min
Calc Zone #1	+	7.1 fc	19.4 fc	1.8 fc	10.8:1	3.9:1
GARAGE ENTRY	+	25.6 fc	31.5 fc	18.7 fc	1.7:1	1.4:1

Statistics Emergency - Garage Ground Level						
Description	Symbol	Avg	Max	Min	Max/Min	Avg/Min
Calc Zone #1	+	0.7 fc	1.8 fc	0.1 fc	18.0:1	7.0:1
GARAGE ENTRY	+	0.8 fc	1.9 fc	0.3 fc	6.3:1	2.7:1

LUMINAIRE SCHEDULE									
Symbol	Label	Qty	Catalog Number	Description	Lamp	Lumens	LLF	Watts	
F	F	2	ACUITY BRANDS LIGHTING DSX2 LED 100C 700 50K T4M MVOLT MOUNTED 20' AFG ON ROUND TAPERED ALUMINUM POLE	DSX2 LED W/2 LARGE & 2 MEDIUM LIGHT ENGINES, (2) 700mA DRIVERS, 5000K LED, TYPE T4M OPTICS	WHITE LED ARRAY (INCLUDED)	Absolute	0.85	872	

STATISTICS PARKING LEVEL TOP FLOOR					
Description	Symbol	Avg	Max	Min	Max/Min
OPEN DECK PARK LANES	+	5.2 fc	9.3 fc	2.9 fc	3.2:1
OPEN DECK PARK STALLS	+	5.7 fc	20.4 fc	1.6 fc	12.8:1

REVISIONS	BY
Site Plan Resubmittal #4	
08/07/14	

MIDTOWN RESIDENCES  
AT COCONUT CREEK  
FOR:  
FLORIDA ATLANTIC INVESTMENTS, INC.  
LOCATED AT:  
COCONUT CREEK, FLORIDA

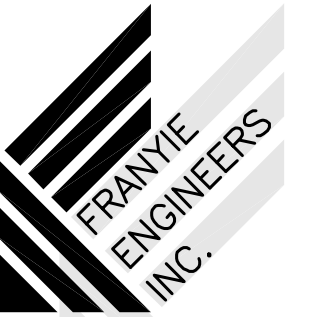

ANTONIO FRANYIE  
Certificate of PE # 11640  
Authorization # 00002905  
VIVIANA FRANYIE  
PE # 49985  
10610 NW 27 Street, Miami FL 33172  
T: (305) 592-1360 F: (305) 594-9279  
www.franjieengineers.com

JOB NUMBER  
DATE Re-submittal for Site 8-7-14

DATE AS SHOWN  
SCALE 1528.PRJ  
JOB NO. SHEET