

NOTE: Over-excavate from final grades shown on plans to accommodate section shown above.

BIO-SWALE DETAIL

N.T.S.

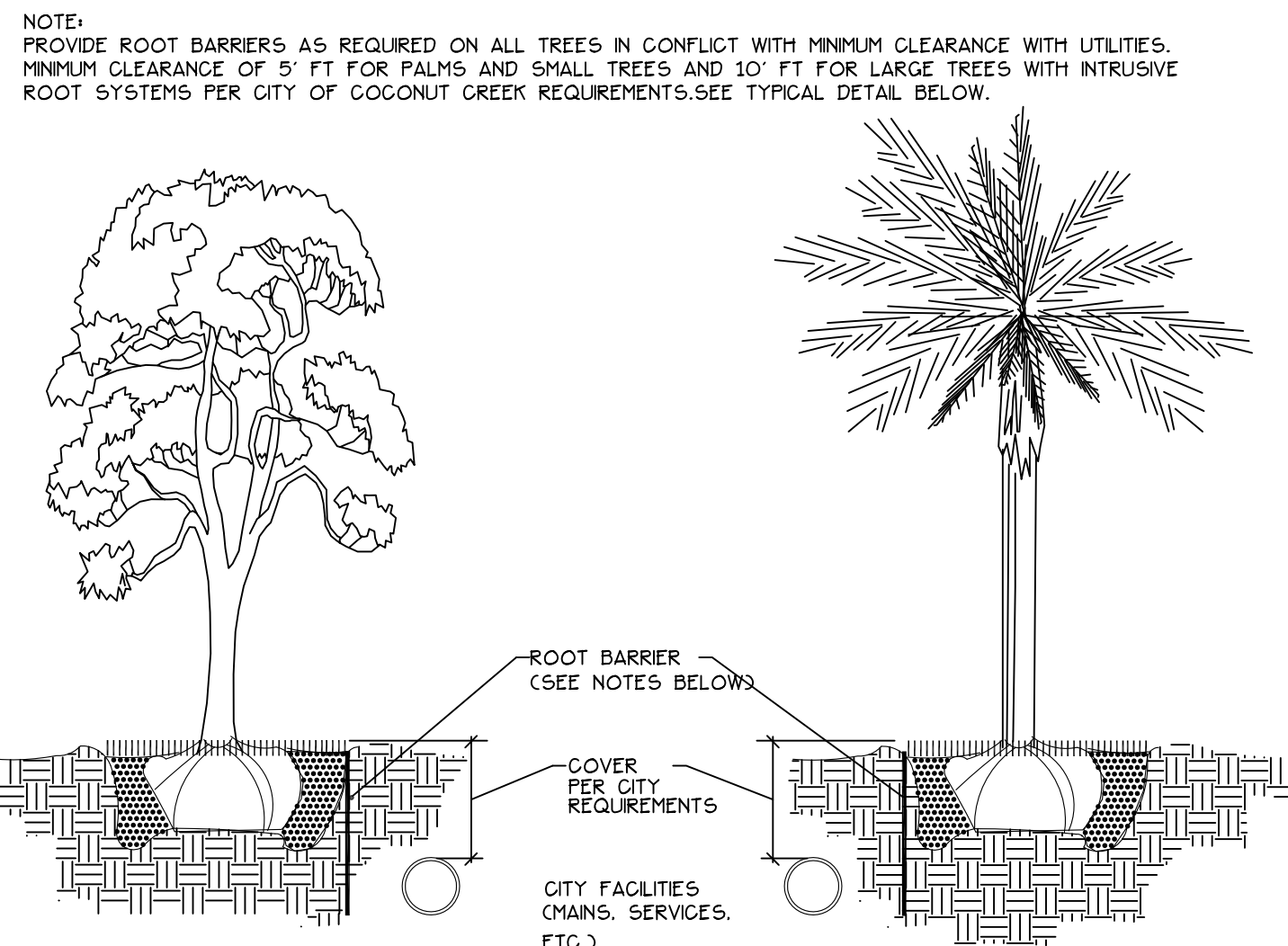

NOTES:

1. THE INSTALLATION OF ROOT BARRIERS SHALL BE COORDINATED WITH CITY AND INSPECTED BY CITY PRIOR TO BACKFILLING. ALL ROOT BARRIERS SHALL EXTEND UP TO FINISHED GRADE.
2. ROOT BARRIERS SHALL HAVE MINIMUM DEEP PER CITY REQUIREMENTS. APPROVED PRODUCTS INCLUDE "DEEP ROOT" AND "ROOT SOLUTIONS". FLEXIBLE BARRIERS SHALL BE 3/8\"/>

TYPICAL TREE ROOT BARRIER DETAIL

N.T.S.

Vertex Water Features
Landscape Systems & Floating Fountains

GeyserJet™ Series

HEIGHT A

TOTAL DISPLAY DIAMETER D

CHECK EITHER WITH OR WITHOUT LIGHTS

| Fountain Only | 1.5 | 2 | 2 | 2 | 3 | 3 | 3 | 3 | 5 | 5 | 7.5 | 7.5 | 10 | 10 | 10 | 15 | 15 | 15 | 20 | 20 |
|---------------|------|------|------|------|------|------|------|------|------|------|------|------|------|------|------|------|------|------|------|------|
| HP | 230 | 230 | 230 | 480 | 230 | 230 | 480 | 230 | 230 | 480 | 230 | 480 | 230 | 230 | 480 | 230 | 230 | 480 | 230 | 480 |
| Phase | 1 | 1 | 3 | 3 | 1 | 3 | 3 | 1 | 3 | 3 | 1 | 3 | 3 | 1 | 3 | 3 | 1 | 3 | 3 | 3 |
| AMP | 11 | 14 | 8 | 4 | 17 | 10 | 5 | 28 | 17 | 9 | 42 | 25 | 12 | 51 | 32 | 18 | 72 | 47 | 24 | 81 |
| Ht. A | 10' | 12' | 12' | 18' | 18' | 20' | 20' | 22' | 22' | 22' | 29' | 29' | 30' | 30' | 30' | 30' | 30' | 30' | 35' | 35' |
| Dia. B | 4' | 4' | 4' | 5' | 5' | 5' | 6' | 6' | 7' | 7' | 7' | 8' | 8' | 8' | 8' | 8' | 8' | 8' | 10' | 10' |
| Lights | 2 | 2 | 2 | 2 | 2 | 2 | 2 | 2 | 3 | 3 | 3 | 3 | 3 | 3 | 3 | 4 | 4 | 4 | 4 | 4 |
| Total Watts | 1000 | 1000 | 1000 | 1000 | 1000 | 1000 | 1000 | 1000 | 1500 | 1500 | 1500 | 1500 | 1500 | 1500 | 1500 | 2000 | 2000 | 2000 | 2000 | 2000 |
| AMP draw | 10 | 10 | 10 | 10 | 10 | 10 | 10 | 10 | 15 | 15 | 15 | 15 | 15 | 15 | 15 | 20 | 20 | 20 | 20 | 20 |

Notes:
1. Drawings are for illustration only and are not to scale.
2. Installation of all fountain equipment shall be in accordance with manufacturer's guidelines and specifications.

Vertex Water Features
2100 NW 33rd Street Pompano Beach, FL 33069
P: 800-432-4302 F: 954-977-7963
www.vertexwaterfeatures.com

WATER FOUNTAIN DETAIL

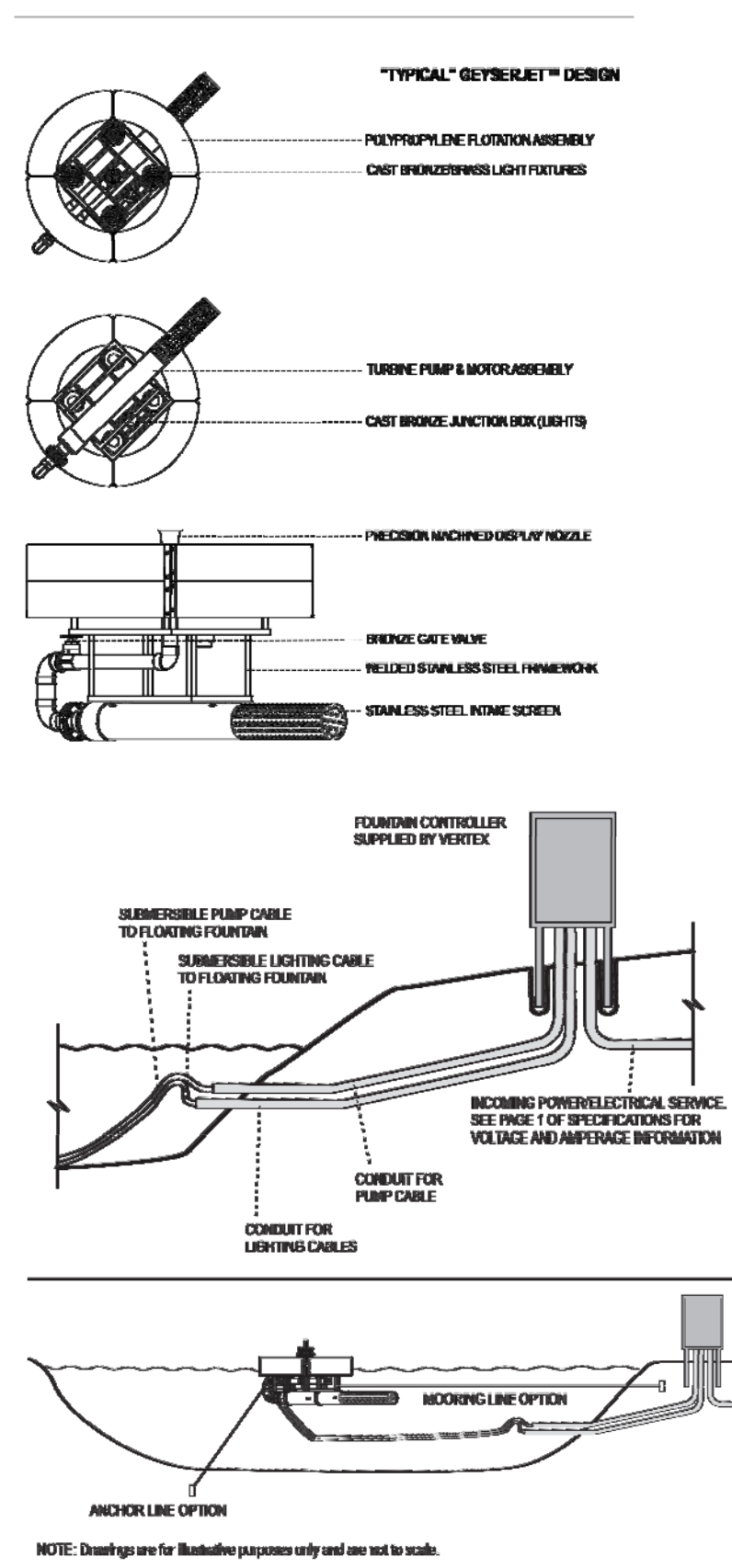

NOTE: Drawings are for illustrative purposes only and are not to scale.

| LOCATION | MANUFACTURE | MODEL | HEIGHT | QUANTITY |
|----------|-------------|-----------|---------|----------|
| Lake | VERTEX | GeyserJet | 12 FEET | 2 |
| Total | | | | 2 |

N.T.S.

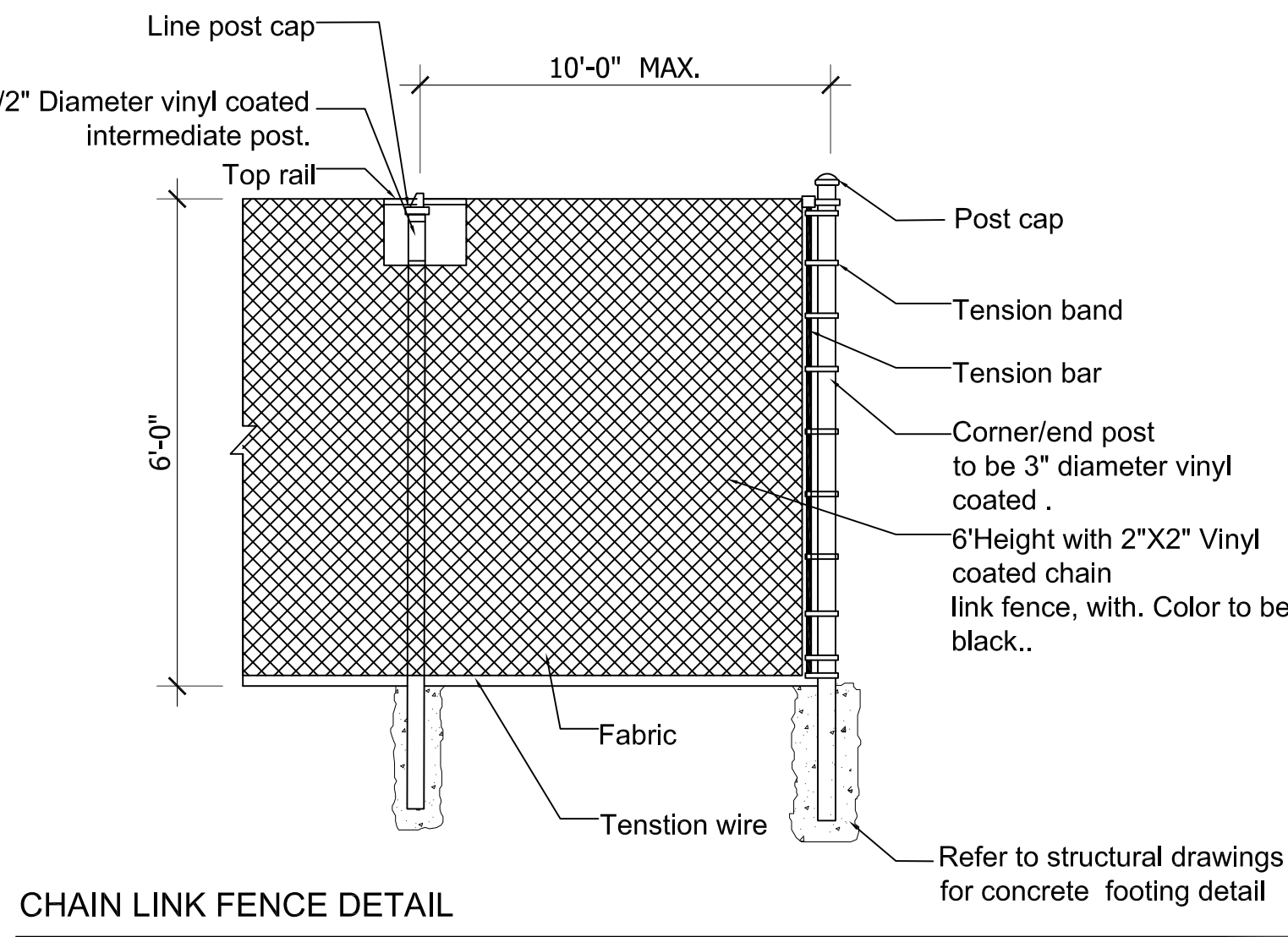

CHAIN LINK FENCE DETAIL

Scale: 1/2"=1'-0"

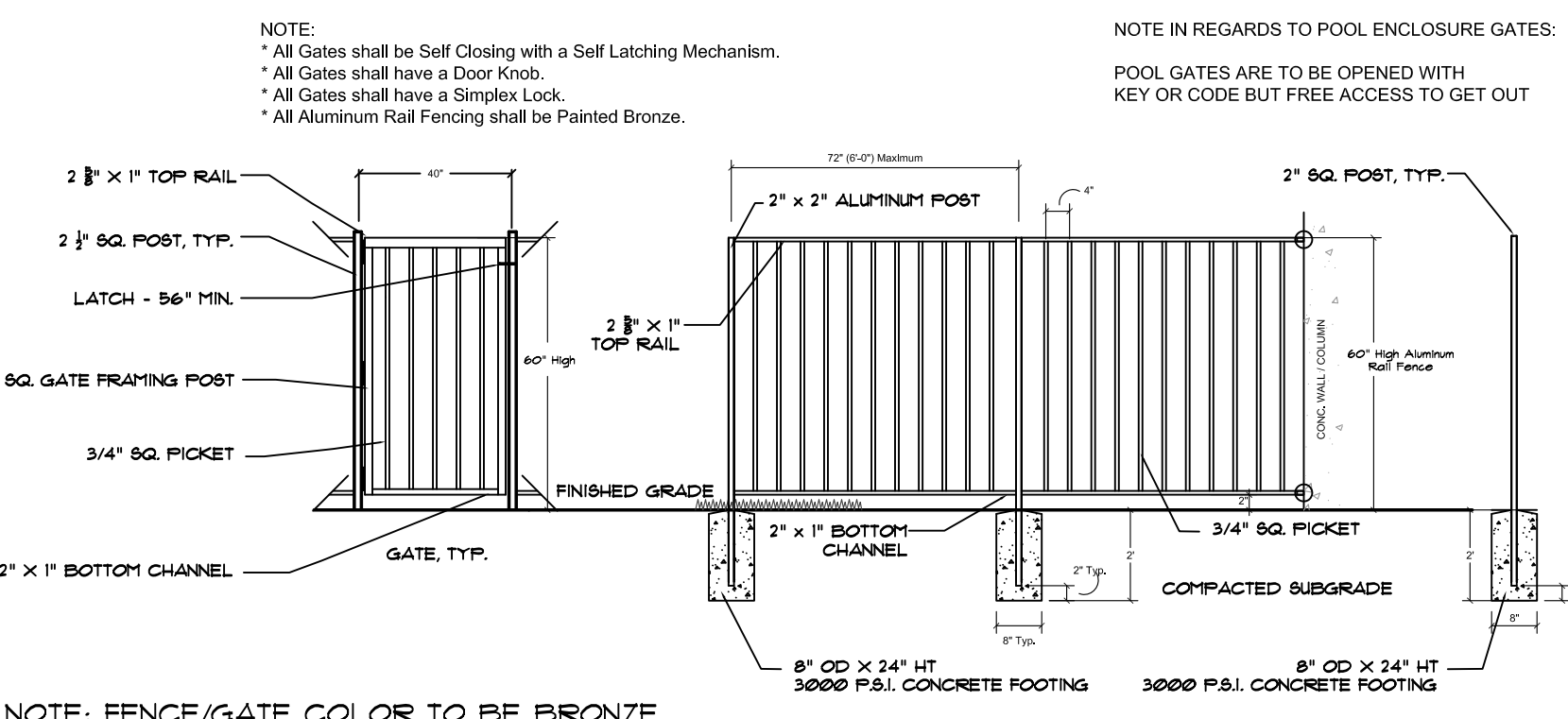

NOTE: FENCE/GATE COLOR TO BE BRONZE

POOL FENCE AND GATE DETAIL

Scale: 1/4"=1'-0"

CITY OF COCONUT CREEK
STANDARD LANDSCAPE NOTES

1. All landscape and specifications shall meet or exceed the minimum requirements as provided in the City of Coconut Creek Land Development Code. Plans are incomplete without written notes and specifications.
2. All planting material shall meet or exceed Florida Grade #1 as specified in Grades and Standards for Nursery Plants, current edition. Trees shall not be tipped, topped, or shaped prior to installation.
3. Landscape shall be placed to edge of abutting streets, canals, lakes or other lands.
4. All mechanical equipment, air conditioning, irrigation pump stations and equipment, FPL transformers, pool pumps, etc., must be screened on three (3) sides by landscape shrubs.
NOTE: The quantity of screening shrubs is in addition to the required number of shrubs as provided in the code calculation table. All screening shrubs shall be planted for proper operation of equipment being screened and/or per the requirements of the utility as necessary. All hedge material required for screening purposes shall be planted with branches touching. Adjust on-center spacing as necessary and/or provide additional plants to provide an adequate screen.
5. Sight distance concerns must be maintained for clear sight visibility from thirty (30) inches to seventy-two inches, tree trunks excluded. Measurement shall be made from top of root ball planted at proper elevation.
6. Guying/staking practices shall not permit nails, screws, wires, etc., to penetrate outer surfaces of trees, palms or other plant material. Trees, palms and plant material rejected due to this practice shall be replaced with the inspector on site.
7. Burlap material, wire cages, plastic/canvas straps, etc., must be cut and removed for the top one-half (1/2) depth of the root ball. Trees and shrubs grown in grow bags or grow bag type material must have such material REMOVED ENTIRELY prior to planting the tree or shrub.
8. All plant material shall be free of pests, insects, disease, weeds, etc.
9. All required landscape material shall be installed using a planting soil mix comprised of a type appropriate to the individual proposed plant material and the native soil found on the site.
10. All plant material shall be planted at the proper depth, as originally grown and/or so the top of the root ball is flush or slightly above finished grade immediately after planting. All trees should provide trunk taper when properly planted at the correct planting depth.
11. All plant material shall be watered in at time of planting to eliminate air pockets in the root zone area.
12. Color-treated or dyed mulch will not be accepted.
13. Upon completion of work, the site shall be cleared of all debris, superfluous materials, and equipment caused by this permit to the satisfaction of the inspector.
14. Refer to Coconut Creek Fire Equipment Clear Zone diagram to maintain a safe zone fronting fire hydrants.
15. Do not plant trees, shrubs or groundcover within Electric Meter Clear Zone. Provide a safe zone as described by the Electrical Inspector.
16. All landscaped areas shall be provided with an underground fully automatic irrigation system using pop-up sprinklers. System shall provide 100% coverage with a 50% overlap (minimum) using rust free water, except preserved areas remaining in natural state. A rain sensor device or switch shall be installed that will override the irrigation system when adequate rainfall has occurred. Water shall not be directed and/or provided onto impervious surfaces and/or be designed or installed to throw water over an impervious surface such as a sidewalk, etc. Hours of operation for all irrigation systems shall be limited to 5:00 p.m. to 8:00 a.m. only or as may be further restricted by South Florida Water Management District or other jurisdictional agency.
17. Irrigation permits and plans shall be submitted for approval at time of building permits.
18. All non-single family or duplex irrigation systems other than City water systems shall require a South Florida Water Management District water use permit prior to issuance of an irrigation permit and installation of the irrigation system as required.
19. All site amenities to include site street lights, landscape common open space, irrigation common open space, buffers, berms, landscape entry features, etc. leading up to and including the model center and/or first certificate of occupancy must be completed and functional prior to issuance of the first requested certificate of occupancy.
20. The height of all required, designed and installed berms shall be from the highest adjacent point whether it is the sidewalk, parking area, vehicular use area, surrounding ground, etc. Where a berm abuts a sidewalk, there shall be a one (1) foot level sod area adjacent to the sidewalk prior to the start of incline for the berm.
21. An inspection is required prior to the backfilling of trees/palms in all parking medians and islands.

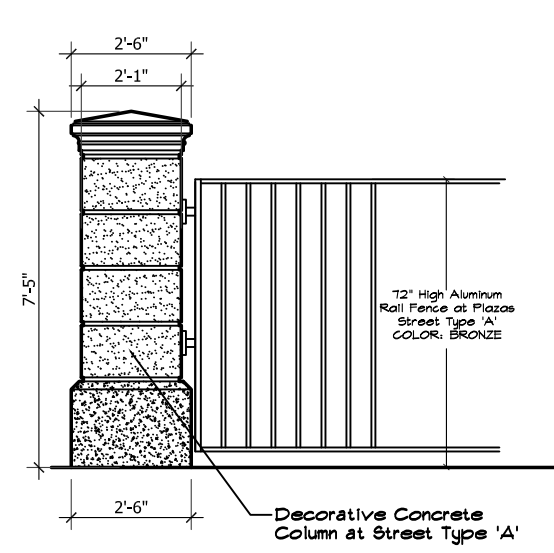

COLUMN & RAIL DETAIL ST. TYPE 'A'

Scale: 1/4"=1'-0"

HUGH JOHNSON
RLA #C000237

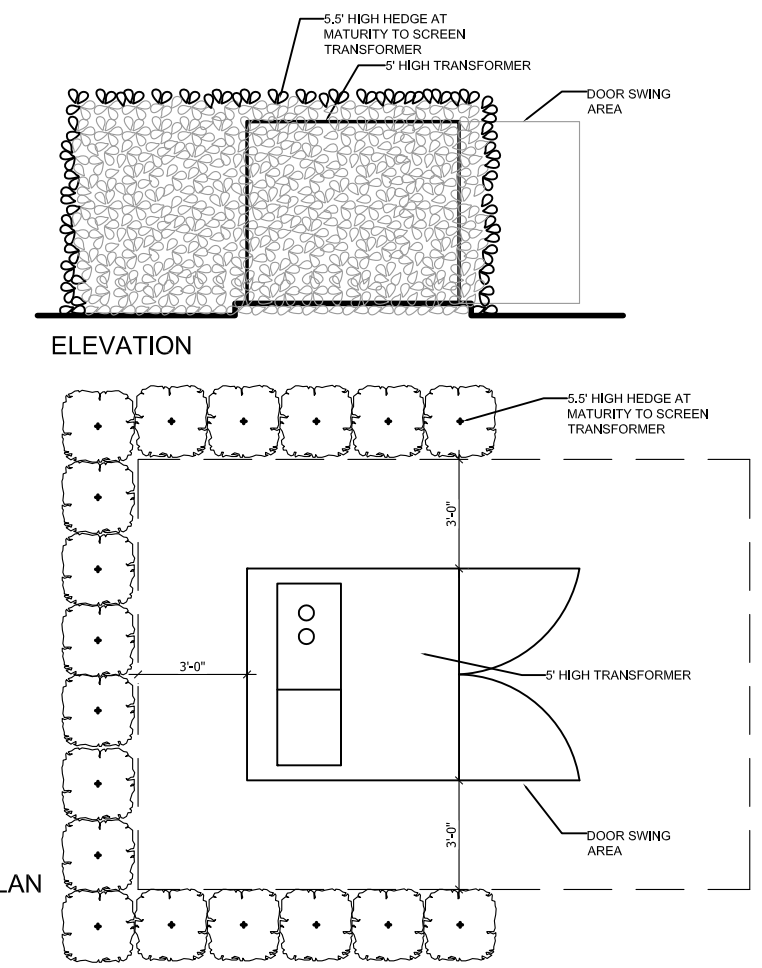

TRANSFORMER SCREENING DETAIL DETAIL

Scale: 1/4"=1'-0"

ARCHITECTURE
LANDSCAPE ARCHITECTURE
LAND PLANNING
INTERIOR DESIGN
GOVERNMENTAL PROCESSING

ARCHITECTURAL ALLIANCE
612 S.W. FOURTH AVENUE, FORT LAUDERDALE, FLORIDA 33315 AA C002084 LC C000237
TEL: (954) 764-8858 FAX: (954) 764-0731 E-MAIL: landscape@archall.net

| REVISIONS | BY |
|------------------------------------|------|
| Site Plan Resubmission #1 02-19-14 | M.M. |
| Site Plan Resubmission #2 04-08-14 | M.M. |
| Site Plan Resubmission #3 07-24-14 | M.M. |
| Site Plan Resubmittal #4 08-20-14 | M.M. |

MIDTOWN RESIDENCES
AT COCONUT CREEK
FOR:
FLORIDA CRYSTALS
LOCATED AT:
COCONUT CREEK, FLORIDA

MSA ARCHITECTS, INC.
MIAMI OFFICE
7695 SW 104th ST.
SUITE 100
MIAMI, FLORIDA 33156
(305) 273-9911

MSA ARCHITECTS
ARCHITECTURE & PLANNING

2011 MSA ARCHITECTS, INC. THE ARCHITECTURAL DESIGN AND DETAIL DRAWINGS FOR THIS BUILDING AND/OR OVERALL PROJECT ARE THE LEGAL PROPERTY OF AND ALL RIGHTS ARE RESERVED BY THE ARCHITECT. THEIR USE FOR REPRODUCTION, CONSTRUCTION, OR DISTRIBUTION IS PROHIBITED UNLESS AUTHORIZED IN WRITING BY THE ARCHITECT.

DRAWN M.S.M.
CHECKED H.J.
DATE 12/19/2013
SCALE AS SHOWN
JOB NO. 1528.PRJ
SHEET

LP-9
LANDSCAPE
DETAILS
PLAN