



1320 S. DIXIE HWY, No 1070
CORAL GABLES, FL 33146
LIC. No. AA-C002151 TEL: (305) 448-7383

PROJECT NAME:

**PALOMA LAKES
PRIVACY WALL**

CITY OF COCONUT CREEK
BROWARD COUNTY,
FLORIDA

OWNER:

**LENNAR
HOMES**

CONSULTANTS:

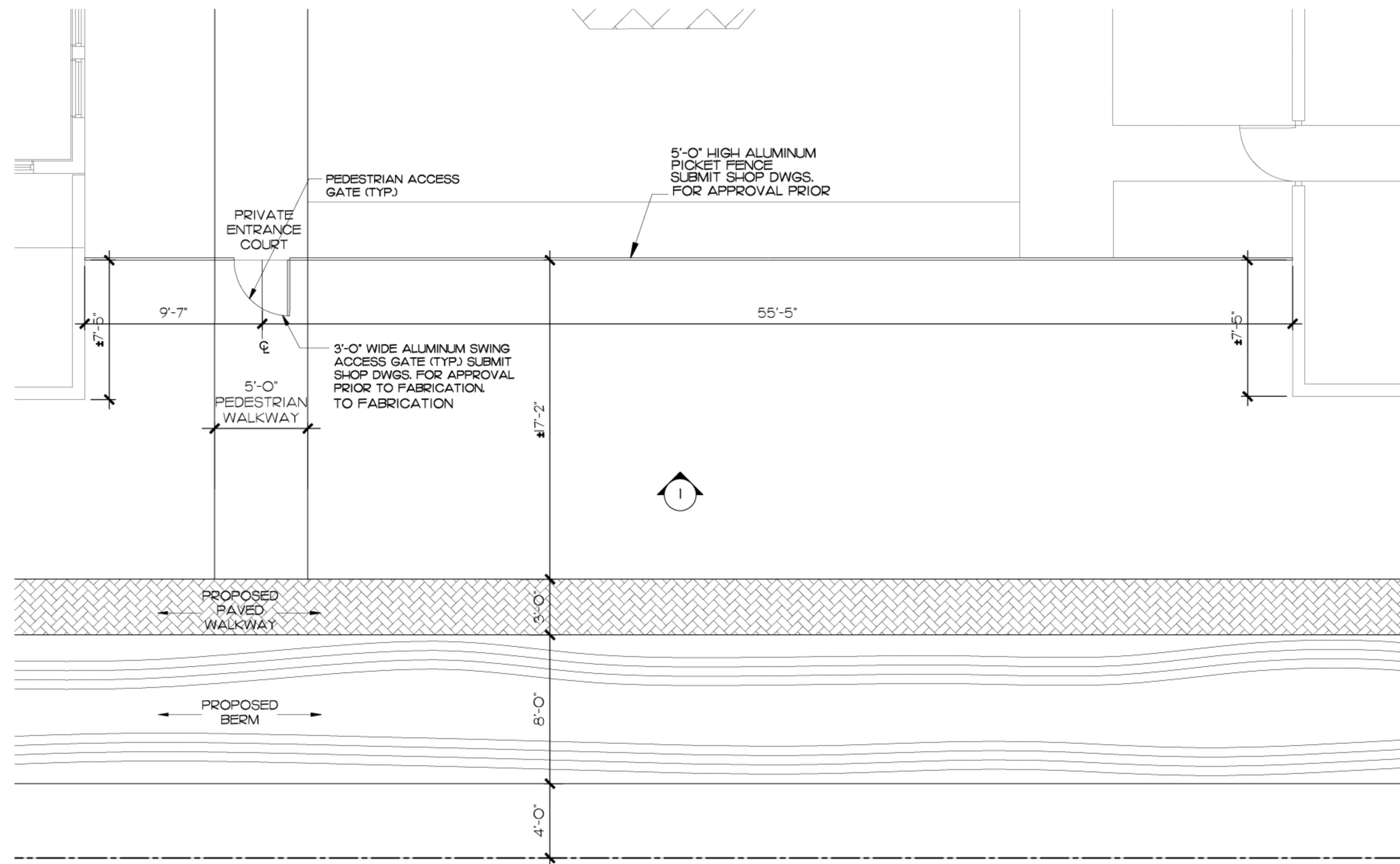

**PARTIAL PRIVACY FENCE PLAN
(TYPICAL PEDESTRIAN ACCESS)**

SCALE: 1/4"=1'-0"

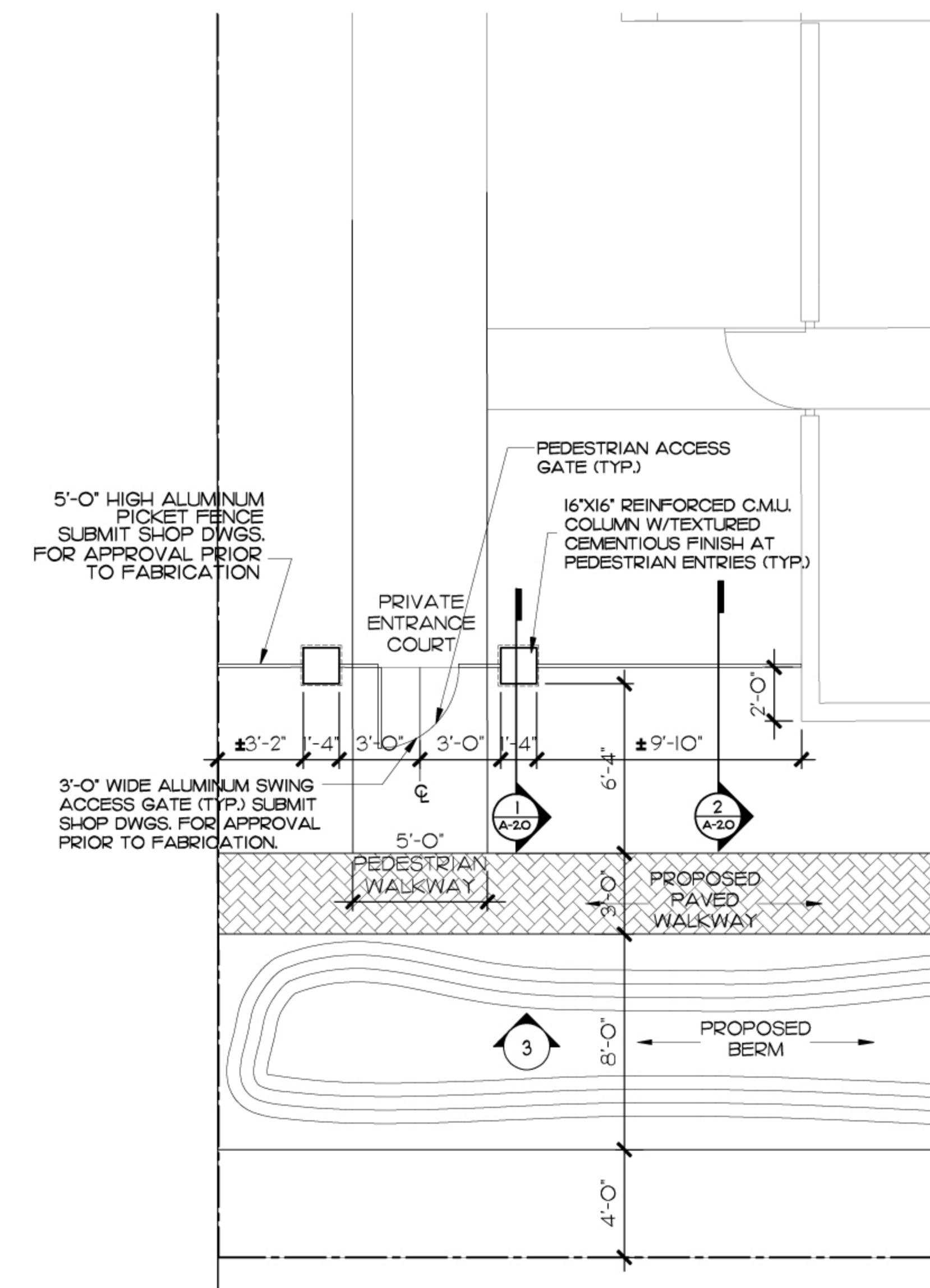
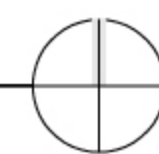

**PARTIAL PRIVACY FENCE PLAN
(TYPICAL PEDESTRIAN ACCESS)**

SCALE: 1/4"=1'-0"

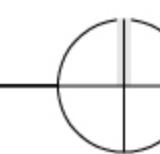

PHASE

REVISIONS

SEAL



THIS DRAWING IS THE PROPERTY OF
CORWIL ARCHITECTS INC. UNLESS
OTHERWISE PROVIDED FOR BY
CONTRACT. THE CONTENTS OF THIS
DRAWING ARE CONFIDENTIAL AND
SHALL NOT BE TRANSMITTED TO ANY
OTHER PARTY EXCEPT AS AGREED
TO BY THE ARCHITECTS/ENGINEERS.

SHEET TITLE

**PRIVACY FENCE
PLANS & SECTIONS**

DATE: 06-24-2009

JOB NO. 2009-13

DRAWN BY FG

APPR BY AMC

FILE 2009-13

SHEET NO.

A-2.00

NOTE: COLORS FOR RAIL FENCE AND
COLUMNS WILL BE CONSISTENT WITH
APPROVED COLORS FOR THE
RESIDENTIAL BUILDINGS.