

STATE ROAD 7 (U.S. 441)

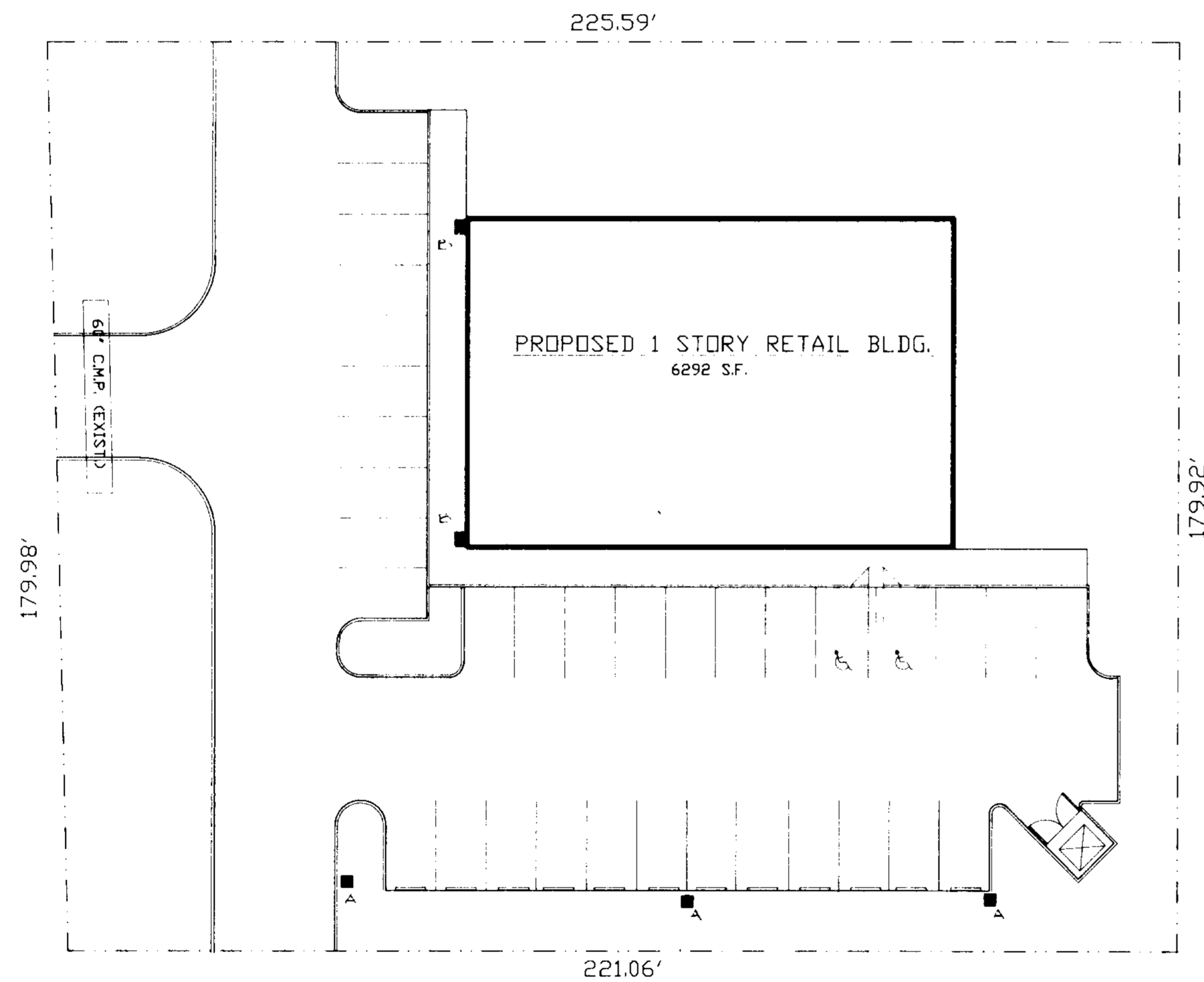

**SITE LIGHTING PLAN**

SCALE: 1" = 20'

- LIGHTING NOTES**
- A 1-1/2" x 2-1/2" x 12" H.P.S. (HOLLOW PIPE) (WALL BRACKETS)
  - B 1-1/2" x 2-1/2" x 12" H.P.S. (HOLLOW PIPE) (WALL BRACKETS)
  - C 1-1/2" x 2-1/2" x 12" H.P.S. (HOLLOW PIPE) (WALL BRACKETS)

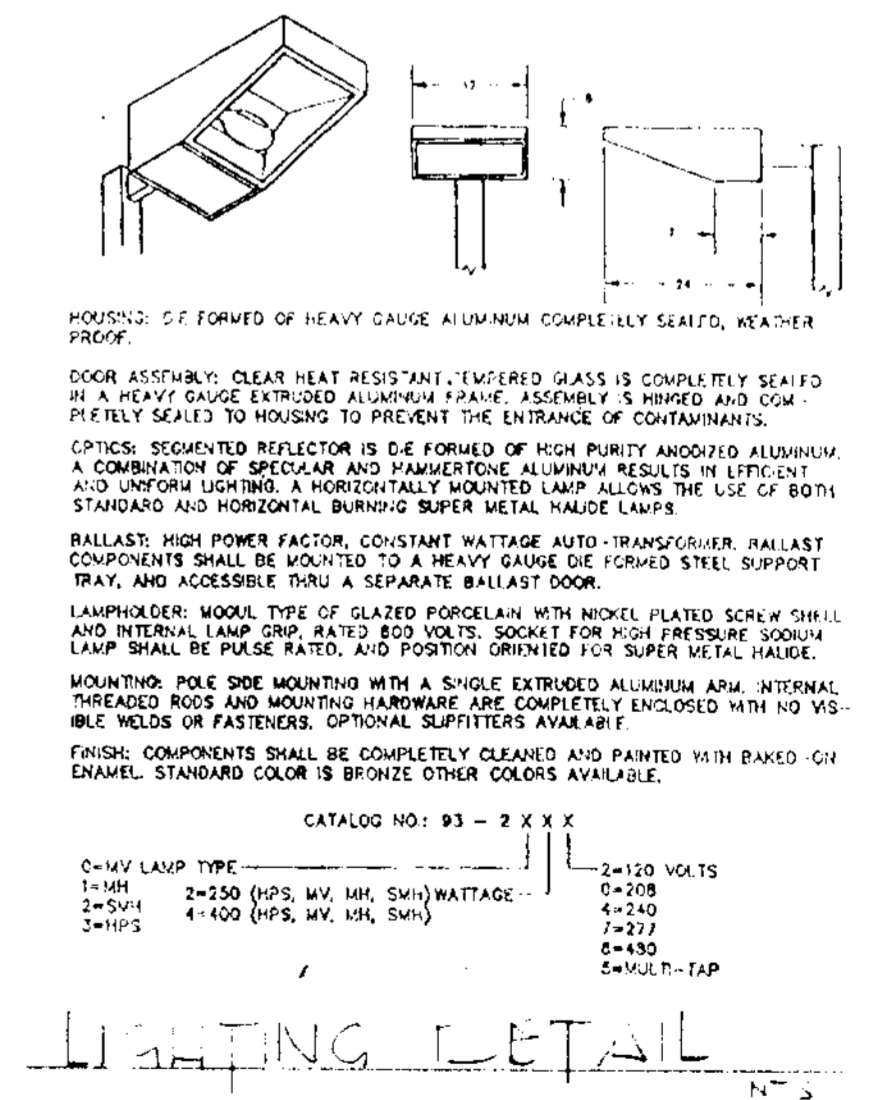
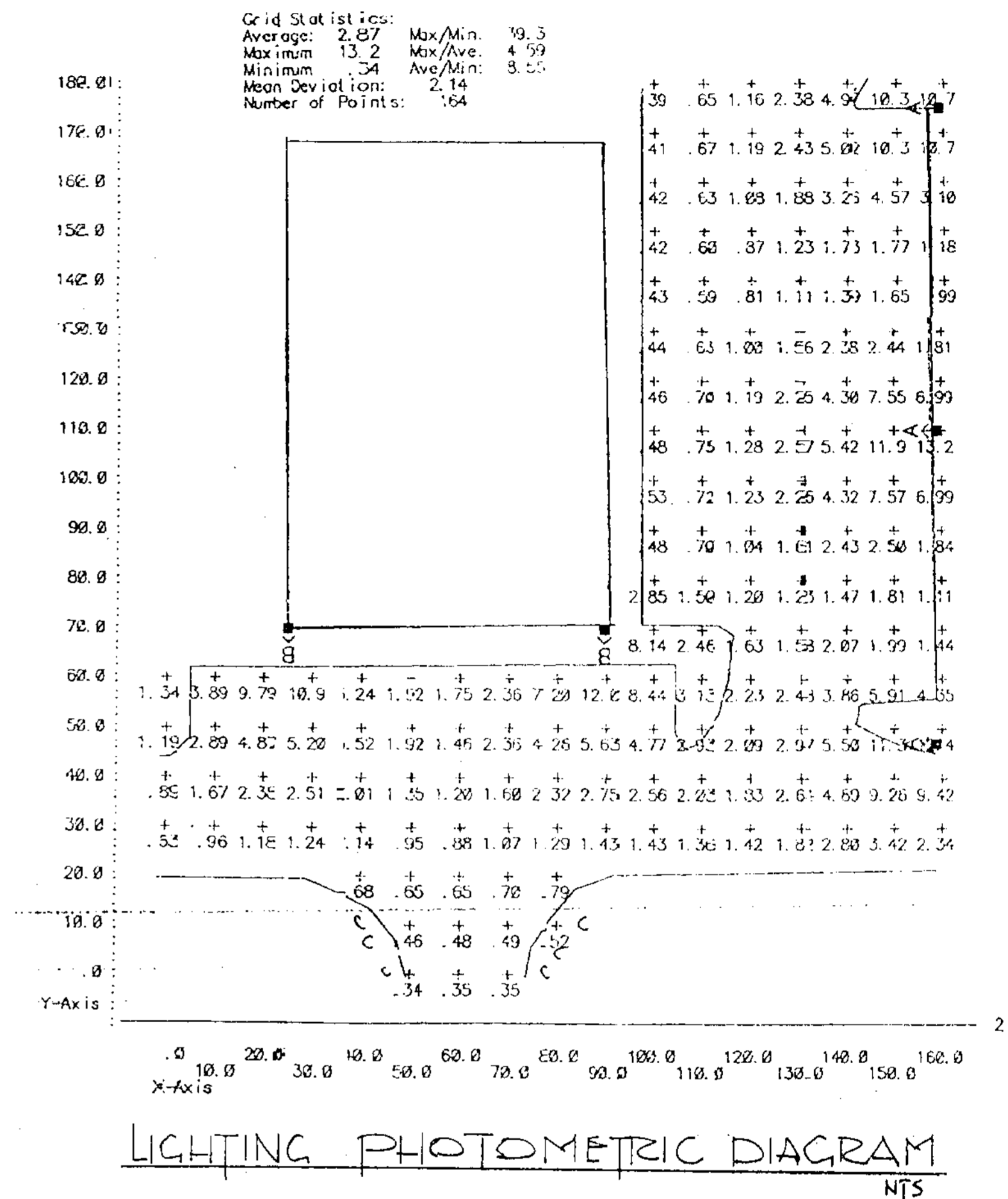
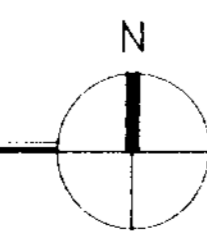

ALL LOCAL REGULATIONS, ORDINANCES, AND PLANS INDICATED ON THIS PLAN ARE THE PROPERTY OF TECHNICAL ASSOCIATES, INC. AND ARE NOT TO BE REPRODUCED OR TRANSMITTED IN ANY FORM OR BY ANY MEANS, ELECTRONIC OR MECHANICAL, INCLUDING PHOTOCOPYING, RECORDING, OR BY ANY INFORMATION STORAGE AND RETRIEVAL SYSTEM, WITHOUT THE WRITTEN PERMISSION OF TECHNICAL ASSOCIATES, INC.

Proposed One Story Retail For

**DISCOUNT AUTO PARTS** FLORIDA

retronics associates architects and planners

6656 northwest 44th street, sunrise, florida 33351 (407) 572-8590

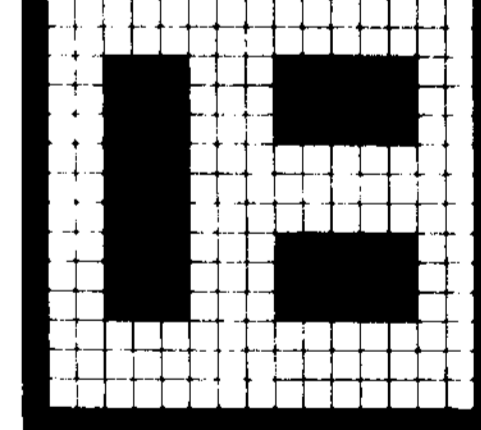

DATE 9-25-89

SCALE A 1/4"

PROJECT NUMBER 89067

SHEET NUMBER E-1

*Joe Davis*  
9.27.89