

**BUILDING PERIMETER REQUIREMENTS:**

- EACH 40 LINEAR FEET OR PORTION THEREOF REQUIRES A MINIMUM OF 1 TREE + 20 SHRUBS AND 30 GROUND COVER PLANTS

**REQUIRED:**

- NORTH SIDE OF BLDG. 70.33 L.F.  
70.33 / 40 LF = 1.76 TREES = 2 TREES  
1.76 X 20 = 36 SHRUBS  
1.76 X 30 = 53 GROUNDCOVERS
- SOUTH SIDE OF BLDG. 70.33 L.F.  
70.33 / 40 LF = 1.76 TREES = 2 TREES  
1.76 X 20 = 36 SHRUBS  
1.76 X 30 = 53 GROUNDCOVERS
- WEST SIDE OF BLDG. 53.33 L.F.  
53.33 / 40 LF = 1.34 TREES = 2 TREES  
1.34 X 20 = 27 SHRUBS  
1.34 X 30 = 41 GROUNDCOVERS
- EAST SIDE OF BLDG. 55.33 L.F.  
55.33 / 40 LF = 1.34 TREES = 2 TREES  
1.34 X 20 = 27 SHRUBS  
1.34 X 30 = 41 GROUNDCOVERS

**OVERALL LANDSCAPE REQUIREMENTS:**

- 122 SHRUBS
- 163 GROUNDCOVERS

**PROPOSED:**

- NORTH = 2 TREES, 35 SHRUBS, 84 GC'S
- SOUTH = 2 TREES, 51 SHRUBS, 78 GC'S
- EAST = 2 TREES, 27 SHRUBS, 41 GC'S
- \* WEST = 2 TREES, 10 SHRUBS, 10 GC'S

\* WEST SIDE REQUIREMENTS WERE MET BY LOCATING THE MAJORITY OF ITS REQUIRED PLANT MATERIAL IN THE NORTH, EAST, AND SOUTH PERIMETER PLANTING BEDS

**OVERALL PROPOSED BLDG. LANDSCAPE MATERIAL:**

- 123 SHRUBS
- 213 GROUNDCOVERS

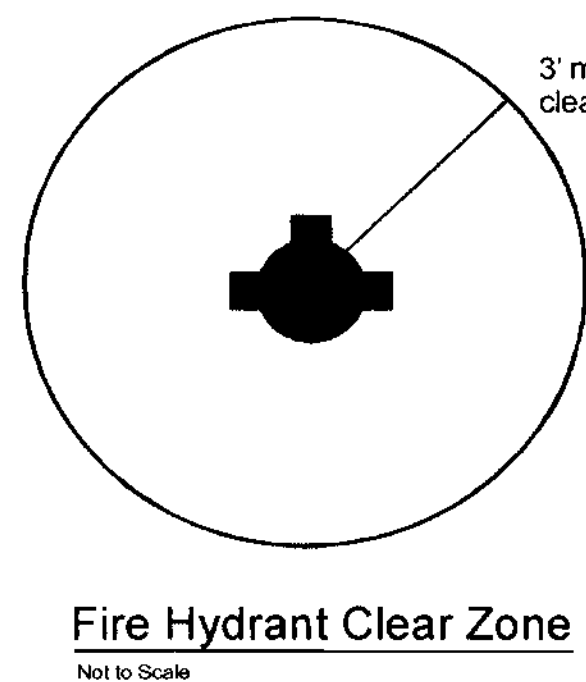
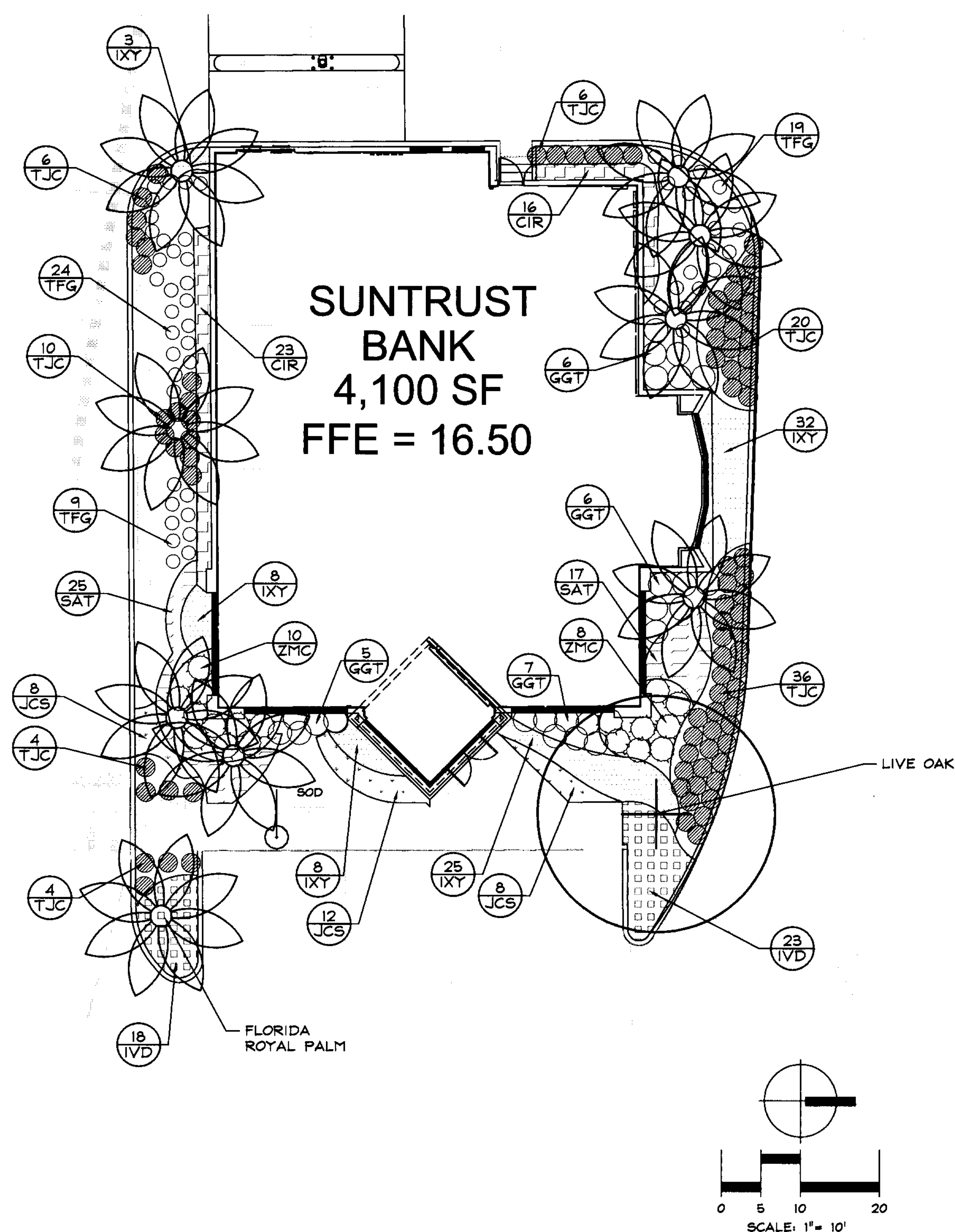

5 CITY OF COCONUT CREEK  
STANDARD LANDSCAPE NOTES

1. All landscape and specifications shall meet or exceed the minimum requirements as provided in the City of Coconut Creek Land Development Code. Plans are incomplete without written notes and specifications.
2. All planting material shall meet or exceed Florida Grade #1 as specified in Grades and Standards for Nursery Plants, current edition. Trees shall not be tipped, topped, or shaped prior to installation.
3. Landscape shall be placed to edge of abutting streets, canals, lakes or other lands.
4. All mechanical equipment, air conditioning, irrigation pump stations and equipment, FPL transformers, pool pumps, etc., must be screened on three (3) sides by landscape shrubs.  
NOTE: The quantity of screening shrubs is in addition to the required number of shrubs as provided in the code and schedule table. All screening shrubs shall be planted for proper operation of equipment being screened and/or per the requirements of the utility as necessary. All hedge material required for screening purposes shall be planted with branches touching. Adjust on-center spacing as necessary and/or provide additional plants to provide an adequate screen.
5. Sight distance concerns must be maintained for clear sight visibility from thirty (30) inches to seventy-two inches. Tree trunks exceeding measurement shall be done from top of root ball planted at proper elevation.
6. Guying/staking practices shall not permit nails, screws, wires, etc., to penetrate outer surfaces of trees, palms or other plant material. Trees, palms and plant material are to be protected from damage by girdling, cutting, or other factor on site.
7. Burlap material, wire cages, plastic/canvas straps, etc., must be cut and removed for the top one-half (1/2) depth of the root ball. Trees and shrubs grown in grow bags or grow bag type material must have such material REMOVED ENTIRELY prior to planting the tree or shrub.
8. All plant material shall be free of pests, insects, disease, weeds, etc.
9. All required landscape material shall be installed using a planting soil mix comprised of material appropriate to the individual proposed planting material and the native soil found on the site.
10. All plant material shall be planted at the proper depth, as originally grown and/or so the top of the root ball is flush or slightly above finished grade immediately after planting. All trees should provide trunk taper when properly planted at the correct planting depth.

11. All plant material shall be watered in at time of planting to eliminate air pockets in the root zone area.
12. Color-treated or dyed mulch will not be accepted.
13. Upon completion of work, the site shall be cleared of all debris, superfluous materials, and equipment caused by this permit to the satisfaction of the inspector.
14. Refer to Coconut Creek Fire Equipment Clear Zone diagram to maintain a safe zone fronting fire hydrants.
15. Do not plant trees, shrubs or groundcover within Electric Meter Clearance Zone. Provide a safe zone as described by the Electrical Inspector.
16. All landscaped areas shall be provided with an underground fully automatic irrigation system using pop-up sprinklers. System shall provide 100% coverage with a 50% overlap (minimum) using mist fine water, except preserved areas remaining in natural state. A rain sensor device switch shall be installed that will override the irrigation system when adequate rainfall has occurred. Water shall not be directed and/or provided onto impervious surfaces and/or be designed or installed to drain water onto any impervious surface such as a sidewalk, etc. Hours of operation for all irrigation systems shall be limited to 500 pm to 800 a.m. only or may be further restricted by South Florida Water Management District or other jurisdictional agency.
17. Irrigation permits and plans shall be submitted for approval at time of building permits.
18. All non-single family or duplex irrigation systems other than City water systems shall require a South Florida Water Management District water use permit prior to issuing an irrigation permit. Irrigation system shall be installed as required.
19. All site amenities to include site street lights, landscape common open space, landscaping, and other amenities, including signs and features, etc. leading up to and including the model center and/or first certificate of occupancy must be completed and functional prior to issuance of the first requested certificate of occupancy.
20. The height of all required, designed and installed berms shall be from the highest adjacent point whether it is the sidewalk, parking area, vehicular access, surrounding ground, etc. Where a berm sits a sidewalk, there shall be a one (1) foot level sand area adjacent to the sidewalk prior to the start of incline for the berm.
21. An inspection is required prior to the backfilling of trees/palis in all residential islands.

PLANT LIST		STMT.	QTY.	BOTANICAL NAME	COMMON NAME	DESCRIPTION	NATIVE	DROUGHT
<b>TREES</b>								
	QV	1		QUERCUS VIRGINIANA	LIVE OAK	46 GAL., 12' X 5-6", 2' DBH., SINGLE STRAIGHT LEADER.	NATIVE	VERY
	RE	1		ROYSTONIA ELATA	FLORIDA ROYAL PALM	B&B FIELD GROWN, 8' GH	NATIVE	MEDIUM
<b>SHRUBS AND GROUNDCOVERS</b>								
○	GGT	24		GALPHIMIA GRACILIS	THYRALLIS	3 GAL., 20-24" OA HT., 18-20" SPR., 2' OC.	NATIVE	VERY
●	TJC	66		TRACHELOSPERMUM JASMINOIDES	CONFEDERATE JASMINE	7 GAL., 8-1' RUNNERS, PLANTED AS SHOWN - TRAIN TO TRELLIS	NATIVE	VERY
○	ZMK	18		ZAMIA MARITIMA	CARDBOARD CYCAD	7 GAL., 20"X30" SP. AS SHOWN	NATIVE	VERY
○	TFG	52		TRIPSACUM FLORIDANA	DWARF FAKAHATCHEE GRASS	3 GAL., 24-30" OA. HT., 24-30" SPR., 3' OC	NATIVE	MEDIUM
○	JCS	57		JUNIPERUS CONFERTA	SHORE JUNIPER	5 GAL., 18 X 18" OA, 2' OC.	NATIVE	VERY
○	CIR	34		CHRYSOBALANUS ICACO	'RED TIP' COCOPLUM	3 GAL., 24" OA HT., 20-24" SPR., 2' OC	NATIVE	MEDIUM
○	SAT	42		SCHIEFFELERA ARBORICOLA 'TRINETTE'	TRICOLOR SCHEFFLERA	5 GAL., 24" OA HT., 20-24" SPR., 2' OC.	NATIVE	VERY
○	IVD	41		ILEX VOMITORIA 'SCHILLINGS DWARF'	DWARF ILEX HOLLY	3 GAL., 20-24" OA HT., 18-20" SPR., 2' OC.	NATIVE	MEDIUM
○	IKY	76		IKORA 'MAUI YELLOW'	YELLOW BLOOMING IKORA	5 GAL., 24" OA. HT., 18-20" SPR., 2' OC.	NATIVE	MEDIUM
BAHIA	BY CONTR.			PASPALUM NOTATUM 'ARGENTINE'	ARGENTINE BAHIA SOD	SOLID SOD, CONTRACTOR TO VERIFY QTY.		
SOD/SB	BY CONTR.			STENOTAPHRUM SECUNDATUM	ST. AUGUSTINE GRASS	SOLID SOD, CONTRACTOR TO VERIFY QTY.		

PLANT DESCRIPTIONS ARE FOR MINIMUM ACCEPTABLE SPECIFICATIONS. ALL CRITERIA LISTED FOR CONTAINER SIZE, CALIPER, HEIGHT, SPREAD, ETC. MUST BE MET FOR PLANT MATERIAL ACCEPTANCE. FOR EXAMPLE, IF A THREE GALLON SHRUB DOES NOT MEET THE HEIGHT OR SPREAD SPECIFICATION, IT WILL NOT BE ACCEPTED.

IF SPECIFIED PLANTS ARE UNAVAILABLE AT TIME OF CONSTRUCTION, CONTRACTOR MAY REPLACE SPECIFIED PLANTS WITH PLANTS APPROVED BY LANDSCAPE ARCHITECT AND CITY STAFF.

ALL OPEN SPACE AREAS WITHIN THE PROPERTY SHALL BE SODDED UNLESS PAVED, SEEDED AND MULCHED OR PLANTED WITH SHRUBS AND GROUND COVER.

ALL LANDSCAPED AREAS WILL BE 100% IRRIGATED WITH A CENTRAL AUTOMATIC IRRIGATION SYSTEM INCLUDING A RAIN SENSOR.