

THE PROMENADE AT COCONUT CREEK

SECTION 18, TOWNSHIP 48 SOUTH, RANGE 42 EAST

4451 LYONS ROAD, CITY OF COCONUT CREEK

BROWARD COUNTY, FLORIDA

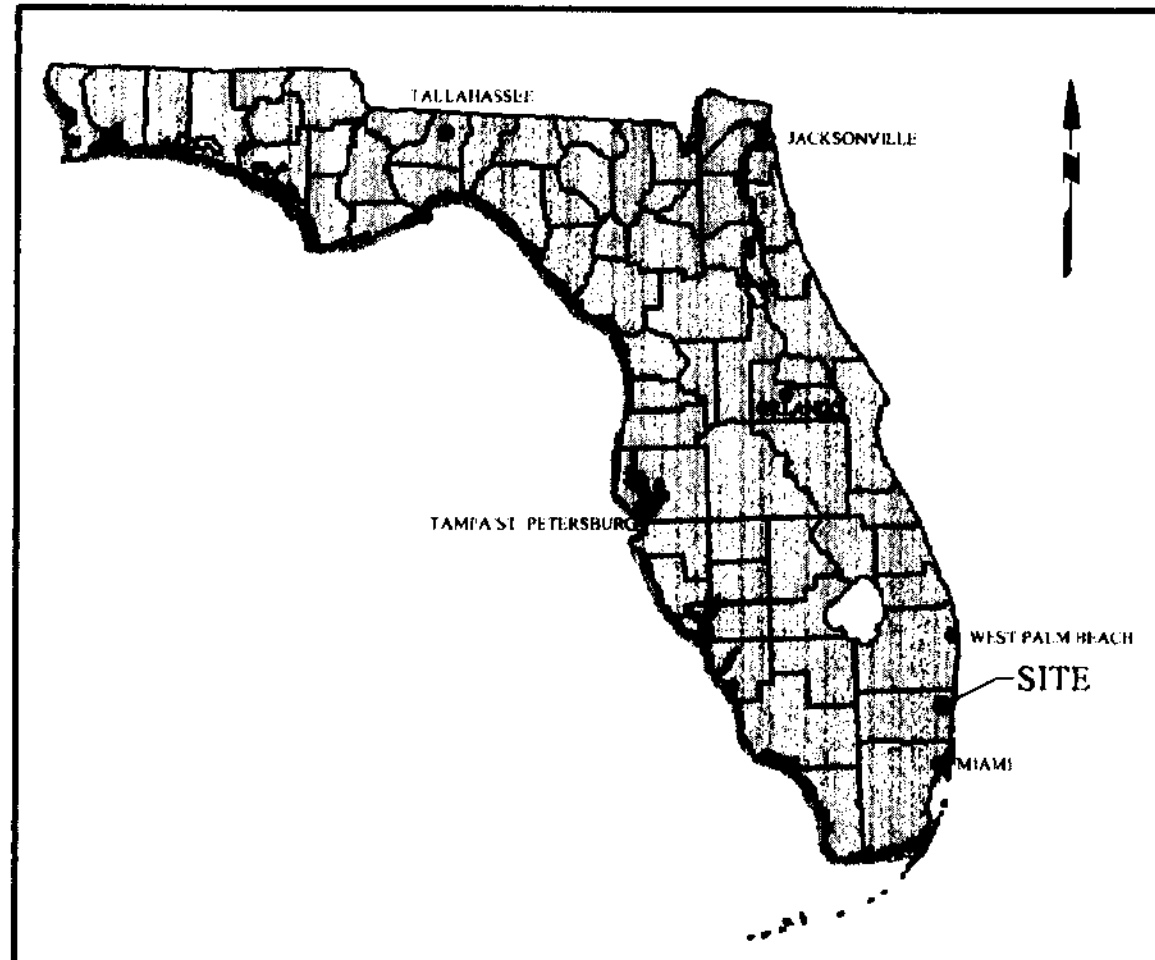

FLORIDA MAP
N.T.S.

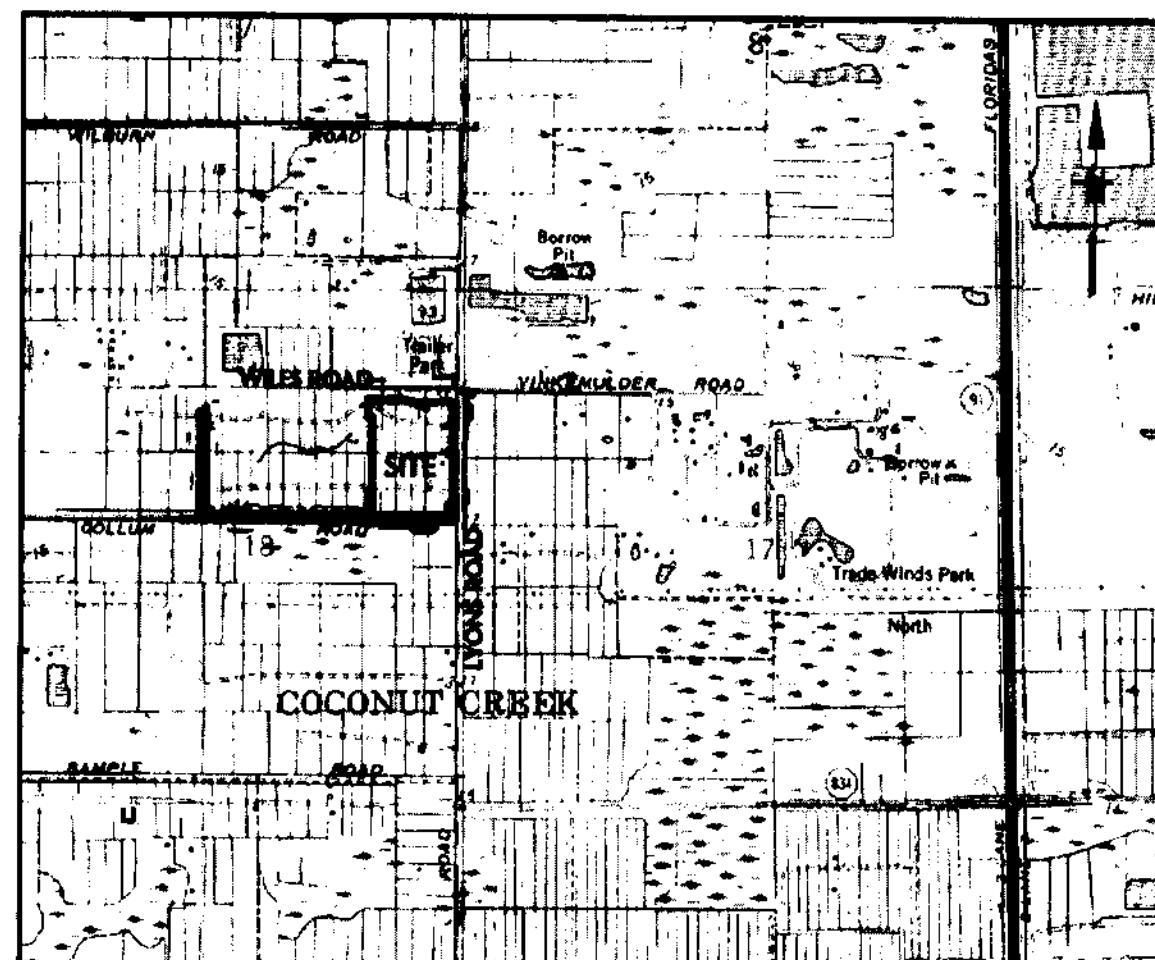

TOPOGRAPHICAL MAP
SCALE 1" = 2000'

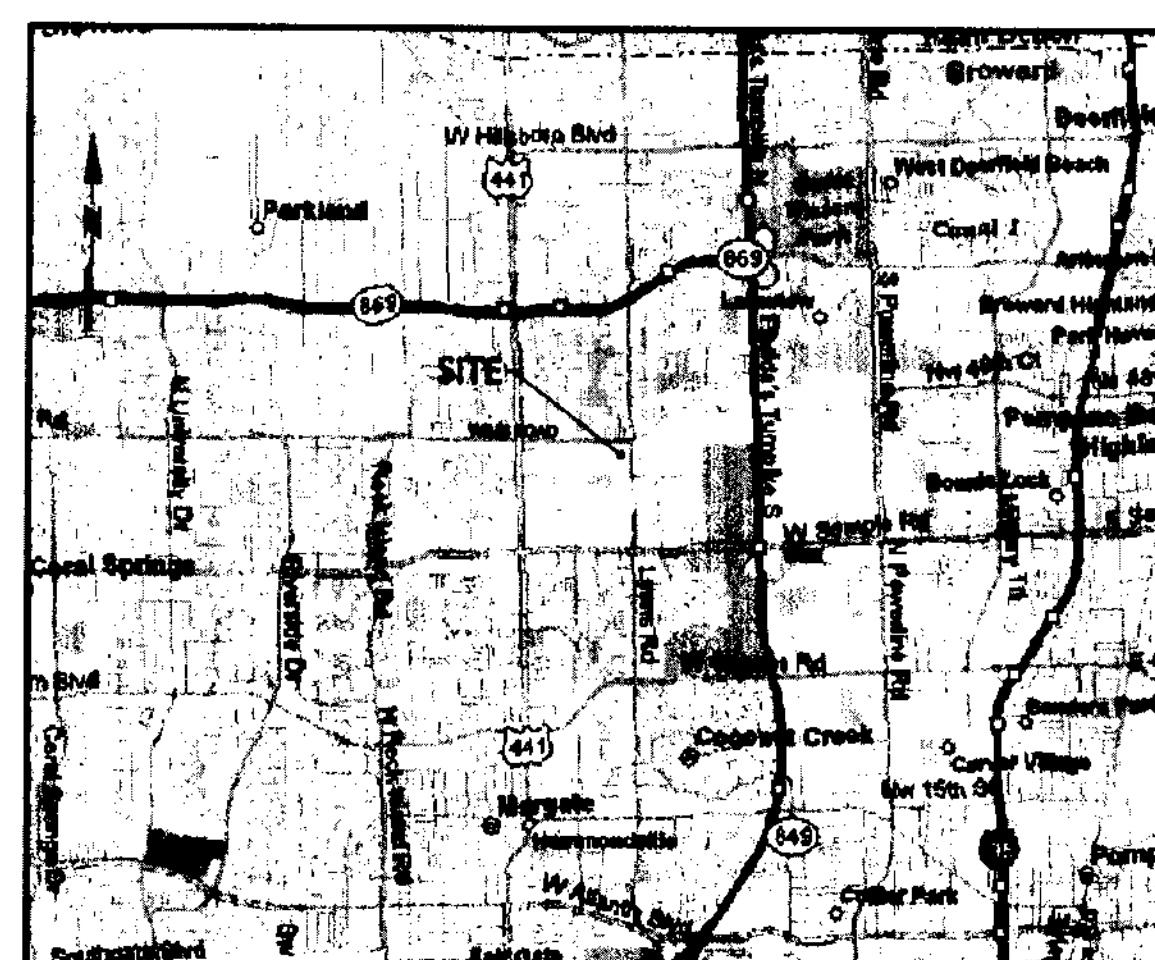

SITE LOCATION MAP
1" = 8,000'



VICINITY MAP - AERIAL
1" = 600'

INDEX OF DRAWINGS				
NUMBER	SHEET	OF	DESCRIPTION	PREPARED BY
C-1	1	OF 5	COVER SHEET	LE
A-110	2	OF 5	ELEVATIONS	DHPY
A-111	3	OF 5	ELEVATIONS	DHPY
A-112	4	OF 5	ELEVATIONS	DHPY
A-115	5	OF 5	ELEVATIONS	DHPY

* = NOT INCLUDED IN SUBMITTAL
AA = ARCHITECTURAL ALLIANCE
DEL = DELTA G
CPH = CPH ENGINEERS
LE = LANGAN ENGINEERING
MARK III = MARK III SIGNS
RRW = ROBERT REID WEDDING ARCHITECTS & PLANNERS AIA INC.
DHPY = DORSKY HODGSON AND PARTNERS

LIST OF CONTACTS

APPLICANT / OWNER
COCONUT CREEK DEVELOPMENT, LLC
c/o STANBURY DEVELOPMENT
250 EAST BROAD STREET, SUITE 2000
COLUMBUS, OH 43215
CONTACT: MARK POTTSCHMIDT
TEL: (614) 437-8100

PLANNER
LEIGH ROBINSON KERR & ASSOCIATES, INC.
808 EAST LAS OLAS BOULEVARD
SUITE 104
FORT LAUDERDALE, FL 33301
TEL: (954) 487-6308
CONTACT: LEIGH KERR

ATTORNEY
RUDEN, MCLOSKEY, SMITH, SCHUSTER & RUSSEL, P.A.
200 E BROWARD BOULEVARD
FORT LAUDERDALE, FL 33301
TEL: (954) 527-2408
CONTACT: DENNIS MELE, ESQ.

PROJECT CIVIL ENGINEER
LANGAN ENGINEERING & ENVIRONMENTAL SERVICES, INC.
PARKSIDE CORPORATE CENTER
15150 NW 79th COURT, SUITE 200
MIAMI LAKES, FL 33016
TEL: (786) 264-7200
CONTACTS: R.S. MURALI
ERIC SCHWARZ, P.E.

PROJECT ARCHITECT
DORSKY HODGSON AND PARTNERS
ONE FINACIAL PLAZA
SUITE 2000
FT. LAUDERDALE, FL 33304
TEL: (954) 524-8886
CONTACTS: VICTOR YUE
VIVIAN SCHAPIS

LEED CONSULTANT
GREENTIME LLC
3208-C EAST COLONIAL DRIVE
SUITE 258
ORLANDO, FL 32803
TEL: (407) 256-9539
CONTACTS: JOANNA C SWITZER, IDA ASIO

PROJECT SURVEYOR
DAVID & GERCHAR, INC.
SURVEYORS AND MAPPERS
10750 WILES ROAD
CORAL SPRINGS, FL 33076
TEL: (954) 340-4025
CONTACT: DEAN GERCHAR

PROJECT LANDSCAPE ARCHITECT
ARCHITECTURAL ALLIANCE
612 SW 4th AVENUE
FT. LAUDERDALE, FL 33315
TEL: (954) 764-8858
CONTACT: HUGH JOHNSON

PROJECT MEP ENGINEER
DELTA G CONSULTING ENGINEERS, INC.
707 NE 3rd AVE.
SUITE 200
FT. LAUDERDALE, FL 33304
CONTACTS: STEPHEN BENDER
GREG PEREZ
IRINA GOLDENBERG
TEL: (954) 527-1112

BROWARD COUNTY
COMMUNITY SERVICE DEPARTMENT
6201 W. COPANS ROAD
PAMPANO BEACH, FL 3089
CONTACT: DAVID DANIELS
TEL: (954) 357-8351

CONTRACTOR
SIKON, CONSTRUCTION CORPORATION
7000 WEST PALMETTO PARK ROAD,
SUITE 203
BOCA RATON, FL 33433
CONTACT: CLIFFORD MICHAEL
TEL: (561) 394-3453

STRUCTURAL ENGINEER
B D M ASSOCIATES, INC.
3998 FAU BOULEVARD,
SUITE 309
BOCA RATON, FL 33431
CONTACT: JOEL MIDDLE BROOKS
TEL: (561) 750-1916

CITY OF COCONUT CREEK
4800 WEST COPANS ROAD
COCONUT CREEK, FL 33063
TEL: (954) 973-4770

PLANNING & ZONING
DIRECTOR OF DEVELOPMENT SERVICES,
SHEILA ROSE, ACP
MANAGER:
SCOTT STOUDEMIRE, ACP
TEL: (954) 973-6756

BUILDING
BUILDING AND PERMITTING MANAGER:
DON GENTILE
STRUCTURAL REVIEWER/INSPECTOR
ED DOMES
TEL: (954) 973-6750

PUBLIC SAFETY/FIRE
STEVE POLLO, FIRE RESCUE ADMINISTRATOR
TEL: (954) 956-1534
KEVIN WILSON, FIRE INSPECTOR
TEL: (954) 956-1514

ALL SERVICE REFUSE COMPANY
TEL: (954) 583-1830
CONTACT: EARL BRADLEY

LANDSCAPE ARCHITECT
CONTACT: PAMELA STANTON
TEL: (954) 764-8756

UTILITIES & ENGINEERING
DIRECTOR:
RAJ VERMA
SENIOR ENGINEER
OSAMA ELSHAMMI
TEL: (954) 973-6786

SUNTRUST / CIVIL ENGINEER AND LANDSCAPE
CPH ENGINEER
7700 N. KENDAL DRIVE
SUITE 305
MIAMI, FL 33156
CONTACT: MARIA ZAPATA
TEL: (305) 274-4805

SUNTRUST / ARCHITECT
RRW ARCHITECTS & PLANNERS AIA INC.
221 COMMERCIAL BLVD.
SUITE 202
LAUDERDALE BY THE SEA, FL 33308
CONTACT: CINDY SHIFFLET
TEL: (954) 492-9080

PROPERTY OWNER:

COCONUT CREEK DEVELOPMENT, LLC
c/o STANBURY DEVELOPMENT
250 EAST BROAD STREET, SUITE 2000
COLUMBUS, OH 43215
CONTACT: MARK POTTSCHMIDT
TELEPHONE: 614-437-8100

PROJECT DESIGN TEAM:

CIVIL ENGINEER:

LANGAN ENGINEERING & ENVIRONMENTAL SERVICES, INC.
15150 NW 79th COURT, SUITE 200
MIAMI LAKES, FL 33016
AUTHORIZED AGENT: R.S. MURALI
PROJECT MANAGER: ERIC SCHWARZ, P.E.
TELEPHONE: 786-264-7200

ARCHITECTURAL:

DORSKY & HODGSON AND PARTNERS
ONE FINACIAL PLAZA
SUITE 2400
FT. LAUDERDALE, FL 33394
TELEPHONE: 954-524-8886

LANDSCAPE ARCHITECT:

ARCHITECTURAL ALLIANCE
612 S.W. FOURTH AVENUE
FORT LAUDERDALE, FL 33315
TELEPHONE: (954) 764-8858

LIGHTING ENGINEER:

DELTA G CONSULTING ENGINEERS, INC.
707 NE 3rd AVE, SUITE 200
FORT LAUDERDALE, FL 33304
TELEPHONE: 954-527-1112

SURVEYOR:

DAVID & GERCHAR, INC.
10750 WILES ROAD
CORAL SPRINGS, FL 33076
TELEPHONE: 954-340-4025

CONTRACTOR NOTES:

- THESE PLANS REPRESENT OVERALL SITEWORK IMPROVEMENTS REQUIRED FOR PROJECT CONSTRUCTION. THE WORK TO BE PERFORMED IS AS SHOWN ON THE DRAWINGS. THE CONTRACTOR IS RESPONSIBLE FOR MEANS AND METHODS OF CONSTRUCTION. AS SUCH, THESE PLANS MAY NOT COMPLETELY REPRESENT ALL SPECIFIC SITE DETAILS OF INSTALLATION REQUIRED FOR SITEWORK CONSTRUCTION. CONTRACTOR IS RESPONSIBLE TO PROVIDE ALL IMPROVEMENTS REQUIRED TO ACHIEVE CONSTRUCTION DEPICTED ON THESE PLANS.
- THE CONTRACTOR SHALL PROVIDE WRITTEN REQUESTS FOR INFORMATION TO THE OWNER AND OWNER'S ENGINEER PRIOR TO THE CONSTRUCTION OF ANY SPECIFIC SITEWORK ITEM IF ANY SITEWORK ITEM DEPICTED ON THE PLANS WARRANTS ADDITIONAL ENGINEERING INFORMATION REQUIRED FOR CONSTRUCTION AND IS NOT RELATED TO MEANS AND METHODS OF CONSTRUCTION. THE CONTRACTOR SHALL BE RESPONSIBLE FOR SITEWORK ITEMS INSTALLED DIFFERENTLY THAN INTENDED AS DEPICTED ON THE PLANS IN THE ABSENCE OF SUBMITTING AND RECEIVING REVIEWS AND/OR DIRECTION ON WRITTEN REQUESTS FOR INFORMATION.
- THE CONTRACTOR SHALL ACCEPT THE SITE AS IS. THE CONTRACTOR SHALL MAKE AND SHALL BE DEEMED TO HAVE MADE A THOROUGH SITE INSPECTION IN ORDER TO FIELD CHECK EXISTING SITE CONDITIONS, CORRELATE CONDITIONS WITH THE DRAWINGS AND RESOLVE ANY POSSIBLE CONSTRUCTION CONFLICTS WITH THE OWNER AND OWNER'S ENGINEER PRIOR TO COMMENCEMENT OF WORK. THIS INCLUDES A TOPOGRAPHIC SURVEY OF ANY AREAS THE CONTRACTOR REQUIRES ADDITIONAL TOPOGRAPHIC INFORMATION. ANY CONDITIONS THAT DIFFER FROM THE EXISTING CONDITIONS SHOWN ON THE DRAWINGS THAT ARE NOT BROUGHT TO THE ATTENTION OF THE OWNER AND OWNER'S ENGINEER PRIOR TO THE START OF WORK SHALL NOT BE CONSIDERED GROUNDS FOR A CHANGE ORDER.
- IT IS SPECIFICALLY NOTED THAT INFORMATION RELATED TO ELEVATIONS AND PROPOSED UTILITIES (SUCH AS ROADWAY GRADES, INVERT ELEVATIONS, RIM ELEVATIONS, GRATE ELEVATIONS, BUILDING FINISHED FLOOR ELEVATIONS, ETC.) MAY BE FOUND IN MORE THAN ONE LOCATION ON THE DRAWINGS. CONTRACTOR SHALL SPECIFICALLY REVIEW ALL PLANS, PROFILES AND ANY INFORMATION / DATA TABLES FOR CONSISTENCY PRIOR TO CONSTRUCTION. ANY INCONSISTENCIES OR DISCREPANCIES THAT ARE FOUND SHALL IMMEDIATELY BE BROUGHT TO THE ATTENTION OF THE OWNER'S ENGINEER IN WRITING REQUESTING CLARIFICATION PRIOR TO CONSTRUCTION.
- CONTRACTOR IS SPECIFICALLY NOTED THAT THERE ARE ADDITIONAL NOTES, SPECIFICATIONS AND REQUIREMENTS CONTAINED ON SHEETS THROUGHOUT THE PLAN SET AND AVAILABLE REFERENCES TO SPECIFICATIONS FROM APPLICABLE GOVERNING AUTHORITIES AND INDUSTRY STANDARDS. IT IS THE CONTRACTOR'S RESPONSIBILITY TO OBTAIN, REVIEW, AND ADHERE TO ALL APPLICABLE REQUIREMENTS.

APPROVED
DATE: 4/10/09 BY: [Signature]
ADMINISTRATIVE APPROVAL



Revisions				Revisions			
03/21/09	REVISED FOR ADMINISTRATIVE APPROVAL BLDG. PG-3	13	03/13/08	REVISED FOR ADMINISTRATIVE APPROVAL SUBMISSION	9	01/04/08	REVISED FOR ADMINISTRATIVE APPROVAL COMMENTS DATED DECEMBER 11, 2007
09/15/08	REVISED FOR ADMINISTRATIVE APPROVAL COMMENTS DATED AUGUST 28, 2008	12	12/05/07	REVISED FOR ADMINISTRATIVE APPROVAL - BLDG L-BANK BLDG G, PG-3	7	11/20/07	REVISED FOR ADMINISTRATIVE APPROVAL - BLDG L-BANK
08/14/08	REVISED FOR ADMINISTRATIVE APPROVAL SUBMISSION	11	08/15/07	REVISED PER DDC REVIEW COMMENTS DATED 18 JULY 2007	5	06/25/07	REVISED FOR ADMINISTRATIVE APPROVAL - MODIFICATION OF SITE PLAN
04/14/08	REVISED PER ADMINISTRATIVE APPROVAL COMMENTS DATED APRIL 1, 2008	10	01/25/07	REVISED FOR FINAL SITE PLAN APPROVAL	3	07/07/08	REVISED BASED ON CITY REVIEW DATED MAY 17, 2008
04/14/08	REVISED PER ADMINISTRATIVE APPROVAL COMMENTS DATED APRIL 1, 2008	1	04/26/06	REVISED BASED ON CITY REVIEW DATED APRIL 13, 2008	1		
Date	Description	No.	Date	Description	No.		
Revisions				Revisions			

ERIC B. SCHWARZ, P.E. PROFESSIONAL ENGINEER FL LIC. No. 62196	
--	--

Project THE PROMENADE AT COCONUT CREEK CITY OF COCONUT CREEK BROWARD COUNTY FLORIDA	
---	--

Drawing Title COVER SHEET	
-------------------------------------	--

Project No. 6110501	Drawing No. C-1
Date MARCH 27, 2006	
Scale AS SHOWN	
Drn. By PK	
Chkd. By EBS	

LANGAN
ENGINEERING & ENVIRONMENTAL SERVICES

Parkside Corporate Center
15150 NW 79th Court, Suite 200
Miami Lakes, FL 33016
P: 786.264.7200 F: 786.264.7201
www.langan.com

NEW JERSEY PENNSYLVANIA NEW YORK CONNECTICUT FLORIDA NEVADA
FL Certificate of Authorization No. 00006601