

PROPOSED RETAIL BUILDINGS : WESTCREEK COMMONS



CONSULTANTS:

SURVEY

Professional Surveyors + Mappers
7914 Wiles Road
Coral Springs, Florida 33067
(954) 344-7994 Fax (954) 344-2636

ARCHITECT

ARCHITECTURE 6400
300 S.E. 2ND STREET
FT. LAUDERDALE, FLORIDA 33301
(954) 627-9180

STRUCTURAL ENGINEERS

BURTON BRASWELL AND
MIDDLEBROOKS
1912 BOOTHE CIRCLE
SUITE 100
LONGWOOD, FLORIDA 32750
(407) 645-3423

MECHANICAL/ELECTRICAL/PLUMBING ENGINEERS

R.A. KAMM AND ASSOCIATES
947 CLINT MOORE ROAD
BOCA RATON, FLORIDA 33487
(561) 995-8636

CIVIL ENGINEERS

SUN-TECH ENGINEERING, INC.
3407 N.W. 9th AVENUE
SUITE 350
FT. LAUDERDALE, FLORIDA 33309
(954) 777-3123

LANDSCAPE ARCHITECT

ECOPLAN
1515 SE 4TH AVENUE,
FT. LAUDERDALE, FLORIDA 33316
(954) 524-3722

LAND DESCRIPTION

All of "PARCEL A", OF "ADAM'S REALTY COMPANY PLAT",
according to the plat thereof as recorded in Plat Book 106, Page
23, of the Public Records of Broward County, Florida.

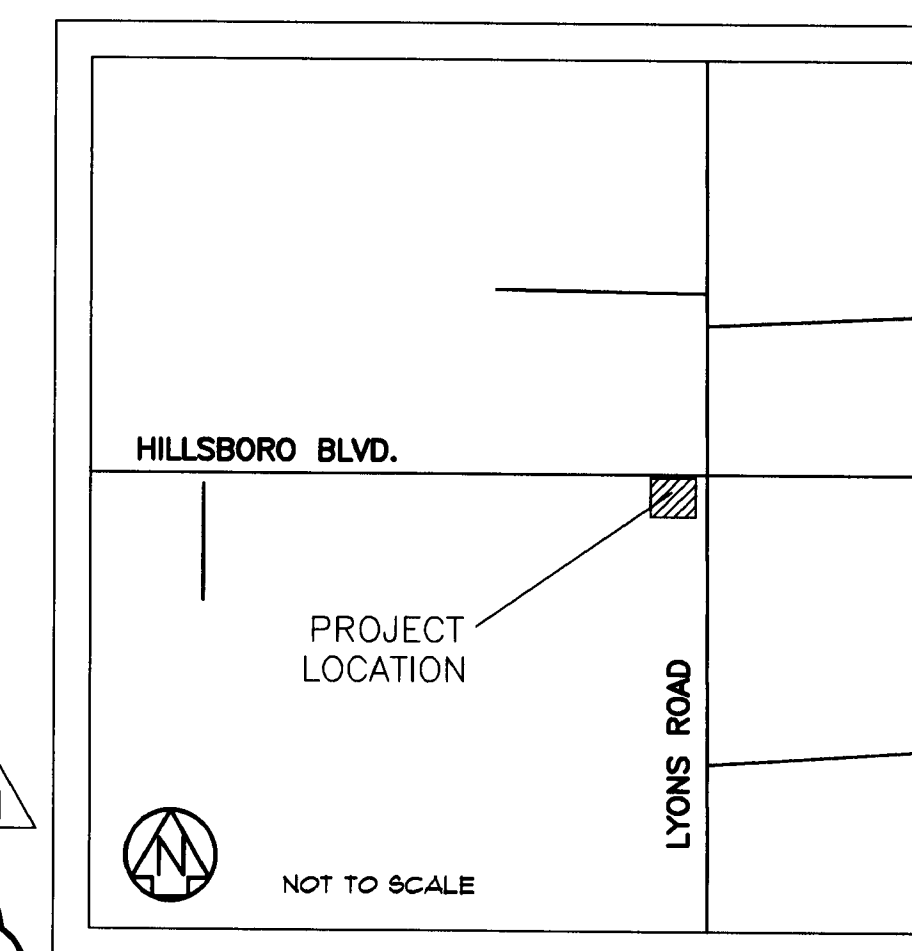

LOCATION MAP

INDEX OF DRAWINGS

SITE PLANS

- A-10 ARCHITECTURE COVER SHEET
- A-11 MASTER SITE PLAN
- A-12 1/2" GEOMETRIC SITE PLAN (BUILDING 'C')
- A-13 1/2" GEOMETRIC SITE PLAN (BUILDING 'A' & 'B')
- A-14 SITE DETAILS
- A-15 SITE SIGNAGE DETAILS

SURVEY

PLAT

ARCHITECTURALS

- A-21 BUILDING 'B' (LOCAL RETAIL) FLOOR PLAN
- A-22 BUILDING 'A' (PUBLIX) FLOOR PLAN
- A-23 BUILDING 'C' (ECKERD'S) FLOOR PLAN
- A-61 BUILDING 'B' (LOCAL RETAIL) EXTERIOR ELEVATIONS
- A-62 BUILDING 'A' (PUBLIX) EXTERIOR ELEVATIONS
- A-63 BUILDING 'C' (ECKERD'S) EXTERIOR ELEVATIONS

TREE SURVEY

LANDSCAPE

- LA-1 TREE RELOCATION PLAN
- LA-2 TREE PLANTING PLAN
- LA-3 PLANT LIST AND NOTES
- LA-4 PLANT DETAILS AND NOTES

ELECTRICAL

- E11 SITE LIGHTING PHOTOMETRICS

CIVIL

- 1 COVER SHEET
- GN-1 GENERAL NOTES
- PD-1 PAVING, GRADING AND DRAINAGE PLAN
- PD-2 OFF-SITE PAVING AND DRAINAGE
- PD-3 PAVING AND DRAINAGE DETAILS
- PM-1 PAVEMENT MARKING PLAN
- US-1 WATER AND SEWER PLAN
- US-2 OFF-SITE SEWER CONNECTION
- US-3 WATER AND SEWER DETAILS
- US-4 WATER DETAILS
- US-5 SEWER DETAILS
- US-6 SEWER DETAILS
- SP-1 WATER AND SEWER PLAN
- OS-1 OFF-SITE TURN LANE - HILLSBORO BLVD.
- OS-2 OFF-SITE TURN LANE - LYONS ROAD.

COCONUT CREEK, FLORIDA

AUGUST 28, 2001

REV. OCTOBER 12, 2001: CITY COMMENTS

REV. NOVEMBER 5, 2001: CITY COMMENTS

ARCHITECTURE 6400, INC.

Approved
DATE 8/28/01 BY [Signature]
PLANNING & ZONING

A-10
DRC

STILES CORPORATION
6400 NORTH ANDREWS AVENUE
FORT LAUDERDALE, FLORIDA
954 - 776 - 9300 33309