

NOTES:
 1. ALL SANITARY SEWER SHALL BE 8" P.V.C.(UNLESS NOTED OTHERWISE)
 2. WHEN DEPTH IS GREATER THAN 14' USE PVC SDR26.

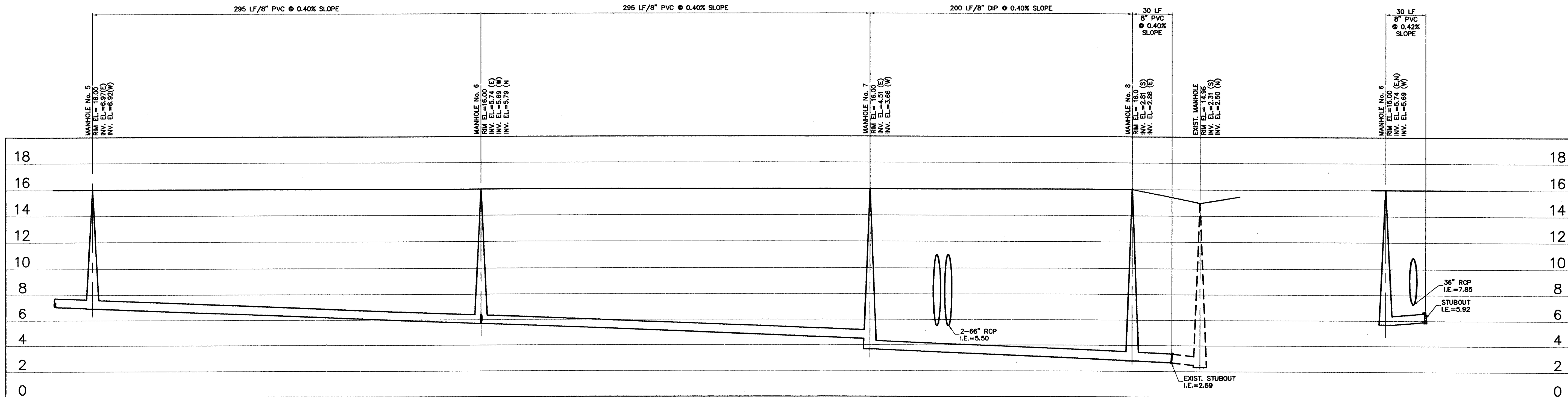

K:\PROJECTS\01-2486\DWG\486spn.dwg, SEWER PROFILES SHEET 1, 01/24/2002 02:31:06 PM, 1:1, Sun-Tech Engineering, Inc. (LAC)

FILE: K:\PROJECTS\01-2486\DWG\486spn.dwg
 DATE: Jun 24, 2002 - 2:31pm EST

APR 0 8 2002

TECH
Sun-Tech Engineering, Inc.
 Engineers - Planners - Surveyors
 1600 West Oakland Park Boulevard
 Ft. Lauderdale, FL 33311
 E-Mail: suntech@suntechengineering.com
 Phone (954)777-3123
 Fax (954)777-3114

REVISIONS	
NO.	DATE
1	01-15-02
	PER CITY REVIEW

WEST CREEK COMMONS
 COCONUT CREEK
 FLORIDA
WATER AND SEWER PLAN

DATE:
 NOV. 2001

SCALE:
 1" = 40' HORZ.
 1" = 4' VERT.

DESIGNED BY:
 W.M.F.

DRAWN BY:
 J.W.

JOB NUMBER
 01-2486

SHEET No.
 SP 1

SEAL
 APR 0 8 2002
 (Professional Engineer Seal)