

MATCHLINE SEE SHEET LP-2

BUILDING NUMBER  
LOT NUMBER  
UNIT TYPE

**LANDSCAPE REQUIREMENTS**

CODE SECTION	REQUIREMENT
13-443.2	MINIMUM LANDSCAPE REQ'T. / PUD 1 tree and 6 shrubs per 2000 s.f. of open space 147,755 s.f./2000 = 74 trees req., 443 shrubs req.
13-443.7(a)	CORNER LOT 1 tree and 4 shrubs per corner lot 10 lots = 10 trees and 40 shrubs
13-443.7(d)	FRONT AND SIDE BLDG. LANDSCAPE 1 tree and 10 shrubs (or 30 g'cover) per 40 l.f. 4185 l.f./40 = 104 trees req., 1040 shrubs (or 3120 g'cover) req.
13-443.8	PERIMETER LANDSCAPE 1 tree per 40 l.f., continuous hedge 2222 l.f. / 40 = 55 trees and 1111 shrubs
13-443.12(a)	INTERIOR LANDSCAPE/VEHICULAR USE AREA 1 tree per 10 spaces 30 spaces/10 = 3 trees req.
13-443.13	STREET TREES 1 tree per 40 l.f. 5823 l.f. / 40 = 146 trees
ROADWAY LANDSCAPE BUFFER STANDARDS	
13-443.15(c)2	OPEN SPACE TREES 1 tree / 2000 s.f. buffer 23,300 s.f. / 2000 = 12 trees required
13-443.15(c)4	HEDGE 1 / 2 l.f. buffer 932 l.f. / 2 = 466 shrubs required
13-443.15(c)2	OPEN SPACE SHRUBS 40 shrubs / 2000 s.f. buffer 23,300 s.f. / 2000 (40) = 466 shrubs required

**LANDSCAPE TOTALS**

	required	provided
Trees (does not include palms)	404	689
Shade/Canopy trees (40% min.)	162	248
Intermediate trees (30% min.)	121	481
Small trees (10% max.)	41	83
Native Trees (40% min.)	162	353(52%)
Palms*(50% max.)	202	116
*Cabbage palms & Washington palms counted as 3:1		
Shrubs	3566	9225
Native Shrubs (40% min.)	1426	4469(48%)

**PLANT KEY FOR SHEETS LP-1, LP-2 & LP-3**

Quan.	Symbol	Botanic Name / Common Name / Specification	Degree of Drought Tolerance
235 Total	BH	BUTTERFLY HABITAT The butterfly habitat shown on sht. LP-2 shall be planted with an equal mix of the following plants in a random, "naturalistic" manner: 70-Pentas Lacedalea - Red 70-Asclepias Tuberosa - Orange Milkweed 70-Stachytarpheta Jamaicensis - Portulacastrum 70-Asclepias Curassavicus - Bloodflower Milkweed Ea. plant shall be 6-12" ht., full, 24" o.c., max.	
40	BS*	Bursera Simarouba / Gumbo Limbo 12' ht. x 6.5" spr., 4" d.b.h., 5' c.t.	VERY
12	CB	Cordia Boissieri / White Gaiher 10' ht. x 4.5" spr., 3" cal., 5' c.t.	VERY
38	CD*	Coccoloba Diversifolia / Pigeon Plum 12' ht. x 5" spr., 2.5" d.b.h., 5' c.t.	VERY
42	CE*	Coccoloba Erectus / Green Buttonwood 12' ht. x 5" spr., 2.5" d.b.h., 5' c.t.	VERY
1532	Q*	Chrysothamnus leucos "Red Tip" / Coccoloba 20' ht. x 12" spr., 24" o.c. Adjust quantity to plant with branches touching.	VERY
21	CN	Coccotheca "Maypop" / Maypop Coconut Palm 4-8' c.t., staggard heights in each group	VERY
53	CR	Cordia Rosea - Pitch Apple 10' ht. x 4.5" spr., 3" cal., 5' c.t.	VERY
8	CT	Chamaedorea Cataractarum / Cat Palm 4" ht., full	
377	CU*	Coccoloba Uvifera / Seagrape 30' ht. x 18-24" spr., 24" o.c. Adjust quantity to plant with branches touching.	VERY
11	CU1*	Coccoloba Uvifera / Seagrape 10' ht. x 6" spr., 15" c.t., tree form	VERY
13	DR	Dioscorea Regia / Royal Poinciana 12' ht. x 7" spr., 3-1/2" d.b.h.	VERY
911	ES	Euphorbia MBII "Short & Sweet" / Dwarf Crown of Thorns 12' ht., full, 15" o.c.	VERY
132	HA	Hamelia Patens "Compacta" / Dwarf Firebush 24" ht. x 15" spr., 24" o.c.	VERY
210	HC*	Hymenocallis Latifolia / Spider Lily 18" ht., full, 24" o.c.	VERY
1075	HD	Hibiscus Rosa-sinensis "Dwarf" / Dwarf Hibiscus 6" ht., full 15" o.c., color to be select. by owner	MOD.

**PLANT KEY cont.**

132	HP*	Hamelia Patens / Firebush 30" ht. x 15" spr.	VERY
57	HR	Hibiscus Rosa-sinensis / Pink Hibiscus 24" ht. x 18" spr., 24" o.c.	MOD.
12	HS	Hibiscus Rosa-sinensis / Pink Hibiscus "Standard" 5' ht. x 3" spr., standard	MOD.
370	IV*	Ilex Vomitoria "Shellings Dwarf" / Dwarf Yaupon Holly 10-12" ht. x 18" spr., 15" o.c.	VERY
10	JH	Jatropha Hastata / Jatropha 5' ht. x 4" spr., full	VERY
83	LJ	Ligustrum Japonicum / Japanese Privet 10' ht. x 6" spr., 5" c.t., multi-stem tree form	VERY
26	LL*	Lysichiton Latifolia / Lysichiton 12' ht. x 6.5" spr., 4" d.b.h., 5' c.t.	
550	LM	Liriodendron "Evergreen Giant" / Lilyturf 12" o.a., full, 15" o.c.	VERY
1121	MC*	Muhlenbergia Capillaris / Muhly Grass 12-18" o.a., full, 24" o.c.	VERY
38	MF-1*	Myrciophora Fragrans / Simpson Stopper 5' ht. x 3" spr., full	VERY
450	NM*	Naprolepis Cordata / Sword Fern 12" ht. x 12" spr., 24" o.c.	
4	PA*	Passiflora Incarnata / Passionflower, Maypop 36" ht., train on trellis	MOD.
3	PE	Ptychosperma Elegans / Solitaire Palm 10-12" ht., triple trunk or as noted on the plan	VERY
10	PU	Plumeria Obusta / Plumeria "Singapore" 8-10' ht., x 4-6' spr.	
86	QV*	Quercus Virginiana "Highrise" / "Highrise" Live Oak 12' ht. x 6.5" spr., 4" d.b.h., 5' c.t.	VERY
21	RE*	Royatea Elata / Royal Palm g.w. ht. as noted on plan	VERY
917	SA	Schefflera Arboricola "Trinette" / Dwarf Schefflera 18" ht. x 12" spr., 24" o.c.	
45	SM*	Sweetenia Mahagonii / West Indies Mahogany 12' ht. x 6.5" spr., 4" d.b.h., 5' c.t.	VERY

**PLANT KEY cont.**

Quan.	Symbol	Botanic Name / Common Name / Specification	Degree of Drought Tolerance
57	SP*	Sabal Palmetto / Cabbage Palm without boots, curved trunks in grouping per detail sht. LP-6	VERY
108	SP1*	Sabal Palmetto / Cabbage Palm stagger hts. in group 10-18" c.t., WITH BOOTS	VERY
15	TR*	Thrinax Rodata / Florida Thatch Palm 4-5' ht., doubles	VERY
15	VE	BUTTERFLY HABITAT (VINES) The butterfly habitat shown on sht. LP-2 notes 15 vines each trained to a post as detailed on sht. LP-5. The species and quantities shall be as follows: 8-Aristolochia Spp. - Dutchman's Pipe 7-Pasiflora Incarnata - May Pop ea. 36" ht., train on trellis	
539	VS	Viburnum Suspensum / Sandankwa Viburnum 20" ht. x 12" spr., 24" o.c. Adjust quantity to plant with branches touching.	MOD.
15	WR	Washingtonia Robusta / Washington Palm c.t. ht. as noted on plan	VERY
44	ZP*	Zamia Floridana / Coontie 12" o.a., full	VERY

Drought tolerance is per "FVMD Xeriscap Plant Guide"  
PLAN QUANTITIES TAKE PRECEDENCE OVER THOSE NOTED ABOVE  
\* = Native to Florida

Abbreviations:  
c.t. - clear trunk  
d.b.h. - diameter at breast height  
g.w. - greywood  
ht. - height  
o.c. - overall  
spr. - on-center spacing  
agr. - spread

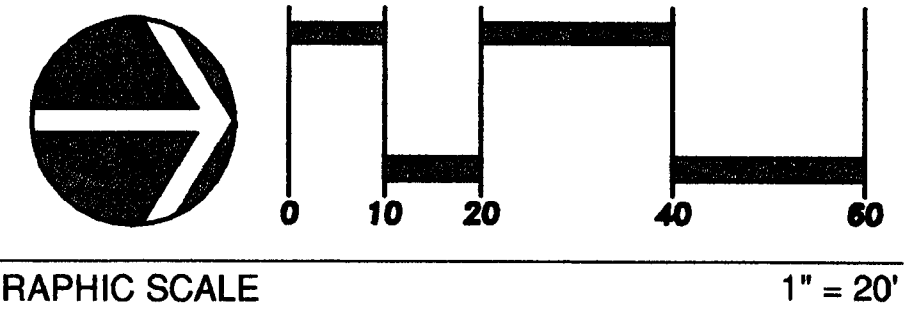

**PALM RELOCATION NOTES**

THERE ARE APPROXIMATELY 156 EXISTING CABBAGE PALMS ON SITE THAT SHALL BE RELOCATED TO A TEMPORARY HOLDING AREA AS DETAILED ON SHT. LP-5.  
These existing cabbage palms shall be substituted for these new palms first.  
An inventory of the relocated palms shall be conducted by the contractor and landscape architect once relocation to the holding area is complete to determine the ultimate location of these palms in the groupings shown on the plan.  
Each palm's c.t. height noted on the plans will be modified as necessary to utilize the existing palms to create a staggered, natural appearance in each grouping.  
Those palm groups on Hillsboro Blvd. detailed on sht. LP-6 shall be planted to the extent allowed by utilizing the existing palms on site first.  
SEE SHEET LP-6 FOR ADDITIONAL NOTES AND DETAILS CONCERNING CABBAGE PALM RELOCATION.

**LANDSCAPE SHEET KEY**

BUILDINGS 1, 2, 3, 4, 5, & 16	SHEET LP-4
BUILDINGS 6, 7, 8, 9, 10, 11, 12, 13, 14, 15, 17, 18, 19, & 20	SHEET LP-5
	SHEET LP-6

**NOTES AND DETAILS**

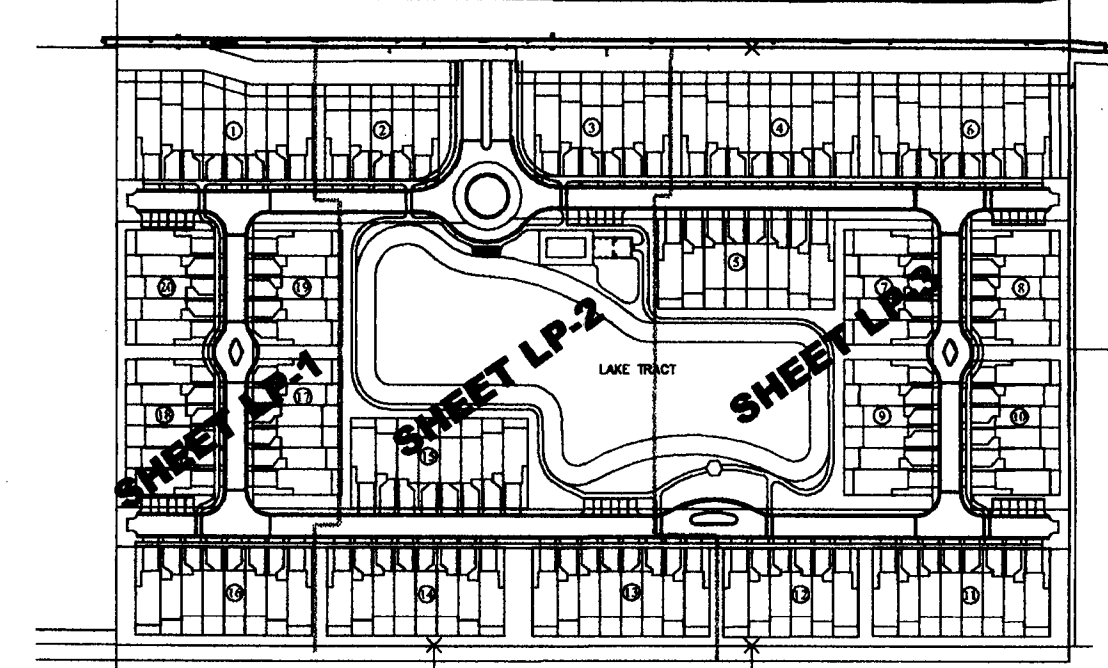

PER TURN LANE MODIFICATION	DATE	BY
CABBAGE PALM REL. NOTES AND DETAILS	08/19/05	CAH
PER 04/14/05 DRC REVIEW	08/01/05	TRM
PER 03/10/05 DRC REVIEW	05/04/05	SET
REVISIONS	DATE	BY
FILE NAME: 4633.LAND		

**CAULFIELD & WHEELER, INC.**  
CIVIL ENGINEERING - LAND PLANNING  
LANDSCAPE ARCHITECTURE - SURVEYING  
7301A W. PALMETTO PARK ROAD - SUITE 100A  
BOCA RATON, FLORIDA 33433  
PHONE (561)-392-1991 / FAX (561)-750-1452

**Landscape Plan**  
**SIMONTON COURT**  
Coconut Creek  
Florida

DATE 02/21/05  
DRAWN BY SET  
F.B. / PG. N/A  
SCALE as noted  
SUBMITTED FOR REVIEW  
STEVEN E. TATE  
LANDSCAPE ARCHITECT  
No. 957  
STATE OF FLORIDA  
FOR THE B.R.N.  
DATE SEP 09 2005  
JOB # 4633  
SHT. NO. LP-1  
OF 6 SHEETS