

BUILDINGS 1 & 2
LOT LANDSCAPE PLAN
 SEE SHEET LP-1 FOR PLANT KEY

PLANT KEY FOR SHEETS LP-4 & LP-5

Quan.	Symbol	Botanic Name / Common Name Specification	Degree of Drought Tolerance
870	AD	Asparagus densiflorus 'Myers' / Foxtail Asparagus 12" o.d., full, 18" o.c.	VERY
27	CB	Cordia Boissieri / White Gelger 10" ht. x 4.5" spr., 3" col., 5' c.t.	VERY
20	CC*	Capparis cynophallophora / Jamaican Caper 36" ht. x 18" spr., FULL	VERY
60	CD*	Coccoloba diversifolia / Pigeon Plum 10" ht. x 4.5" spr., 3" col., 5' c.t.	VERY
57	CES*	Coccosarpus Erectus 'Sericeus' / Silver Buttonwood 10' ht. x 5' spr., multi-trunk tree form, 5' c.t.	VERY
626	CI*	Chrysalidanthus loaco 'Red Tip' / Cocoplum 18" ht. x 12" spr., 24" o.c.	VERY
156	CV	Codiaeum Variegatum 'Gold Dust' / Gold Dust Croton 24" ht. x 18" spr., 24" o.c., Gold Dust	VERY
110	DM	Drocaena Marginata / Red Edged Drocaena 36" ht. min. 3 staggered heads	VERY
67	DS*	Dideroxylon Sollicifolium / Willow Busic 10" ht. x 5" spr., 5' c.t.	VERY
65	GD*	Guapira Discolor / Blotly 10" ht. x 5" spr., 5' c.t.	VERY
20	IC*	Ilex Cassine / Dahoon Holly 10" ht. x 5" spr., 5' c.t.	MOD.
296	IV*	Ilex Vomitoria 'Shellings Dwarf' / Dwarf Yaupon Holly 10-12" ht. x 18" spr., 18" o.c.	VERY
1281	JV	Jasminum Volubile / Wax Jasmine 18" ht. x 18" spr., 18" o.c.	MOD.
1252	LM	Liriope Muscari 'Evergreen Giant' / Lilyturf 12" o.d., full, 15" o.c.	VERY
132	MF*	Simpson Stopper / Myrciophora Fragrans 24" ht. x 18" spr., 24" o.c.	MOD.
684	MP	Murraya Paniculata / Chalcas 24" ht. x 18" spr., 24" o.c.	VERY
62	NE	Noronhia Emarginata / Madagascar Olive 8-10" ht. x 5" spr., 5' c.t.	VERY
40	PE	Ptychosperma Elegans / Solitaire Palm 10-12" ht., triple trunk	VERY
180	PL	Psychotria Ligustrifolia / Dwarf Wild Coffee 24" ht. x 18" spr., 24" o.c.	VERY
784	SA	Schefflera Arboricola 'Trinette' / Dwarf Schefflera 18" ht. x 12" spr., 24" o.c.	-
1152	VS	Viburnum Suspensum / Sandalwood Viburnum 24" ht. x 18" spr., 24" o.c.	MOD.
222	ZF*	Zamia Floridana / Coontie 12" o.d., full	VERY

Drought tolerance is per "SFWMD Xeriscape Plant Guide"
 PLAN QUANTITIES TAKE PRECEDENCE OVER THOSE NOTED ABOVE
 * = Native to Florida
 Abbreviations:
 c.t. - clear trunk
 d.b.h. - diameter at breast height
 g.w. - graywood
 ht. - height
 o.c. - overall
 o.d. - on-center spacing
 spr. - spread

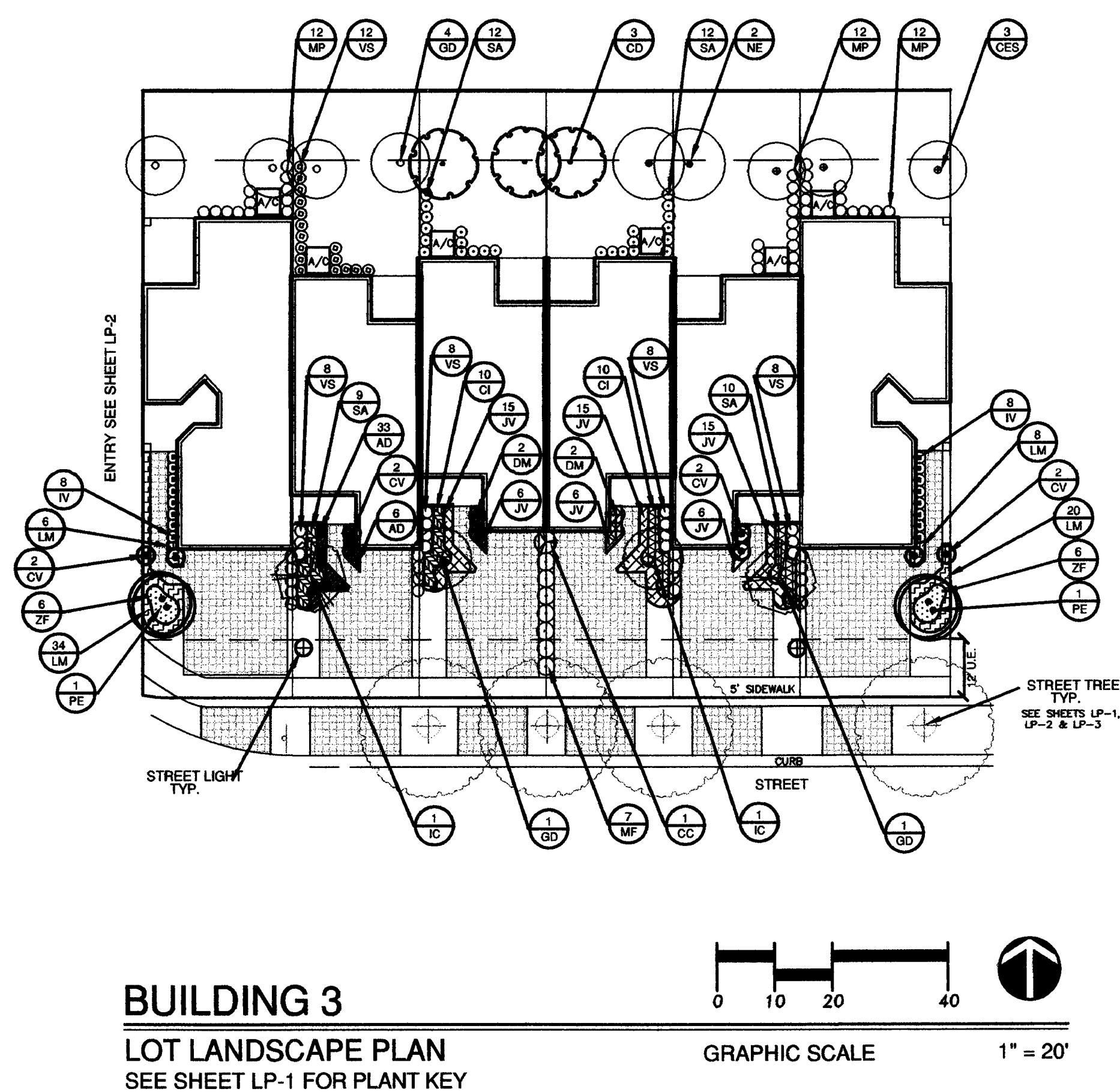

BUILDING 3
LOT LANDSCAPE PLAN
 SEE SHEET LP-1 FOR PLANT KEY

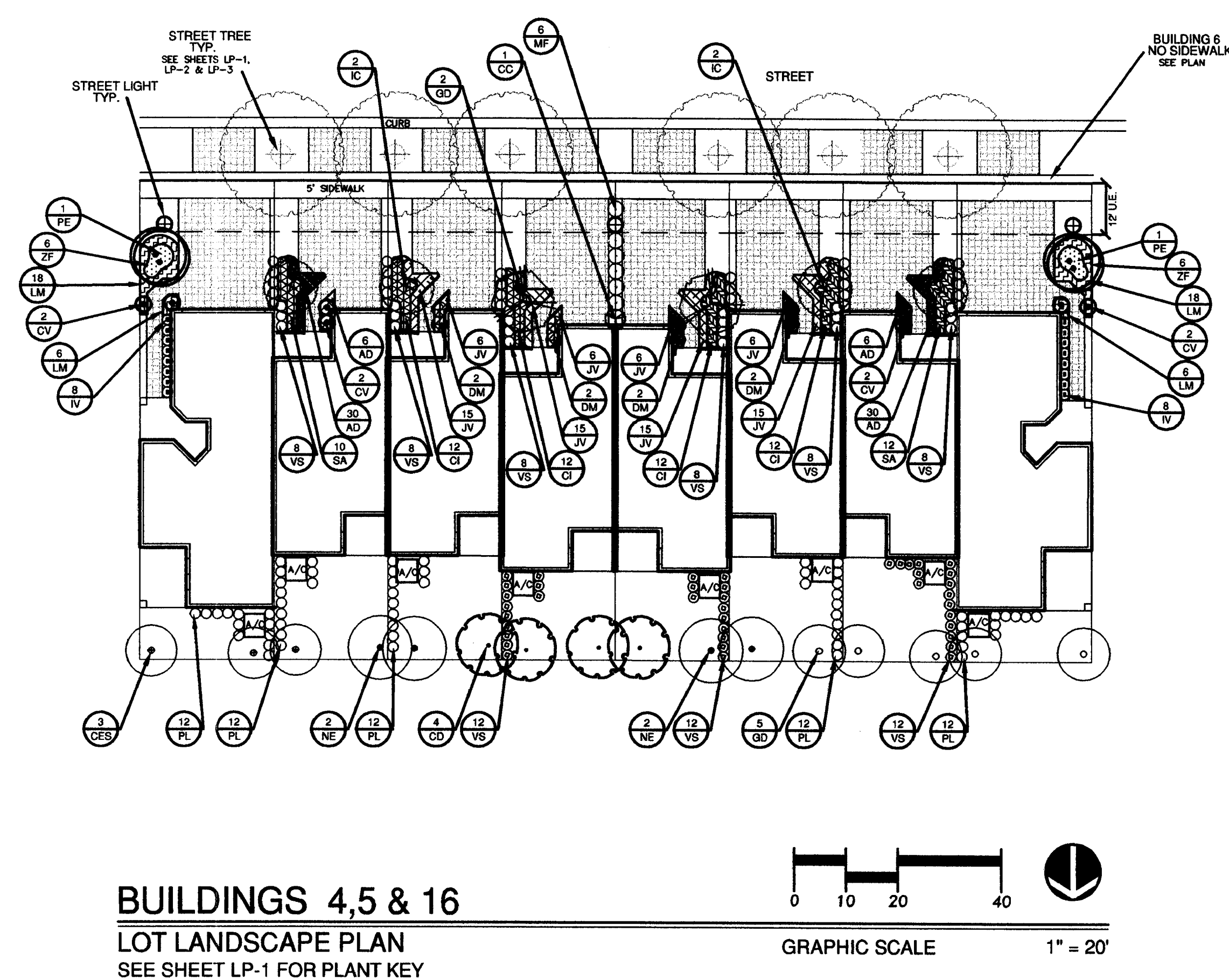

BUILDINGS 4, 5 & 16
LOT LANDSCAPE PLAN
 SEE SHEET LP-1 FOR PLANT KEY

DATE	02/21/05
BY	set
SET	
REVISIONS	
FILE NAME	4633.LAND

CAULFIELD & WHEELER, INC.
 CIVIL ENGINEERING - LAND PLANNING
 LANDSCAPE ARCHITECTURE - SURVEYING
 7301 A W. PALMETTO PARK ROAD, SUITE 100A
 BOCA RATON, FLORIDA 33433
 PHONE (561) 392-1991 / FAX (561) 750-1452

Landscape Plan
SIMONTON COURT
 Coconut Creek Florida

DATE	02/21/05
DRAWN BY	set
F.B. / PG.	N/A
SCALE	as noted

STEVEN E. TATE
 LANDSCAPE ARCHITECT
 No. 967
 STATE OF FLORIDA
 -FOR THE FIRM-
 DATE **SEP 09 2005**

JOB # 4633
 SHT. NO.
LP-4
 OF 6 SHEETS

E:\PROJECTS\4633-05-05-02-land\wpl\simontoncourt\4633.LAND.dwg 1/20/2005 9:06:32 AM EST