

# HILLSBORO BOULEVARD (STATE ROAD 810)

EX. ASPHALT ROADWAY

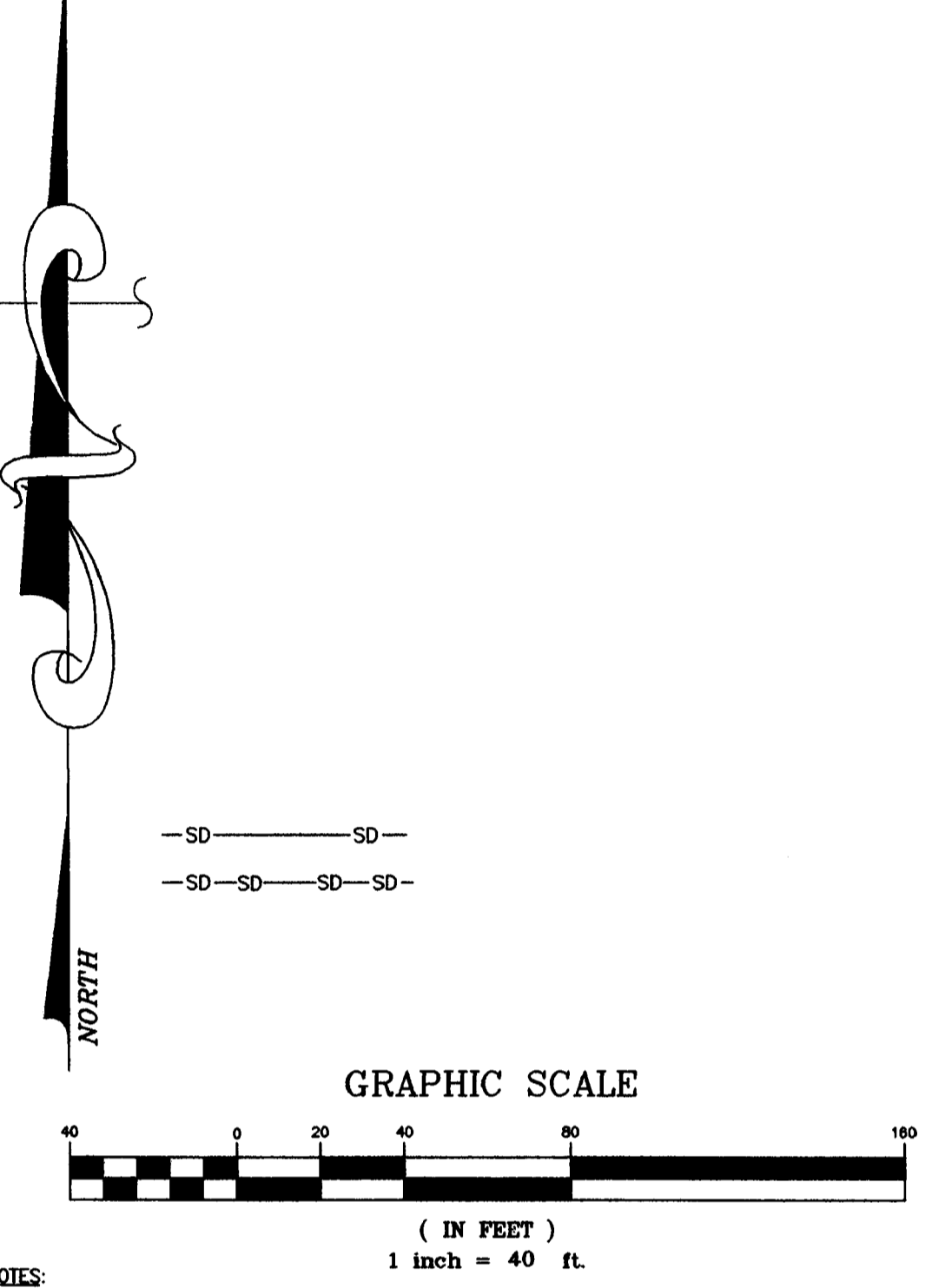

- PROPOSED NOTES:**
1. STORM SEWER, GRAVITY WASTEWATER AND RECLAIMED WATER MAIN CROSSING UNDER POTABLE WATER MAINS SHALL BE LAID TO PROVIDE A MINIMUM VERTICAL DISTANCE OF EIGHTEEN (18) INCHES BETWEEN THE INVERT OF THE UPPER PIPE AND THE CROWN OF THE LOWER PIPE. WHERE THIS MINIMUM SEPARATION CANNOT BE MAINTAINED, THE CROSSING SHALL BE ARRANGED SO THAT THE STORM/WASTEWATER/RECLAIMED WATER PIPE JOINTS AND POTABLE WATER MAIN JOINTS ARE EQUIDISTANT FROM THE POINT OF CROSSING WITH NO LESS THAN TEN (10) FEET BETWEEN ANY TWO JOINTS. BOTH PIPES SHALL BE D.I.P. AND THE MINIMUM VERTICAL SEPARATION SHALL BE 6" INCHES. WHERE THERE IS NO ALTERNATIVE TO STORM/WASTEWATER/RECLAIMED WATER PIPES CROSSING OVER A POTABLE WATER MAIN, THE CRITERIA FOR MINIMUM 18" VERTICAL SEPARATION BETWEEN LINES AND JOINT ARRANGEMENT, AS STATED ABOVE, SHALL BE REQUIRED, AND BOTH PIPES SHALL BE D.I.P. IRRESPECTIVE OF SEPARATION. D.I.P. IS NOT REQUIRED FOR STORM SEWERS.
  2. MAINTAIN MIN. TEN (10) FEET HORIZONTAL DISTANCE (WALL TO WALL) BETWEEN POTABLE WATER MAIN AND STORM SEWER, WASTEWATER MAIN, OR FORCE MAIN. MAINTAIN MIN. THREE (3) FEET HORIZONTAL DISTANCE (WALL TO WALL) BETWEEN RECLAIMED WATER MAIN AND POTABLE WATER MAIN, STORM SEWER, WASTEWATER GRAVITY MAIN OR FORCE MAIN.
  3. FORCE MAIN CROSSING POTABLE WATER MAIN OR RECLAIMED WATER MAIN SHALL BE LAID TO PROVIDE A MINIMUM VERTICAL DISTANCE OF EIGHTEEN (18) INCHES BETWEEN THE OUTSIDE OF THE FORCE MAIN AND OUTSIDE OF THE POTABLE WATER MAIN OR RECLAIMED WATER MAIN WITH THE POTABLE WATER MAIN OR RECLAIMED WATER MAIN CROSSING OVER THE FORCE MAIN.
  4. WASTEWATER LATERALS SHALL CROSS UNDER POTABLE WATER MAINS WITH A MIN. 18" VERTICAL SEPARATION WHENEVER POSSIBLE. WHERE THIS MINIMUM SEPARATION CANNOT BE MAINTAINED, A 20" SECTION OF DUCTILE IRON PIPE POTABLE WATER MAIN CENTERED ON THE CROSSING IS REQUIRED AND THE MINIMUM VERTICAL SEPARATION SHALL BE 6". WHERE THERE IS NO ALTERNATIVE TO A WASTEWATER LATERAL PIPE CROSSING OVER A POTABLE WATER MAIN, A MINIMUM 18" VERTICAL SEPARATION IS REQUIRED. THE LATERAL SHALL BE P.V.C. C-200 SMOOTH OR BETTER. THE POTABLE WATER MAIN SHALL BE D.I.P. AND THE PIPE JOINTS SHALL BE EQUIDISTANT FROM THE POINT OF CROSSING.
  5. POTABLE WATER SERVICE LINES SHALL CROSS OVER WASTEWATER MAINS WITH MIN. 12" VERTICAL SEPARATION. WHERE THIS MIN. SEPARATION CANNOT BE MAINTAINED, THE WATER SERVICE SHALL BE ENCASED IN A MIN. 10" LONG CASING CENTERED OVER THE CROSSING WITH MIN. 6" VERTICAL SEPARATION.

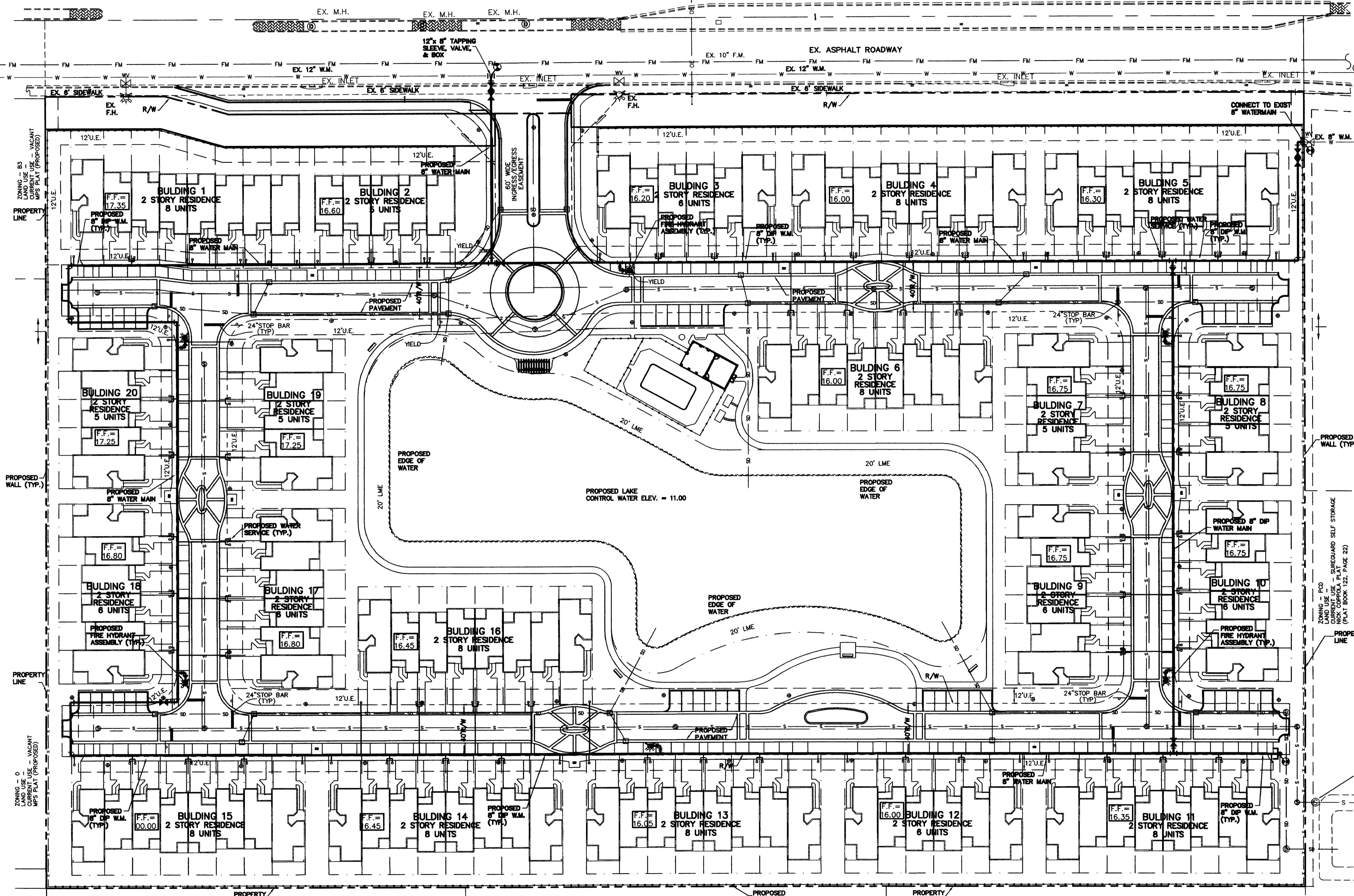
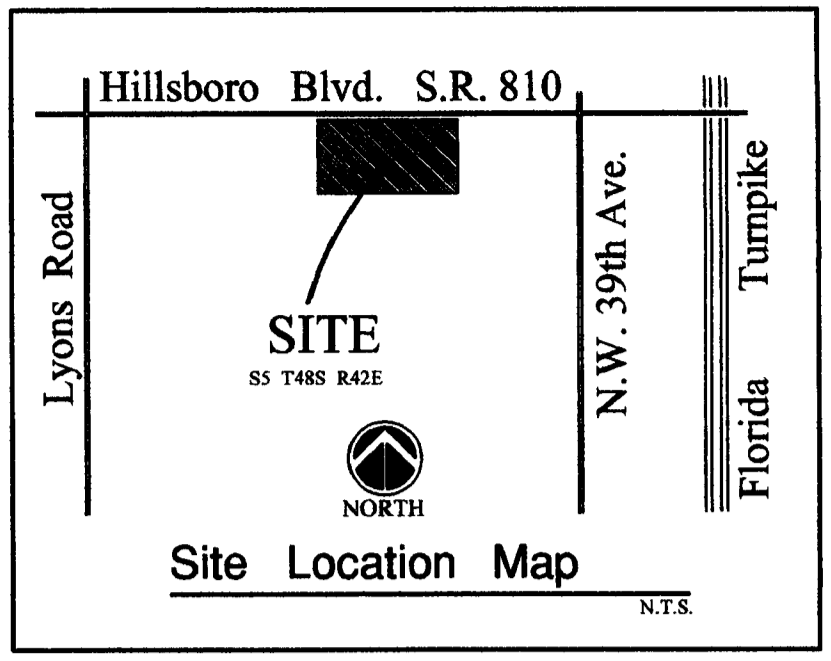
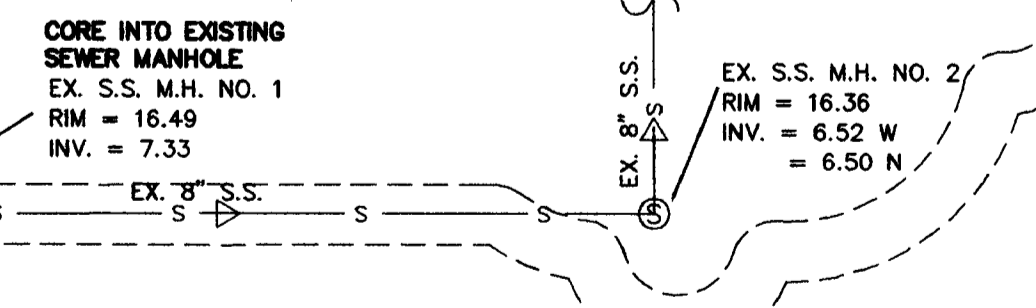

ZONING - MH-1  
 LAND USE - MOBILE HOME PARK  
 CURRENT USE - PALM BEACH FARMS COMPANY PLAT NO. 3  
 (PLAT BOOK 2, PAGES 45 THROUGH 54, P.B.C.R.)

REVISIONS	DATE	BY

**CAULFIELD & WHEELER, INC.**  
 CIVIL ENGINEERING - LAND PLANNING  
 LANDSCAPE ARCHITECTURE - SURVEYING  
 7301A W. PALMETTO PARK ROAD - SUITE 100A  
 BOCA RATON, FLORIDA 33433  
 PHONE (561) 992-1191 / FAX (561) 750-1453

**Conceptual Water Distribution Plan**  
**Simonton Court**  
 COCONUT CREEK, FLORIDA

DATE 8/14/05  
 DRAWN BY BAH  
 F.B./PG. n/a  
 SCALE 1" = 40'

JOHN F. WHEELER  
 PROFESSIONAL ENGINEER  
 CERT. NO. 25478  
 STATE OF FLORIDA  
 ENG. NO. EB-0003501  
 DATE **SEP 09 2005**

JOB # 4633  
 SHT. NO. **C-1**  
 OF 4 SHEETS