

HILLSBORO BOULEVARD (STATE ROAD 810)
EX. ASPHALT ROADWAY

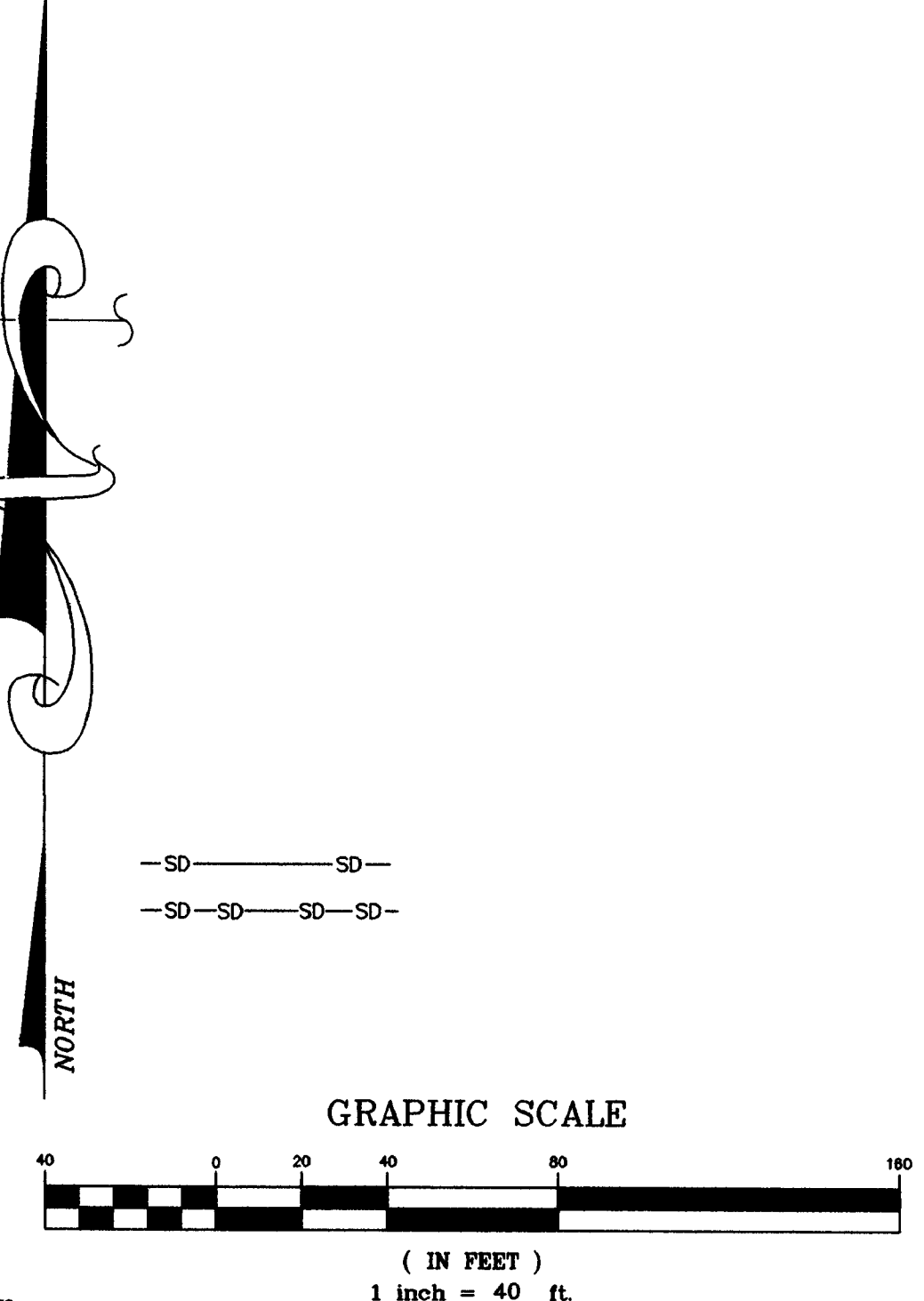
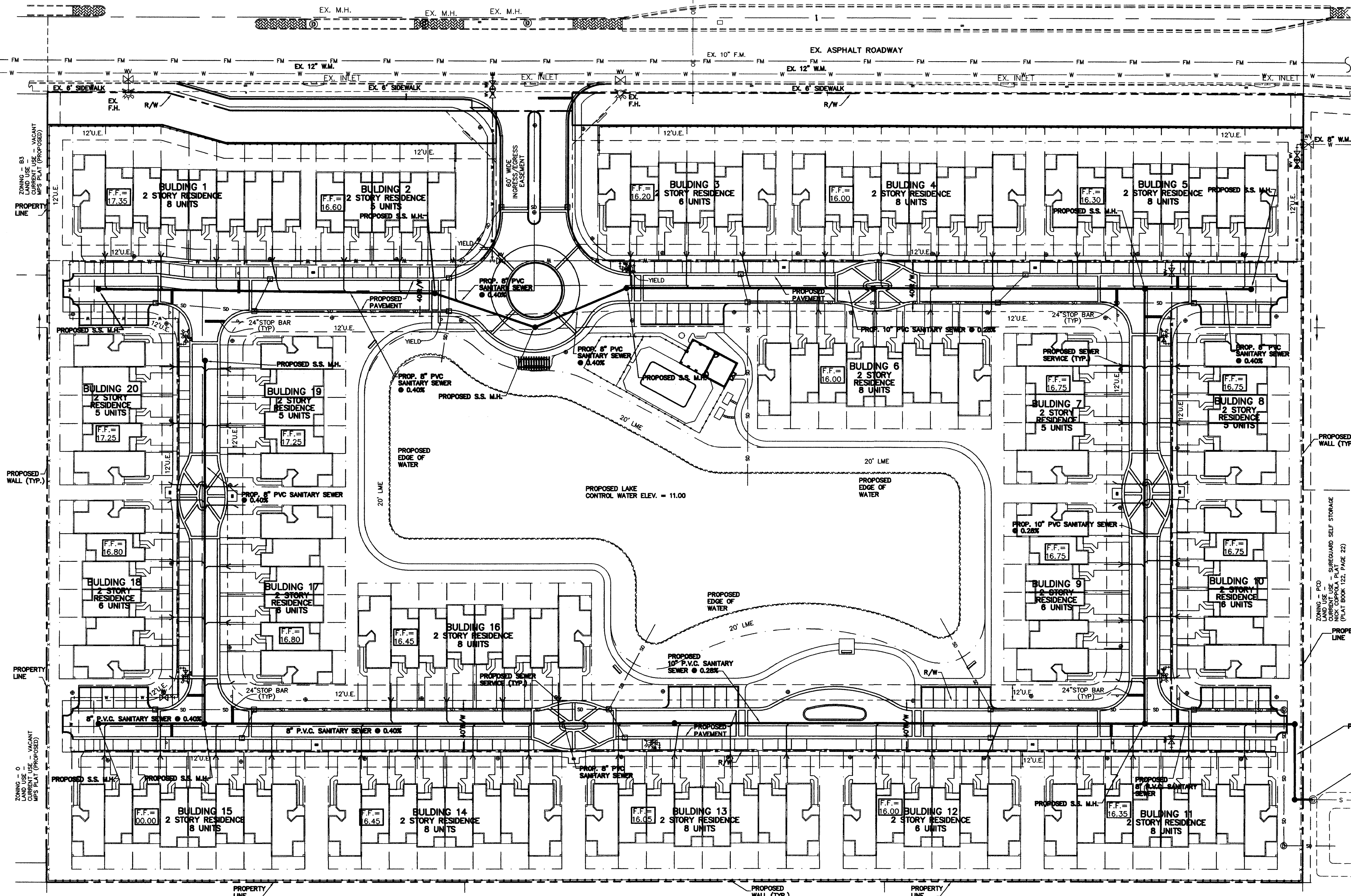
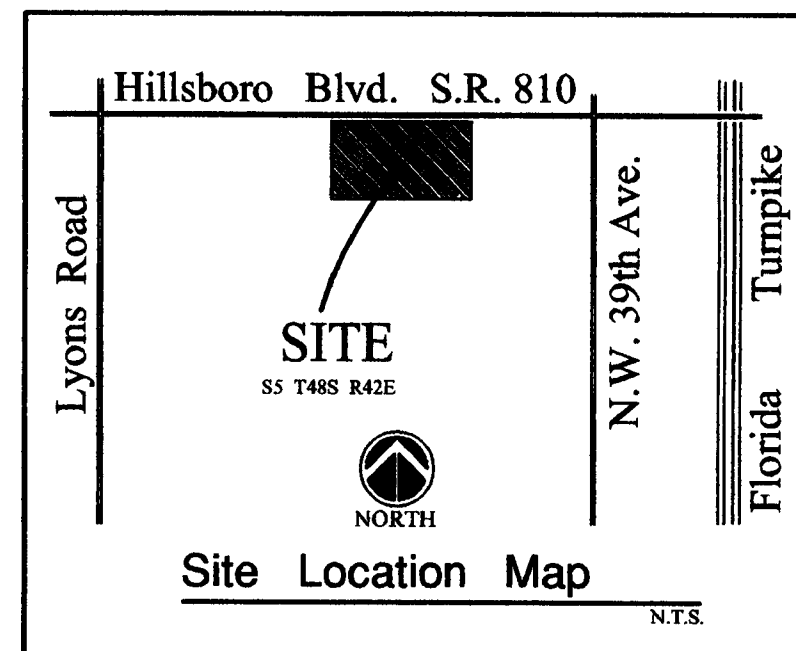

- PROPOSED NOTES:**
- STORM SEWER, GRAVITY WASTEWATER AND RECLAIMED WATER MAIN CROSSING UNDER POTABLE WATER MAINS SHALL BE LAID TO PROVIDE A MINIMUM VERTICAL DISTANCE OF EIGHTEEN (18) INCHES BETWEEN THE INVERT OF THE UPPER PIPE AND THE CROWN OF THE LOWER PIPE, WHERE THIS MINIMUM SEPARATION CANNOT BE MAINTAINED, THE CROSSING SHALL BE ARRANGED SO THAT THE STORM/WASTEWATER/RECLAIMED WATER PIPE JOINTS AND POTABLE WATER MAIN JOINTS ARE EQUIDISTANT FROM THE POINT OF CROSSING WITH NO LESS THAN TEN (10) FEET BETWEEN ANY TWO JOINTS; BOTH PIPES SHALL BE D.I.P. AND THE MINIMUM VERTICAL SEPARATION SHALL BE 6 INCHES, WHERE THERE IS NO ALTERNATIVE TO STORM/WASTEWATER/RECLAIMED WATER PIPES CROSSING OVER A POTABLE WATER MAIN, THE CRITERIA FOR MINIMUM 18\"/>
 - MAINTAIN MIN. TEN (10) FEET HORIZONTAL DISTANCE (WALL TO WALL) BETWEEN POTABLE WATER MAIN AND STORM SEWER, WASTEWATER MAIN, OR FORCE MAIN; MAINTAIN MIN. THREE (3) FEET HORIZONTAL DISTANCE (WALL TO WALL) BETWEEN RECLAIMED WATER MAIN AND POTABLE WATER MAIN, STORM SEWER, WASTEWATER GRAVITY MAIN OR FORCE MAIN.
 - FORCE MAIN CROSSING POTABLE WATER MAIN OR RECLAIMED WATER MAIN SHALL BE LAID TO PROVIDE A MINIMUM VERTICAL DISTANCE OF EIGHTEEN (18) INCHES BETWEEN THE OUTSIDE OF THE FORCE MAIN AND OUTSIDE OF THE POTABLE WATER MAIN OR RECLAIMED WATER MAIN WITH THE POTABLE WATER MAIN OR RECLAIMED WATER MAIN CROSSING OVER THE FORCE MAIN.
 - WASTEWATER LATERALS SHALL CROSS UNDER POTABLE WATER MAINS WITH A MIN. 18\"/>
 - POTABLE WATER SERVICE LINES SHALL CROSS OVER WASTEWATER MAINS WITH MIN. 12\"/>

ZONING - MH-1
LAND USE - MOBILE HOME PARK
CURRENT USE - PALM BEACH FARMS COMPANY PLAT NO. 3 (PLAT BOOK 2, PAGES 45 THROUGH 54, P.B.C.R.)

BY	
DATE	
REVISIONS	
FILE NAME	463509

CAULFIELD & WHEELER, INC.
CIVIL ENGINEERING - LAND PLANNING
LANDSCAPE ARCHITECTURE - SURVEYING
7301A W. PALMETTO PARK ROAD - SUITE 100A
BOCA RATON, FLORIDA 33433
PHONE (561)-392-1991 / FAX (561)-390-1452

Conceptual Sanitary Sewer Plan
Simonton Court
FLORIDA
COCONUT CREEK

DATE 8/14/05
DRAWN BY BAH
F.B./PG. n/a
SCALE 1" = 40'

JOHN P. WHEELER
PROFESSIONAL ENGINEER
CERT. NO. 25478
STATE OF FLORIDA
ENG. NO. EB-0003581
DATE 09 2005

JOB # 4633
SHT. NO.
C-2
OF 4 SHEETS