

THIS ELECTRONIC DRAWING FILE IS RELEASED UNDER THE AUTHORITY OF STB ARCHITECTS AND PLANNERS INC. JERRY W. STEWART, PRINCIPAL, TEX. ARCH. REG. NO. 34692 ON JULY 31, 2004. WHO MAINTAINS THE ORIGINAL FILE. THIS ELECTRONIC FILE MAY BE USED AS A BACKGROUND DRAWING PURSUANT TO RULE 100.00 OF THE RULES AND EXAMINERS. NO PERSON MAY MAKE ANY MODIFICATIONS TO THIS ELECTRONIC DRAWING FILE WITHOUT THE ARCHITECT'S EXPRESS WRITTEN PERMISSION.  
 H:10709 DD/A3-02

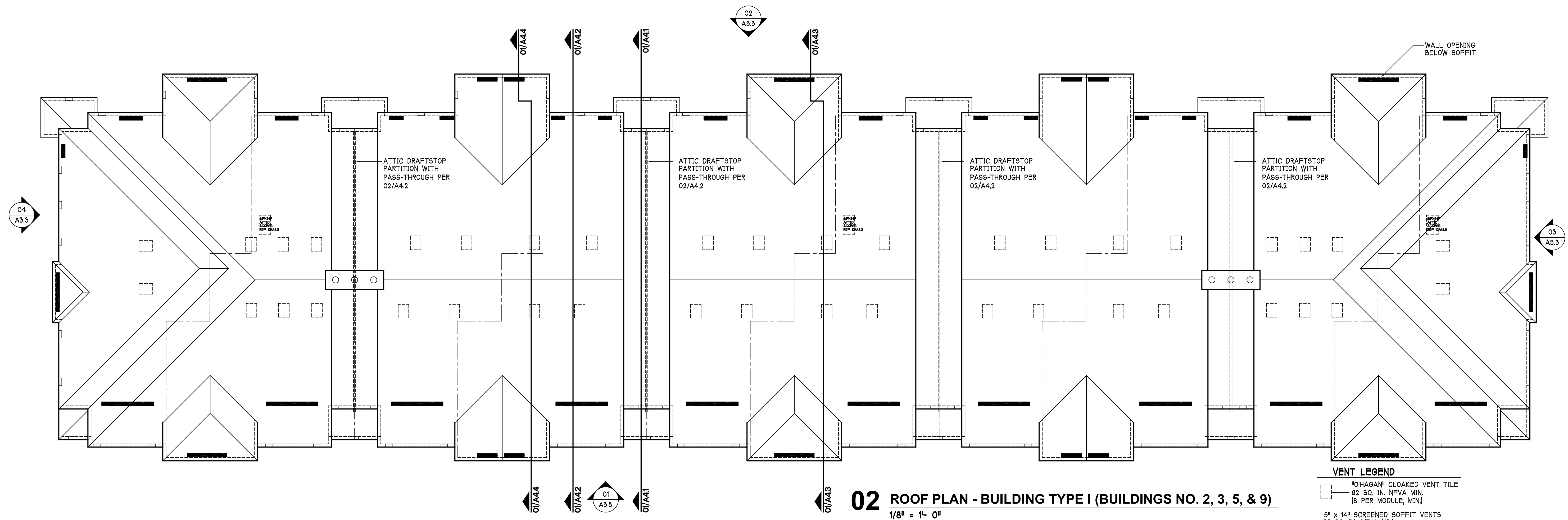

**02 ROOF PLAN - BUILDING TYPE I (BUILDINGS NO. 2, 3, 5, & 9)**  
 1/8" = 1'- 0"

**VENT LEGEND**  
 [Symbol] "HAGAN" CLOAKED VENT TILE  
 92 SQ. IN. NFVA MIN.  
 (8 PER MODULE, MIN.)  
 [Symbol] 5" x 14" SCREENED SOFFIT VENTS  
 65 SQ. IN. NFVA MIN.  
 (12 PER MODULE, MIN.)  
 AS SHOWN ON ROOF PLAN. [Symbol]

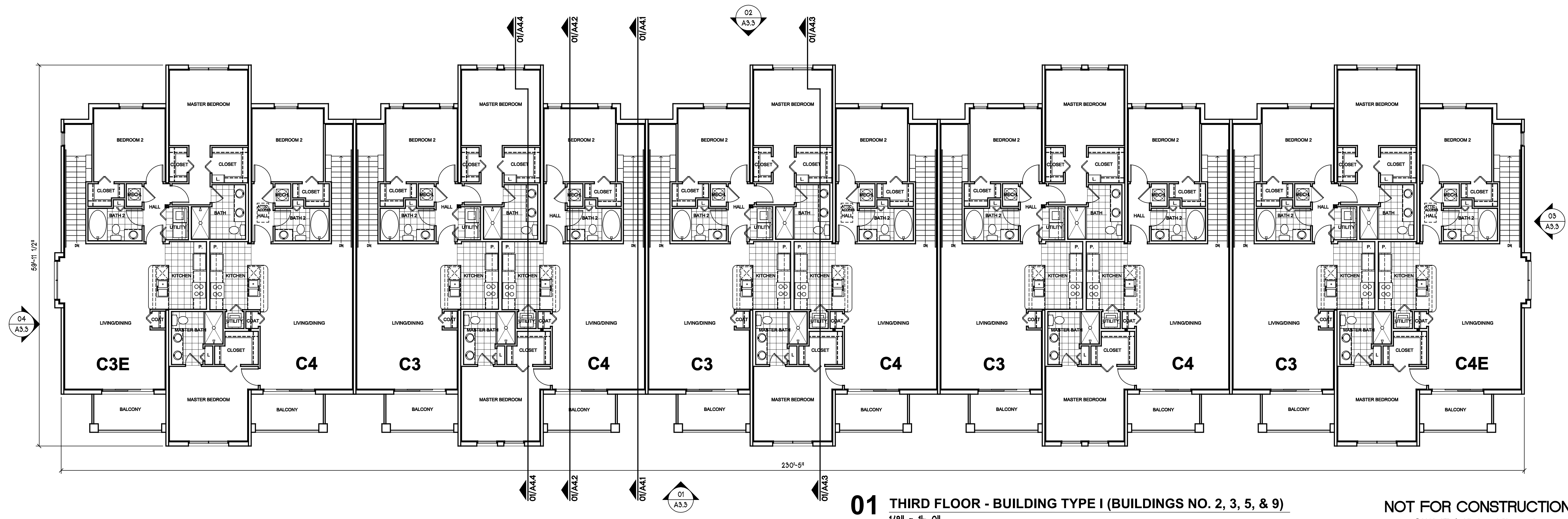

**01 THIRD FLOOR - BUILDING TYPE I (BUILDINGS NO. 2, 3, 5, & 9)**  
 1/8" = 1'- 0"

**NOT FOR CONSTRUCTION**  
 ©2008 STB Architects and Planners, Inc.  
 Proprietary Designs of STB Architects and Planners, Inc.  
 NOT TO BE COPIED, USED OR REPRODUCED  
 WITHOUT WRITTEN PERMISSION.

**STB** architects & planners, inc.  
 8144 walnut hill lane · suite 460 lb 107 · dallas, tx. 75231  
 (214) 739-8080 fax (214) 739-8084

BELL LAGO - Coconut Creek, Florida  
 Altman Development Corporation  
**CARRIAGE HOME**  
 C A P A R T M E N T S

revisions:

date: 09/19/08  
 job no.: 0708

sheet number:  
**A3.2**  
 of