

PLANT LIST LINEAR GREENWAY

NOTE: The quantities on this plant list are to be used as a guide only. Bidder shall do independent takeoff for bidding purposes. * Denotes native plants.

CT= CLEAR TRUNK GW= GREY WOOD DBH= DIAMETER BREST HEIGHT (4 1/2) OA= OVERALL HEIGHT
 FTB= FULL TO BASE HVY= HEAVY TRUNK CAL= CALIPER @ 6" / 12" PER GRADES & STDS. SING= SINGLE TRUNK
 DBL= DOUBLE TRUNK TRP= TRIPLE TRUNK STD.= TREE STANDARD MULT= MULTI-TRUNK
 STAG= STAGGERED HEIGHTS
 ALL PLANT MATERIALS MUST ADHERE TO CURRENT GRADES AND STANDARDS FOR FLORIDA NUMBER ONE QUALITY OR BETTER

| SYM | QTY | BOTANICAL NAME | COMMON NAME | OA HEIGHT | SPREAD | TRUNK SPECS. | TRUNK DIA. | COMMENTS |
|-------|------|-------------------------------|---------------------|-----------|--------|--------------|------------|----------|
| VS | 1034 | Viburnum suspensum | Sandankwa Viburnum | 24" | 18" | | | |
| ING | 564 | Ixora 'Nora Grant' | Nora Grant Ixora | 24" | 18" | | | Full |
| JV | 543 | Jasminum volubile | Wax Jasmine | 24" | 18" | | | Full |
| FGI | 358 | Ficus microcarpa | Green Island Ficus | 18" | 18" | | | |
| HPC | 168 | Hamelia patens compacta | *Dwarf Firebush | 18"-24" | 18" | | | Full |
| CI | 98 | Chrysobalanus icaco | *Cocoplum | 24" | 18" | | | Full |
| DGM | 75 | Duranta erecta | Gold Mound | 24" | 18" | | | |
| ROY12 | 56 | Roystonea elata | *Florida Royal Palm | | | 12" GW | | MATCHED |
| QV14 | 21 | Quercus virginiana | *Live Oak | 14' | 7' | 4.5CT | 3"dbh | |
| IB | 30 | Ilex cornuta 'Burfordii' | Burford Holly | 24" | 18" | | | |
| MED14 | 8 | Phoenix dactylifera 'Medjool' | Medjool | | | 14CT | | |
| DEL16 | 16 | Delonix regia | Royal Poinciana | 16' | 10' | 8CT | 3"dbh | MATCHED |
| IAP14 | 6 | Ilex attenuata 'East Palatka' | *East Palatka Holly | 14' | 5' | 3CT | 2"dbh | |

OTHER LANDSCAPE MATERIALS:
 MUL Mulch (in Bags) As needed
 SOIL Planting Soil (Cubic Yards) As needed
 SOD TO BE MEASURED IN FIELD LOCATION AS SHOWN ON PLAN & GENERAL SPECIFICATIONS

NOTE: ALL PLANT MATERIAL SHOWN IN GREY TONE AROUND THE STORAGE BUILDING CLUB BUILDING AND THE RESIDENTIAL BUILDINGS IS LABELED AND LOCATED ON THE INDIVIDUAL BUILDING LANDSCAPE PLANS. SEE INDIVIDUAL BUILDING SHEETS.

ALL SHRUBS AND/OR HEDGES LOCATED WITHIN ANY SIGHT TRIANGLE SHALL BE MAINTAINED AT A HEIGHT NO TALLER THAN 24" ABOVE THE FINISHED GRADE OF THE ADJACENT ROAD PAVEMENT.

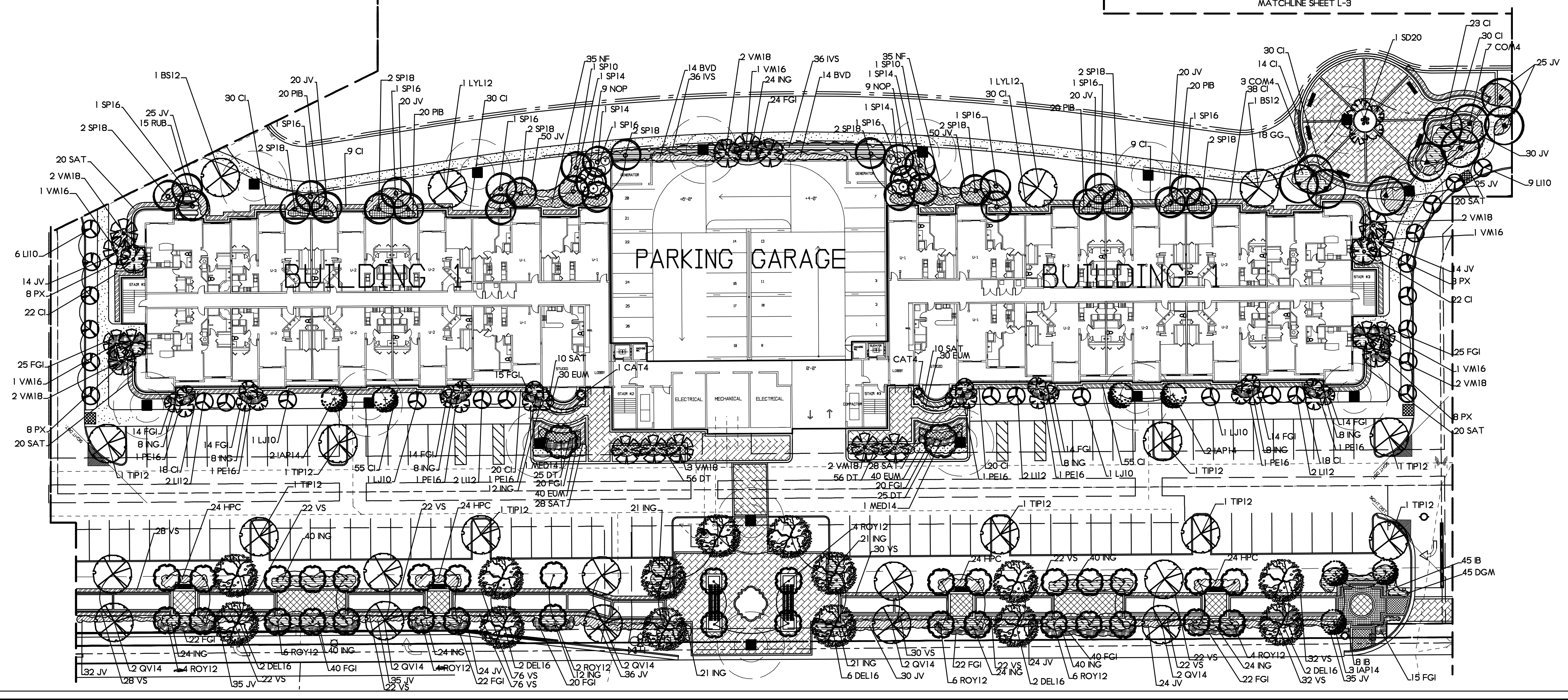

© Copyright 2008, Michael J. Petrow and Associates, Inc. All Rights Reserved.

RIGHT OF OWNERSHIP: The drawings, designs, engineering and data hereon are the property of the landscape architect and shall remain the property of the landscape architect. No part of these drawings shall be reproduced, stored in a retrieval system, or transmitted in any form or by any means, electronic, mechanical, photocopying, recording, or by any information storage and retrieval system, without the express written permission of the landscape architect. The landscape architect's liability is limited to the professional services provided herein and does not extend to any other services provided by the landscape architect. The landscape architect's liability is limited to the professional services provided herein and does not extend to any other services provided by the landscape architect. The landscape architect's liability is limited to the professional services provided herein and does not extend to any other services provided by the landscape architect.

NO REVISIONS

| | |
|-----------------|--|
| JULY 9, 2008 | |
| SEPT. 16, 2008 | |
| OCTOBER 9, 2008 | |
| JUNE 29, 2009 | |
| JULY 15, 2009 | |
| NOV. 17, 2009 | |
| JAN. 21, 2010 | |
| MAY 26, 2010 | |

SCALE: 1" = 30'
 DATE: APRIL 22, 2008
 DRAWN BY: M.J.P.

SITE LANDSCAPE PLAN & BUILDING #1 FOR BEL LAGO
 WILES ROAD, COCONUT CREEK, FLORIDA

Michael J. Petrow and Associates, Inc.
 Landscape Architecture
 P.O. Box 8801, Coral Springs, FL 33075
 Phone: (954) 466-9659, FL Reg. #382

SHEET NO: L-2
 OF TEN

THESE DRAWINGS ARE NOT VALID FOR SUBMITTAL OR CONTRACT NEGOTIATION USE UNLESS SIGNED, SEALED & DATED WITHIN 60 DAYS OF THE DATE OF ISSUANCE. UNLESS OTHERWISE SPECIFIED, ALL DIMENSIONS AND MATERIALS SHALL BE AS SHOWN. THE LANDSCAPE ARCHITECT, UNLESS OTHERWISE SPECIFIED, SHALL BE RESPONSIBLE FOR OBTAINING ALL NECESSARY PERMITS AND APPROVALS. THE LANDSCAPE ARCHITECT'S LIABILITY IS LIMITED TO THE PROFESSIONAL SERVICES PROVIDED HEREIN AND DOES NOT EXTEND TO ANY OTHER SERVICES PROVIDED BY THE LANDSCAPE ARCHITECT.