

MORGAN PROFESSIONAL PARK

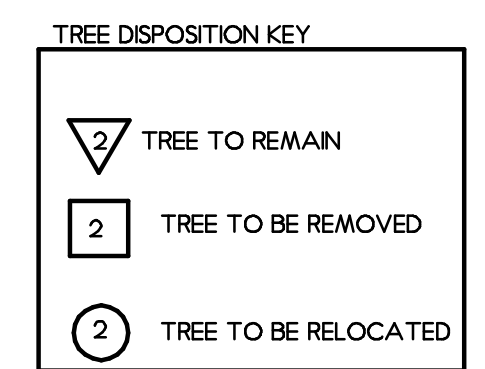
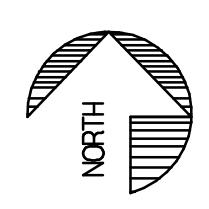
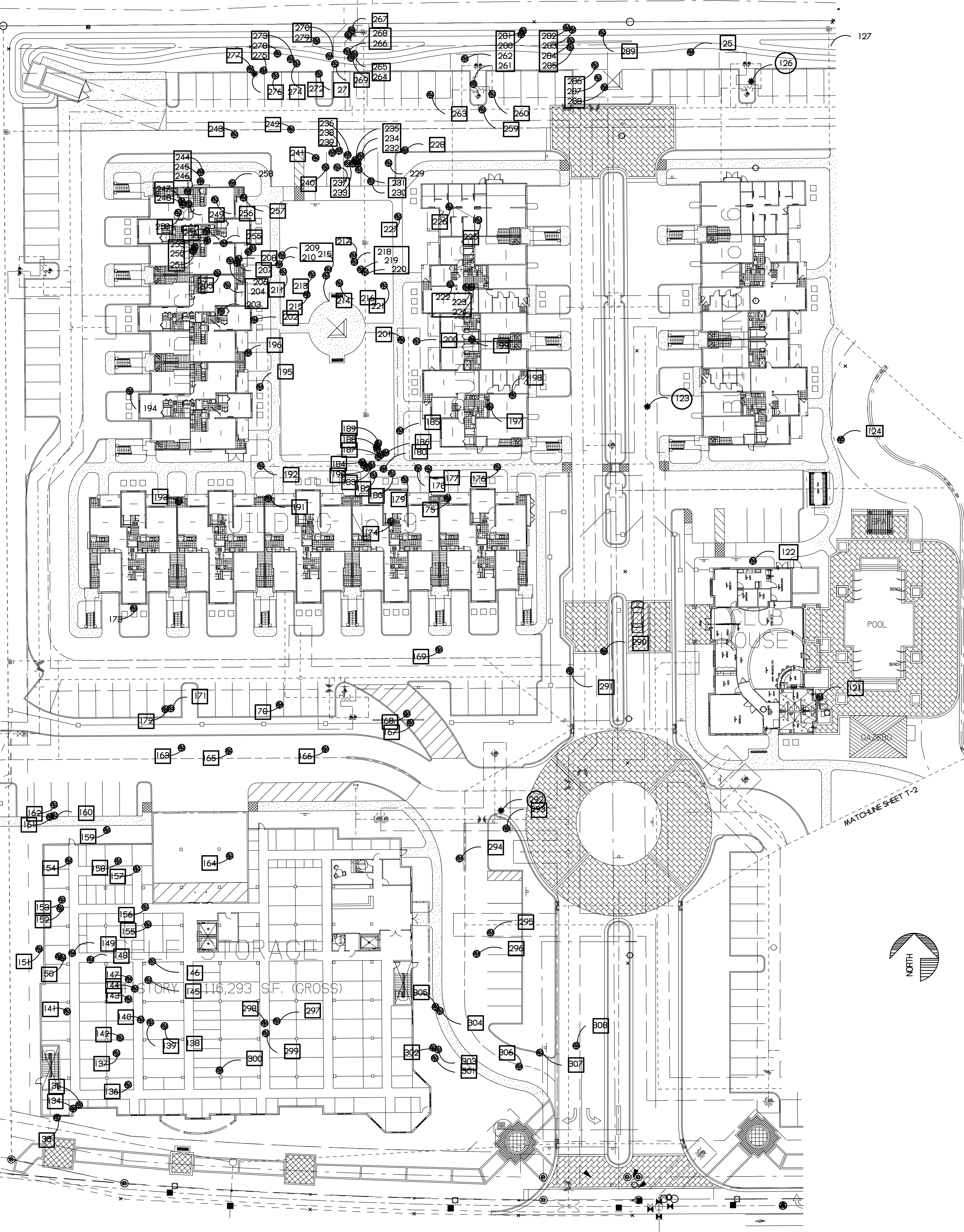

NOTE: ALL BASE INFORMATION FOR SITE PLAN HAS BEEN PROVIDED BY H&Q GROUP, INC. ENGINEERS.
 ALL EXISTING TREE INFORMATION HAS BEEN PROVIDED BY JERRY T. CHANCEY, ISA, CERTIFIED ARBORIST.
 THIS PLAN IS A GRAPHIC REPRESENTATION OF THE BASE AND TREE INFORMATION PROVIDED BY
 EACH OF THE ABOVE COMPANIES.
 THE LANDSCAPE ARCHITECT IS NOT RESPONSIBLE FOR THE ACCURACY OF THE INFORMATION PROVIDED.

THESE DRAWINGS ARE NOT VALID FOR SUBMITTAL OR CONTRACT CONSTRUCTION USE
 UNLESS THEY ARE APPROVED BY THE ARCHITECT AND THE LANDSCAPE ARCHITECT.
 THESE DRAWINGS ARE NOT TO BE USED FOR ANY OTHER PURPOSES WITHOUT THE WRITTEN
 CONSENT OF THE ARCHITECT AND LANDSCAPE ARCHITECT. DRAWINGS MAY BE USED FOR
 CLIENT IN-HOUSE PURPOSES & BIDDING ONLY.

NOTE: ALL EXISTING TREE locations, sizes, species and ages represented
 on this plan are based on field data collected by the landscape architect
 and remain the property of the landscape architect. None of such drawings,
 designs, arrangements and locations may be used by any person whatsoever without
 the written consent of the landscape architect. To the best of our knowledge, the plans and specifications submitted herein comply
 with all applicable laws, codes and regulations. The landscape architect and his/her
 firm do not warrant the accuracy or completeness of the information provided
 herein. The landscape architect and his/her firm do not warrant the accuracy or
 completeness of the information provided herein. The landscape architect and
 his/her firm do not warrant the accuracy or completeness of the information
 provided herein. The landscape architect and his/her firm do not warrant the
 accuracy or completeness of the information provided herein.

NO REVISIONS

OCT. 9, 2008
JUNE 29, 2009
NOV. 17, 2009

SCALE: 1" = 30'

DATE: JULY 3, 2008
 DRAWN BY: M.J.P.

TREE DISPOSITION PLAN
 BEL LAGO
 COCONUT CREEK, FLORIDA

Michael J. Petrow
 and
 Associates, Inc.
 Landscape Architecture
 P.O. Box 890, Coral Springs, FL 33075
 Phone: (954) 448-0659 FL Reg. #32

SHEET NO. T-1
 OF THREE

© Copyright 2008, Michael J. Petrow and Associates, Inc. All Rights Reserved.