

CONCRETE: 3000psi COMPRESSIVE STRENGTH AT 28 DAYS, SAWCUT CONSTRUCTION JOINTS 10 FOOT (O.C.) WITHIN 48 HOURS OF PLACING.  
**FDOT TYPE "D" CONCRETE CURB**  
 SCALE: NONE

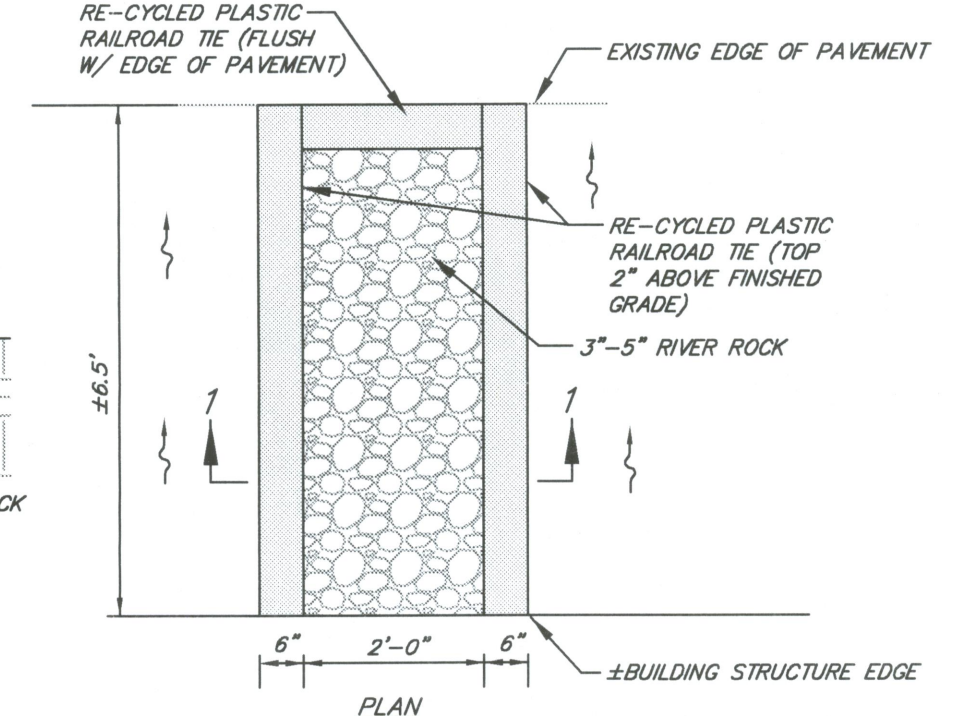

**ROCK AREA DETAIL**  
 SCALE: NONE

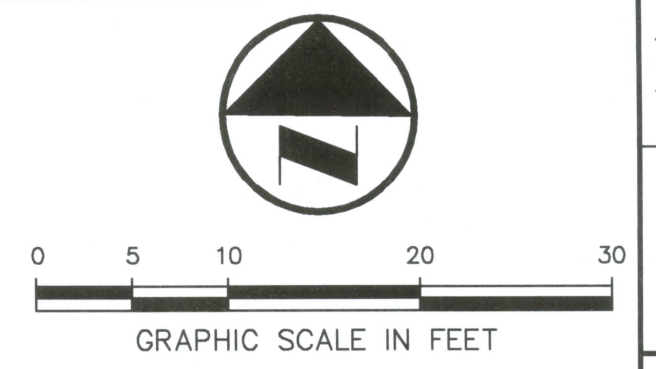

**LEGEND**  
 13.50 NGVD (12.00 NAVD) EXISTING SPOT ELEVATION  
 14.20 NGVD (12.70 NAVD) PROPOSED SPOT ELEVATION

BROWARD COUNTY DEVELOPMENT AND ENVIRONMENTAL REGULATION MODIFICATION TO: SURFACE WATER MANAGEMENT LICENSE NO. SW12006-057-0  
 BY *[Signature]* DATE 3/28/12

**I. APPLICABLE CODES**

1. ALL CONSTRUCTION AND MATERIALS SHALL CONFORM TO THE STANDARDS AND SPECIFICATIONS OF THE CITY OF COCONUT CREEK AND ALL OTHER LOCAL, STATE AND NATIONAL CODES WHERE APPLICABLE.
2. ALL CONSTRUCTION SHALL BE DONE IN A SAFE MANNER AND IN STRICT COMPLIANCE WITH ALL THE REQUIREMENTS OF FEDERAL OCCUPATIONAL SAFETY AND HEALTH ACT OF 1970, AND ALL STATE AND LOCAL SAFETY AND HEALTH REGULATIONS.
3. ALL ELEVATIONS SHOWN ON THE DRAWINGS ARE REFERENCED TO THE NATIONAL GEODETICAL VERTICAL DATUM OF 1929, (N.G.V.D.) AND THE NORTH ATLANTIC VERTICAL DATUM OF 1988 (N.A.V.D. 88).
4. WATER & SEWER SERVICE IS PROVIDED BY THE CITY OF MARGATE.

**II. PRECONSTRUCTION RESPONSIBILITIES**

1. UPON THE RECEIPT OF THE "NOTICE TO PROCEED", THE CONTRACTOR SHALL CONTACT THE ENGINEER OF RECORD AND ARRANGE A PRECONSTRUCTION CONFERENCE TO INCLUDE ALL INVOLVED GOVERNMENTAL AGENCIES, UTILITY OWNERS, THE OWNER AND THE ENGINEER OF RECORD.
2. THE CONTRACTOR SHALL OBTAIN AN SUNSHINE STATE ONE CALL OF FLORIDA, INC. CERTIFICATION NUMBER AT LEAST 48 HOURS PRIOR TO BEGINNING ANY EXCAVATION, CALL 811.
3. LOCATION OF EXISTING FACILITIES AS SHOWN ON CONSTRUCTION DRAWINGS ARE DRAWN FROM AVAILABLE RECORDS. THE ENGINEER ASSUMES NO RESPONSIBILITY FOR THE ACCURACY OF THE FACILITIES SHOWN OR FOR ANY FACILITY NOT SHOWN. THE CONTRACTOR SHALL VERIFY, IF POSSIBLE, THE ELEVATIONS AND LOCATIONS OF EXISTING FACILITIES PRIOR TO CONSTRUCTION. IF AN EXISTING FACILITY IS FOUND TO CONFLICT WITH THE PROPOSED CONSTRUCTION UPON EXCAVATION, THE CONTRACTOR SHALL IMMEDIATELY NOTIFY THE ENGINEER OF RECORD SO THAT APPROPRIATE MEASURES CAN BE TAKEN TO RESOLVE THE PROBLEM.

**III. INSPECTIONS**

1. THE CONTRACTOR SHALL NOTIFY THE CITY OF COCONUT CREEK ENGINEERING DEPARTMENT, THE ENGINEER OF RECORD, AND ANY OTHER GOVERNMENTAL AGENCIES HAVING JURISDICTION AT LEAST 24 HOURS PRIOR TO BEGINNING CONSTRUCTION AND PRIOR TO APPLICABLE INSPECTIONS.

**IV. TEMPORARY FACILITIES**

- TEMPORARY FACILITIES:**
  1. IT SHALL BE THE CONTRACTOR'S RESPONSIBILITY TO ARRANGE FOR OR SUPPLY TEMPORARY WATER SERVICE, SANITARY FACILITIES AND ELECTRICITY.
- TRAFFIC REGULATION:**
  1. MAINTENANCE OF TRAFFIC IN THE SHALL BE IN ACCORDANCE WITH M.U.T.C.D. THE CONTRACTOR SHALL BE RESPONSIBLE FOR PREPARING AND PROCESSING AN M.O.T. PLAN THROUGH APPLICABLE AGENCIES.
  2. ALL OPEN TRENCHES AND HOLES ADJACENT TO ROADWAYS OR WALKWAYS SHALL BE PROPERLY MARKED AND BARRICADED TO ASSURE THE SAFETY OF BOTH VEHICULAR AND PEDESTRIAN TRAFFIC.
  3. NO TRENCHES OR HOLES NEAR WALKWAYS, IN ROADWAYS OR THEIR SHOULDERS ARE TO BE LEFT OPEN DURING NIGHTTIME HOURS WITHOUT EXPRESS PERMISSION OF THE CITY OF COCONUT CREEK.
  4. IT SHALL BE THE RESPONSIBILITY OF THE CONTRACTOR FOR ANY NECESSARY CONSTRUCTION, PAVEMENT MARKING AND SIGNAGE OR ANY PEDESTRIAN SIGNALIZATION AND/OR SIGNAL MODIFICATION TO ACCOMMODATE AN ALTERNATE SAFE WALK ROUTE.

**V. PROJECT CLOSEOUT**

- CLEANING UP:**
  1. DURING CONSTRUCTION, THE PROJECT SITE AND ALL ADJACENT AREAS SHALL BE MAINTAINED IN A NEAT AND CLEAN MANNER, AND UPON FINAL CLEAN-UP, THE PROJECT SITE SHALL BE LEFT CLEAR OF ALL SURPLUS MATERIAL OR TRASH. THE PAVED AREAS SHALL BE SWEEPED BROOM CLEAN.
  2. THE CONTRACTOR SHALL RESTORE OR REPLACE, WHEN AND AS DIRECTED, ANY PUBLIC OR PRIVATE PROPERTY DAMAGED BY HIS WORK, EQUIPMENT, OR EMPLOYEES, TO A CONDITION AT LEAST EQUAL TO THAT EXISTING IMMEDIATELY PRIOR TO THE BEGINNING OF OPERATIONS. TO THAT END, THE CONTRACTOR SHALL DO, AS REQUIRED, ALL NECESSARY HIGHWAY, DRIVEWAY, WALK AND LANDSCAPING WORK. SUITABLE MATERIALS AND METHODS SHALL BE USED FOR SUCH RESTORATION.
  3. WHERE MATERIAL OR DEBRIS HAS WASHED OR FLOWED INTO OR HAS BEEN PLACED IN WATER COURSES, DITCHES, DRAINS, CATCH BASINS, OR ELSEWHERE AS A RESULT OF THE CONTRACTOR'S OPERATIONS, SUCH MATERIAL OR DEBRIS SHALL BE REMOVED AND SATISFACTORILY DISPOSED OF DURING THE PROGRESS OF THE WORK, AND THE AREA KEPT IN A CLEAN AND NEAT CONDITION.
  4. ALL PROPERTY MONUMENTS OR PERMANENT REFERENCES, REMOVED OR DESTROYED BY THE CONTRACTOR DURING CONSTRUCTION SHALL BE RESTORED BY A STATE OF FLORIDA REGISTERED LAND SURVEYOR AT THE CONTRACTOR'S EXPENSE.
  5. ALL UNPAVED SURFACES DISTURBED AS A RESULT OF CONSTRUCTION ACTIVITIES SHALL BE RESTORED TO A CONDITION EQUAL TO OR BETTER THAN THAT WHICH EXISTED BEFORE THE CONSTRUCTION.
- CLOSE OUT:**
  1. ALL "AS-BUILT" INFORMATION SHALL BE CERTIFIED BY A FLORIDA REGISTERED LAND SURVEYOR.
  2. UPON COMPLETION OF CONSTRUCTION AND PRIOR TO FINAL PAYMENT, THE CONTRACTOR SHALL SUBMIT TO THE ENGINEER OF RECORD ONE COMPLETE SET OF ALL "AS-BUILT" CONTRACT DRAWINGS FOR REVIEW AND APPROVAL. THESE DRAWINGS SHALL BE MARKED TO SHOW "AS-BUILT" CONSTRUCTION CHANGES AND DIMENSIONS, LOCATIONS, AND ELEVATIONS OF ALL IMPROVEMENTS.

**VI. EROSION CONTROL/SWPPP**

1. THE CONTRACTOR IS RESPONSIBLE FOR PREPARING AND IMPLEMENTING A STORMWATER POLLUTION PREVENTION PLAN (SWPPP), INCLUDING BUT NOT LIMITED TO TURBIDITY BARRIERS, SILT FENCE, INLET PROTECTION, WATER MONITORING, ETC.

DATE:	07/20/12
SCALE:	1"=10'
DESIGN BY:	M.C.
DRAWN BY:	M.C.
CHECKED BY:	RWC
APPROVED BY:	RWC
DATE:	
BY:	
DATE:	
BY:	
DATE:	
BY:	

**GRAVEN • THOMPSON AND ASSOCIATES, INC.**  
 ENGINEERS • PLANNERS • SURVEYORS  
 3563 N.W. 53RD STREET, FORT LAUDERDALE, FLORIDA 33309  
 TEL.: (954) 739-6400  
 FAX: (954) 739-6409  
 FLORIDA LICENSED ENGINEERING, SURVEYING & MAPPING BUSINESS NO. 271  
 FLORIDA LICENSED LANDSCAPE ARCHITECTURE BUSINESS NO. C00014

NATIONAL ARCHITECTURE NUMBER IS THE PROPERTY OF GRAVEN THOMPSON & ASSOCIATES, INC. AND SHALL NOT BE REPRODUCED OR TRANSMITTED IN ANY FORM OR BY ANY MEANS, ELECTRONIC OR MECHANICAL, INCLUDING PHOTOCOPYING, RECORDING, OR BY ANY INFORMATION STORAGE AND RETRIEVAL SYSTEM.

**STRADA**  
**BLDG 'C' VAULT ADDITION**  
 PREPARED FOR:  
**1ST LINE ONCOLOGY**  
**SITE ENGINEERING PLAN**

Robert M. Connors  
 Florida P.E. No. 41863  
 MAR 27 2012  
 PROJECT NO.  
**05-0061**

**C-1**  
 SHEET \_\_\_ OF \_\_\_