

PLANT SCHEDULE

TREES	QTY	COMMON NAME	BOTANICAL NAME	CONT	SIZE	NATIVE	REMARKS
CE	1	Silver Buttonwood	Conocarpus erectus seneceus	B # B	8' - 10' Ht.	Yes	2" Cal., 4'-6" Sprd., Full
IE	3	East Palatka Holly	Ilex x attenuata 'East Palatka'	B # B	8' - 10' Ht.	Yes	2" Cal., 4'-6" Sprd., Full

PALM TREES	QTY	COMMON NAME	BOTANICAL NAME	CONT	SIZE	NATIVE	REMARKS
AC	2	Paurotis Palm	Accolorrhaphe wrightii	B # B	10' O.A. HT	Yes	Full
SP	3	Cabbage Palmetto	Sabal palmetto	B # B	8', 10' x 12' CT	Yes	Slick, Staggered Heights

ACCENTS	QTY	COMMON NAME	BOTANICAL NAME	CONT	SIZE	NATIVE	REMARKS
TI	32	Black Magic Ti	Cordyline fruticosa 'Black Magic'	7 gal	3'-4' Ht.	No	Full, 3 Plants per pot
SR	13	Bird Of Paradise	Strelitzia reginae	7 gal	3'-4' Ht.	No	Full, 3 Plants per pot

SHRUB AREAS	QTY	COMMON NAME	BOTANICAL NAME	CONT	SIZE	NATIVE	SPACING	REMARKS
CHR	107	Red Tip Cocoplum	Chrysobalanus icaco 'Red Tip'	3 gal	24" Ht. x 24" Sprd.	Yes	24" o.c.	Full
HLD	19	Lady Di Heliconia	Heliconia psittacorum 'Lady Di'	3 gal	18" Ht. x 18" Sprd.	No	24" o.c.	Full

GROUND COVERS	QTY	COMMON NAME	BOTANICAL NAME	CONT	SIZE	NATIVE	SPACING	REMARKS
DIA	44	Flax Lily	Dianella tasmanica 'Vanegata'	3 gal	12" Ht. x 12" Sprd.	No	18" o.c.	Full
HAM	78	Dwarf Scarlet Bush	Hamelia patens 'Compacta'	3 gal	12" Ht. x 12" Sprd.	Yes	18" o.c.	Full
ILX	84	Dwarf Yaupon	Ilex vomitoria 'Nana'	3 gal	12" Ht. x 12" Sprd.	Yes	18" o.c.	Full
ZAM	65	Coontie	Zamia pumila	3 gal	12" Ht. x 12" Sprd.	Yes	18" o.c.	Full

SOD St. Augustine 'Floritam' Stenotaphrum secundatum Solid Sod, Sq. Ft. to be determined by land contractor

- PLANT SCHEDULE SATISFIES 50% MIN. NATIVE REQUIREMENTS.
 100% OF ALL TREES/PALMS, 63% OF ALL SHRUBS/ACCENTS, AND 84% OF ALL GROUNDCOVERS ARE NATIVE SPECIES.

EXISTING TABULAR TREE LIST

POINT	SIZE	SPREAD	HEIGHT	TYPE
622	16"	24	28	OAK
623	20"	35	28	OAK
624	20"	30	30	OAK
625	9	20	24	QUEEN PALM
626	9	20	24	QUEEN PALM
627	14	20	18	QUEEN PALM
628	9	20	2	QUEEN PALM
629	12	20	24	QUEEN PALM
630	10	20	22	QUEEN PALM
631	10	20	20	QUEEN PALM
632	10	20	20	QUEEN PALM
825	10	18	25	TABEBUIA
828	8	18	20	TABEBUIA
850	10	12	23	FOX TAIL PALM
851	10	12	23	FOX TAIL PALM
1133	14	30	30	OAK
1134	14	30	25	OAK
1135	14	30	28	OAK
1136	14	30	28	OAK
1137	14	30	28	OAK

EXISTING LANDSCAPE SCHEDULE

CODE	Botanical Name	Common Name	Remarks
CRI	CRINUM AUGUSTUM	CRINUM LILY	Existing To Remain
FIC	FICUS NITIDA	FICUS	Existing To Remain
LIR	LIRIOPE MUSCARI 'EVERGREEN GIANT'	LIRIOPE	Existing To Remain
JAS	JASMINUM VOLLUBLE	WAX JASMINE	Existing To Remain
VIB	VIBURNUM ODORTISSIMUM	SWEET VIBURNUM	Existing To Remain

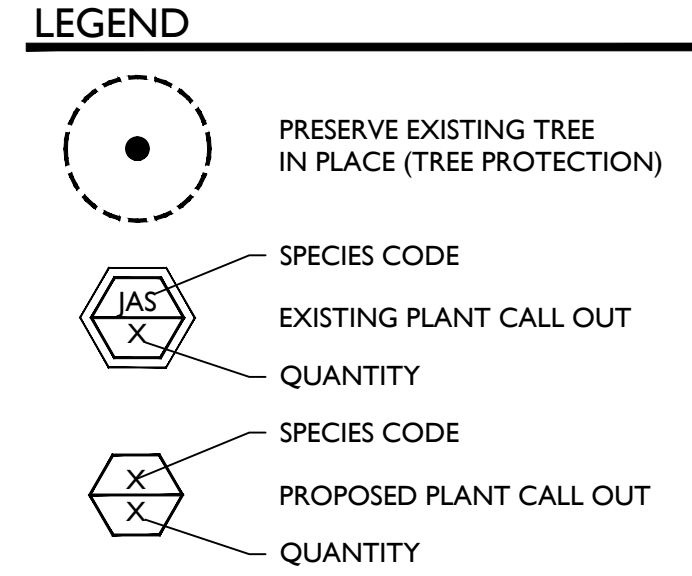

IRRIGATION NOTE

- EXISTING IRRIGATION SYSTEM TO BE REPAIRED/REPLACED AS NEEDED. IRRIGATION IS REQUIRED PROVIDING 100% COVERAGE WITH A MAXIMUM OF 50% OVERLAP. AN AUTOMATIC RAIN SENSOR MUST BE INCLUDED.

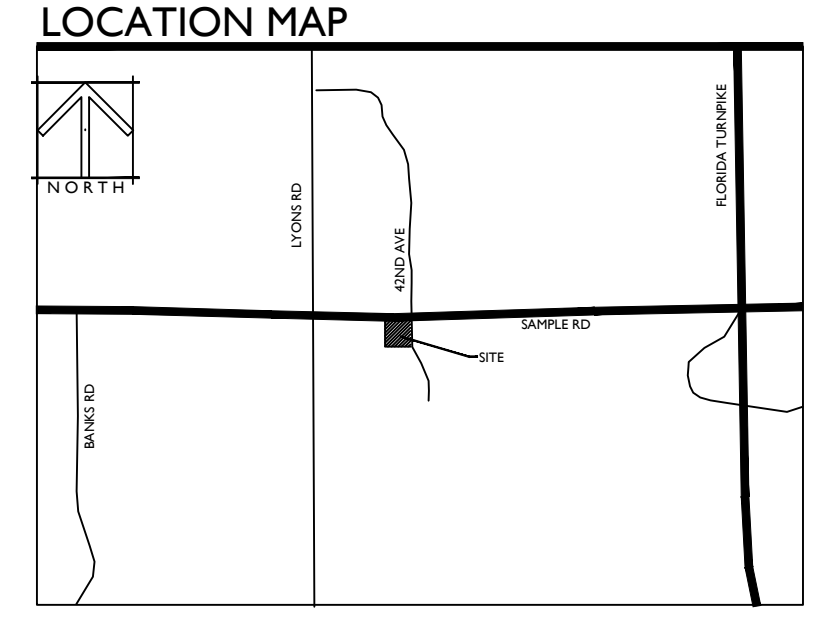

REVISION DATES

DATE	APPROVAL	NOTES
1-27-2014		INITIAL PREPARATION
2-27-2014		REVISIONS TO ADDRESS CITY COMMENTS

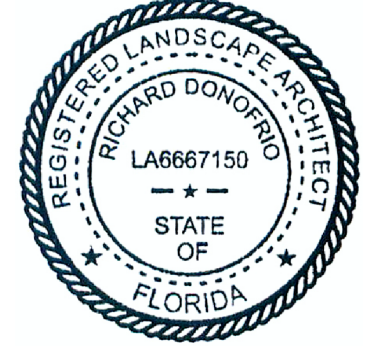

"ALL DRAWINGS, SPECIFICATIONS AND RELATED DOCUMENTS ARE THE COPYRIGHT PROPERTY OF THE LANDSCAPE ARCHITECT AND MUST BE RETURNED UPON REQUEST. REPRODUCTION OF DRAWINGS, SPECIFICATIONS AND RELATED DOCUMENTS IN PART OR IN WHOLE IS FORBIDDEN WITHOUT THE LANDSCAPE ARCHITECT'S WRITTEN PERMISSION."

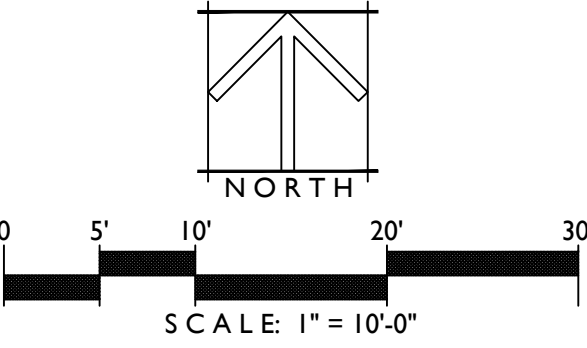

DRAWN BY: LHT
 DRAWING #: 2014-02-27_LSC_1066.52.dwg
 FILE #: 1066.52

SMALL PALM STAKING PLAN

NOTE:
1. APPLICABLE TO ALL PALMS WITH CALIPER SIZE OF LESS THAN SIX (6) INCHES.
2. ALL TREE SUPPORTS MATERIALS ARE TO BE REMOVED FROM EACH TREE ONCE IT IS ESTABLISHED, TYPICALLY SIX MONTHS FOR SHADE TREES OR ONE YEAR FOR PALMS.

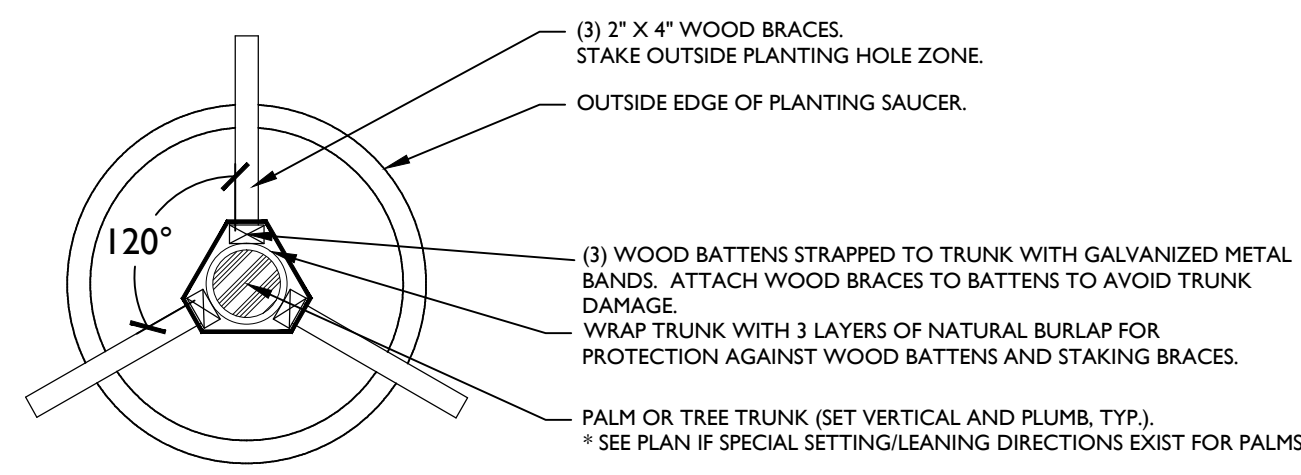

NTS.

LARGE PALM OR TREE STAKING PLAN

NOTE:
1. APPLICABLE TO ALL MULTI-TRUNK PALMS AND PALMS WITH CALIPER SIZE OF SIX (6) INCHES OR GREATER.
2. ALL TREE SUPPORTS MATERIALS ARE TO BE REMOVED FROM EACH TREE ONCE IT IS ESTABLISHED, TYPICALLY SIX MONTHS FOR SHADE TREES OR ONE YEAR FOR PALMS.

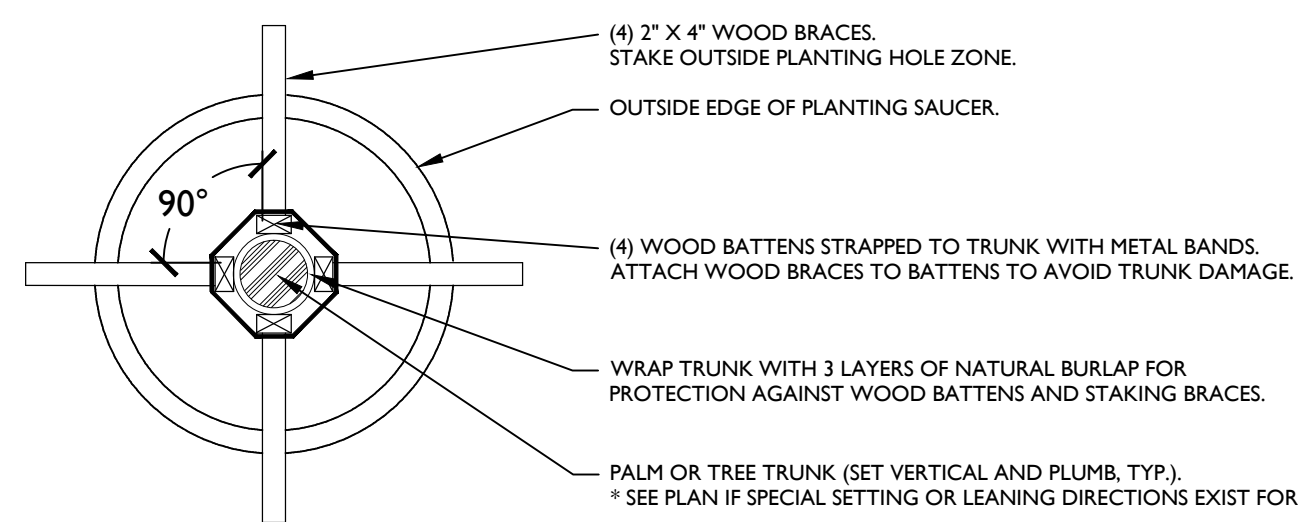

NTS.

PALM PLANTING DETAIL

NTS.

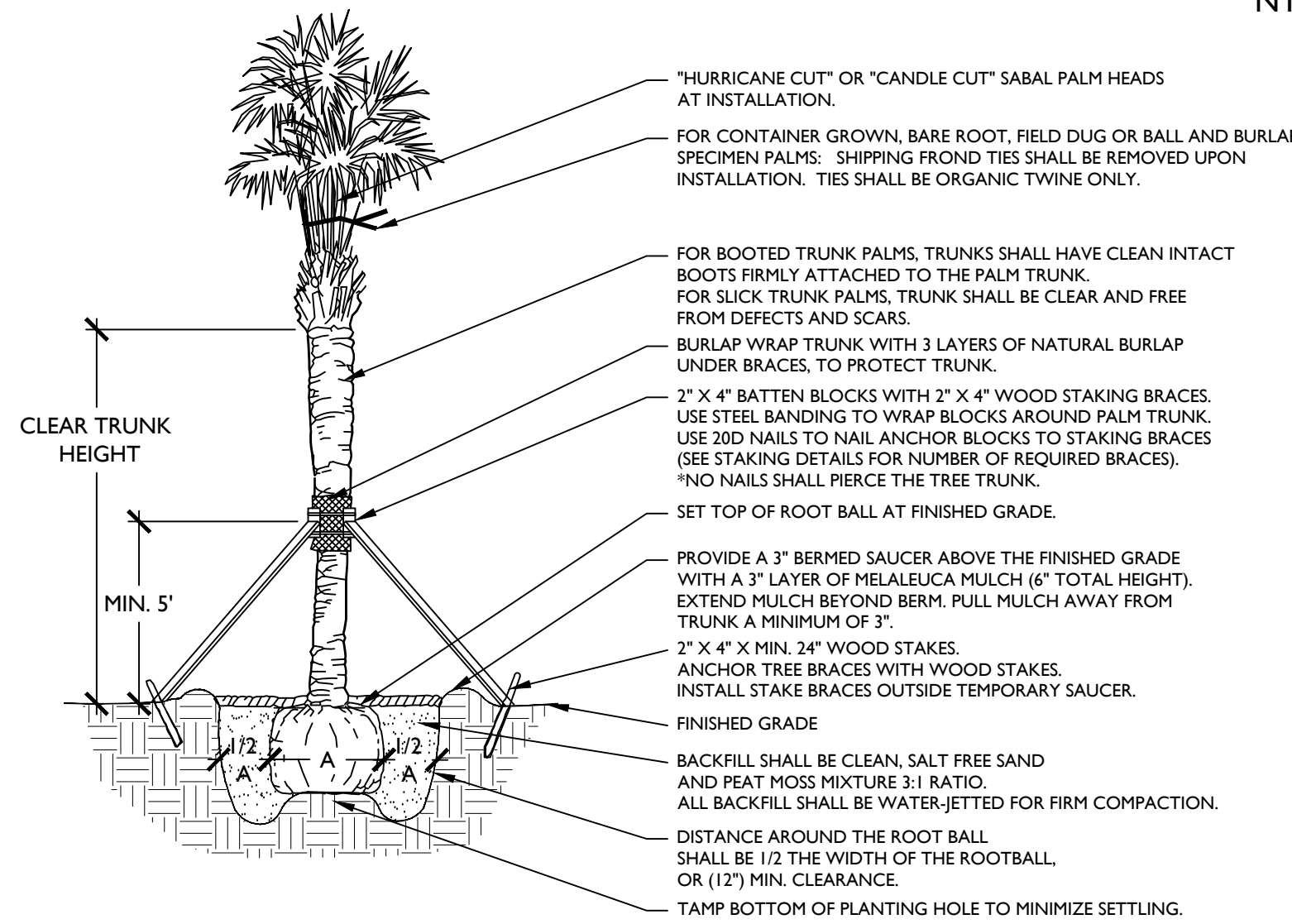

TREE PLANTING DETAIL

NOTE:
1. ALL TREE SUPPORT MATERIALS ARE TO BE REMOVED FROM EACH TREE ONCE IT IS ESTABLISHED, TYPICALLY SIX MONTHS TO ONE YEAR AFTER PLANTING FOR SHADE TREES.

NTS.

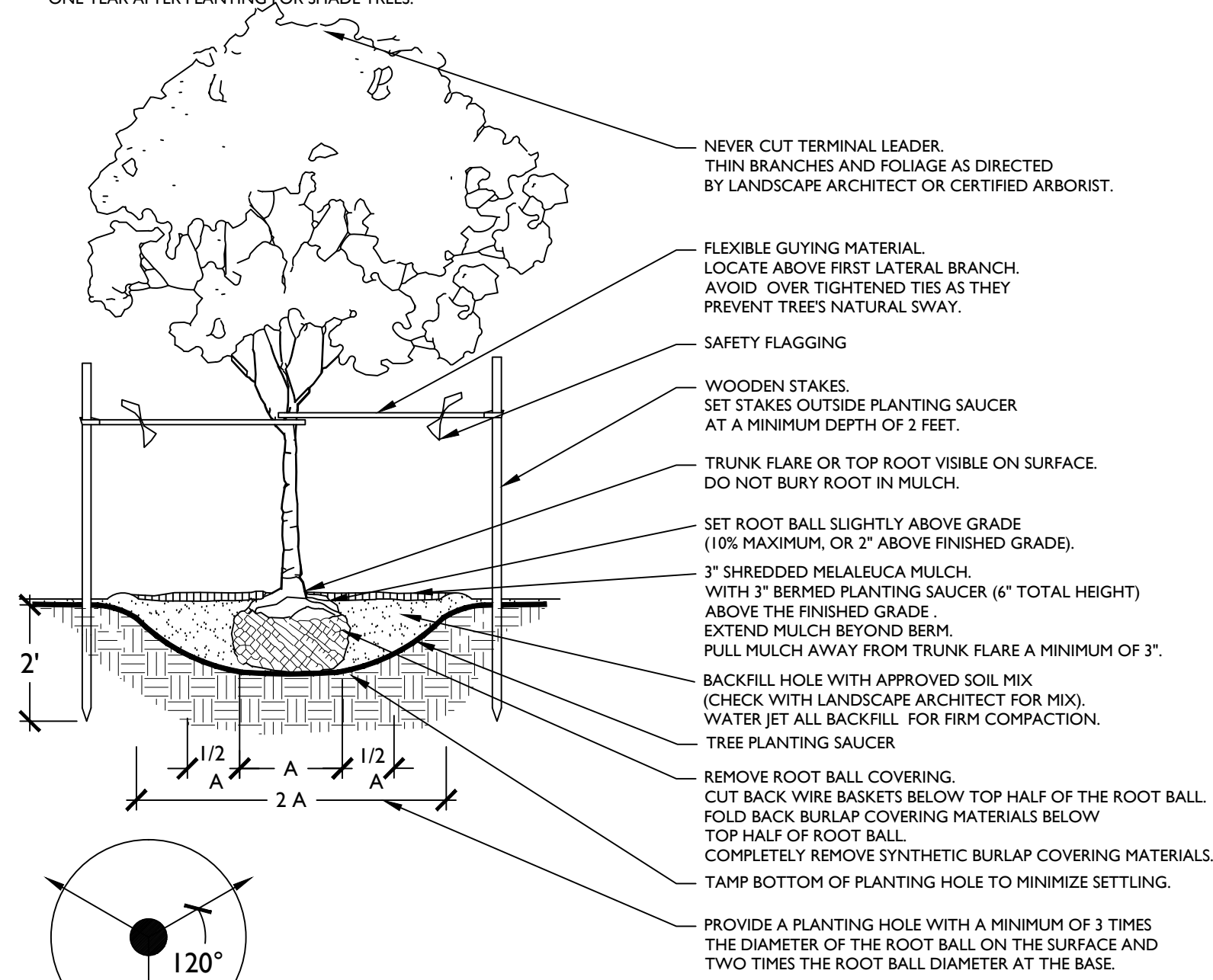

STAKING PLAN DIAGRAM

GROUND COVER DETAIL

NTS.

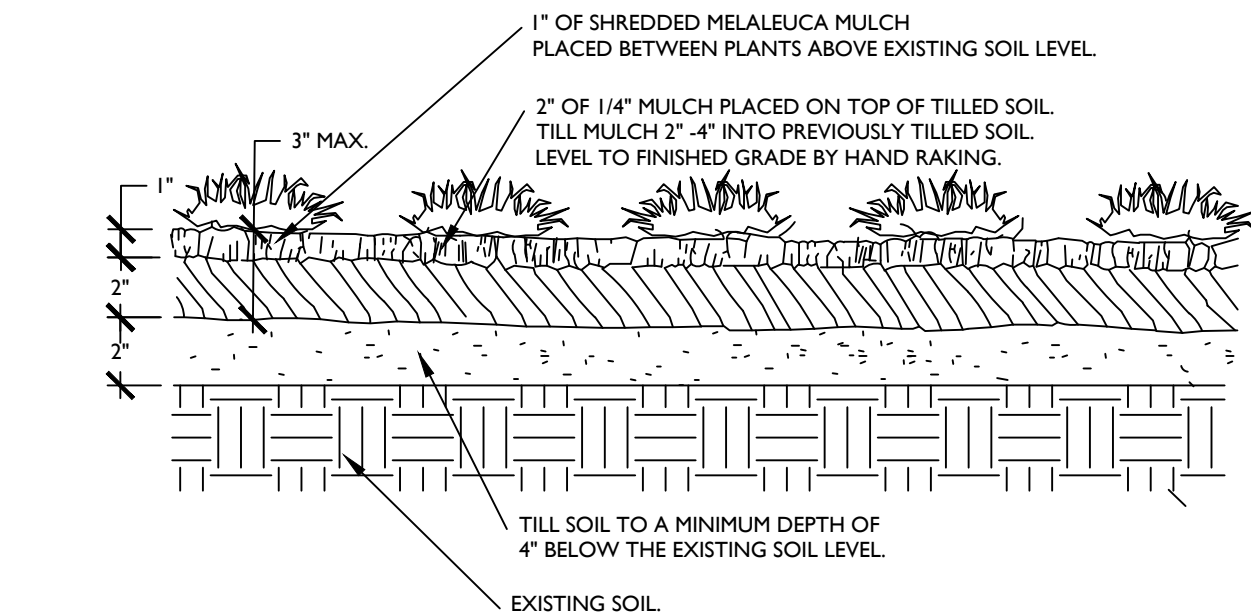

TREE PROTECTION DETAIL

NOTE: THIS DETAIL APPLIES TO ALL TREES THAT WILL BE PRESERVED IN PLACE OR BE RELOCATED.

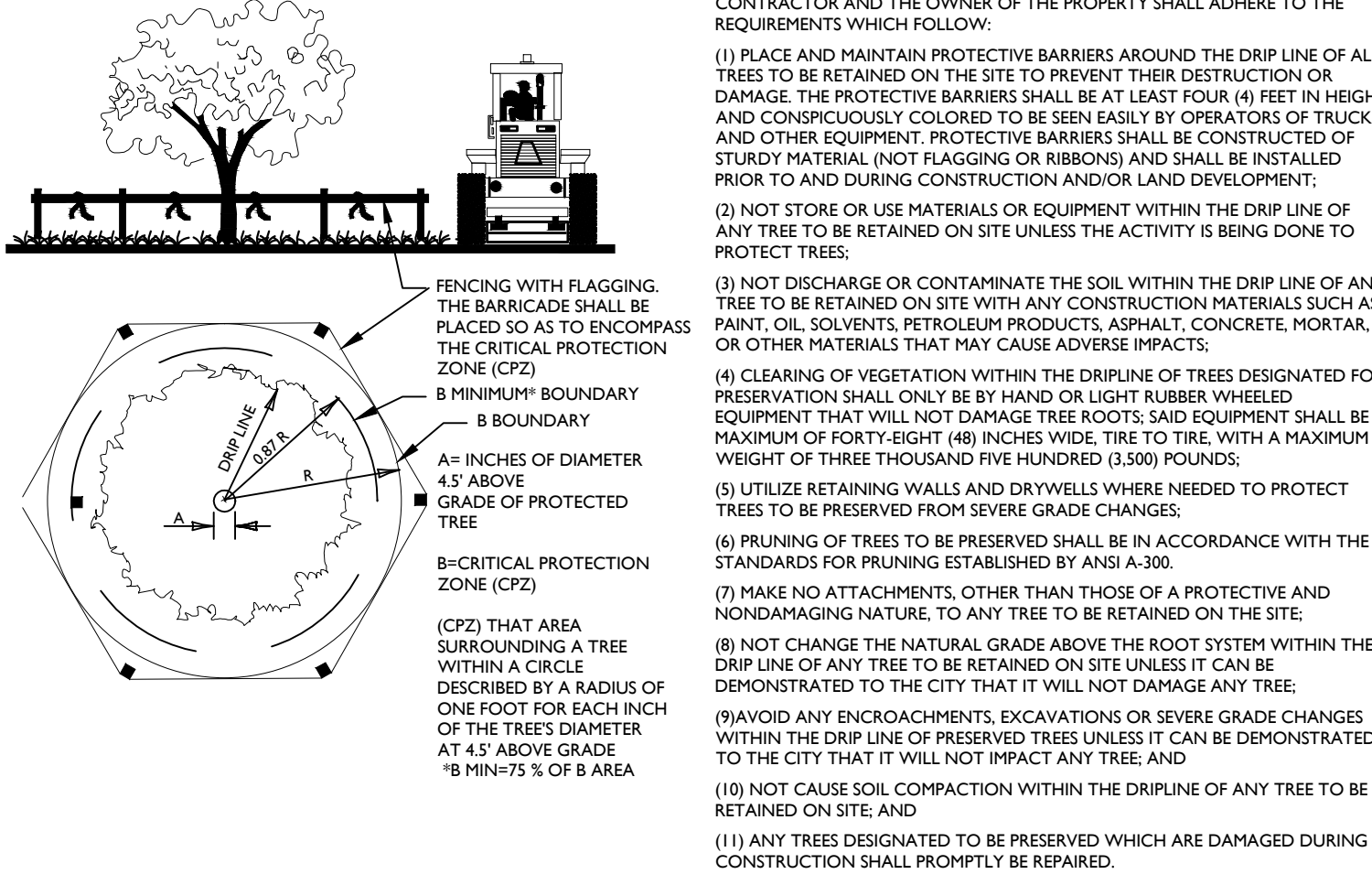

NTS.

DURING ANY CONSTRUCTION, LAND DEVELOPMENT OR LOT CLEARING, THE CONTRACTOR AND THE OWNER OF THE PROPERTY SHALL ADHERE TO THE REQUIREMENTS WHICH FOLLOW:
(1) PLACE AND MAINTAIN PROTECTIVE BARRIERS AROUND THE DRIP LINE OF ALL TREES TO BE RETAINED ON THE SITE TO PREVENT THEIR DESTRUCTION OR DAMAGE. THE PROTECTIVE BARRIERS SHALL BE AT LEAST FOUR (4) FEET IN HEIGHT AND CONSPICUOUSLY COLORED TO BE SEEN EASILY BY OPERATORS OF TRUCKS AND OTHER EQUIPMENT. PROTECTIVE BARRIERS SHALL BE CONSTRUCTED OF STURDY MATERIAL (NOT FLAGGING OR RIBBONS) AND SHALL BE INSTALLED PRIOR TO AND DURING CONSTRUCTION AND/OR LAND DEVELOPMENT.
(2) NOT STORE OR USE MATERIALS OR EQUIPMENT WITHIN THE DRIP LINE OF ANY TREE TO BE RETAINED ON SITE UNLESS THE ACTIVITY IS BEING DONE TO PROTECT TREES.
(3) NOT DISCHARGE OR CONTAMINATE THE SOIL WITHIN THE DRIP LINE OF ANY TREE TO BE RETAINED ON SITE WITH ANY CONSTRUCTION MATERIALS SUCH AS PAINT, OIL, SOLVENTS, PETROLEUM PRODUCTS, ASPHALT, CONCRETE, MORTAR, OR OTHER MATERIALS THAT MAY CAUSE ADVERSE IMPACTS.
(4) CLEARING OF VEGETATION WITHIN THE DRIP LINE OF TREES DESIGNATED FOR PRESERVATION SHALL ONLY BE BY HAND OR LIGHT RUBBER WHEELED EQUIPMENT THAT WILL NOT DAMAGE TREE ROOTS. SAID EQUIPMENT SHALL BE A MAXIMUM OF FORTY EIGHT (48) INCHES WIDE, TREE TO TREE, WITH A MAXIMUM WEIGHT OF THREE THOUSAND FIVE HUNDRED (3,500) POUNDS.
(5) UTILIZE RETAINING WALLS AND DRYWELLS WHERE NEEDED TO PROTECT TREES TO BE PRESERVED FROM SEVERE GRADE CHANGES.
(6) PRUNING OF TREES TO BE PRESERVED SHALL BE IN ACCORDANCE WITH THE STANDARDS FOR PRUNING ESTABLISHED BY ANSI A-300.
(7) MAKE NO ATTACHMENTS, OTHER THAN THOSE OF A PROTECTIVE AND NONDAMAGING NATURE, TO ANY TREE TO BE RETAINED ON THE SITE.
(8) NOT CHANGE THE NATURAL GRADE ABOVE THE ROOT SYSTEM WITHIN THE DRIP LINE OF ANY TREE TO BE RETAINED ON SITE UNLESS IT CAN BE DEMONSTRATED TO THE CITY THAT IT WILL NOT DAMAGE ANY TREE.
(9) AVOID ANY ENCROACHMENTS, EXCAVATIONS OR SEVERE GRADE CHANGES WITHIN THE DRIP LINE OF PRESERVED TREES UNLESS IT CAN BE DEMONSTRATED TO THE CITY THAT IT WILL NOT IMPACT ANY TREE; AND
(10) NOT CAUSE SOIL COMPACTION WITHIN THE DRIP LINE OF ANY TREE TO BE RETAINED ON SITE; AND
(11) ANY TREES DESIGNATED TO BE PRESERVED WHICH ARE DAMAGED DURING CONSTRUCTION SHALL PROMPTLY BE REPAIRED.

PLANT SPACING DETAIL

NTS.

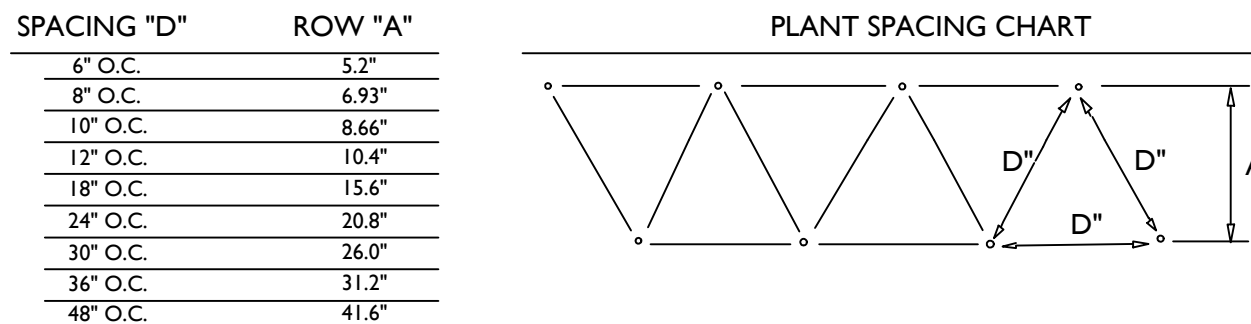

SHRUB PLANTING DETAIL

NTS.

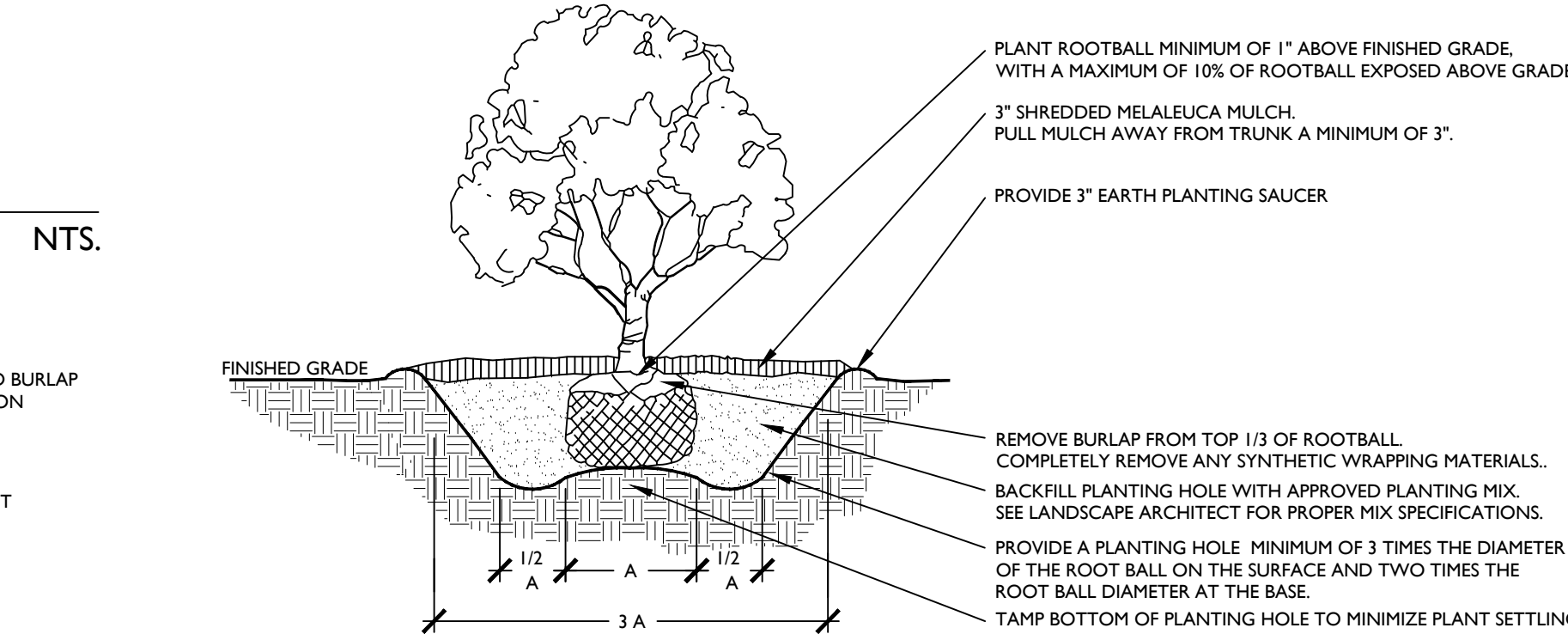

ROOT BARRIER DETAIL

NOTE:
1. TREES ARE TO BE INSTALLED WITH A MINIMUM TEN FOOT (10') SEPARATION FROM ANY PUBLIC WATER OR PUBLIC SEWER MAIN AND/OR SERVICE HYDRANTS, AND LIFT STATIONS. IF A TEN FOOT (10') SEPARATION CANNOT BE ACHIEVED, THE TREE SHALL BE INSTALLED WITH A ROOT BARRIER SYSTEM.
2. ROOT BARRIERS SHALL COMPLY WITH ALL REQUIREMENTS OF THE MUNICIPALITY WITHIN WHICH THEY ARE LOCATED AS WELL AS WITH ANY REQUIREMENTS OF THE UTILITY HOLDER OF THE AFFECTED UTILITIES. IN THE EVENT THAT CONFLICTING REQUIREMENTS EXIST BETWEEN THIS ROOT BARRIER DETAIL AND THE MUNICIPALITY/UTILITY HOLDER REQUIREMENTS, THE MORE STRINGENT OF THE REQUIREMENTS SHALL BE APPLICABLE.

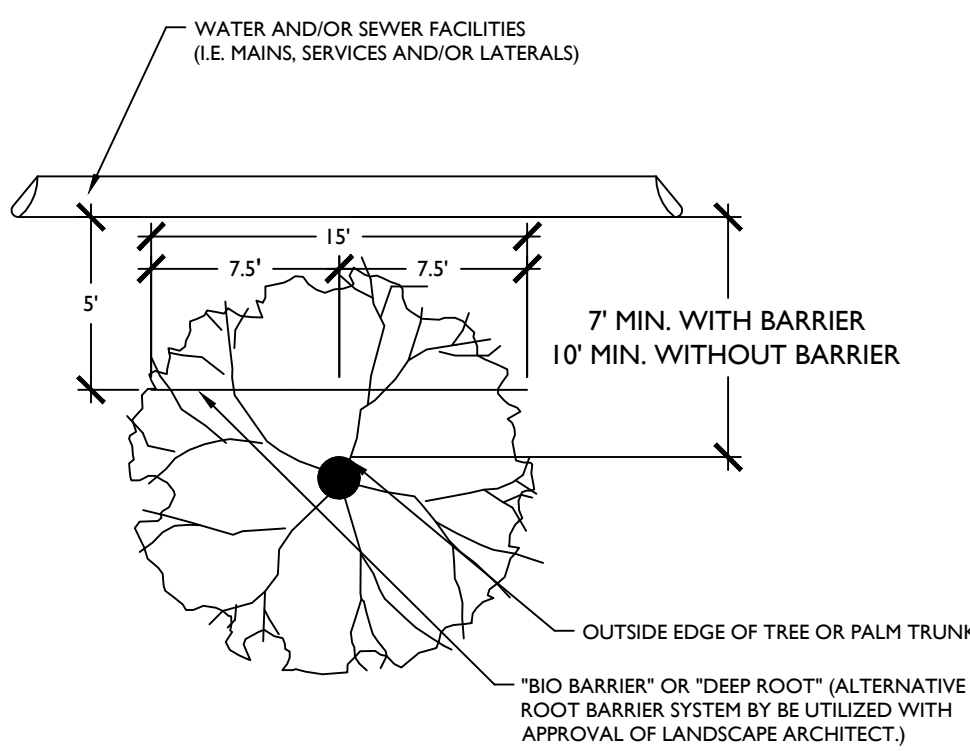
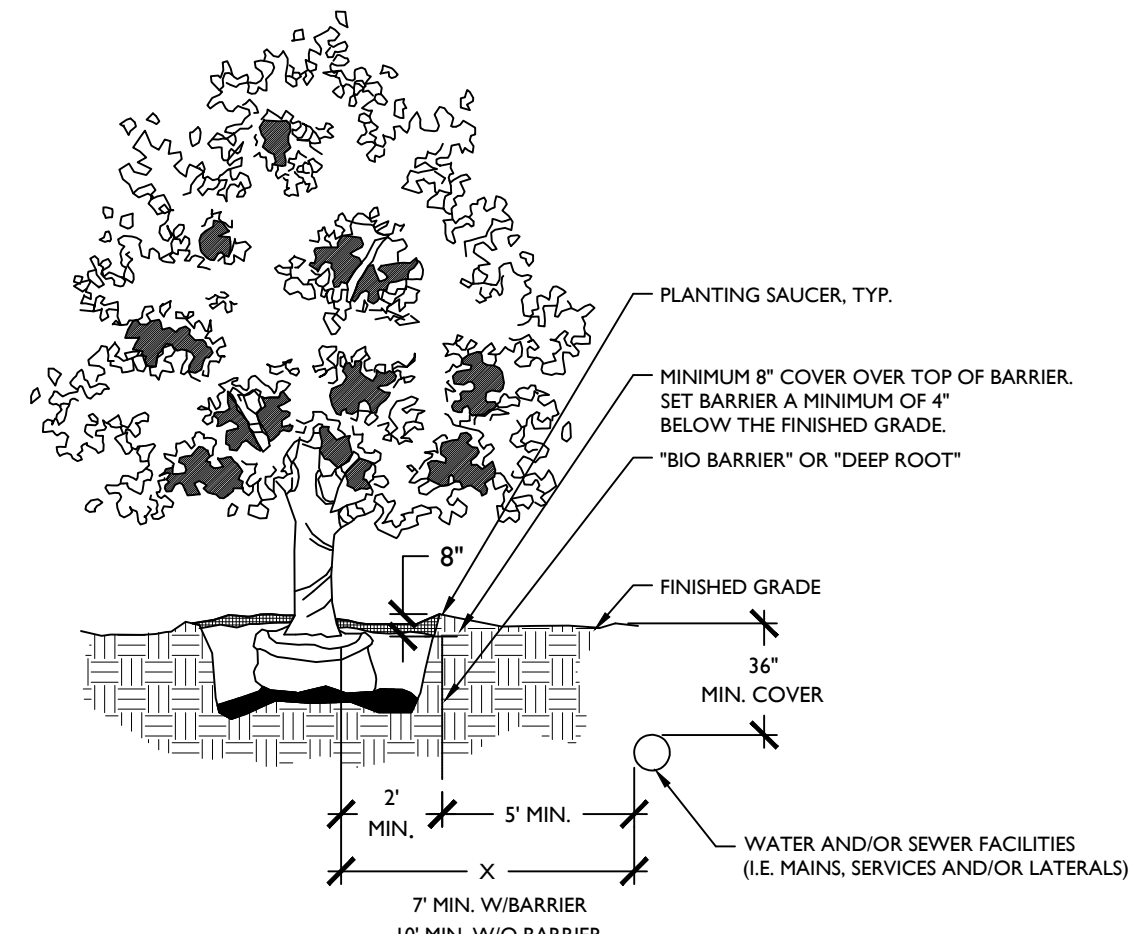

TYPICAL PLANTING DIAGRAM

NTS.

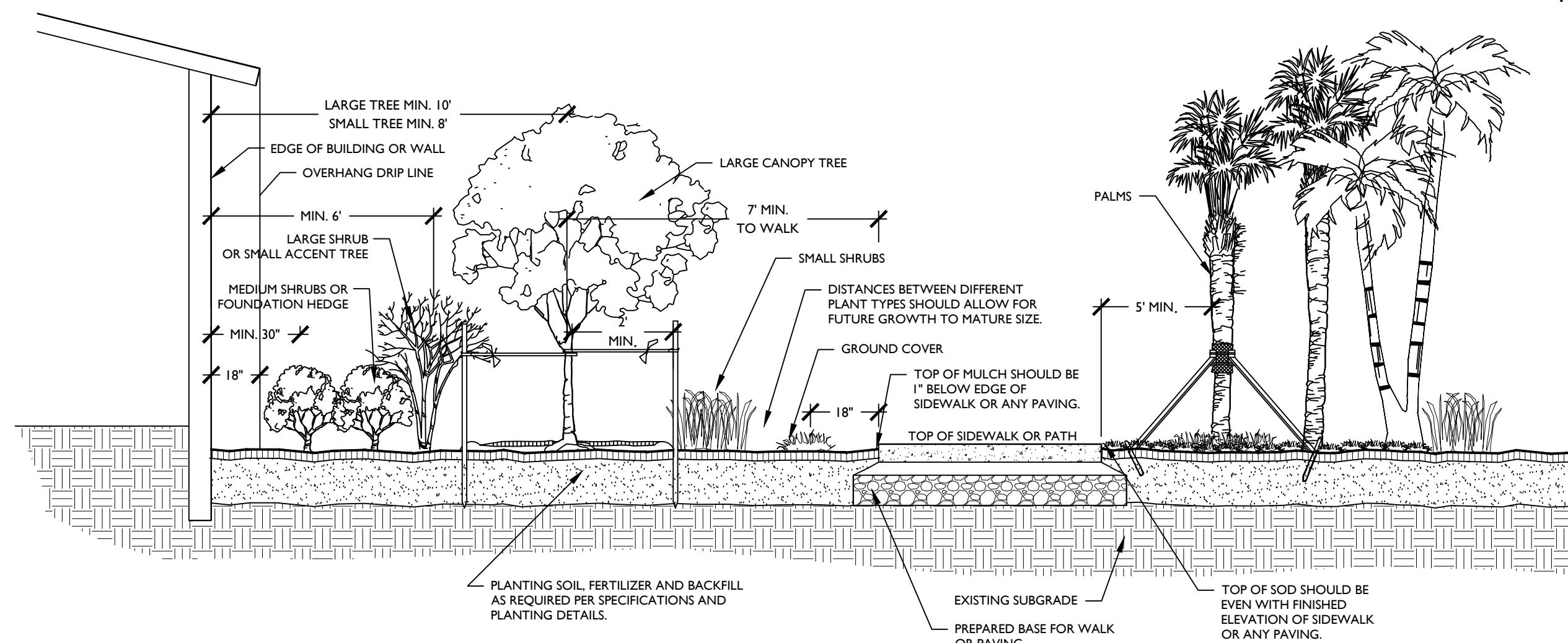

SHRUB AND GROUND COVER PLANTING DETAIL

NTS.

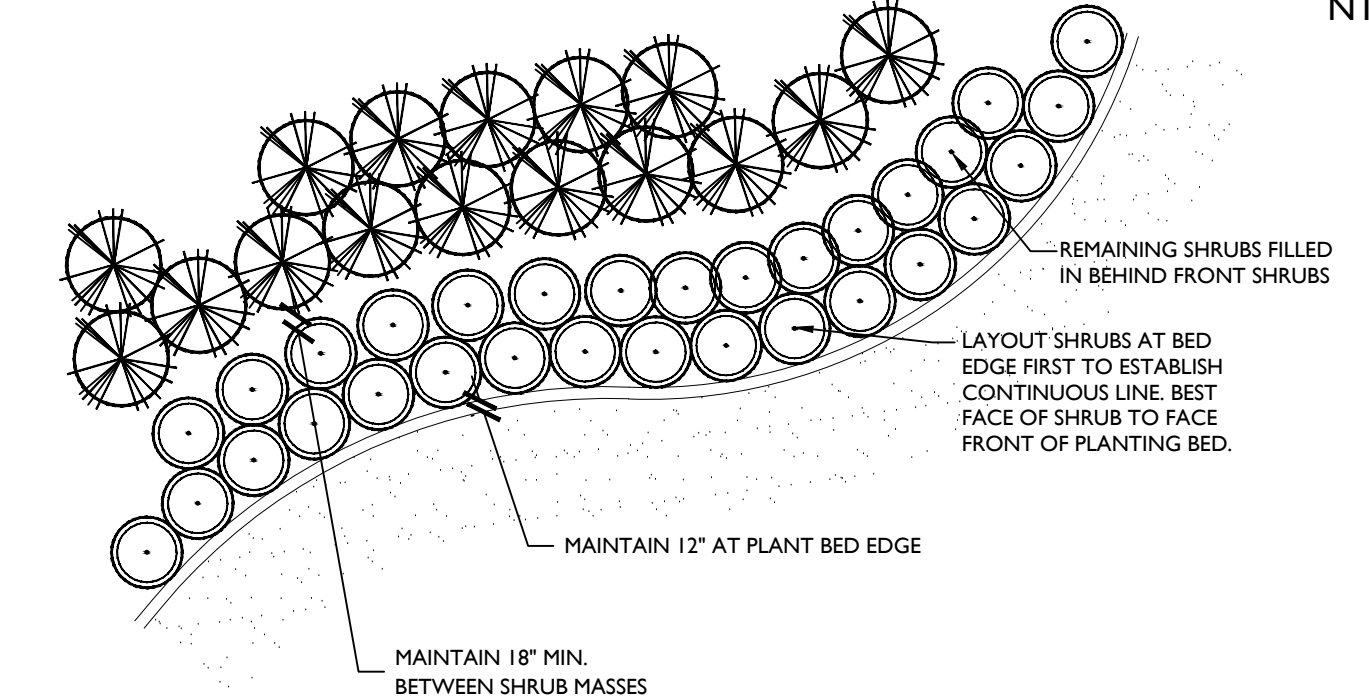

CITY OF COCONUT CREEK STANDARD LANDSCAPE NOTES

- ALL LANDSCAPE AND SPECIFICATIONS SHALL MEET OR EXCEED THE MINIMUM REQUIREMENTS AS PROVIDED IN THE CITY OF COCONUT CREEK LAND DEVELOPMENT CODE. PLANS ARE INCOMPLETE WITHOUT WRITTEN NOTES AND SPECIFICATIONS.
- ALL PLANTING MATERIAL SHALL MEET OR EXCEED FLORIDA GRADE #1 AS SPECIFIED IN GRADES AND STANDARDS FOR NURSERY PLANTS, CURRENT EDITION. TREES SHALL NOT BE TIPPED, TOPPED, OR SHAPED PRIOR TO INSTALLATION.
- LANDSCAPE SHALL BE PLACED TO EDGE OF ABUTTING STREETS, CANALS, LAKES OR OTHER LANDS.
- ALL MECHANICAL EQUIPMENT, AIR CONDITIONING, IRRIGATION PUMP STATIONS AND EQUIPMENT, FPL TRANSFORMERS, POOL PUMPS, ETC., MUST BE SCREENED ON THREE (3) SIDES BY LANDSCAPE SHRUBS. NOTE: THE QUANTITY OF SCREENING SHRUBS IS IN ADDITION TO THE REQUIRED NUMBER OF SHRUBS AS PROVIDED IN THE CODE CALCULATION TABLE. ALL SCREENING SHRUBS SHALL BE PLANTED FOR PROPER OPERATION OF EQUIPMENT BEING SCREENED AND/OR PER THE REQUIREMENTS OF THE UTILITY AS NECESSARY. ALL HEDGE MATERIAL REQUIRED FOR SCREENING PURPOSES SHALL BE PLANTED WITH BRANCHES TOUCHING. ADJUST ON-CENTER SPACING AS NECESSARY AND/OR PROVIDE ADDITIONAL PLANTS TO PROVIDE AN ADEQUATE SCREEN.
- SIGHT DISTANCE CONCERNS MUST BE MAINTAINED FOR CLEAR SIGHT VISIBILITY FROM THIRTY (30) INCHES TO SEVENTY-TWO INCHES, TREE TRUNKS EXCLUDED. MEASUREMENT SHALL BE MADE FROM TOP OF ROOT BALL PLANTED AT PROPER ELEVATION.
- GUYING/STAKING PRACTICES SHALL NOT PERMIT NAILS, SCREWS, WIRES, ETC., TO PENETRATE OUTER SURFACES OF TREES, PALMS OR OTHER PLANT MATERIAL. TREES, PALMS AND PLANT MATERIAL REJECTED DUE TO THIS PRACTICE SHALL BE REPLACED WITH THE INSPECTOR ON SITE.
- BURLAP MATERIAL, WIRE CAGES, PLASTIC/CANVAS STRAPS, ETC., MUST BE CUT AND REMOVED FROM THE TOP ONE HALF (1/2) DEPTH OF THE ROOT BALL. TREES AND SHRUBS GROWN IN GROW BAGS OR GROW BAG TYPE MATERIAL MUST HAVE SUCH MATERIAL REMOVED ENTIRELY PRIOR TO PLANTING THE TREE OR SHRUB.
- ALL PLANT MATERIAL SHALL BE FREE OF PESTS, INSECTS, DISEASE, WEEDS, ETC.
- ALL REQUIRED LANDSCAPE MATERIAL SHALL BE INSTALLED USING A PLANTING SOIL MIX COMPRISED OF A TYPE APPROPRIATE TO THE INDIVIDUAL PROPOSED PLANT MATERIAL AND THE NATIVE SOIL FOUND ON THE SITE.
- ALL PLANT MATERIAL SHALL BE PLANTED AT THE PROPER DEPTH, AS ORIGINALLY GROWN AND/OR SO THE TOP OF THE ROOT BALL IS FLUSH OR SLIGHTLY ABOVE FINISHED GRADE IMMEDIATELY AFTER PLANTING. ALL TREES SHOULD PROVIDE TRUNK TAPER WHEN PROPERLY PLANTED AT THE CORRECT PLANTING DEPTH.
- ALL PLANT MATERIAL SHALL BE WATERED IN AT TIME OF PLANTING TO ELIMINATE AIR POCKETS IN THE ROOT ZONE AREA.
- COLOR-TREATED OR DYED MULCH WILL NOT BE ACCEPTED.
- UPON COMPLETION OF WORK, THE SITE SHALL BE CLEARED OF ALL DEBRIS, SUPERFLUOUS MATERIALS, AND EQUIPMENT CAUSED BY THIS PERMIT TO THE SATISFACTION OF THE INSPECTOR.
- REFER TO COCONUT CREEK FIRE EQUIPMENT CLEAR ZONE DIAGRAM TO MAINTAIN A SAFE ZONE FRONTING FIRE HYDRANTS.
- DO NOT PLANT TREES, SHRUBS OR GROUND COVER WITHIN ELECTRIC METER CLEAR ZONE. PROVIDE A SAFE ZONE AS DESCRIBED BY THE ELECTRICAL INSPECTOR.
- ALL LANDSCAPED AREAS SHALL BE PROVIDED WITH AN UNDERGROUND FULLY AUTOMATIC IRRIGATION SYSTEM USING POP-UP SPRINKLERS. SYSTEM SHALL PROVIDE 100% COVERAGE WITH A 50% OVERLAP (MINIMUM) USING RUST FREE WATER, EXCEPT PRESERVED AREAS REMAINING IN NATURAL STATE. A RAIN SENSOR DEVICE OR SWITCH SHALL BE INSTALLED THAT WILL OVERRIDE THE IRRIGATION SYSTEM WHEN ADEQUATE RAINFALL HAS OCCURRED. WATER SHALL NOT BE DIRECTED AND/OR PROVIDED ONTO IMPERVIOUS SURFACES AND/OR BE DESIGNED OR INSTALLED TO THROW WATER OVER AN IMPERVIOUS SURFACE SUCH AS A SIDEWALK, ETC. HOURS OF OPERATION FOR ALL IRRIGATION SYSTEMS SHALL BE LIMITED TO 5:00 P.M. TO 8:00 A.M. ONLY OR AS MAY BE FURTHER RESTRICTED BY SOUTH FLORIDA WATER MANAGEMENT DISTRICT OR OTHER JURISDICTIONAL AGENCY.
- IRRIGATION PERMITS AND PLANS SHALL BE SUBMITTED FOR APPROVAL AT TIME OF BUILDING PERMITS.
- ALL NON-SINGLE FAMILY OR DUPLEX IRRIGATION SYSTEMS OTHER THAN CITY WATER SYSTEMS SHALL REQUIRE A SOUTH FLORIDA WATER MANAGEMENT DISTRICT WATER USE PERMIT PRIOR TO ISSUANCE OF AN IRRIGATION PERMIT AND INSTALLATION OF THE IRRIGATION SYSTEM AS REQUIRED.
- ALL SITE AMENITIES TO INCLUDE SITE STREET LIGHTS, LANDSCAPE COMMON OPEN SPACE, IRRIGATION COMMON OPEN SPACE, BUFFERS, BERMS, LANDSCAPE ENTRY FEATURES, ETC. LEADING UP TO AND INCLUDING THE MODEL CERTIFICATE OF OCCUPANCY MUST BE COMPLETED AND FUNCTIONAL PRIOR TO ISSUANCE OF THE FIRST REQUESTED CERTIFICATE OF OCCUPANCY.
- THE HEIGHT OF ALL REQUIRED, DESIGNED AND INSTALLED BERMS SHALL BE FROM THE HIGHEST ADJACENT POINT WHETHER IT IS THE SIDEWALK, PARKING AREA, VEHICULAR USE AREA, SURROUNDING GROUND, ETC. WHERE A BERM ABUTS A SIDEWALK, THERE SHALL BE A ONE (1) FOOT LEVEL SOD AREA ADJACENT TO THE SIDEWALK PRIOR TO THE START OF THE BERM.
- AN INSPECTION IS REQUIRED PRIOR TO THE BACKFILLING OF TREES/PALMS IN ALL PARKING MEDIANS AND ISLANDS.

GENERAL LANDSCAPE NOTES

- STRUCTURAL ELEMENTS AND HARDSCAPE FEATURES INDICATED ON LANDSCAPE PLANS ARE FOR INFORMATIONAL PURPOSES ONLY. LANDSCAPE PLANS ARE TO BE UTILIZED FOR LOCATION OF LIVING PLANT MATERIAL ONLY. LANDSCAPE PLANS SHOULD NOT BE UTILIZED FOR STAKING AND LAYOUT OR LOCATION OF ANY STRUCTURAL SITE FEATURES INCLUDING BUT NOT LIMITED TO: BUILDINGS, SIGNAGE, PATHWAYS, EASEMENTS, BERMS, WALL, FENCES, UTILITIES OR ROADWAYS.
- CONTRACTOR SHALL ACQUIRE ALL APPLICABLE FEDERAL, STATE, LOCAL, JURISDICTIONAL OR UTILITY COMPANY PERMITS REQUIRED PRIOR TO REMOVAL, RELOCATION, AND/OR INSTALLATION OF LANDSCAPE MATERIALS INDICATED WITHIN PLAN DOCUMENTS. THE CONTRACTOR SHALL HAVE PERMITS "IN HAND" PRIOR TO STARTING WORK. LANDSCAPE ARCHITECT SHALL BEAR NO RESPONSIBILITY FOR WORK PERFORMED WITHOUT PERMITTED DRAWINGS. THE CONTRACTOR SHALL BE RESPONSIBLE FOR ALL CHANGES TO THE WORK, AT NO ADDITIONAL COST TO THE OWNER, AS A RESULT OF UNAUTHORIZED WORK PRIOR TO RECEIPT OF PERMIT.
- TREES SHOWN ON THIS PLAN ARE FOR GRAPHIC REPRESENTATION ONLY. TREE SPACING IS BASED ON DESIGN REQUIREMENTS AND THE TREES SHOWN ON THESE PLANS ATTEMPT TO ACCOMPLISH THAT SPACING WHILE MAINTAINING THE REQUIRED SETBACKS FROM UTILITIES. IN THE EVENT OF A CONFLICT, AFFECTED PLANT MATERIAL SHALL BE FIELD ADJUSTED WITH THE APPROVAL OF THE LANDSCAPE ARCHITECT TO AVOID CONFLICTS WITH THE WITH EXISTING AND PROPOSED UTILITIES, LIGHT POLES, DRAINAGE STRUCTURES OR LINES, LAKE MAINTENANCE EASEMENTS OR OTHER AFFECTED SITE FEATURES.
- ANY PLANTING WITHIN THE SIGHT TRIANGLES SHALL PROVIDE UNOBSTRUCTED VIEWS AT A LEVEL BETWEEN 30" AND 8' ABOVE THE PAVEMENT.
- ALL UTILITY BOXES/STRUCTURES TO BE SCREENED ON 3 SIDES W/ APPROVED PLANTING MATERIAL.
- IRRIGATION IS REQUIRED PROVIDING 100% COVERAGE WITH A MAXIMUM OF 50% OVERLAP, AN AUTOMATIC RAIN SENSOR MUST BE INCLUDED.
- ALL PLANT MATERIAL TO BE INSTALLED SHALL CONFORM TO FLORIDA POWER AND LIGHT'S (FPL'S) RIGHT TREE RIGHT PLACE GUIDELINES.
- IN CASE OF DISCREPANCIES PLANS TAKE PRECEDENCE OVER PLANT LIST.
- LANDSCAPE CONTRACTOR RESPONSIBLE FOR VERIFICATION OF ALL QUANTITIES PRIOR TO BIDDING.
- REMOVAL OF EXISTING VEGETATION IS RESPONSIBILITY OF LANDSCAPE CONTRACTOR.
- RELOCATION OF EXISTING VEGETATION IS RESPONSIBILITY OF LANDSCAPE CONTRACTOR. REFER TO SPECIFICATIONS FOR RELOCATION INSTRUCTIONS.



MCDONALD'S 009-1012
LANDSCAPE DETAILS
PREPARED FOR MCDONALD'S CORP.
CITY OF COCONUT CREEK, FL

REVISION DATES		
DATE	APPROVAL	NOTES
1-23-2014		INITIAL PREPARATION
3-27-2014		REVISIONS TO ADDRESS CITY COMMENTS

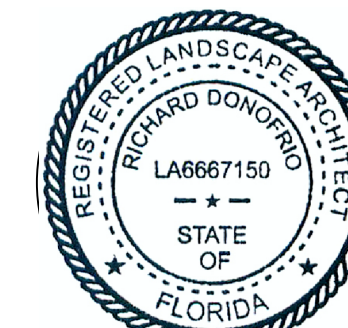

"ALL DRAWINGS, SPECIFICATIONS AND RELATED DOCUMENTS ARE THE COPYRIGHT PROPERTY OF THE LANDSCAPE ARCHITECT AND MUST BE RETURNED UPON REQUEST. REPRODUCTION OF DRAWINGS, SPECIFICATIONS AND RELATED DOCUMENTS IN PART OR IN WHOLE IS FORBIDDEN WITHOUT THE LANDSCAPE ARCHITECT'S WRITTEN PERMISSION."

DRAWN BY: LHT
DRAWING #: 2014-02-27_LSC_1066.52.dwg
FILE #: 1066.52

SHEET #
LP.2

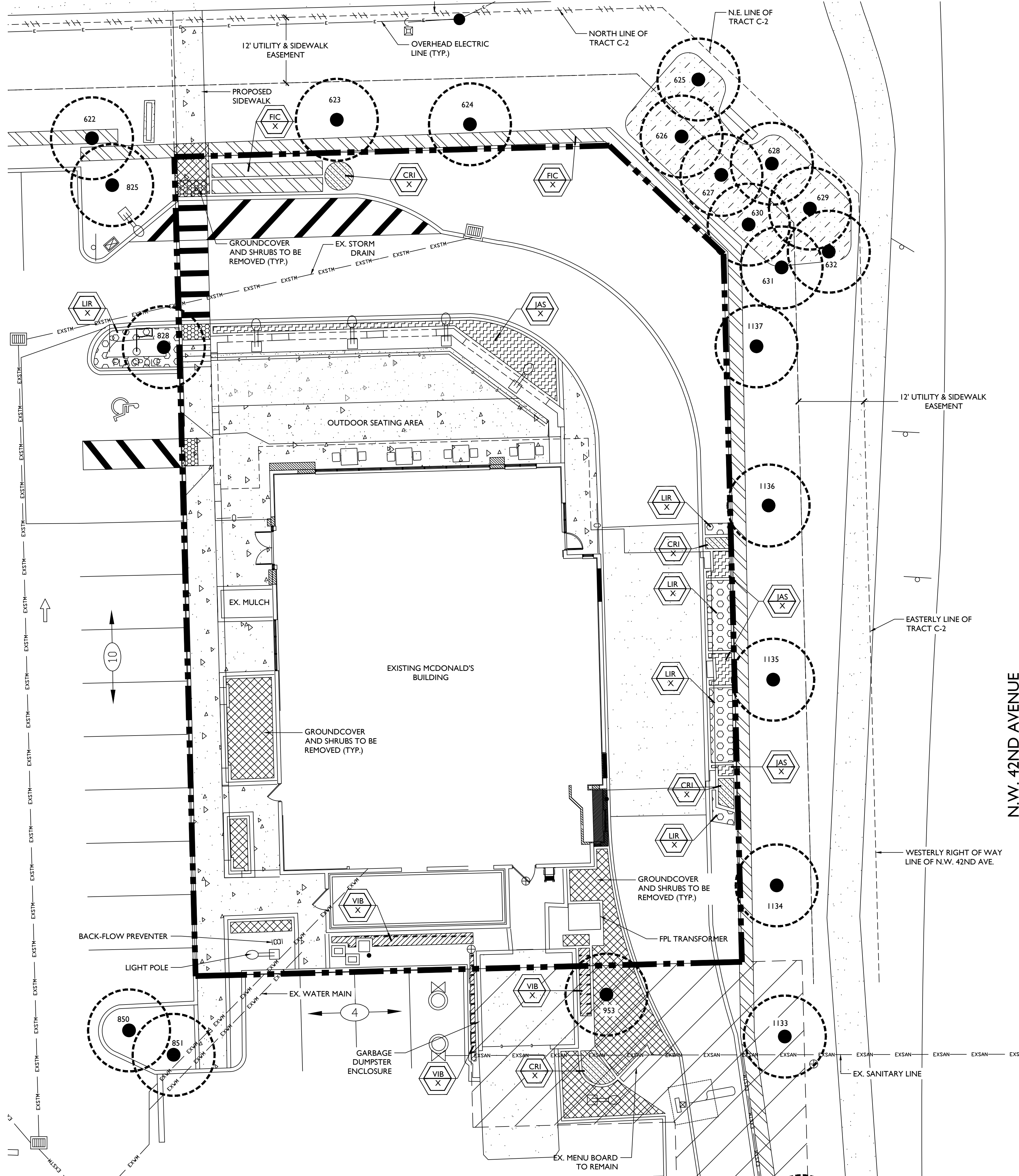

EXISTING TABULAR TREE LIST

POINT	SIZE	SPREAD	HEIGHT	TYPE
622	16"	24	28	OAK
623	20"	35	28	OAK
624	20"	30	30	OAK
625	9	20	24	QUEEN PALM
626	9	20	24	QUEEN PALM
627	14	20	18	QUEEN PALM
628	9	20	2	QUEEN PALM
629	12	20	24	QUEEN PALM
630	10	20	22	QUEEN PALM
631	10	20	20	QUEEN PALM
632	10	20	20	QUEEN PALM
825	10	18	25	TABEBUIA
828	8	18	20	TABEBUIA
850	10	12	23	FOX TAIL PALM
851	10	12	23	FOX TAIL PALM
1133	14	30	30	OAK
1134	14	30	25	OAK
1135	14	30	28	OAK
1136	14	30	28	OAK
1137	14	30	28	OAK

EXISTING LANDSCAPE SCHEDULE

SHRUBS			
CODE	Botanical Name	Common Name	Remarks
CRI	CRINUM AUGUSTUM	CRINUM LILY	Existing To Remain
FIC	FICUS NITIDA	FICUS	Existing To Remain
LIR	LIRIOPE MUSCARI 'EVERGREEN GIANT'	LIRIOPE	Existing To Remain
JAS	JASMINUM VOLLUBLE	WAX JASMINE	Existing To Remain
VIB	VIBURNUM ODORTISSIMUM	SWEET VIBURNUM	Existing To Remain

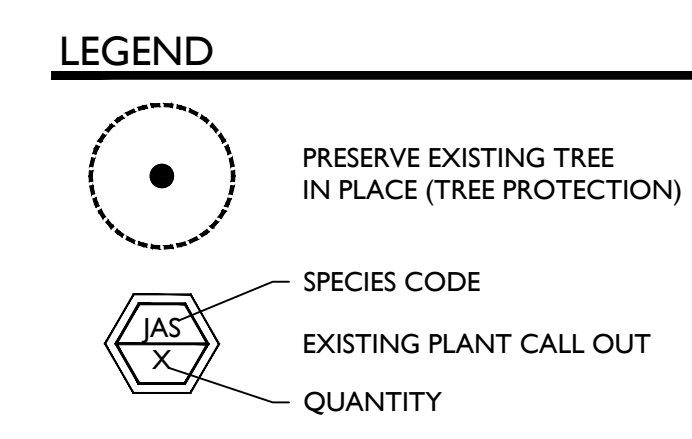

MCDONALD'S 009-1012
EXISTING LANDSCAPE INVENTORY
 PREPARED FOR MCDONALD'S CORP.
 CITY OF COCONUT CREEK, FL

REVISION DATES

DATE	APPROVAL	NOTES
1/27/2014		INITIAL PREPARATION
1/30/2014		REVISIONS TO ADDRESS CITY COMMENTS

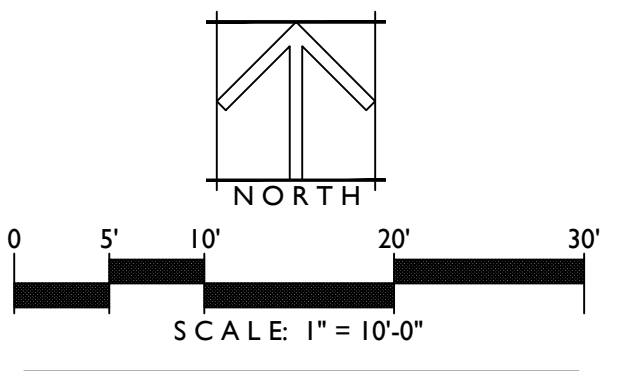
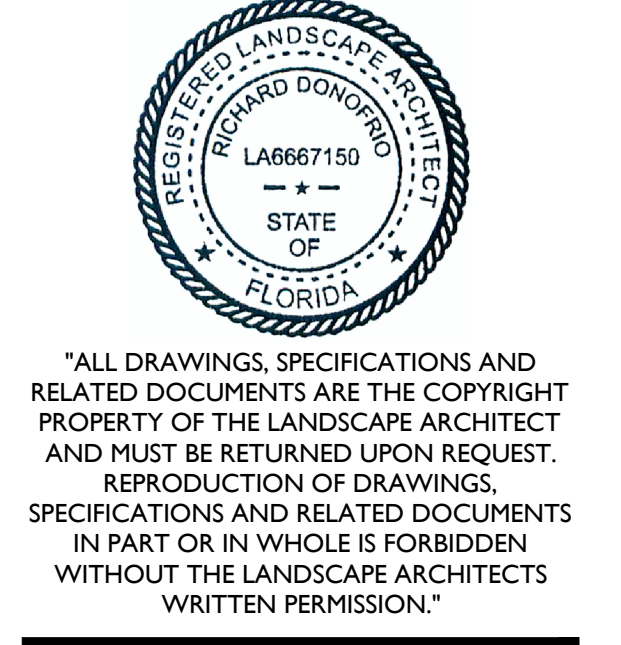
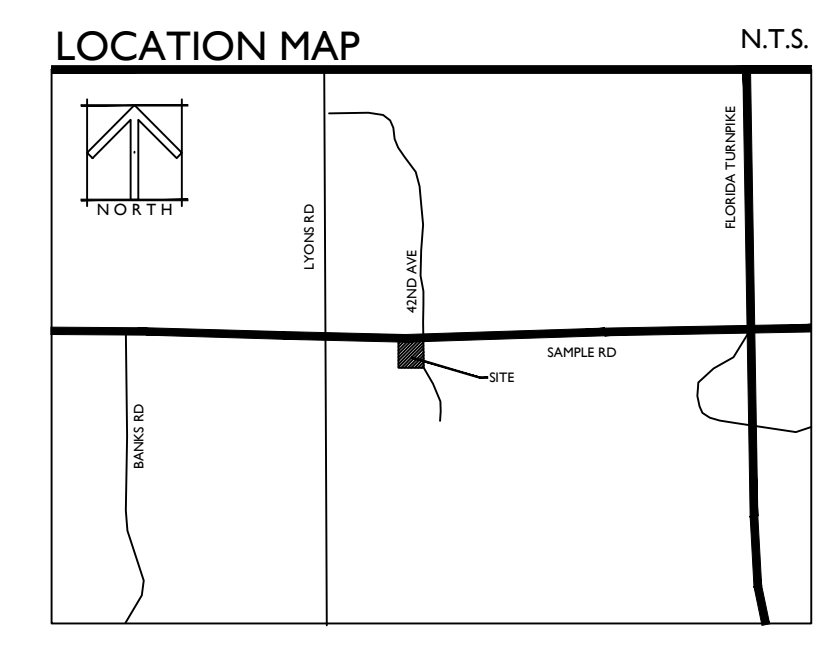

DRAWN BY: LHT
 DRAWING #: 2014-02-27_EX_LSC_1066.52.dwg
 FILE #: 1066.52

SHEET #
TI.1