

MATCH LINE SEE SHEET AS2.01

MATCH LINE SEE SHEET L-1 FOR CONTINUATION



SYNALOVSKI ROMANIK SAYE
Architectural - Planning - Interior Design

1800 Eller Drive, Suite 500
Fort Lauderdale, FL 33316
T 954.961.6806
F 954.961.6807
www.synalovskid.com

TAMMY D. COOK-WEEBON, R.L.A.
STATE OF FLORIDA REGISTERED LANDSCAPE ARCHITECT
LICENSE NO. 1328

Certificate of Authorization LC00000339

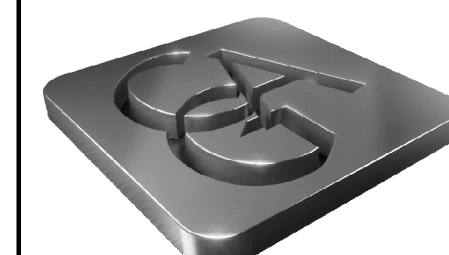

Calvin, Giordano & Associates, Inc.
EXCEPTED PROFESSIONAL SOLUTIONS
1800 Eller Drive, Suite 600, Fort Lauderdale, Florida 33316
Phone: 954.921.7701 • Fax: 954.921.8807

WINDMILL PARK
700 LYONS ROAD
COCONUT CREEK, FL 33063
CLIENT: CITY OF COCONUT CREEK

| REV | DATE | DESCRIPTION |
|-----|----------|----------------|
| 1 | 11-14-16 | ISSUE COMMENTS |
| 2 | 11-14-16 | ISSUE COMMENTS |

DESIGN DELIVERABLE: SET
100% COMPLETION
ISSUE DATE: 01/12/2016

PROJECT NUMBER: 1252-140622
DRAWN BY: MM
CHECKED BY: TCW

PLANTING PLAN



SHEET NUMBER: L-4

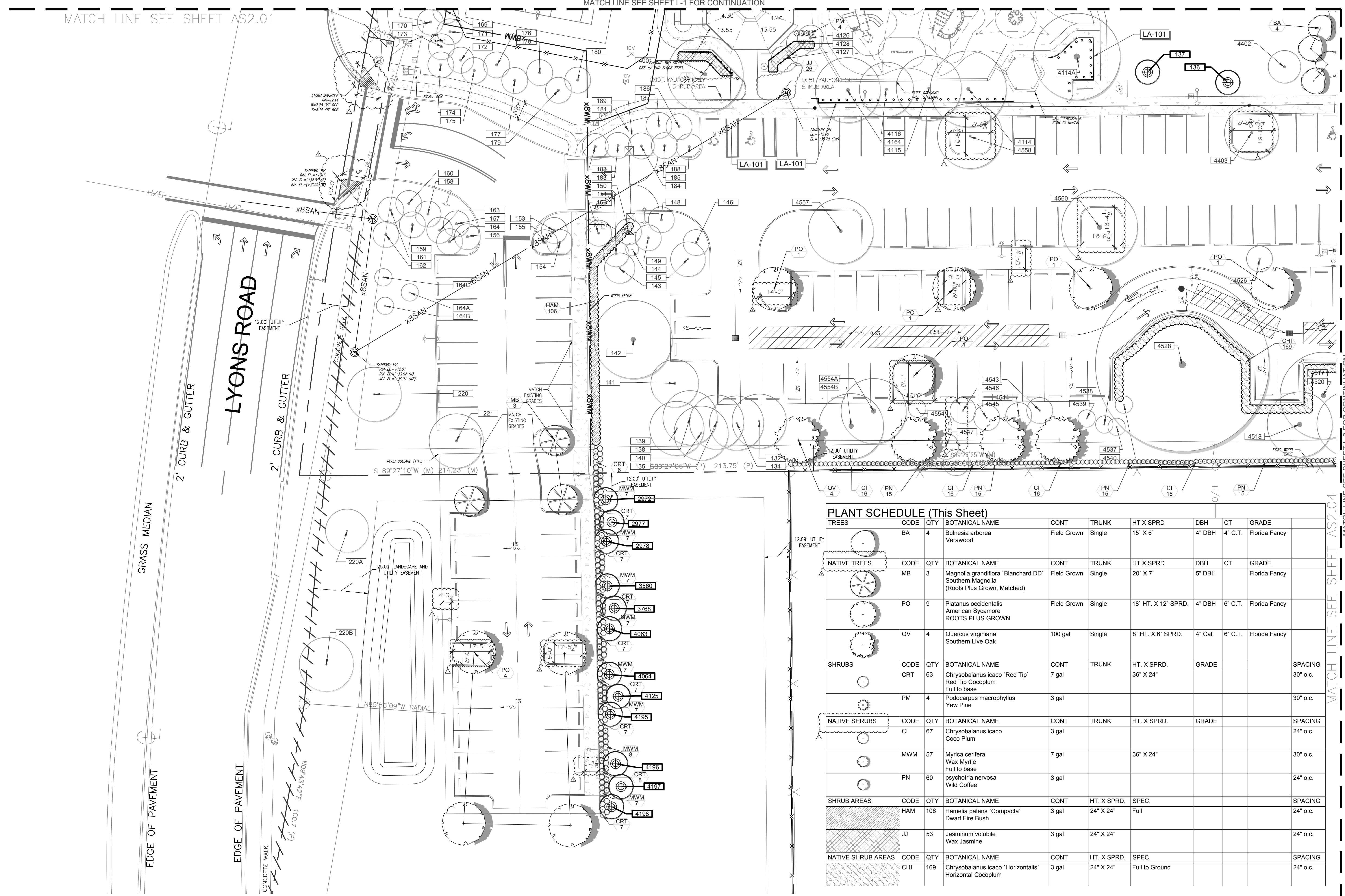

| PLANT SCHEDULE (This Sheet) | | | | | | | | | |
|-----------------------------|-----|---|-------------|--------|---------------------|---------|---------|----------------|----------|
| TREES | | | | | | | | | |
| BA | 4 | Bulnesia arborea Verawood | Field Grown | Single | 15' X 6' | 4" DBH | 4' C.T. | Florida Fancy | |
| NATIVE TREES | | | | | | | | | |
| MB | 3 | Magnolia grandiflora 'Blanchard DD' Southern Magnolia (Roots Plus Grown, Matched) | Field Grown | Single | 20' X 7' | 5" DBH | | Florida Fancy | |
| PO | 9 | Platanus occidentalis American Sycamore ROOTS PLUS GROWN | Field Grown | Single | 18' HT. X 12' SPRD. | 4" DBH | 6' C.T. | Florida Fancy | |
| QV | 4 | Quercus virginiana Southern Live Oak | 100 gal | Single | 8' HT. X 6' SPRD. | 4" Cal. | 6' C.T. | Florida Fancy | |
| SHRUBS | | | | | | | | | |
| CRT | 63 | Chrysobalanus icaco 'Red Tip' Red Tip Cocoplum Full to base | 7 gal | | 36" X 24" | | | | 30" o.c. |
| PM | 4 | Podocarpus macrophyllus Yew Pine | 3 gal | | | | | | 30" o.c. |
| NATIVE SHRUBS | | | | | | | | | |
| CI | 67 | Chrysobalanus icaco Coco Plum | 3 gal | | | | | | 24" o.c. |
| MWM | 57 | Myrica cerifera Wax Myrtle Full to base | 7 gal | | 36" X 24" | | | | 30" o.c. |
| PN | 60 | psychotria nervosa Wild Coffee | 3 gal | | | | | | 24" o.c. |
| SHRUB AREAS | | | | | | | | | |
| HAM | 106 | Hamelia patens 'Compacta' Dwarf Fire Bush | 3 gal | | 24" X 24" | | | Full | 24" o.c. |
| JJ | 53 | Jasminum volubile Wax Jasmine | 3 gal | | 24" X 24" | | | | 24" o.c. |
| NATIVE SHRUB AREAS | | | | | | | | | |
| CHI | 169 | Chrysobalanus icaco 'Horizontalis' Horizontal Cocoplum | 3 gal | | 24" X 24" | | | Full to Ground | 24" o.c. |

TOTAL ST AUGUSTINE FLORATAM SOD L-4 = 59,741
REFERENCE NOTES SCHEDULE

| SYMBOL | LANDSCAPE DESCRIPTION | QTY | DETAIL |
|--------|------------------------|--------|--------|
| LA-101 | Root Barrier 36" depth | 183 If | 1/L-5 |

- NOTE:
- ANY DAMAGE TO EXISTING TREE ROOTS GREATER THAN ONE INCH IN DIAMETER, WILL NEED TO BE EVALUATED AND TREATED BY A CERTIFIED ARBORIST AT NO ADDITIONAL COST TO THE OWNER.
 - ANY EXISTING TREE OR PALM WHICH DIES DUE TO CONSTRUCTION SHALL BE REPLACED WITH SAME TYPE AND SIMILAR SIZE AT NO ADDITIONAL COST TO THE OWNER.

DRC SUBMISSION
PRELIMINARY NOT FOR CONSTRUCTION
ELEVATIONS SHOWN ARE NGVD 29
(NAVD88=NGVD29-1.565')

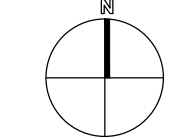

4 PLANTING PLAN
1"= 20'-0"

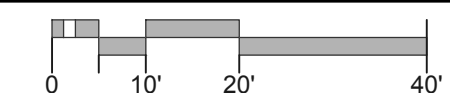

P:\Projects\2014\12\1721 - windmillpark\add\Rev\Drawings\14-271_L-PLANTING.Plan.dwg 1/12/2016 8:02:30 PM