

REVISIONS

REV #	DATE	BY:
-------	------	-----

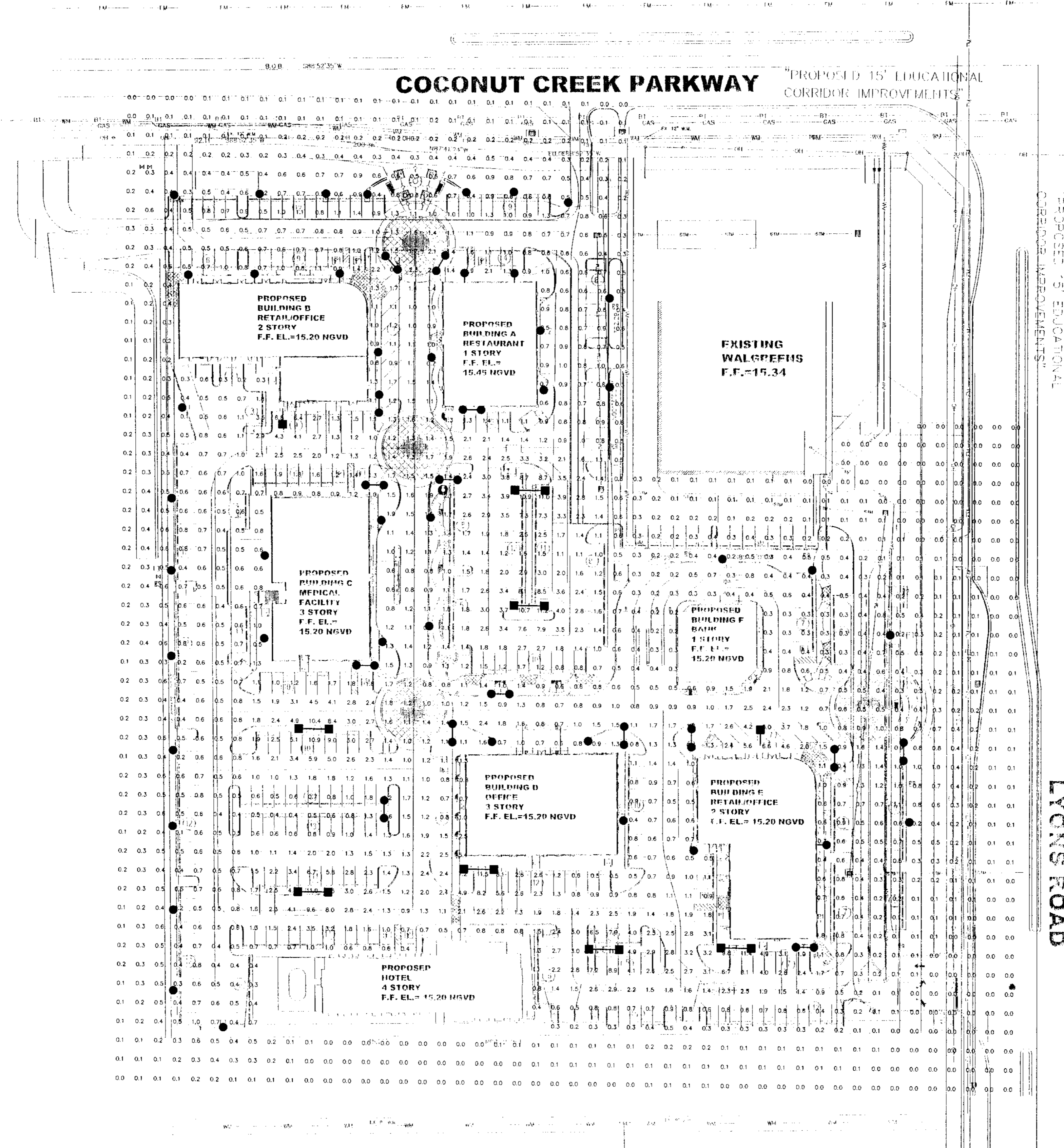

Statistical Area Summary

Project: All Projects					
Label	Avg	Max	Min	Avg/Min	Max/Min
parking	1.50	11.5	0.1	15.00	115.00

Luminaire Schedule

Project: All Projects						
Symbol	Qty	Label	Arrangement	Lumens	LLF	Description
[Symbol]	7	A	BACK-BACK	36000	0.750	WLS-HF-S-FP-400-MH-FG 22' POLE 3'BASE
[Symbol]	2	B	SINGLE	36000	0.750	WLS-HF-S-FP-400-MH-FG 22' POLE 3'BASE
[Symbol]	15	C	BACK-BACK	13500	0.750	WLS-858-3-150-MH 15' MH
[Symbol]	36	D	SINGLE	13500	0.750	WLS-858-3-150-MH 15' MH
[Symbol]	6	E	SINGLE	13500	0.750	WLS-858-3-150-MH 15' MH

BASED ON THE INFORMATION PROVIDED, ALL DIMENSIONS AND LUMINAIRE LOCATIONS SHOWN REPRESENT RECOMMENDED POSITIONS. THE ENGINEER AND/OR ARCHITECT MUST DETERMINE APPLICABILITY OF THE LAYOUT TO EXISTING OR FUTURE FIELD CONDITIONS.

THIS LIGHTING PATTERN REPRESENTS ILLUMINATION LEVELS CALCULATED FROM LABORATORY DATA TAKEN UNDER CONTROLLED CONDITIONS UTILIZING CURRENT INDUSTRY STANDARD LAMP RATINGS IN ACCORDANCE WITH ILLUMINATING ENGINEERING SOCIETY APPROVED METHODS. ACTUAL PERFORMANCE OF ANY MANUFACTURER'S LUMINAIRE MAY VARY DUE TO VARIATION IN ELECTRICAL VOLTAGE, TOLERANCE IN LAMPS AND OTHER VARIABLE FIELD CONDITIONS.

REVISED

[Signature]
3/15/06

STRADA
COCONUT CREEK, FL

WLS LIGHTING SYSTEMS

SCALE 1"=50'

DATE - 10/20/05

BY: S.C.

800-633-8711

PM: JEFF

SHEET 1 OF 1