

SAMPLE ROAD
S.R. No. 834

SITE PLAN

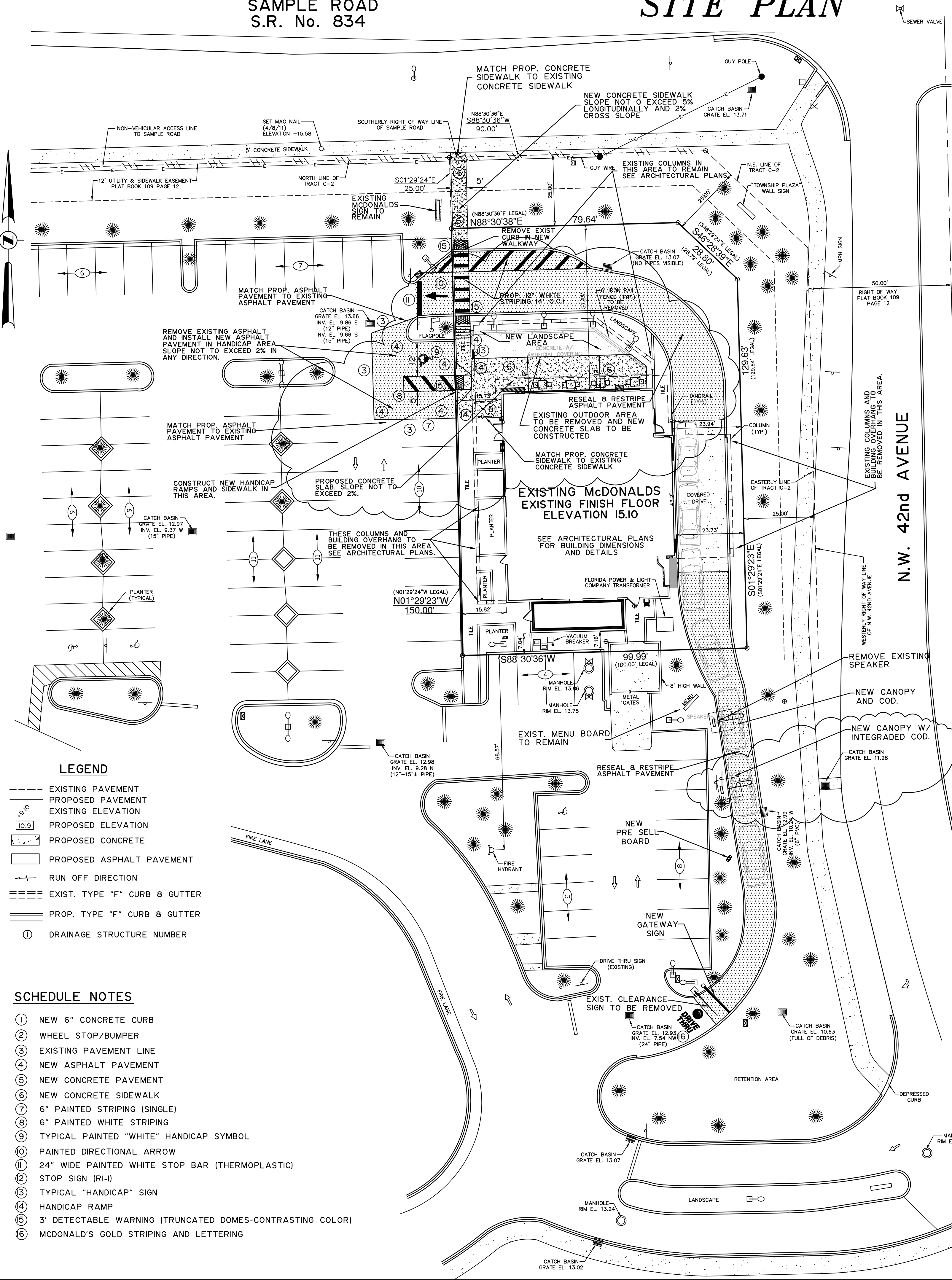

- LEGEND**
- EXISTING PAVEMENT
 - - - PROPOSED PAVEMENT
 - - - EXISTING ELEVATION
 - 10.9 PROPOSED ELEVATION
 - - - PROPOSED CONCRETE
 - - - PROPOSED ASPHALT PAVEMENT
 - - - RUN OFF DIRECTION
 - EXIST. TYPE "F" CURB & GUTTER
 - PROP. TYPE "F" CURB & GUTTER
 - ① DRAINAGE STRUCTURE NUMBER

SCHEDULE NOTES

- NEW 6" CONCRETE CURB
- WHEEL STOP/BUMPER
- EXISTING PAVEMENT LINE
- NEW ASPHALT PAVEMENT
- NEW CONCRETE PAVEMENT
- NEW CONCRETE SIDEWALK
- 6" PAINTED STRIPING (SINGLE)
- 6" PAINTED WHITE STRIPING
- TYPICAL PAINTED "WHITE" HANDICAP SYMBOL
- PAINTED DIRECTIONAL ARROW
- 24" WIDE PAINTED WHITE STOP BAR (THERMOPLASTIC)
- STOP SIGN (R-I-I)
- TYPICAL "HANDICAP" SIGN
- HANDICAP RAMP
- 3' DETECTABLE WARNING (TRUNCATED DOMES-CONTRASTING COLOR)
- MCDONALD'S GOLD STRIPING AND LETTERING

SITE DATA:

ZONING: B - 3
LAND USE: COMMUNITY SHOPPING DISTRICT

Flood Zone:	AH	Elevation 14 FEET
BUILDING SETBACKS:	REQUIRED	EXISTING
Front (Sample Rd)	25 F.	56.8 F.
Rear	0 F.	7.0 F.
Side (East)	20 F.	23.7 F.

LEGAL DESCRIPTION:

Being a portion of Tract C-2, TARTAN COCONUT CREEK PHASE II, according to the Plat thereof as recorded in Plat Book 109 at Page 12 of the Public Records of Broward County, Florida.

Commence at the Northeast corner of said Tract C-2, said corner lying on the Southerly right-of-way line of Sample Road; thence South 88°30'36" West along said Southerly right-of-way line also being the North line of said Tract C-2 for 90.00' feet; thence South 01°29'24" East for 25.00 feet to the Point of Beginning of the hereinafter described parcel of land; thence North 88°30'36" East along a line parallel with and 25.00 feet South of said Southerly right-of-way line of Sample Road for 79.64 feet; thence South 46°29'24" East along a line parallel with and 25.00 feet Southwesterly of the Northeast line of said Tract C-2 for 28.79 feet; thence South 01°29'24" East along a line parallel with and 25.00 feet West of the Westerly right-of-way line of NW 42nd Avenue and its projection thereof said Westerly right-of-way line also being the Easterly line of said Tract C-2 for 129.64 feet; thence South 88°30'36" West for 100.00 feet; thence North 01°29'24" West for 150.00 feet to the Point of Beginning.

All lying and being in Section 20, Township 48 South, Range 42 East, City of Coconut Creek, Broward County, Florida.

NOTES:

- BACKGROUND INFORMATION OBTAINED FROM BOUNDARY & TOPOGRAPHIC SURVEY PREPARED BY FORTIN, LEAVY, SKILES, INC. APRIL 8, 2011.
- ELEVATIONS ARE BASED UPON N.G.V. DATUM OF 1929 AND AS SHOWN ON SURVEY.
- UNDERGROUND UTILITY INFORMATION IS TAKEN FROM THE BEST AVAILABLE SOURCES; BUT SHOULD BE VERIFIED BY THE CONTRACTOR IN THE FIELD WITH THE APPROPRIATE UTILITY AGENCY PRIOR TO COMMENCEMENT OF ANY WORK.
- EXISTING UTILITY LINES OTHER THAN THOSE INDICATED IN THIS DRAWING MAY BE ON THE SITE. THE CONTRACTOR IS WARNED TO PROCEED WITH CAUTION WITH ALL WORK. HE IS TO MAKE ALL POSSIBLE INVESTIGATION AS TO POSSIBLE UNMARKED UTILITY LINES.
- ANY APPARENT DISCREPANCIES IN THE PLANS AND FIELD CONDITIONS SHALL BE BROUGHT TO THE ATTENTION OF THE ENGINEER BEFORE PROCEEDING WITH THE WORK.
- THE CONTRACTOR SHALL RESTORE ALL AREAS DISTURBED BY THIS CONSTRUCTION TO A CONDITION EQUAL TO, OR BETTER THAN, THAT NOW EXISTING.
- CONTRACTOR SHALL ADJUST ANY UTILITY LIDS AND/OR COVERS IN PROJECT AREA TO THE FINISHED GRADE.
- THIS SITE LIES IN SECTION 20, TOWNSHIP 48 SOUTH, RANGE 42 EAST IN THE CITY OF COCONUT CREEK IN BROWARD COUNTY, FLORIDA.
- ALL CONSTRUCTION SHALL COMPLY WITH THE LATEST BUILDING CODE IN AFFECT.
- CONTRACTOR SHALL VERIFY THAT COMPONENTS OF THE SITE COMPLY WITH CURRENT ADA STANDARDS AND SPECIFICATIONS.

NOTE TO CONTRACTOR:

CONTRACTOR SHALL FAMILIARIZE HIMSELF WITH THE ADA REPORT DEVELOPED BY ADA COMPLIANCE. CONTRACTOR SHALL IMPLEMENT ALL REQUIRED WORK UNDER THIS REPORT. FURTHERMORE IF ANY ASPECT CAN NOT BE PERFORMED OR IF ANY ADDITIONAL EXISTING SITE ADA COMPONENT DOES NOT COMPLY WITH ADA STANDARDS CONTRACTOR SHALL NOTIFY ENGINEER AND MCDONALD'S PROJECT MANAGER FOR DIRECTION.

NOTE TO CONTRACTOR:

AFTER ALL NEW SITE WORK HAS BEEN COMPLETED, THE HATCHED AREA IS TO BE RE-SEALED AND RE-STRIPED.

CONTRACTOR TO TAKE ALL PRECAUTIONS DURING CONSTRUCTION TO INSURE THAT NO DEBRIS ENTERS THE DRAINAGE SYSTEM.

AFTER ALL CONSTRUCTION IS COMPLETED CONTRACTOR TO VACUUM CLEAN THE EXISTING DRAINAGE SYSTEM AND MANHOLES.

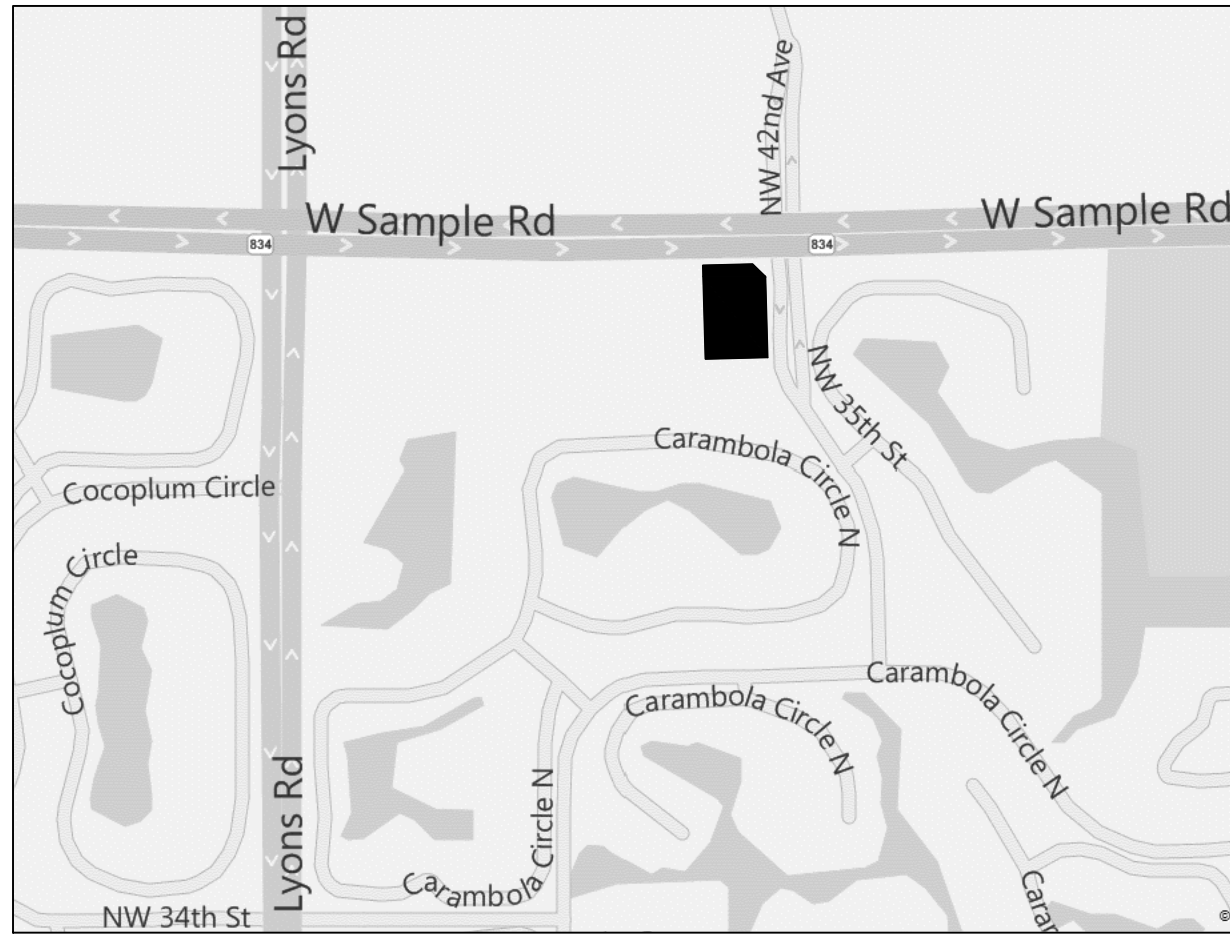

- MCDONALD'S ROAD SIGN AND BASE ARE BY THE SIGN CONTRACTOR. CONDUIT AND WIRING ARE BY THE GENERAL CONTRACTOR.
- BASES, ANCHOR BOLTS, CONDUIT, AND WIRING FOR ALL OTHER SIGNS ARE BY THE GENERAL CONTRACTOR.
- (3) 1 1/2" EMPTY CONDUITS TO LOCATIONS SHOWN AT THE LOT PER-METER FOR LOT LIGHTING IS SUPPLIED AND INSTALLED BY THE GENERAL CONTRACTOR.
- BASES FOR FLAGPOLES ARE BY THE GENERAL CONTRACTOR. ANCHOR BOLTS ARE BY THE FLAGPOLE SUPPLIER.
- PROPOSED UTILITIES ARE SHOWN IN SCHEMATIC ONLY. EXACT LOCATIONS SHALL BE DETERMINED TO ALLOW FOR THE MOST ECONOMICAL INSTALLATION. G.C. TO PROVIDE AS-BUILT UTILITY PLAN.
- THE CONTRACTOR SHALL COORDINATE WITH ALL UTILITY COMPANIES TO DETERMINE EXACT POINT OF SERVICE CONNECTION AT EXISTING UTILITY. REFER TO THE BUILDING ELECTRICAL AND PLUMBING DRAWINGS FOR LOCATIONS, SIZES, AND CIRCUITING.
- ALL ELEVATIONS SHOWN ARE IN REFERENCE TO THE BENCHMARK AND MUST BE VERIFIED BY THE GENERAL CONTRACTOR AT GROUND BREAK.
- FINISH WALK AND CURB ELEVATIONS SHALL BE 6" ABOVE FINISH PAVEMENT.

PAVING SPECIFICATION

Flood Zone:	AH	Elevation 14 FEET
BUILDING SETBACKS:	REQUIRED	EXISTING
Front (Sample Rd)	25 F.	56.8 F.
Rear	0 F.	7.0 F.
Side (East)	20 F.	23.7 F.

LEGAL DESCRIPTION:

Being a portion of Tract C-2, TARTAN COCONUT CREEK PHASE II, according to the Plat thereof as recorded in Plat Book 109 at Page 12 of the Public Records of Broward County, Florida.

Commence at the Northeast corner of said Tract C-2, said corner lying on the Southerly right-of-way line of Sample Road; thence South 88°30'36" West along said Southerly right-of-way line also being the North line of said Tract C-2 for 90.00' feet; thence South 01°29'24" East for 25.00 feet to the Point of Beginning of the hereinafter described parcel of land; thence North 88°30'36" East along a line parallel with and 25.00 feet South of said Southerly right-of-way line of Sample Road for 79.64 feet; thence South 46°29'24" East along a line parallel with and 25.00 feet Southwesterly of the Northeast line of said Tract C-2 for 28.79 feet; thence South 01°29'24" East along a line parallel with and 25.00 feet West of the Westerly right-of-way line of NW 42nd Avenue and its projection thereof said Westerly right-of-way line also being the Easterly line of said Tract C-2 for 129.64 feet; thence South 88°30'36" West for 100.00 feet; thence North 01°29'24" West for 150.00 feet to the Point of Beginning.

All lying and being in Section 20, Township 48 South, Range 42 East, City of Coconut Creek, Broward County, Florida.

PARKING INFORMATION

TOTAL SPACES	PARCEL IS	SPACES	X	•
	BUILDING ONLY	SPACES	X	•
		SPACES	X	•
		SPACES	X	•

UTILITY INFORMATION

	SIZE	TYPE	LOCATION
SANITARY SEWER			
WATER			
STORM SEWER			
ELECTRIC			
GAS			

SURVEY INFORMATION

PREPARED BY: FORTIN, LEAVY & SKILES, INC.
180 NORTHEAST 168 STREET
NORTH MIAMI BEACH, FLORIDA 33162
305-653-4493

DATE: APRIL 8, 2011

LEGEND	
SANITARY SEWER	GAS
WATER	LOT LIGHT
STORM SEWER	EXISTING ELEVATION
ELECTRIC	PROPOSED ELEVATION

PLAN SCALE: 1"=20'

STREET ADDRESS

4200 W. SAMPLE ROAD

CITY COCONUT CREEK STATE FLORIDA

COUNTY BROWARD

REGIONAL DWG. NO

LOCATION CODE NUMBER

009 — 1012

REV	DATE	DESCRIPTION	BY	ISSUE/REF
1	2/26/14	REMOVE OUTDOOR SEATING	CZ	

GERARDO ZAMORA P.E.
CIVIL ENGINEER
P.E. No. 44207
E.B. 0006791
STATE OF FLORIDA

ZAMORA & ASSOCIATES, INC.
ENGINEERING
LAND PLANNING
1410 N. KENDALL DRIVE SUITE 302 MIAMI, FLORIDA 33176
(305) 273-7801 FAX (305) 273-994

MCDONALD'S
4200 W. SAMPLE ROAD
COCONUT CREEK, FLORIDA

THESE PLANS AND SPECIFICATIONS ARE THE PROPERTY OF MCDONALD'S CORP. AND SHALL NOT BE REPRODUCED WITHOUT THEIR WRITTEN PERMISSION.

PLAN APPROVAL	DATE	STATUS	DATE	BY
SIGNATURE (2 REQUIRED)		PRELIMINARY		
REGIONAL MGR.		PLAN CHECKED		
CONST. MGR.		AS-BUILT		
OPERATIONS DEPT.				
REAL ESTATE DEPT.				
CO-SIGN SIGNATURES				
CONTRACTOR				
OWNER				