

DESCRIPTION

The geometric form of MESA LED luminaire allows it to adapt to either contemporary or traditional architectural settings. Available in single or twin pole mount configurations with optional wall mounting capability, the MESA LED luminaire's mounting options allow for harmonized site design whether at the entryway or in the parking lot. UL/cUL listed for use in wet locations.

SPECIFICATION FEATURES

Construction

HOUSING: Die-cast aluminum main housing and spider mount base maintain a minimum 0.125 wall thickness. Integral aluminum heat sink provides superior thermal heat transfer in +40°C ambient environments. **DOOR ASSEMBLY:** Top mounted, heavy wall, die-cast aluminum door maintains a nominal 0.125 thickness. Door includes a self-retaining interior hinge. **GASKET:** Continuous silicone gasket provided to seal housing door assembly and optic tray. **LENS:** Downlight lens is LED board integrated acrylic over-optics, each individually sealed for IP66 rating. **HARDWARE:** Four inset fasteners on underside of housing provide access to luminaire interior. Concealed, stainless steel four bar hinge lock allows door to lock in the open position.

Optics

DISTRIBUTION: Choice of twelve patented, high-efficiency AccuLED Optics™, featuring designs that maximize light collection and directional distribution onto the application region. Each optical lens is precision manufactured via injection-molding then precisely arranged and sealed on the board

media. **LEDs:** High output LEDs, 60,000+ hours life at >90% lumen maintenance, offered standard in 4000°K (+/- 275K) CCT and nominal 70 CRI. Mesa LightBAR optic tray is removable and able to rotate 360° in 90° increments for specific placement of the distribution relative to fixture.

Electrical

DRIVER: LED drivers are potted and heat sunk for optimal performance and prolonged life. Standard drivers feature electronic universal voltage (120-277V/50-60Hz), greater than 0.9 power factor, less than 20% harmonic distortion and feature ambient temperature range of +40°C (104°F) down to minimum starting temperature of -30°C (-22°F). Shipped standard with Cooper Lighting proprietary circuit module designed to withstand 10kV of transient line surge. All LED LightBARs™ and drivers are mounted to dedicated mounting trays and are easily replaced by use of quick disconnects for ease of wiring. Driver tray is removable without the use of tools. Options to control light levels, energy savings and egress capabilities (battery pack and separate circuit) are available.

Mounting

Fitter assembly mounts over 3" O.D. tenon and is secured via three concealed stainless steel set screws. Design of fitter provides seamless transition to 4" round poles. Additional mounting accessories include a dual fixture post top mounting arm and wall mount arm.

Finish

Housing is finished in five-stage super TGIC polyester powder coat paint, 2.5 mil nominal thickness for superior protection against fade and wear. LightBAR™ cover plates are standard white and may be specified to match finish of luminaire housing. Standard colors include black, bronze, grey, white, dark platinum and graphite metallic. RAL and custom color matches available. Consult Outdoor Architectural Colors brochure for a complete selection.

Warranty

Five-year warranty.



MSA MESA LED

1-6 LightBARs

Solid State LED

DECORATIVE LUMINAIRE



CERTIFICATION DATA

UL/cUL Listed
ISO 9001
IP66 LightBARs
LM79 / LM80 Compliant
2G Vibration Tested
DesignLights Consortium® Qualified*

ENERGY DATA

Electronic LED Driver
>0.9 Power Factor
<20% Total Harmonic Distortion
120-277V/50 & 60Hz, 347V/60Hz,
480V/60Hz
-30°C Minimum Temperature
40°C Ambient Temperature Rating

EPA

Effected Projected Area
1.1 Sq. Ft.

SHIPPING DATA

Approximate Net Weight:
50 lbs. (22.7 kgs.)



AVU092072
2015-01-08 13:22:43

DIMENSIONS

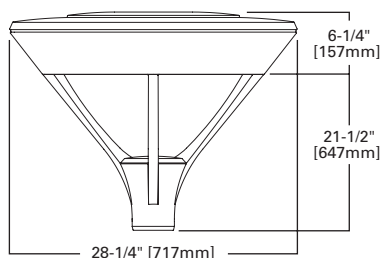

MOUNTING ACCESSORIES

WALL MOUNT ARM

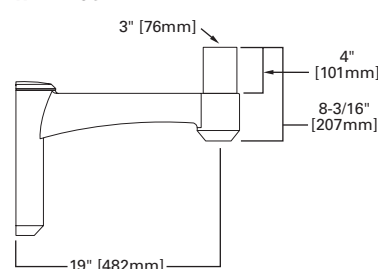

DUAL MOUNT ARM (EPA 1.36)

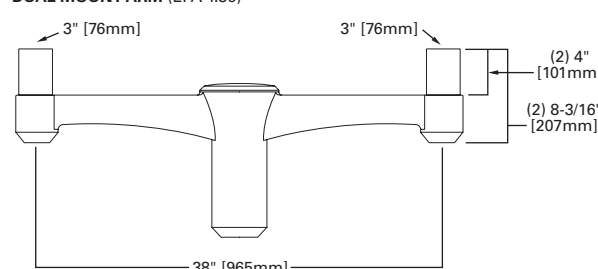

Cooper Lighting

by F.T.N

*www.designlights.org

POWER AND LUMENS BY BAR COUNT

Number of LightBARs	Distribution													
	Power (Watts)	Current @ 120V (A)	Current @ 277V (A)	T2	T3	T4	SL2	SL3	SL4	5MQ	5WQ	5XQ	RW	SLR/SLL
7 LED LIGHTBAR														
C01	27	0.23	0.13	1,708	1,709	1,668	1,718	1,668	1,675	1,845	1,770	1,791	1,701	1,609
C02	54	0.46	0.21	3,291	3,294	3,215	3,311	3,214	3,228	3,556	3,412	3,451	3,277	3,102
C03	77	0.65	0.29	4,751	4,755	4,641	4,779	4,640	4,660	5,133	4,925	4,982	4,731	4,478
C04	101	0.86	0.37	6,270	6,276	6,125	6,308	6,124	6,151	6,775	6,500	6,575	6,244	5,910
C05	131	1.11	0.50	7,508	7,515	7,334	7,553	7,333	7,365	8,112	7,783	7,873	7,477	7,076
C06	154	1.30	0.58	9,086	9,094	8,875	9,140	8,874	8,913	9,817	9,419	9,528	9,048	8,563
21 LED LIGHTBAR														
B01	27	0.23	0.13	2,101	2,102	2,052	2,113	2,052	2,061	2,269	2,177	2,203	2,092	1,980
B02	51	0.43	0.20	4,048	4,052	3,954	4,072	3,954	3,971	4,374	4,196	4,245	4,031	3,815
B03	73	0.62	0.28	5,844	5,849	5,708	5,879	5,707	5,732	6,314	6,058	6,128	5,820	5,507
B04	95	0.81	0.35	7,712	7,720	7,534	7,759	7,533	7,566	8,333	7,995	8,087	7,681	7,269
B05	124	1.05	0.48	9,235	9,243	9,021	9,290	9,020	9,059	9,978	9,573	9,684	9,197	8,703
B06	146	1.24	0.56	11,176	11,186	10,917	11,243	10,915	10,963	12,075	11,585	11,719	11,130	10,533

LUMEN MULTIPLIER

Ambient Temperature	Lumen Multiplier
10°C	1.04
15°C	1.03
25°C	1.00
40°C	0.96

LUMEN MAINTENANCE

Ambient Temperature	TM-21 Lumen Maintenance (60,000 Hours)	Theoretical L70 (Hours)
25°C	> 94%	> 350,000
40°C	> 93%	> 250,000
50°C	> 90%	> 170,000

ORDERING INFORMATION

Sample Number: MSA-A06-LED-E1-T3-GM

Product Family ¹	Number of LightBARs ^{2,3}	Lamp Type	Voltage	Distribution	Color ⁴
MSA=Mesa	B01=(1) 21 LED LightBAR B02=(2) 21 LED LightBARs B03=(3) 21 LED LightBARs B04=(4) 21 LED LightBARs B05=(5) 21 LED LightBARs B06=(6) 21 LED LightBARs C01=(1) 7 LED LightBAR C02=(2) 7 LED LightBARs C03=(3) 7 LED LightBARs C04=(4) 7 LED LightBARs C05=(5) 7 LED LightBARs C06=(6) 7 LED LightBARs	LED=Solid State Light Emitting Diodes	E1=Electronic (120-277V) 347=347V 480=480V	T2=Type II Area T3=Type III Area T4=Type IV Short SL2=Type II w/Spill Control SL3=Type III w/Spill Control SL4=Type IV w/Spill Control RW=Rectangular Wide 5MQ=Type V Square Medium 5WQ=Type V Square Wide 5XQ=Type V Square Extra Wide SLL=90° Spill Light Eliminator Left SLR=90° Spill Light Eliminator Right	AP=Grey BZ=Bronze BK=Black DP=Dark Platinum GM=Graphite Metallic WH=White
Options (Add as Suffix)			Accessories (Order Separately) ⁹		
PC=Button Type Photocontrol (Specify Voltage) R=NEMA Twistlock Photocontrol Receptacle 2L=Two Circuits ⁵ LCF=LightBAR Cover Plate Matches Housing Finish 7060=70 CRI / 6000K CCT ⁶ 8030=80 CRI / 3000K CCT ⁶ ICB=Integral Cold Weather Battery Pack (Specify 120 or 277V) ⁷ DIMRF-LW=LumaWatt Wireless Sensor, Wide Lens for 8' - 16' Mounting Height ⁸ DIMRF-LN=LumaWatt Wireless Sensor, Narrow Lens for 16' - 40' Mounting Height ⁸			VA6028-XX=Dual Mount Arm (EPA 1.38) VA6029-XX=Wall Mount Arm OA/RA1016=NEMA Photocontrol - Multi-Tap OA/RA1027=NEMA Photocontrol - 480V OA/RA1201=NEMA Photocontrol - 347V MA1253=10kV Circuit Module Replacement		

Notes:

- DesignLights Consortium® Qualified. Refer to www.designlights.org Qualified Products List under Family Models for details.
- Standard 4000K CCT and nominal 70 CRI.
- 21 LED LightBAR powered at 350mA, 7 LED LightBAR powered at 1A.
- Cutsom and RAL color matching available upon request. Consult your Eaton's Cooper Lighting business representative for more information.
- Low-level output varies by bar count. Consult factory. Not available with 347V or 480V. Requires quantity two or more LightBARs.
- Consult factory for lead times and lumen multiplier.
- Available with B01-B04 or C01-C04 configurations only. Specify 120V or 277V. LED cold weather integral battery pack is rated for minimum operating temperature -40°F (-20°C). Operates one LightBAR for 90-minutes. Not available in all configuration, consult factory. Rated for use in 25°C ambient.
- LumaWatt wireless sensors are factory installed and require network components RF-EM1-, RF-GW1 and RF-ROUT1 in appropriate quantities. See www.cooperlighting.com for LumaWatt application information.
- Replace XX with color designation.